



TIVOLI PARK APARTMENTS (P) LTD.  
*Director*  
 Director

SIGNATURE OF OWNER

CERTIFICATE OF STRUCTURAL ENGINEER

THIS IS TO CERTIFY THAT THE STRUCTURAL DESIGN AND DRAWING OF BOTH FOUNDATION AND SUPER STRUCTURE OF THE BUILDING HAS BEEN MADE BY ME CONSIDERING ALL POSSIBLE LOADS INCLUDING THE SEISMIC LOAD AS PER THE NATIONAL BUILDING CODE OF INDIA AND CERTIFIED THAT IT IS SAFE AND STABLE IN ALL RESPECTS.

*Upul Santra*  
 UPUL SANTRA  
 B.E., M.T.E. (2001),  
 I.T.E. (1993)  
 M/C Empanelled Structural Engineer  
 Civil, E.E. No. 1/94

SIGNATURE OF STRUCTURAL ENGG.

*M. K. Roy*  
 M. K. ROY  
 B.E. (Mechanical), M.Sc. Tech. (Mechanical) U.K.  
 A.N.D.S.T.C. Eng. M.T. STRUCT. E. (London)  
 Membership No. 20100003  
 M/C Empanelled Structural Reviewer  
 E.S.R.-(11)/12

SIGNATURE OF STRUCTURAL REVIEWER

CERTIFICATE OF GEOTECHNICAL ENGINEER

IT IS CERTIFIED THAT THE COMPREHENSIVE GEO-TECHNICAL REPORT ON SOIL INVESTIGATION HAS BEEN PREPARED BY ME FOR DESIGN AND CALCULATION OF THE FOUNDATION BY ANALYZING THE SOIL SAMPLE FOR ESTIMATING THE BEARING CAPACITY OF THE SOIL ON WHICH FOUNDATION IS EXTENDED UP TO APPROPRIATE DEPTH THAT HAS BEEN PROPOSED IN THE GEO-TECHNICAL REPORT.

For: C. E. Testing Company Pvt. Ltd.  
 Geotechnical Consultant  
*M. N. Nayak*  
 Dr. M. Nayak, MD  
 B.E. (Civil), Ph. D. (Geotech)

SIGNATURE OF GEO TECHNICAL ENGG.

CERTIFICATE OF ARCHITECT

I DO HEREBY CERTIFY WITH FULL RESPONSIBILITY THAT THE BUILDING PLAN HAS BEEN DRAWN UP AS PER K.M.C. BUILDING RULE - 2009 AS AMENDED FROM TIME TO TIME THAT THE WIDTH OF THE ABUTTING ROAD CONFORMS WITH THE PLAN AND IT IS A BUILDABLE SITE NOT A TANK OR A FILLED UP TANK. THE SITE PLAN, LOCATION PLAN AGREES WITH THE SITE. THE PLOT IS DEMARCATED BY BOUNDARY WALLS & MEASUREMENTS TALLY WITH THE REGD. DEED PLAN.

JAY PRAKASH BHARAT KUMAR AGRAWAL  
 B. Arch., A.J.C.A.  
 Reg. No. CAJ 801/10098  
 ARCHITECT S.L. NO. - 321A1

SIGNATURE OF ARCHITECT

TITLE: BASEMENT PLAN

PROJECT:  
 PLAN SHOWING CHANGES U/R-26 (2a)&(2b) OF K.M.C. BLDG. RULE 2009 FROM THE SANCTIONED PLAN VIDE B.P. NO. 2015080122 DATED: 31.03.16 FOR PARTLY (G+XXIX) & PARTLY (G+XXXI) & PARTLY (B+G+XXXII) STORIED RESIDENTIAL BUILDING AT PREMISES NO. 225B, A.J.C. BOSE ROAD, KOLKATA - 700 020.  
 WARD NO. - 89 BOROUGH - VIII & FURTHER REGULARISED U/R-26 (2a)&(2b) & U/R 69A(1)(a) OF K.M.C. BLDG. RULE 2009 APPROVED BY M.B.C. DATED - 10.01.17

ARCHITECTS:  
**AGRAWAL & AGRAWAL**  
 BARODA KOLKATA

SCALE - 1:100 DATE 15.02.18 DEALT SAYANTANI CHECKED SUBHASHISH

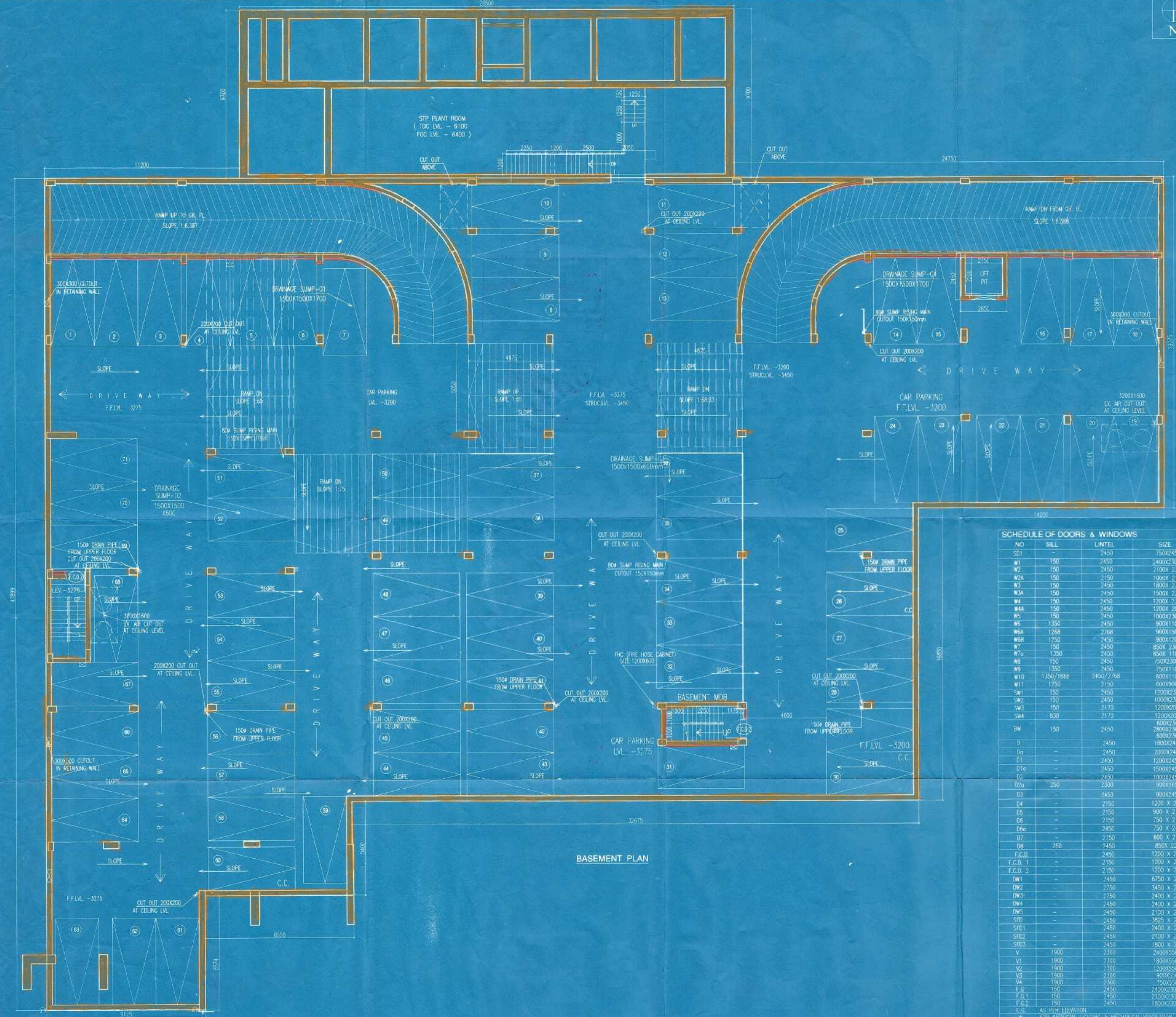

SCHEDULE OF DOORS & WINDOWS

NO	SILL	LINTEL	SIZE
S01	-	2450	750X2450
W1	150	2450	2400X2300
W2	150	2450	2100X 2300
W3	150	2150	1000X 2150
W3A	150	2450	1800X 2300
W4	150	2450	1500X 2300
W4A	150	2450	1200X 2300
W5	150	2450	1200X 2020
W6	1350	2450	1000X2300
W6A	1268	2768	900X1100
W6B	1250	2450	900X1100
W7	150	2450	850X 2300
W7G	1350	2450	850X 1100
W8	150	2450	750X2300
W9	1350	2450	750X1100
W10	1350/1868	2450/2768	600X1100
W11	1250	2150	600X900
SW1	150	2450	1200X2300
SW2	150	2450	1000X2300
SW3	150	2170	1200X2020
SW4	830	2170	1200X2070
BW	150	2450	800X2300
D	-	2450	2800X2300
Dg	-	2450	600X2300
D1	-	2450	1800X2450
D1a	-	2450	2000X2450
D2	-	2450	1200X2450
D2a	250	2300	1000X2450
D3	-	2450	900X2050
D3	-	2450	900X2450
D4	-	2150	1200 X 2150
D5	-	2150	900 X 2150
D6	-	2150	750 X 2150
D6a	-	2450	750 X 2450
D7	-	2150	750 X 2150
D7	-	2150	800 X 2150
D8	250	2450	850X 2250
F.C.D	-	2450	1200 X 2450
F.C.D. 1	-	2150	1000 X 2150
F.C.D. 2	-	2150	1200 X 2150
DW1	-	2450	6750 X 2450
DW2	-	2750	3450 X 2750
DW3	-	2750	2400 X 2750
DW4	-	2450	2400 X 2450
DW5	-	2450	2100 X 2450
SFD	-	2450	3825 X 2450
SFD1	-	2450	2400 X 2450
SFD2	-	2450	2100 X 2450
SFD3	-	2450	1800 X 2450
V	1900	2300	2400X550
V1	1900	2300	1800X550
V2	1900	2300	1200X550
V3	1900	2300	900X550
V4	1900	2300	750X550
F.G	150	2450	2400X2300
F.G.1	150	2450	2100X2300
F.G.2	150	2450	1800X2300
C.G.	-	-	-

BASEMENT PLAN

**PARTY'S COPY**

U/R-26(2a) & (2b) of  
K.M.C. Building rules  
2009...approved by  
D.S. (S-18).....  
Dt. 15.02.2018....

KOLKATA MUNICIPAL CORPORATION  
BUILDING DEPTT.  
PLANS APPROVED U/R 26(2a) & (2b) of  
K.M.C. BUILDING RULES 2009  
S.P. No. 2015080122DL9/108/2016  
BR. NO. ... VIII  
Assistant Engineer Ex. Engr. VIII  
Br. No. VIII Br. No. VIII

This Plan is To Be Treated As Part  
And Parcel And Contiguous To  
S. S. Plan No. 2015080122  
Dated 15.02.2018  
Ex. Engineer (B)  
Br. No. :- VIII



*[Handwritten mark]*