

SCHEDULE OF DOORS & WINDOWS					
SI.NO	MKD.	SILL	LINTEL	SIZE	
1.	W1	350	2150	1800X1800	
2.	W2	350	2150	850X1800	
3.	W3	1100	2150	1050X1050	
4.	W4	1250	2150	600X900	
5.	W5	350	2150	1500X1800	
6.	W6	1100	2150	1800X1050	
7.	W7	350	2150	2050X1250	
8.	W8	350	2150	3000X1800	
11.	D	-	2450	1500X2450	
12.	D	-	2150	1200X2150	
13.	D1	-	2150	1000X2150	
14.	D2	-	2150	900X2150	
15.	D3	-	2150	750X2150	
16.	D4	-	2150	1500X2150	
17.	D5	-	2150	2000X2150	
18.	D6	-	2150	1800X2150	
18.	D7	150	2300	1000X2150	
20.	FCD	-	2150	1000X2150	
21.	SD1	-	2150	1800X2150	
22.	SD2	-	2150	1500X2150	
26.	DW	-	2150	1400X2150	
27.	DW1	-	2150	5000X2150	
28.	DW2	-	2150	2800X2150	
29.	DW3	-	2150	2425X2150	
31.	C.G.	AS / ELEVATION			

ABUL BARKAT MISAQUL WAHAB
 IMTIAZUL WAHAB
 RITA GOYAL
 SHIREEN WAHAB
 SHWETA GOYAL
 ZAINUS SANAM RAHMAN
 ZARA RAHMAN
 ZOYA RAHMAN
 ATTRIBUTE BUILD WORTH (P) LIMITED
 CAPETOWN TRADELINK (P) LIMITED
 EARTHPURE REALTY LLP
 JAGATGURU INFRA LLP
 KISHAN BUILDCON LLP
 PARTNERPROJECT (P) LIMITED
 RAMSWAROOP ESTATE LLP
 SINGLE POINT COMMOSEAL (P) LIMITED
 UTRAV VINIMAY (P) LIMITED

Rishu Chandra
 SIGNED AND AUTHORIZED SIGNATURE OF OWNERS

CERTIFICATE OF STRUCTURAL STABILITY

WE HEREBY CERTIFIED THAT THE FOUNDATION AND THE SUPERSTRUCTURE OF THE BUILDING PROPOSED FOR CONSTRUCTION AT F.S. & L.R. DAG NOS.1391,1395,1396,1397,1410,1411, &1412, MOUZA-THAKDARI, J.L. NO.19, UNDER BIDHANNAGAR MUNICIPAL CORPORATION, WARD NO. 27, PINCODE-700102, P.S. NEWTOWN, DIST. NORTH 24 PARGANAS. DESIGNED BY US WILL MAKE SOUND FOUNDATION & SUPER STRUCTURE SAFE IN ALL RESPECTS INCLUDING THE CONSIDERATION OF BEARING CAPACITY AND SETTLEMENT OF SOIL E.T.C.

Jishnu Pal

JISHNU PAL
 B.Tech (Civil), M.E. (Geo-tech)
 RMC Reg. No. G.1./11/1
 22/RAJISON/CA-7/1/2016-17
 OTR/NRDA/10/0043

SIGN. OF GEO-TECH. ENGG.

M. S. Majumdar

MAHENDRANATH MAJUMDAR
 B.Sc. (Hons), B.E. (Struct),
 M. Struc. E. (Lond), M.A.S.T.E. (USA)
 ESE-88 of
 The Gujarat Municipal Corporation

SIGN. OF STRUCTURAL REVIEWER

M. S. Majumdar

Mainak Majumdar
 B.Sc. (Hons), M.E. (Struct)
 ESE-152/19/GMC
 STR/NRDA/10/00020
 074/RJ/PSO/ESE/11-12

SIGN. OF STRUCTURAL ENGG.

J.P.

JAY PRAKASH BIHAR KUMAR AGRAWAL
 Reg. No. CA / 40 / 10098
 ARCHITECT SL. NO. - 32(A)

SIGN. OF ARCHITECT

TITLE:
 OVERALL SECOND FLOOR PLAN

PROJECT:
 PROPOSED PLAN OF (G+XII) STORED RESIDENTIAL BUILDING AT R.S. & L.R. DAG NOS.1391,1395,1396,1397,1410,1411, &1412, MOUZA-THAKDARI, J.L. NO 19, UNDER BIDHANNAGAR MUNICIPAL CORPORATION, WARD NO. 27, PINCODE-700102, P.S. NEWTOWN, DIST. NORTH 24 PARGANAS.

ARCHITECTS

AGRAWAL & AGRAWAL
 BARODA KOLKATA

SCALE	DATE	DEALT	CHECKED
1 : 100	24.08.19	ROSY	SUPRIYA

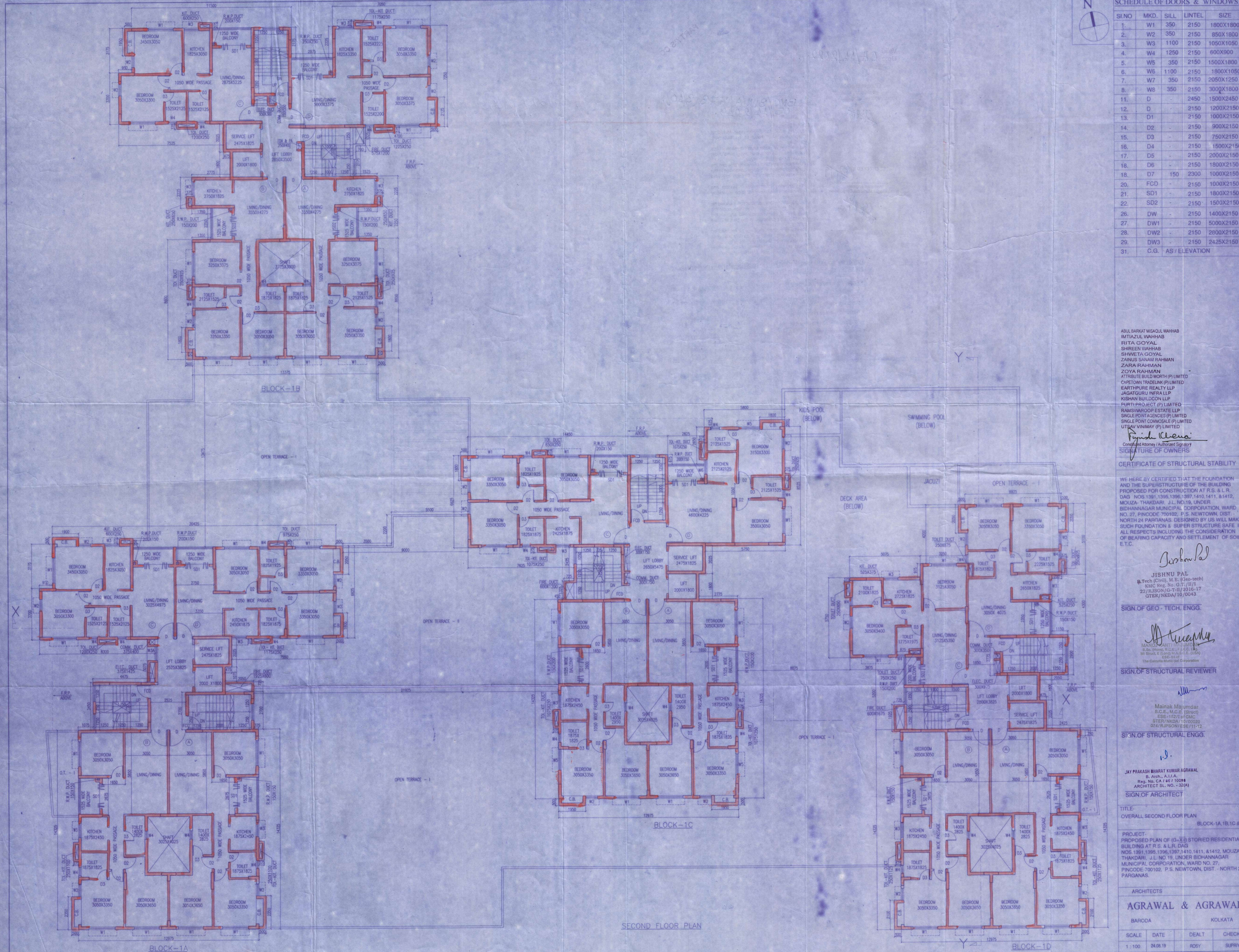

SECOND FLOOR PLAN

Valid Upto 08/11/2019

ANY DEVIATION SHALL MEAN DEMOLITION

PARTY'S COPY

Executive Engineer
Building Plan
Bidhannagar Municipal Corporation

08-11-19

APPROVED
Bidhannagar Municipal Corporation
Pouza Bhavan, FD-415A, Sector-III
Kolkata-700008
No.: BMC/BRN/A/773(3/10)
Date: 08/11/2019

CHECKED BY
Assistant Engineer
Bidhannagar Municipal Corporation

08-11-19

- Approved Subject to:
- 1) Building rules for Bidhannagar Municipal Corporation shall have to be observed, carefully.
 - 2) No wastage of water shall be made, check valve must be provided in ground/under ground & overhead reservoir.
 - 3) In no case water from rain water pipe and the surface drainage should be connected to the house sewer directly or through any yard gully.
 - 4) Plan showing internal sewer system and water supply lines have got to be separately sanctioned.
 - 5) Before starting any construction it should be satisfied that the site dimension conforms with that of plans sanctioned and all the conditions as proposed in the plan shall be fulfilled.
 - 6) Road and footpath shall not be encroached by dumping of building materials mixing of mortar etc. without prior permission.
 - 7) Prior to commencement of construction Appendix-B shall have to be submitted.

During construction following measures are to be strictly taken to reduce the effects of dust pollution from building construction sites

- Properly covering all building materials stocked at site like cement bags, sand, lime & stone chips.
- Using water sprays or sprinklers to keep the dust down during activities such as concreting, plastering, breaking concrete and piling activities.
- Washing the wheels of vehicles leaving the site, if they are carrying mud or waste.
- Putting up solid barriers around the site.
- Properly covering trucks & vehicles that enter and leave the site-carrying building materials and building debris.
- Cleaning and watering the road and footpath adjacent to the site at frequent intervals.
- Using dust bags, spraying water when using stone cutters and making the working area wet before using the machineries.
- Not burning waste materials at site which causes smoke containing carbon monoxide and a range of poisonous substances.

Executive Engineer
Building Plan
Bidhannagar Municipal Corporation

08-11-19