

Name of the Land Owning Companies

1. Aadarsaalea Dealers Private Limited.
2. Aadarsaalea Tie Up Private Limited.
3. Anjanidham Marketing Private Limited.
4. Anjanidham Mercantile Private Limited.
5. Araval Complex Private Limited.
6. Asthija Complex Private Limited.
7. Asthija Housing Private Limited.
8. Average Enclave Private Limited.
9. Agrage Heights Private Limited.
10. Average Properties Private Limited.
11. Averages Residency Private Limited.
12. Bagmati Vyapar Private Limited.
13. Bagmati Shoppers Private Limited.
14. Blockdeal Hirsa Private Limited.
15. Blockdeal Infracon Private Limited.
16. Blockdeal Nirman Private Limited.
17. Blockdeal Residency Private Limited.
18. Boiler Residency Private Limited.
19. Circular Promoters Private Limited.
20. Coohit Builders Private Limited.
21. Coohit Complex Private Limited.
22. Coohit Enclave Private Limited.
23. Coohit Housing Private Limited.
24. Coohit Infracon Private Limited.
25. Coohit Nirman Private Limited.
26. Coohit Projects Private Limited.
27. Coohit Promoters Private Limited.
28. Coohit Realty Private Limited.
29. Coohit Residency Private Limited.
30. Coohit Shoppers Private Limited.
31. Coohit Traders Private Limited.
32. Coohit Vyapar Private Limited.
33. Coohit Vyapar Private Limited.
34. Coohit Vyapar Private Limited.
35. Coohit Vyapar Private Limited.
36. Coohit Vyapar Private Limited.
37. Coohit Vyapar Private Limited.
38. Coohit Vyapar Private Limited.
39. Coohit Vyapar Private Limited.
40. Coohit Vyapar Private Limited.
41. Coohit Vyapar Private Limited.
42. Coohit Vyapar Private Limited.
43. Coohit Vyapar Private Limited.
44. Coohit Vyapar Private Limited.
45. Coohit Vyapar Private Limited.
46. Coohit Vyapar Private Limited.
47. Coohit Vyapar Private Limited.
48. Coohit Vyapar Private Limited.
49. Coohit Vyapar Private Limited.
50. Coohit Vyapar Private Limited.
51. Coohit Vyapar Private Limited.
52. Coohit Vyapar Private Limited.
53. Coohit Vyapar Private Limited.
54. Coohit Vyapar Private Limited.
55. Coohit Vyapar Private Limited.
56. Coohit Vyapar Private Limited.
57. Coohit Vyapar Private Limited.
58. Coohit Vyapar Private Limited.
59. Coohit Vyapar Private Limited.
60. Coohit Vyapar Private Limited.
61. Coohit Vyapar Private Limited.
62. Coohit Vyapar Private Limited.
63. Coohit Vyapar Private Limited.
64. Coohit Vyapar Private Limited.
65. Coohit Vyapar Private Limited.
66. Coohit Vyapar Private Limited.
67. Coohit Vyapar Private Limited.
68. Coohit Vyapar Private Limited.
69. Coohit Vyapar Private Limited.
70. Coohit Vyapar Private Limited.
71. Coohit Vyapar Private Limited.
72. Coohit Vyapar Private Limited.
73. Coohit Vyapar Private Limited.
74. Coohit Vyapar Private Limited.
75. Coohit Vyapar Private Limited.
76. Coohit Vyapar Private Limited.
77. Coohit Vyapar Private Limited.
78. Coohit Vyapar Private Limited.
79. Coohit Vyapar Private Limited.
80. Coohit Vyapar Private Limited.
81. Coohit Vyapar Private Limited.
82. Coohit Vyapar Private Limited.
83. Coohit Vyapar Private Limited.
84. Coohit Vyapar Private Limited.
85. Coohit Vyapar Private Limited.
86. Coohit Vyapar Private Limited.
87. Coohit Vyapar Private Limited.
88. Coohit Vyapar Private Limited.
89. Coohit Vyapar Private Limited.
90. Coohit Vyapar Private Limited.
91. Coohit Vyapar Private Limited.
92. Coohit Vyapar Private Limited.
93. Coohit Vyapar Private Limited.
94. Coohit Vyapar Private Limited.
95. Coohit Vyapar Private Limited.
96. Coohit Vyapar Private Limited.
97. Coohit Vyapar Private Limited.
98. Coohit Vyapar Private Limited.
99. Coohit Vyapar Private Limited.
100. Coohit Vyapar Private Limited.

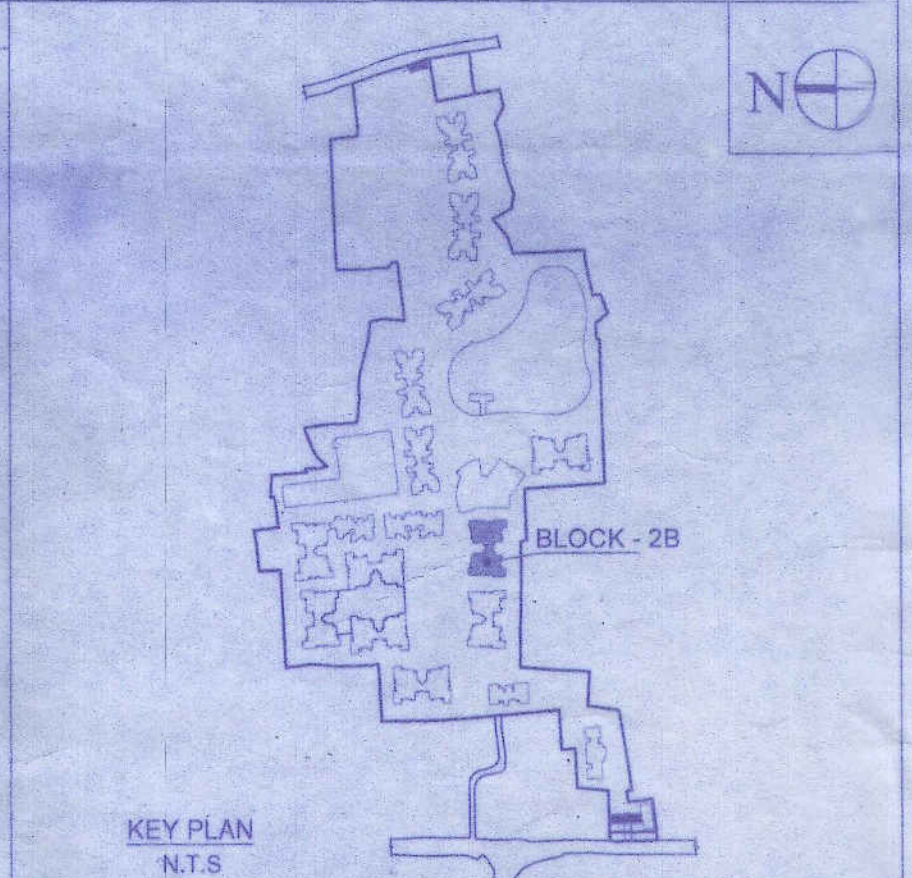

**SCHEDULE OF DOORS & WINDOWS**

NO.	SILL	LINTEL	SIZE
D	2150	1800X2150	
D1	2150	1100X2150	
D2	2150	1000X2150	
D3	2150	900X2150	
D4	2150	750X2150	
D5	2150	1000X2150	
FCD	2150	1150X2150	
SD1	2150	2100X2150	
SD2	2150	1800X2150	
SD3	2150	1500X2150	
SD4	2150	1200X2150	
W1	350	2150	1800X1800
W1A	350	2150	1500X1800
W2	350	2150	1325X1800
W2A	350	2150	1150X1800
W2B	350	2150	1000X1800
W3	350	2150	850X1800
W3A	350	2150	800X900
W4	950	2150	900X1200
W5	1250	2150	600X900
W6	950	2150	1200X1200
W6A	950	2150	1500X1200

**CERTIFICATE OF STRUCTURAL STABILITY**

WE HEREBY CERTIFY THAT THE FOUNDATION AND SUPERSTRUCTURE OF THE BUILDING PROPOSED FOR CONSTRUCTION ON MOUZA-PATULIA DAG NOS.-696 (P), 697, 698, 699, 700, 737 (P), 743, 744 (P), 749, 750, 754, 755, 756, 757, 758, 759, 760, 761, 762, 766 (P), 768, 769, 770, 771, 772, 773, 774, 776, 777, 778, 779, 780, 781, 782, 786 (P), 787, 788, 789, 790, 791, 792, 793, 794, 795, 796, 797, 798, 799, 800, 801, 802, 803, 804, 805, 806, 807, 808, 809, 810, 811, 812, 813, 814, 815, 816, 817, 818, 819, 820, 821, 822, 823, 824, 825, 826, 827, 828, 829, 830, 831, 832, 833, 834, 835, 836, 837, 838, 839, 840, 841, 842, 843, 844, 845, 846, 847, 848, 849, 850, 851, 852, 853, 854, 855, 856, 857, 858, 859, 860, 861, 862, 863, 864, 865, 866, 867, 868, 869, 870, 871, 872, 873, 874, 875, 876, 877, 878, 879, 880, 881, 882, 883, 884, 885, 886, 887, 888, 889, 890, 891, 892, 893, 894, 895, 896, 897, 898, 899, 900, 901, 902, 903, 904, 905, 906, 907, 908, 909, 910, 911, 912, 913, 914, 915, 916, 917, 918, 919, 920, 921, 922, 923, 924, 925, 926, 927, 928, 929, 930, 931, 932, 933, 934, 935, 936, 937, 938, 939, 940, 941, 942, 943, 944, 945, 946, 947, 948, 949, 950, 951, 952, 953, 954, 955, 956, 957, 958, 959, 960, 961, 962, 963, 964, 965, 966, 967, 968, 969, 970, 971, 972, 973, 974, 975, 976, 977, 978, 979, 980, 981, 982, 983, 984, 985, 986, 987, 988, 989, 990, 991, 992, 993, 994, 995, 996, 997, 998, 999, 1000.

JAY PRAKASH BHARAT KUMAR AGRAWAL  
 B. Arch., A.I.A.  
 Reg. No. CA/81/10098  
 ARCHITECT SL. NO. - 3214  
 SIGNATURE OF ARCHITECT

SANJAY KUMAR DEUBEY  
 B. Engg., A.I.E.E.  
 Reg. No. CE/85/14098  
 ARCHITECT SL. NO. - 3214  
 SIGNATURE OF ARCHITECT

**SIGN OF STRUCTURAL ENGG. & SIGN OF GEO-TECH. ENGG.**

THE PLAN HAS BEEN PLANNED & DESIGNED IN COMPLIANCE OF THE BEST ZONAL MUNICIPAL BUILDING RULES 2007 FOLLOWED BY KHARDAH MUNICIPALITY. THE NEAREST MUNICIPALITY. ALL NORMS REGARDING BUILDING SAFETY INCLUDING STRUCTURAL STABILITY & FIRE SAFETY SHALL BE AS PER NBC.

JAY PRAKASH BHARAT KUMAR AGRAWAL  
 B. Arch., A.I.A.  
 Reg. No. CA/81/10098  
 ARCHITECT SL. NO. - 3214  
 SIGNATURE OF ARCHITECT

SANJAY KUMAR DEUBEY  
 B. Engg., A.I.E.E.  
 Reg. No. CE/85/14098  
 ARCHITECT SL. NO. - 3214  
 SIGNATURE OF ARCHITECT

**TITLE :**  
 GROUND FLOOR PLAN 1ST FLOOR PLAN TYP FLOOR PLAN (2ND TO 14TH), ROOF PLAN, PART PLAN OF O.H.W.R.-2 & 1  
 BLOCK - 2B

**PROJECT :**  
 PROPOSED ADDITION OF 4 NOS. RESIDENTIAL BLOCKS (NOS. (G-IV) STORED NAMELY - 5 & 6 AND 2 NOS. (G-III) STORED NAMELY - 3B & 3C) AND 1 NO. (G-III) STORED COMMERCIAL BLOCK WITH REVISED OF 7 NOS. BLOCKS 1B NOS. (G-III) STORED NAMELY - 1E, 1F, 1G, 1H, 1I AND 1 NO. (G-III) STORED NAMELY - 1A, 1B, 1C, 1D, 2A, 2B, 2D AND 1 NO. (G-III) STORED NAMELY - 2C UNDER CONSTRUCTION WITH REFERENCE TO THE APPROVED CONSTRUCTION PERMIT PERMISSION NO. - 2522PK/HS/DATED 11/04/16 AND OUT OF 6 NOS. SANCTIONED BLOCKS, 4 NOS. BLOCKS (NAMELY - 1B, 1C, 1D & 2A) HAS BEEN OBTAINED OCCUPANCY CERTIFICATE ON 05.04.2016. D.C. NO. - BALCHAKRAI - SAMMILANITA-24 PARGANAS IN RESIDENTIAL COMPLEX AT MOUZA - PATULIA, R.S. DAG NOS. - 696 (P), 697, 698, 699, 700, 737 (P), 743, 744 (P), 749, 750, 754, 755, 756, 757, 758, 759, 760, 761, 762, 766 (P), 768, 769, 770, 771, 772, 773, 774, 776, 777, 778, 779, 780, 781, 782, 786 (P), 787, 788, 789, 790, 791, 792, 793, 794, 795, 796, 797, 798, 799, 800, 801, 802, 803, 804, 805, 806, 807, 808, 809, 810, 811, 812, 813, 814, 815, 816, 817, 818, 819, 820, 821, 822, 823, 824, 825, 826, 827, 828, 829, 830, 831, 832, 833, 834, 835, 836, 837, 838, 839, 840, 841, 842, 843, 844, 845, 846, 847, 848, 849, 850, 851, 852, 853, 854, 855, 856, 857, 858, 859, 860, 861, 862, 863, 864, 865, 866, 867, 868, 869, 870, 871, 872, 873, 874, 875, 876, 877, 878, 879, 880, 881, 882, 883, 884, 885, 886, 887, 888, 889, 890, 891, 892, 893, 894, 895, 896, 897, 898, 899, 900, 901, 902, 903, 904, 905, 906, 907, 908, 909, 910, 911, 912, 913, 914, 915, 916, 917, 918, 919, 920, 921, 922, 923, 924, 925, 926, 927, 928, 929, 930, 931, 932, 933, 934, 935, 936, 937, 938, 939, 940, 941, 942, 943, 944, 945, 946, 947, 948, 949, 950, 951, 952, 953, 954, 955, 956, 957, 958, 959, 960, 961, 962, 963, 964, 965, 966, 967, 968, 969, 970, 971, 972, 973, 974, 975, 976, 977, 978, 979, 980, 981, 982, 983, 984, 985, 986, 987, 988, 989, 990, 991, 992, 993, 994, 995, 996, 997, 998, 999, 1000.

**ARCHITECTS**  
 AGRAWAL & AGRAWAL  
 BARODA & KOLKATA

**SCALE :** 1:100  
**DATE :** 15.07.19  
**DEALT :** SATAPA  
**CHECKED :**

**SIGN OF OWNER :**