

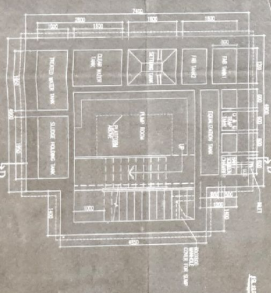

PLAN OF TOWARDS TREATMENT PLANT & BINDER ROOM (E.T.V. 4.50)
SCALE: 1:50



NO.	DESCRIPTION	QTY.	UNIT	REMARKS
1	CEMENT CONCRETE	100	M ³	
2	BRICKS	1000	NOS.	
3	ROOFING SHEET	100	M ²	
4	STEEL JOIST	100	M	
5	WOODEN PLANK	100	M ²	
6	WATER TIGHTING	100	M ²	
7	PAINT	100	LITERS	
8	LABOUR	100	MAN-DAYS	

NOTES:
1. ALL DIMENSIONS ARE IN METERS.
2. FINISHES ARE AS SHOWN.
3. REFER TO SPECIFICATIONS FOR MATERIALS.
4. CONSULT ARCHITECT FOR DETAILS.

LOCATION PLAN
SCALE: 1:500

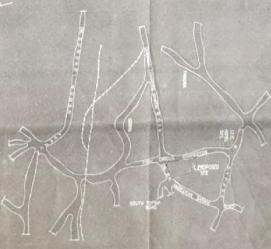

PLAN OF TOWARDS BINDER ROOM
SCALE: 1:50

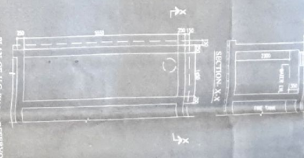

GENERAL NOTES:
1. ALL DIMENSIONS ARE IN METERS.
2. FINISHES ARE AS SHOWN.
3. REFER TO SPECIFICATIONS FOR MATERIALS.
4. CONSULT ARCHITECT FOR DETAILS.
5. THE WORK SHALL BE EXECUTED IN ACCORDANCE WITH THE SPECIFICATIONS AND STANDARDS OF THE GOVERNMENT OF KARNATAKA.
6. THE CONTRACTOR SHALL BE RESPONSIBLE FOR OBTAINING ALL NECESSARY PERMITS AND APPROVALS FROM THE LOCAL AUTHORITIES.
7. THE CONTRACTOR SHALL MAINTAIN ACCESS TO ALL ADJACENT PROPERTIES AT ALL TIMES.
8. THE CONTRACTOR SHALL BE RESPONSIBLE FOR THE PROTECTION OF ALL UTILITIES AND STRUCTURES EXISTING ON THE SITE.
9. THE CONTRACTOR SHALL MAINTAIN A NEAT AND ORDERLY WORK SITE AT ALL TIMES.
10. THE CONTRACTOR SHALL BE RESPONSIBLE FOR THE DISPOSAL OF ALL WASTE MATERIALS AND DEBRIS.
11. THE CONTRACTOR SHALL BE RESPONSIBLE FOR THE SAFETY OF ALL WORKERS AND THE PUBLIC.
12. THE CONTRACTOR SHALL BE RESPONSIBLE FOR THE PROTECTION OF THE ENVIRONMENT.
13. THE CONTRACTOR SHALL BE RESPONSIBLE FOR THE PROTECTION OF ALL ADJACENT PROPERTIES.
14. THE CONTRACTOR SHALL BE RESPONSIBLE FOR THE PROTECTION OF ALL UTILITIES AND STRUCTURES EXISTING ON THE SITE.
15. THE CONTRACTOR SHALL MAINTAIN A NEAT AND ORDERLY WORK SITE AT ALL TIMES.
16. THE CONTRACTOR SHALL BE RESPONSIBLE FOR THE DISPOSAL OF ALL WASTE MATERIALS AND DEBRIS.
17. THE CONTRACTOR SHALL BE RESPONSIBLE FOR THE SAFETY OF ALL WORKERS AND THE PUBLIC.
18. THE CONTRACTOR SHALL BE RESPONSIBLE FOR THE PROTECTION OF THE ENVIRONMENT.
19. THE CONTRACTOR SHALL BE RESPONSIBLE FOR THE PROTECTION OF ALL ADJACENT PROPERTIES.
20. THE CONTRACTOR SHALL BE RESPONSIBLE FOR THE PROTECTION OF ALL UTILITIES AND STRUCTURES EXISTING ON THE SITE.

AGRAWAL & AGRAWAL
ARCHITECTS
BANGALORE
KARNATAKA

PARTY'S COPY

KOLKATA MUNICIPAL CORPORATION
PLANS APPROVED UNDER SECTIONS 24 & 25 of
K.M.C. BUILDING RULES, 2009
By D.G.(Bldg) Dy. Commr. Ex. Engr.
ON 22.11.2011
B.P. No. 2381/10BR. 16722
Assistant Engineer Ex. Engr. (Civil)
Br. No. 367

This Plan is to be Treated As Part
And Parcel And Compulsions To
B.S. Plan No. 2012/10/10/10/10
Dated 25.11.2011
Ex. Engineer (CB)
Br. No. 367

OFFICE OF THE EXECUTIVE ENGINEER
BUILDING BORDERS-II
DATE 17.11
THE KOLKATA MUNICIPAL CORPORATION