

1. ALL DIMENSIONS ARE IN MM UNLESS OTHERWISE MENTIONED.
2. THE USER, BEFORE TAKING THE APPROVAL, IS SO DESIRED THAT IT IS CAPABLE OF TAKING THE LOAD OF HEAVY VEHICLES LIKE FIRE ENGINE ETC.
3. ALL EXTERNAL WALLS ARE 300 THK. R.C. WALL & INTERNAL WALLS ARE 225 / 250 THK. UNLESS OTHERWISE MENTIONED.
4. ALL AVAILION INFORMATION OF NEAREST NEARBY FIRE SERVICES.
5. EXISTING STREET INLET POINTS VERIFIED AT SITE.
6. G.L. 30.00 IS FLUSH WITH THE CROWN OF THE ROAD LEVEL.

ASPS DEVELOPERS LLP  
*Asps Developers LLP*  
 CONSTITUTED ATTORNEY

**SIGNATURE OF OWNER**  
**CERTIFICATE OF GEO-TECHNICAL ENGINEER**  
 IT IS CERTIFIED THAT THE COMPREHENSIVE GEO-TECHNICAL REPORT FOR DESIGN AND CALCULATION OF THE FOUNDATION BY ANALYZING THE SAMPLE FOR ESTIMATING THE BEARING CAPACITY OF THE SOIL ON WHICH FOUNDATION OF THE STRUCTURE WILL BE CONSTRUCTED. I SHALL ALSO CHECK THE NATURE OF THE SOIL AFTER EXCAVATION AT SITE SO THAT FOUNDATION IS EXTENDED UP TO APPROPRIATE DEPTH THAT HAS BEEN PROPOSED IN THE GEO-TECHNICAL REPORT.

For. C. A. Testina Company Pvt. Ltd.  
 Geotechnical Consultant  
 Dr. T. N. Nayak, MD  
 BE (Civil), Ph. D. (Geotech)

**SIGNATURE OF STRUCTURAL ENGINEER**  
**CERTIFICATE OF STRUCTURAL ENGINEER**  
 CERTIFIED THAT THE STRUCTURAL DESIGN & DRAWINGS OF BOTH FOUNDATION & SUPER STRUCTURE OF THE BUILDING HAS BEEN MADE BY ME CONSIDERING ALL POSSIBLE LOADS INCLUDING THE SEISMIC LOAD AS PER THE NATIONAL BUILDING CODE OF INDIA & CERTIFIED THAT IT IS SAFE & STABLE IN ALL RESPECTS.

*Aravind*  
 Aravind  
 P. N. S. CARVALA  
 P.E. (CIVIL), I.E. (STR)  
 G. ENG. MASTRUCT. E. (INDIA)  
 I.M.E. (INDIA)  
 I.M.E. (INDIA)  
 I.M.E. (INDIA)  
 CLASS. I, E.S. No. 177

**SIGNATURE OF ST. ENGR**  
**CERTIFICATE OF ST. ENGR**  
 THE LB.A. HAS CERTIFIED ON THE PLAN ITSELF WITH FULL RESPONSIBILITY THAT THE BUILDING PLAN HAS BEEN DRAWN UP AS PER PROVISION OF K.M.C. BLDG. RULES 2009. AS AMENDED FROM TIME TO TIME AND THAT THE SITE CONDITION INCLUDING THE NATURE OF THE SLEEPING ROAD CONFIRM WITH THE PLAN AND IS A BUILDABLE SITE AND NOT A TANK OR A FILLED UP TANK.

Rakumar Agarwal  
 Architect  
 Member of Council 1990  
 Architecture CA 1947/1990

**SIGNATURE OF ARCHITECT**  
**TITLE**  
 1ST & 2ND FLOOR LVL G.A.

**PROJECT**  
 PROPOSED PLAN OF G+2X11 (86.4 M. HT) STORED RESIDENTIAL BUILDING AT PRE NO. 45, CHRISTOPHER ROAD, WARD NO. 58, BOROUGH-VII, P.S. TANGRA, KOLKATA - 700046.

**CIVIL AND STRUCTURAL CONSULTANT:**  
**M.N. CONSULTANTS (Pvt.) Ltd.**

ISO 9001-2008 CERTIFIED  
 MNC House  
 1516, Rajbanga Main Road,  
 Kolkata - 700 107

**ARCHITECT**  
**RAJ AGRawal & ASSOCIATES**  
 88, ROYD STREET, CALCUTA - 16

NO. 100  
 DATE: 10-03-2016  
 SCALE: 1:1000  
 DWG. NO.: CORR-COM-SDR-01-01

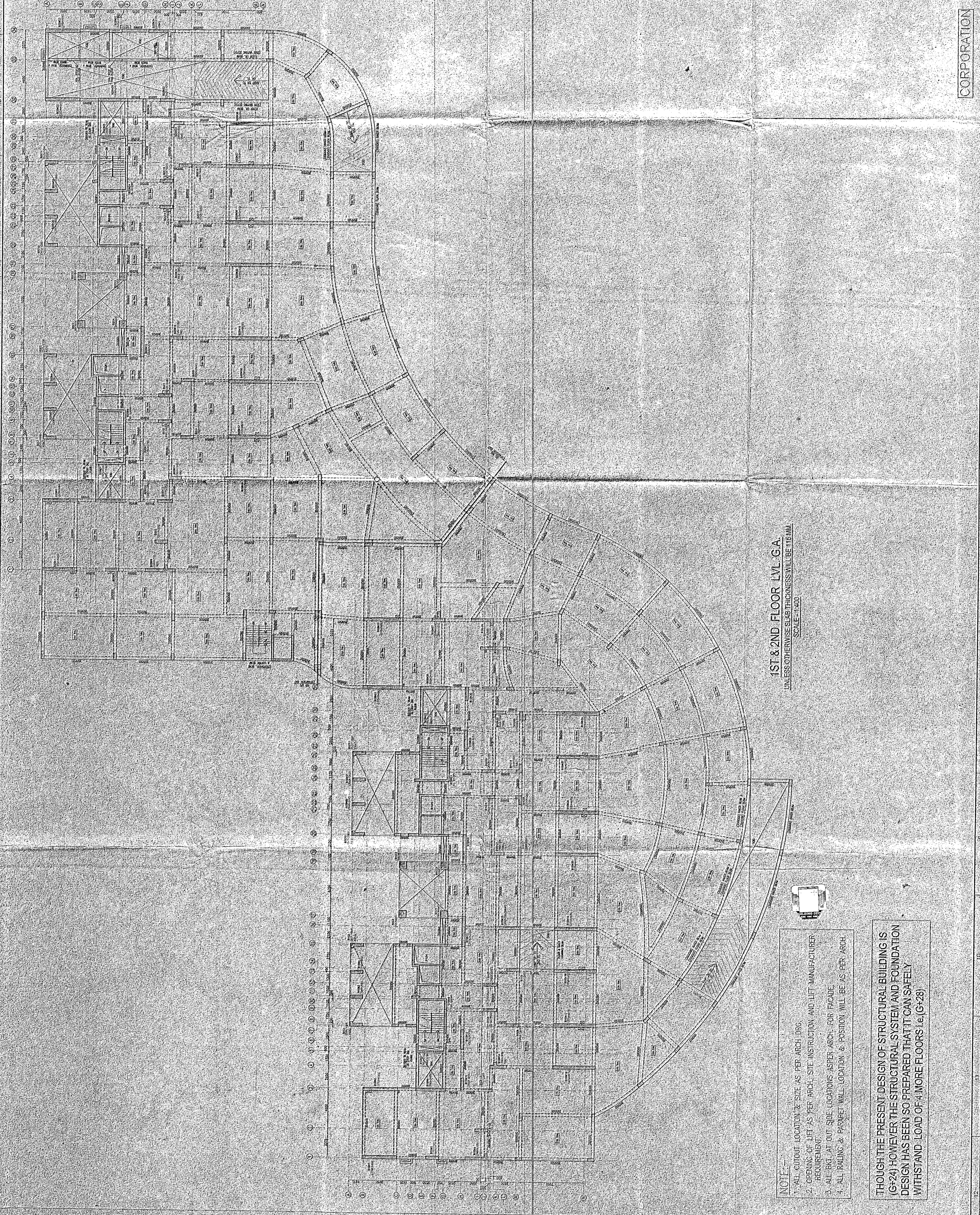

**1ST & 2ND FLOOR LVL G.A.**  
 UNLESS OTHERWISE SLAB THICKNESS WILL BE 115 MM.  
 SCALE: 1:1000

- NOTE-**
1. ALL OUTCUT LOCATION & SIZE AS PER ARCH. DRG.
  2. OPENING OF LIFT AS PER ARCH. SITE INSTRUCTION AND LIFT MANUFACTURER REQUIREMENT.
  3. ALL ENCL. AT OUT SIDE LOCATIONS AS PER ARCH. FOR FACADE.
  4. ALL TRAILING & PARAPET WALL LOCATION & POSITION WILL BE AS PER ARCH.

THOUGH THE PRESENT DESIGN OF STRUCTURAL BUILDING IS (G+24) HOWEVER THE STRUCTURAL SYSTEM AND FOUNDATION DESIGN HAS BEEN SO PREPARED THAT IT CAN SAFELY WITHSTAND LOAD OF 4 MORE FLOORS (i.e. (G+28))