

14.5 M WIDE ROAD

15 M WIDE ROAD
NEPALGANGE ROAD

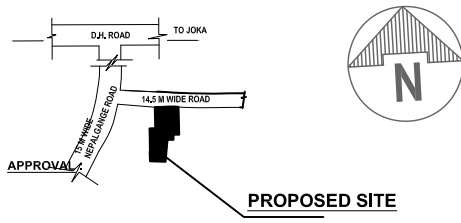
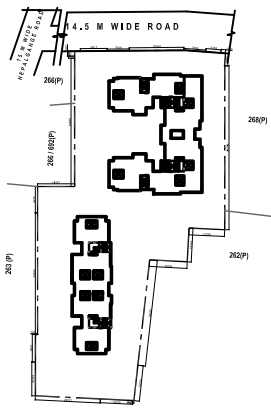
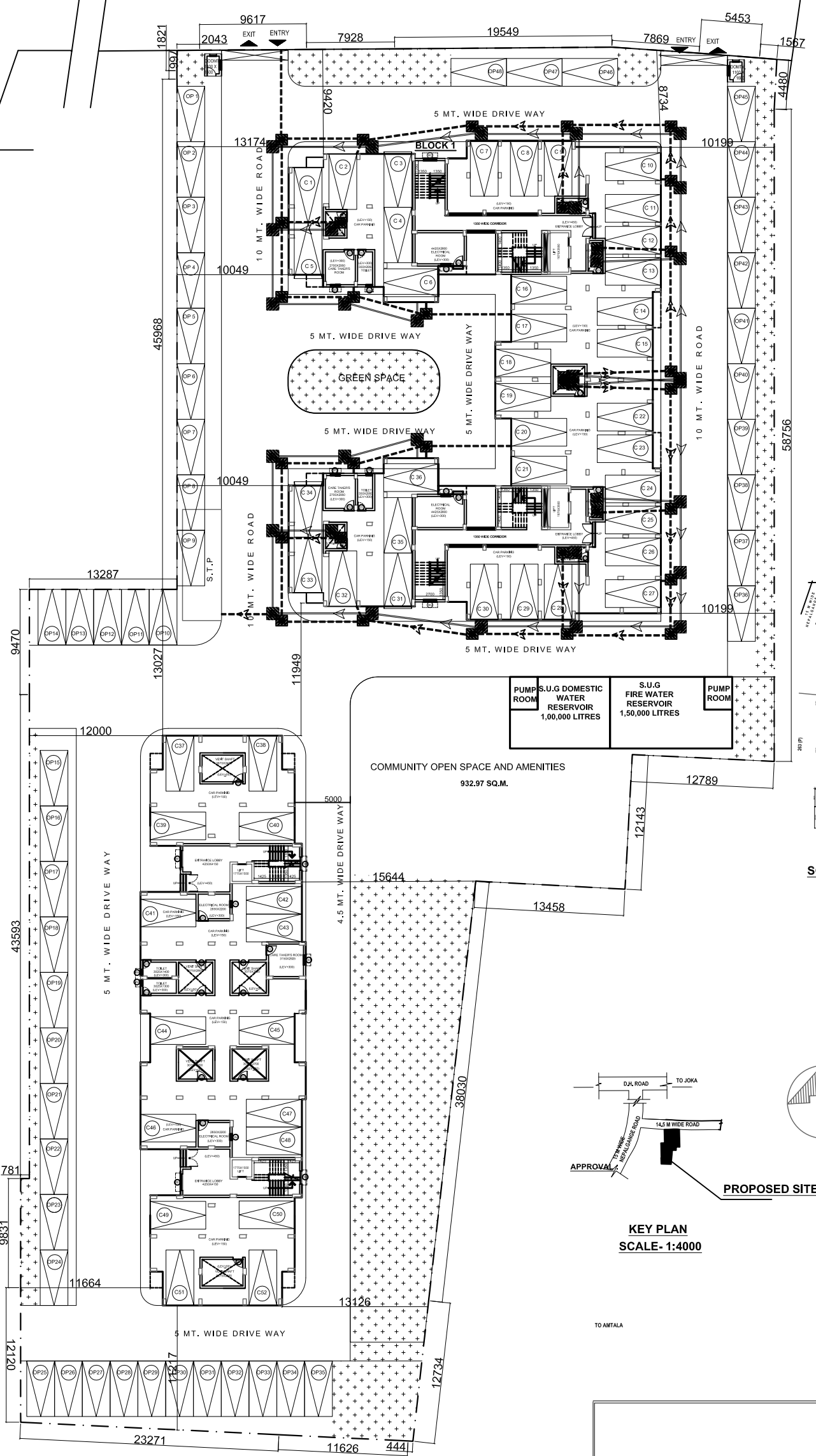

LANDSCAPE AREA=999.689 SQ. MT.

WINDOWS		DOOR	
MARKED	UNMARKED	MARKED	UNMARKED
W1	1000	D1	1000
W2	1200	D2	1200
W3	800	D3	800
W4	800	D4	800
W5	1000	D5	1000
W6	1000	D6	1000
W7	1000	D7	1000
W8	1000	D8	1000

PROPOSED G+X STORIED RESIDENTIAL COMPLEX AT R.S. DAG NO. -261,262 (P), 266 (P), 266/692(P), 267/705, 267(P) AND 268(P), MOUZA AMGACHIA, J.L. NO - 93, UNDER P.S. BISHNUPUR, DIST - SOUTH 24 PARGANAS, LOCAL LIMIT : AMGACHHIA GRAM PANCHAYET.

I CERTIFY THAT ALL THE ARCHITECTURAL DRAWINGS OF THE PROJECT AT R.S. DAG NO. -261,262 (P), 266 (P), 266/692(P), 267/705, 267(P) AND 268(P), MOUZA AMGACHIA, J.L. NO - 93, UNDER P.S. BISHNUPUR, DIST - SOUTH 24 PARGANAS, LOCAL LIMIT : AMGACHHIA GRAM PANCHAYET., HAVE BEEN PREPARED BY ME COMPLYING WITH THE PROVISIONS OF THE NATIONAL BUILDING AND THE WEST BENGAL MUNICIPAL BUILDING RULES, NO SUCH WRONG AND INCORRECT INFORMATION HAS BEEN FURNISHED BY ME INCLUDING AREA CALCULATION CHARTS IN THIS DRAWINGS AND NO VIOLATION OF THE PROVISIONS OF THESE RULES WILL BE FOUND IN ANY OF THE DRAWINGS AND DOCUMENTS, SUBMITTED TO THE SANCTIONING AUTHORITY FOR OBTAINING SANCTIONS.

[Signature]
AMITAV BISWAS
Chartered Architect
CA/2010/47702

Signature of Architect
Amitav Biswas
PRAKALPA™
145, NANI GOPAL ROY CHOWDHURY AVENUE,
MEZZANINE & 2ND FLOOR, KOLKATA - 700 014
T: 033 64507757, WEB SITE : www.prakalpa.in
E-MAIL : prakalpa.arch@gmail.com

I CERTIFY THAT THE STRUCTURAL DRAWING AND DESIGN OF BOTH THE FOUNDATION AND SUPERSTRUCTURE OF THE BUILDING/BUILDINGS HAS BEEN MADE CONSIDERING THE SOIL TEST REPORT (AS PER THESE RULES AND REGULATIONS MADE UNDER THE ACT) AND ALSO CONSIDERING ALL POSSIBLE LOADS, SEISMIC LOAD AND THE MOMENTS GENERATED BY THE PROPOSED STRUCTURE AS PER CURRENT CODES, THE BUREAU OF INDIAN STANDARD AND NATIONAL BUILDING CODE OF INDIA AND CERTIFY THAT IT IS SAFE AND STABLE IN ALL RESPECT UP TO G+X STORY STORES AND THESE PROVISIONS SHALL BE ADHERED TO DURING THE CONSTRUCTION.

.....
SIGNATURE OF THE STRUCTURAL ENGINEER

IT IS CERTIFIED THAT THE COMPREHENSIVE GEO-TECHNICAL REPORT ON SOIL INVESTIGATION HAS BEEN PREPARED BY ME FOR DESIGN AND CALCULATION OF THE FOUNDATION BY ANALYZING THE SOIL SAMPLES FOR ESTIMATING THE BEARING CAPACITY OF THE SOIL ON WHICH FOUNDATION OF THE STRUCTURE WILL BE CONSTRUCTED. I SHALL ALSO CHECK THE NATURE OF THE SOIL AFTER EXCAVATION AT SITE SO THAT FOUNDATION IS EXTENDED UP TO THE APPROPRIATE DEPTH THAT HAS BEEN PROPOSED IN THE GEO-TECHNICAL REPORT.

.....
SIGNATURE OF THE STRUCTURAL ENGINEER

.....
SIGNATURE OF THE OWNER

TITLE :
LANDSCAPE

PRAKALPA™
145, NANI GOPAL ROY CHOWDHURY AVENUE,
MEZZANINE & 2ND FLOOR, KOLKATA - 700 014
T: 033 64507757, WEB SITE : www.prakalpa.in
E-MAIL : prakalpa.arch@gmail.com

DRAWN BY :	ALPANA
CHECKED BY :	ATANJ. C
APPROVED BY :	
SCALE :	1 : 150
SUBMISSION DRAWING	
DRAWING NO.	REVISION NO.
0076BS011SDG - AR - LAND/02	