

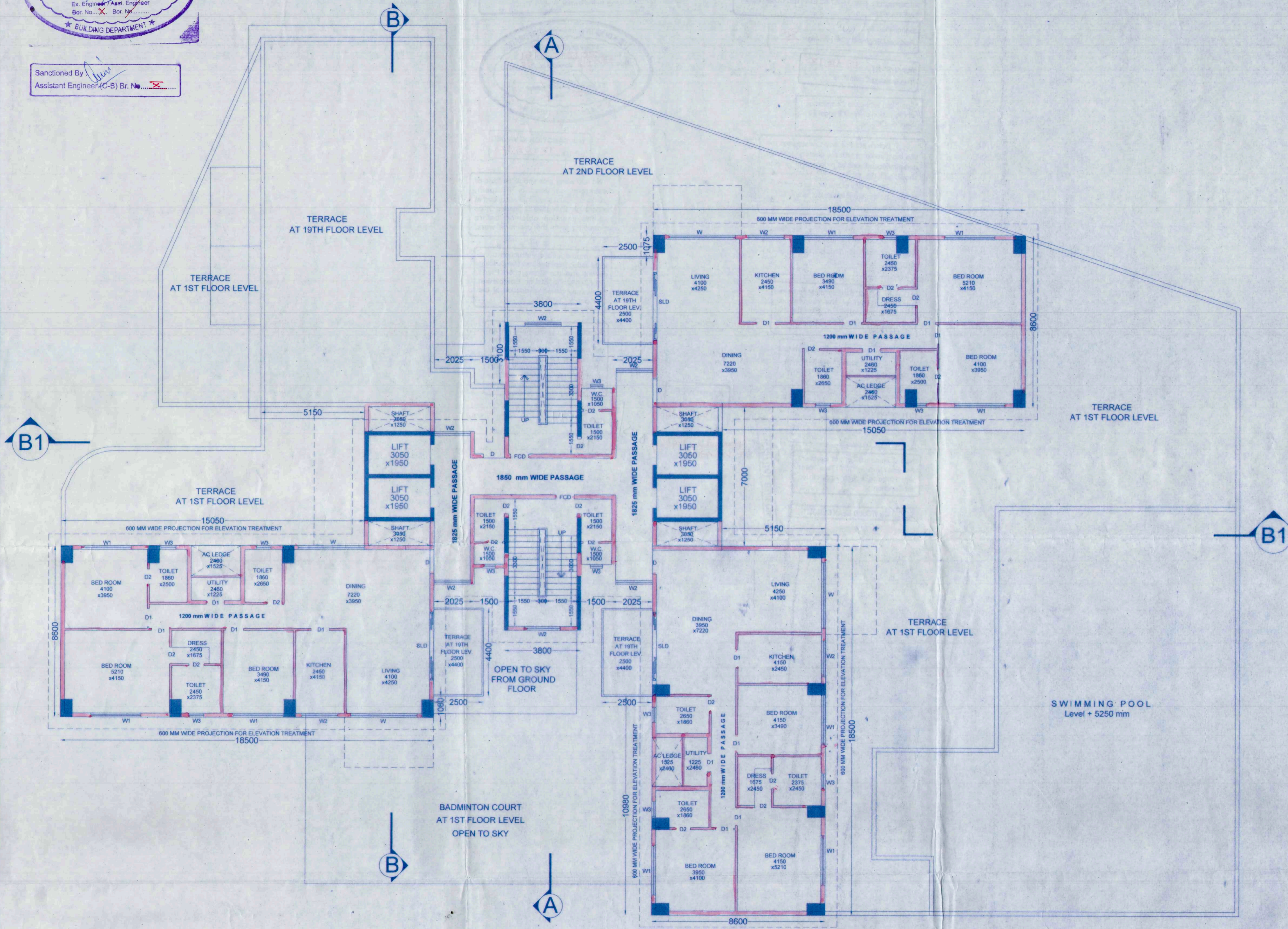

Sanctioned By
Assistant Engineer (C-B) Br. No. 18



WING -1
19TH FLOOR PLAN
SCALE- 1:100

For IDEAL REAL ESTATES PVT. LTD.
S.K. HASTINGS
DIRECTOR

Signature of owner :

THE STRUCTURAL DESIGNS DRAWINGS OF BOTH FOUNDATION AND SUPERSTRUCTURE OF THE BUILDING HAS BEEN MADE BY ME CONSIDERING ALL POSSIBLE LOADS INCLUDING THE SEISMIC LOAD AS PER THE NATIONAL BUILDING CODE OF INDIA AND CERTIFIED THAT IT IS SAFE AND STABLE IN ALL RESPECTS.

C.P. KHANNA
CHANDI PRASAD KHANNA
BE (Civil), ME (Struct), MIE (India)
EST-172

Signature of Structural Engineer :

THE BUILDING HAS BEEN DRAWN UP AS PER THE PROVISION OF THE K.M.C. BUILDING RULES 2006 AND THAT THE SITE CONDITIONS INCLUDING THE WIDTH OF THE ABUTTING K.M.C. ROAD CONFIRM WITH THE PLAN AND THAT IT IS A BUILDABLE SITE AND NOT A TANK OR FILLED UP TANK. THE PLOT IS LYING VACANT AND DEMARCATED BY BRICK BUILT BOUNDARY WALL.

HARSH SANON
COUNCIL OF ARCHITECTURE
REGISTRATION NO. CA/90/13556

Harsh Sanon
HARSH SANON
COUNCIL OF ARCHITECTURE
REGISTRATION NO. CA/90/13556

Signature of Architect :

PROJECT :
PROPOSAL FOR ADDITION, ALTERATION PLAN OF 2B-G+21 STORIED RESIDENTIAL BUILDING, (HEIGHT 79.5 MT) BY SUPERCEEDING THE OLD SANCTIONED PLAN VIDE B.P NO : 2011100306, DATED: 13.03.2013. AT PREMISES NO: 21, PRAMATHA CHOWDHURY SARANI, KOLKATA - 700 053, W -81, BOROUGH - X.

JOB NO.	TITLE : WING- 1			
DRG NO. CA/07A	19 TH FLOOR PLAN			
REVISION NO.	SCALE As mentioned	DEALT BY Moumita	CHECKED Suvadip	DATE 15.04.2011
SANON SEN & ASSOCIATES (P) LTD.				
S, RUSSEL STREET, KOLKATA-700 071 PHONE:91-33-22264579, 22278068, 22172505; FAX:2226 6917 www.sanonsen.com				
				SANC/JAN/12

