

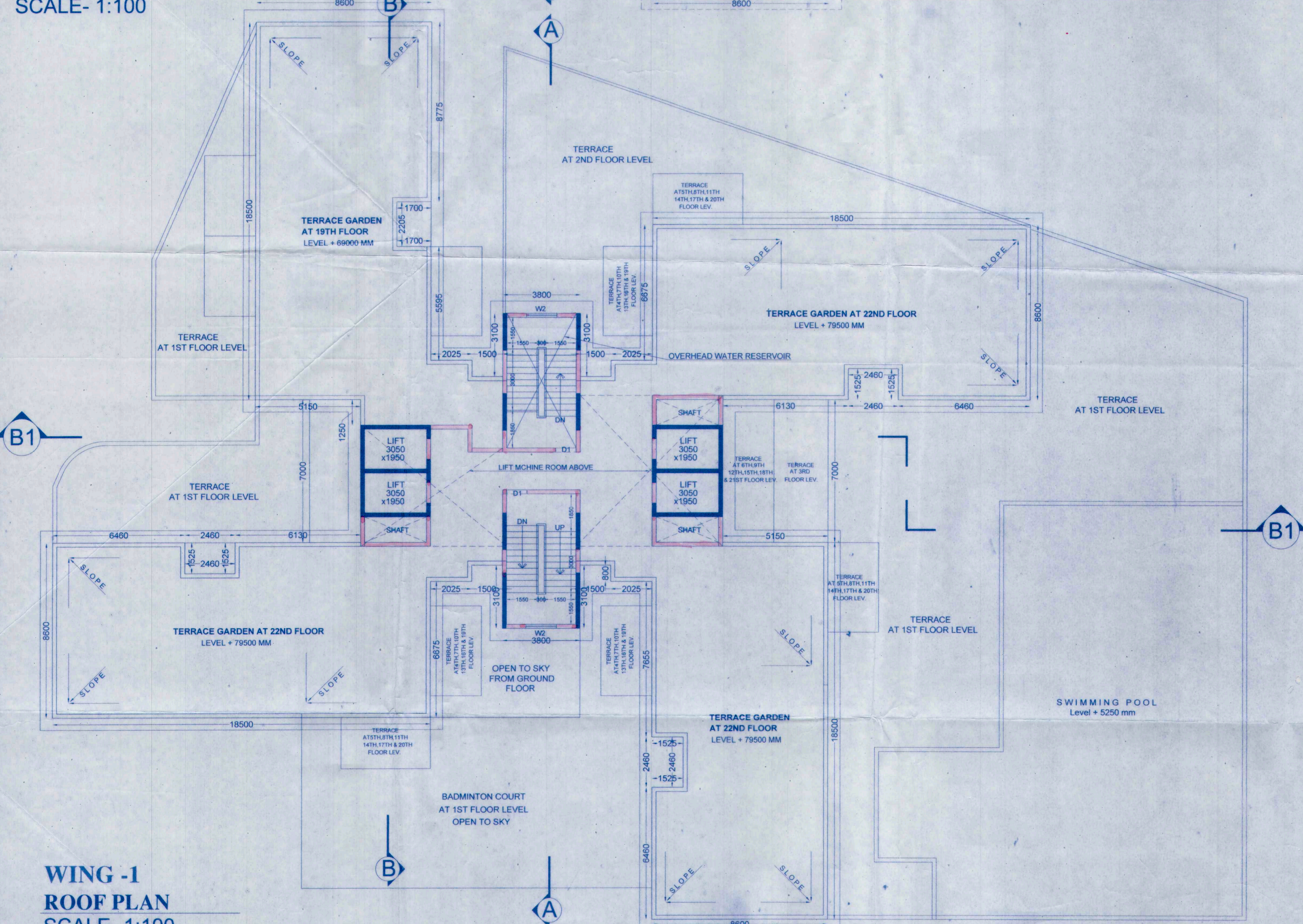

Sanctioned By
Assistant Engineer (C-B) Br. No. X

WING - 1
21ST FLOOR PLAN
SCALE - 1:100



WING - 1
ROOF PLAN
SCALE - 1:100

For IDEAL REAL ESTATES PVT. LTD. <i>S.K. Haldar</i> DIRECTOR	
Signature of owner :	
THE STRUCTURAL DESIGN DRAWINGS OF BOTH FOUNDATION AND SUPERSTRUCTURE OF THE BUILDING HAS BEEN MADE BY ME CONSIDERING ALL POSSIBLE LOADS INCLUDING THE SEISMIC LOAD AS PER THE NATIONAL BUILDING CODE OF INDIA AND CERTIFIED THAT IT IS SAFE AND STABLE IN ALL RESPECTS.	
<i>C. Khanna</i> CHANDI PRASAD KHANNA B.E. (CIVIL), M.E. (STRUCT.), MISE (IAGS) ESS-12	
Signature of Structural Engineer :	
THE BUILDING HAS BEEN DRAWN UP AS PER THE PROVISION OF THE K.M.C. BUILDING RULES 2009 AND THAT THE SITE CONDITIONS INCLUDING THE WIDTH OF THE ABUTTING K.M.C. ROAD CONFIRM WITH THE PLAN AND THAT IT IS A BUILDABLE SITE AND NOT A TANK OR FILLED UP TANK. THE PLOT IS LYING VACANT AND DEMARCATED BY BRICK BUILT BOUNDARY WALL.	
<i>Harsh Sanon</i> HARSH SANON COUNCIL OF ARCHITECTURE REGISTRATION NO. CA/90/13554	HARSH SANON COUNCIL OF ARCHITECTURE REGISTRATION NO. CA/90/13556
Signature of Architect :	
PROJECT : PROPOSAL FOR ADDITION, ALTERATION PLAN OF 2B+G+21 STORIED RESIDENTIAL BUILDING, (HEIGHT 79.5 MT) BY SUPERCEEDING THE OLD SANCTIONED PLAN VIDE B.P NO : 201100306, DATED: 13.03.2013, AT PREMISES NO: 21, PRAMATHA CHOWDHURY SARANI, KOLKATA - 700 053, W - 81, BOROUGH - X.	
JOB NO.	TITLE : WING - 1
DRG. NO. CA/08	21ST FLOOR PLAN & ROOF PLAN
REVISION NO.	SCALE: As mentioned
DEALT BY: Moutita	CHECKED: Suvadip
DATE: 15.04.2011	
SANON SEN & ASSOCIATES (P) LTD.	
5, RUSSEL STREET, KOLKATA-700 071 PHONE: 91-33-22264579, 22278068, 22172505; FAX: 2226 6917 www.sanonsen.com	
SANC/JAN/12	