



REAL ESTATE

MAA BHABATARINI UDYOG

Developer

38/2/A, A. C. Banerjee Road,
Ariadaha, Kolkata - 700056

Contact :
801-7070602 / 9874644551

LOCATION MAP OF PROPOSED G+III STORIED RESIDENTIAL BUILDING AT PREMISES NO.-17, K.P. MUKHERJEE ROAD, DAKSHINESWAR, KOLKATA-76, MOUZA-DAKSHINESWAR, WARD NO.-12, HOLDING NO.-559, C.S & R.S. DAG NO.-556, PLOT NO.-735, J.L. NO.-4, R.S. NO.-1, TOUZI NO.-222, KHATIAN NOS.-502,589,861,907,1571,2364, P.O.-DAKSHINESWAR, P.S.-BELGHARIA, DIST.-24 PGS(NORTH) UNDER KAMARHATI MUNICIPALITY.

AREA OF LAND = (0.0875 ACRE) = 05 KH.-05 CH.-00 SQ.FT.
= 355.48 SQM. = 3825 SQ.FT.

Latitude - 22.6618
Longitude - 88.3598

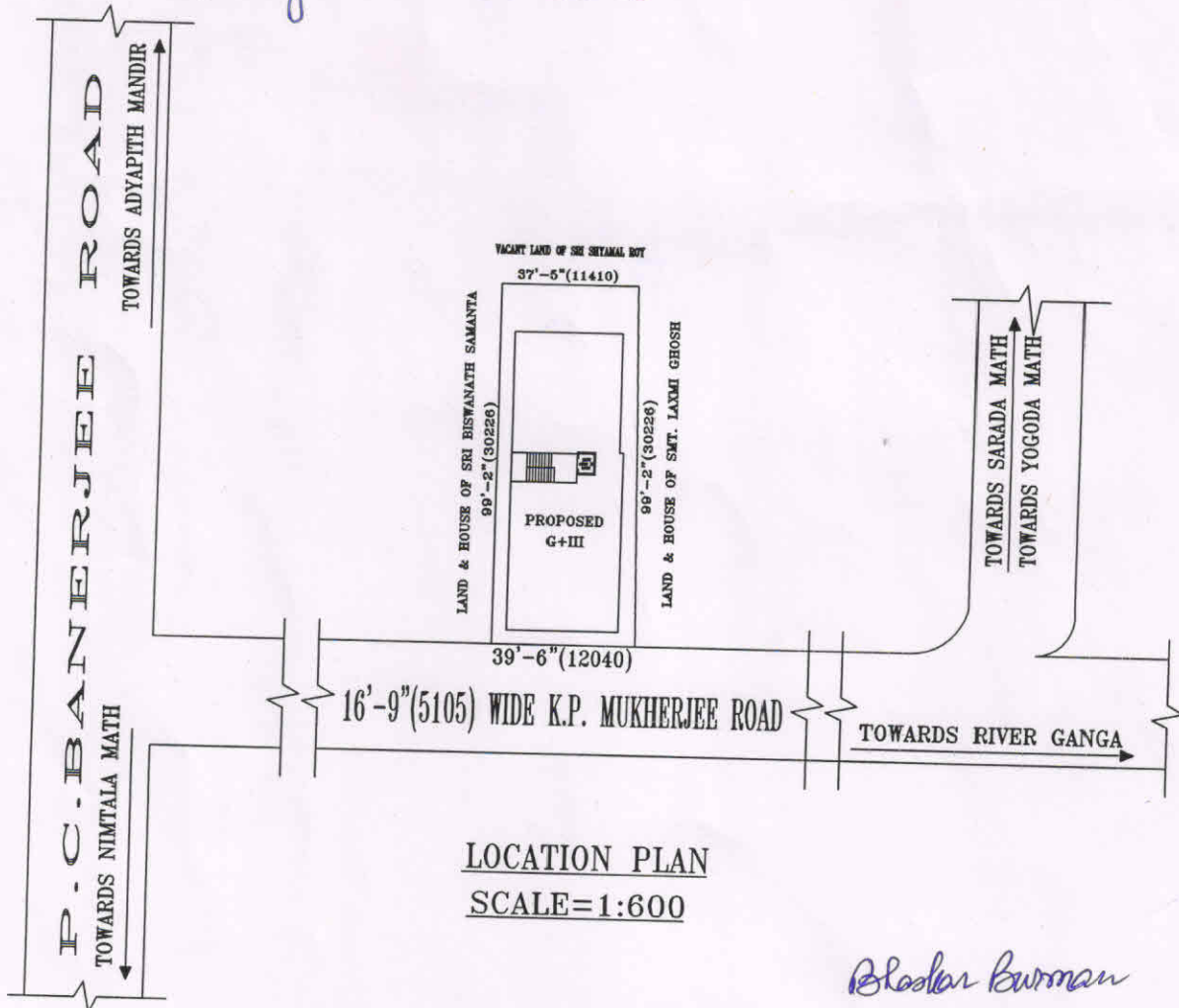

LOCATION PLAN
SCALE=1:600

Sourin Ghosh

Bhaskar Burman

BHASKAR BURMAN
D.C.E.

Engineer, Planner & Estimator
L.B.S. No. - B

15A, A. C. Paul Street, Ariadaha, Kol - 57
LIC No. - B-30 Year 19-20