

**ROOF PLAN**

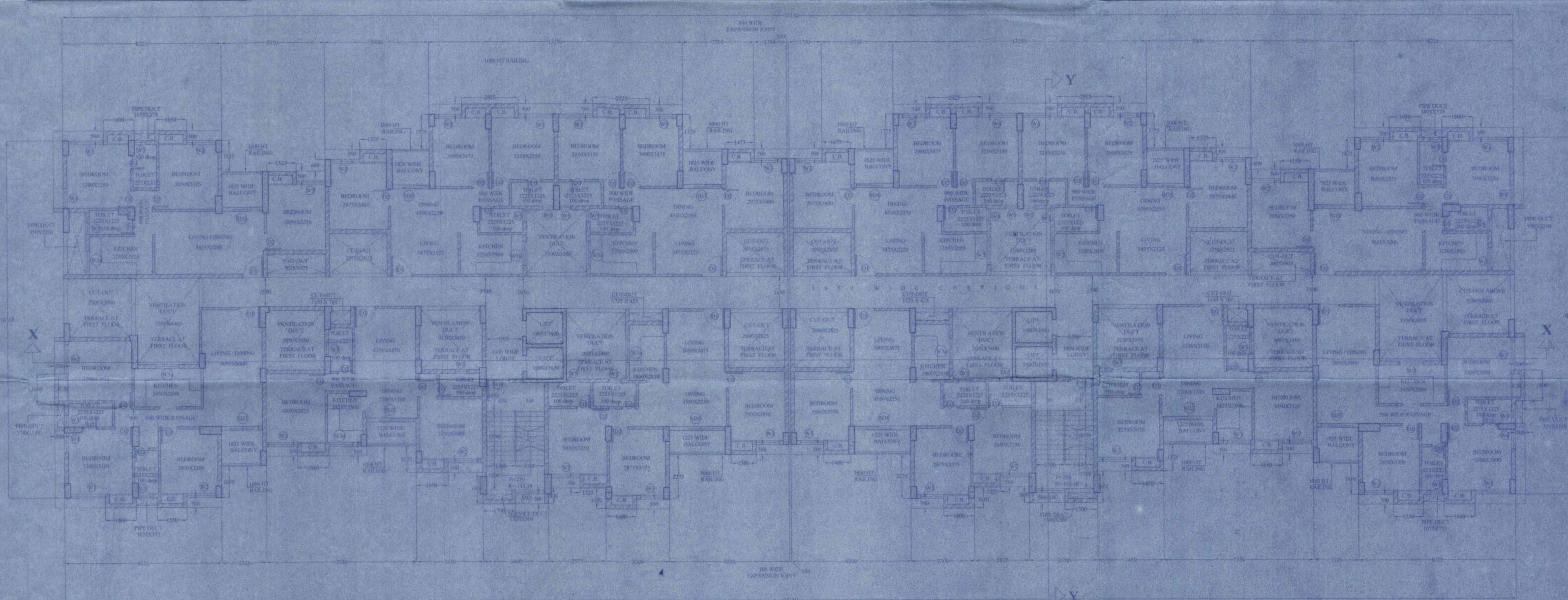

**TYPICAL PLAN OF 1ST-3RD FLOOR**

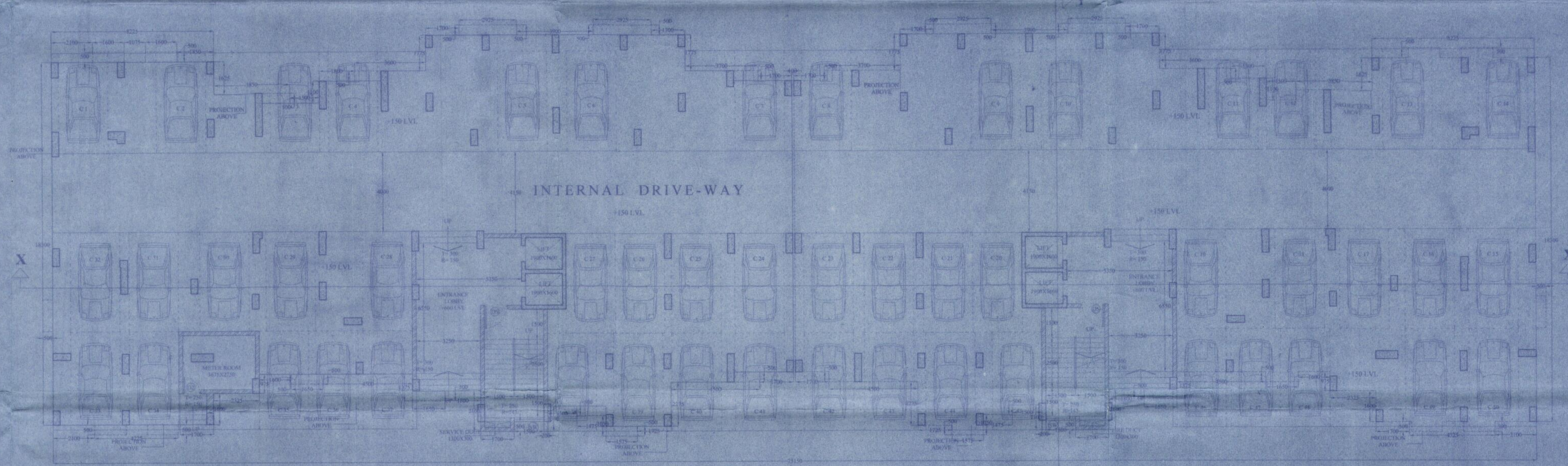

**GROUND FLOOR PLAN**

<p><b>FOR OFFICE USE</b></p> <p><b>PROPOSED G+III STORED RESIDENTIAL BUILDING</b></p>	<p><b>OWNER DETAIL</b></p> <p>Smart Vanija Private Limited represented by Vineet Bansal</p>	<p><b>LINE SCHEDULE</b></p> <p>MOLD - 300x300x100mm          PLASTER - 12mm          FINISH - 12mm          ...</p>	<p><b>NOTES</b></p> <ol style="list-style-type: none"> <li>1. ALL DIMENSIONS ARE IN METERS UNLESS OTHERWISE MENTIONED.</li> <li>2. ALL EXTERNAL WALLS ARE 200 THK. ALL INTERNAL WALLS ARE 100 THK. ALL 4 THK.</li> <li>3. ...</li> </ol>	<p><b>DOOR &amp; WINDOW SCHEDULE</b></p> <table border="1"> <thead> <tr> <th>NO.</th> <th>TYPE</th> <th>SIZE</th> <th>FINISH</th> </tr> </thead> <tbody> <tr> <td>01</td> <td>DOOR</td> <td>1000x2000</td> <td>WOOD</td> </tr> <tr> <td>02</td> <td>WINDOW</td> <td>1200x1500</td> <td>GLASS</td> </tr> </tbody> </table>	NO.	TYPE	SIZE	FINISH	01	DOOR	1000x2000	WOOD	02	WINDOW	1200x1500	GLASS	<p><b>DECLARATION OF OWNER</b></p> <p>I, the undersigned, being the owner of the above mentioned property, hereby declare that the above mentioned plans and specifications are true and correct and I have no objection in the construction of the building as per the above mentioned plans and specifications.</p> <p><b>SMART VANIJA PRIVATE LIMITED</b>          Vineet Bansal          Director</p>	<p><b>DECLARATION OF STRUCTURAL ENGINEER</b></p> <p>I, the undersigned, being a duly qualified and registered structural engineer, hereby declare that the above mentioned plans and specifications are true and correct and I have no objection in the construction of the building as per the above mentioned plans and specifications.</p> <p><b>Mahesh Kumar</b>          B.E., M.C.E. (Struct)          ESE - 1227 of CMC          ...</p>	<p><b>DECLARATION OF ARCHITECT</b></p> <p>I, the undersigned, being a duly qualified and registered architect, hereby declare that the above mentioned plans and specifications are true and correct and I have no objection in the construction of the building as per the above mentioned plans and specifications.</p> <p><b>MAHESH KUMAR ASSOCIATES</b>          37A, BAKER ROAD, 3RD FLOOR          ...</p>
NO.	TYPE	SIZE	FINISH																
01	DOOR	1000x2000	WOOD																
02	WINDOW	1200x1500	GLASS																