

No. M- 586/1(2) /HIDCO/ADMN-917/2006

To

1. M/s. Magus Estates & Hotels Pvt. Ltd.  
114, Dr. E Moses Road, Worli,  
Mumbai - 400 018
2. M/s Keppel Land Asia (Pte) Ltd.  
230, Pretoria Street, #  
14-01, Dugis Junction Towers,  
Singapore - 188024 "KLA"  
Fax: (65) 633 77 175

Sub: Revised area of land allotted for the residential purpose in New Town Kolkata vide letter no. 986/HIDCO/ADMN-917/2006 dated 27.02.2006.

Sir,

Please refer to your letter dated 7<sup>th</sup> September, 2006 for

- a) the revised surveyed plan showing the new boundary of the allotted site;
- b) a copy of the mouza map; and
- c) the respective land title deeds for the new strip of land

Attached are a copies of site plan with coordinates and plot plan on mouja map showing the revised site boundary with a total land area of 9.998 Ha (99983 Sq.m.) Copies of papers as to the title of HIDCO over the land will be supplied within the next 10 days.

In view that the land area of the allotted site has been revised to 9.998 Ha. the land price of the allotted site as per para 1 of our letter dated 27<sup>th</sup> February, 2006 (No. 986/HIDCO/ADMN-917/2006) will be revised proportionately based on final measurement.

Encl: As stated,

Yours faithfully,

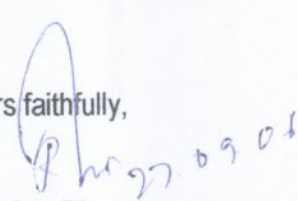
  
Managing Director

Dated :27.09.2006

No. M- 586/1(7)/HIDCO/Admn-917/2006

Copy forwarded for information and necessary action to:

1. Pr. Consultant, WBHIDCO Ltd.
2. DG (Engg.), WBHIDCO Ltd.
3. FA, WBHIDCO Ltd.
4. ED(F), WBHIDCO Ltd.
5. ED(EM), WBHIDCO Ltd.
6. Company Secretary, WBHIDCO Ltd.
7. GM (T & CP), WBHIDCO Ltd.

Managing Director

**WEST BENGAL HOUSING INFRASTRUCTURE DEVELOPMENT CORPORATION LTD.**

(A Govt. of West Bengal Undertaking)

Regd. Office : Salt Lake Stadium Complex, Gate No. 3, Sector III, Salt Lake, Kolkata-700 098  
Telephone : 2335-7166/7148, Fax : 2335-6677/ 0096, E-mail : housing@cal2.vsnl.net.in, Website: www.wbhidcoltd.com.  
New Town Office : 01, MAR, New Town, Kolkata-700156, Ph. 2367-3961, Fax : 2367-3962

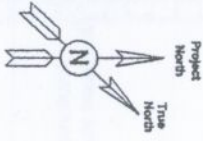

Magus Estate  
 Kepple Land  
 (Residential)  
 99983 Sq.M.  
 (9.998 Ha.)

Peripheral Canal

220 K.V Electric line



H.I.D.C.O LAND

Project Boundary

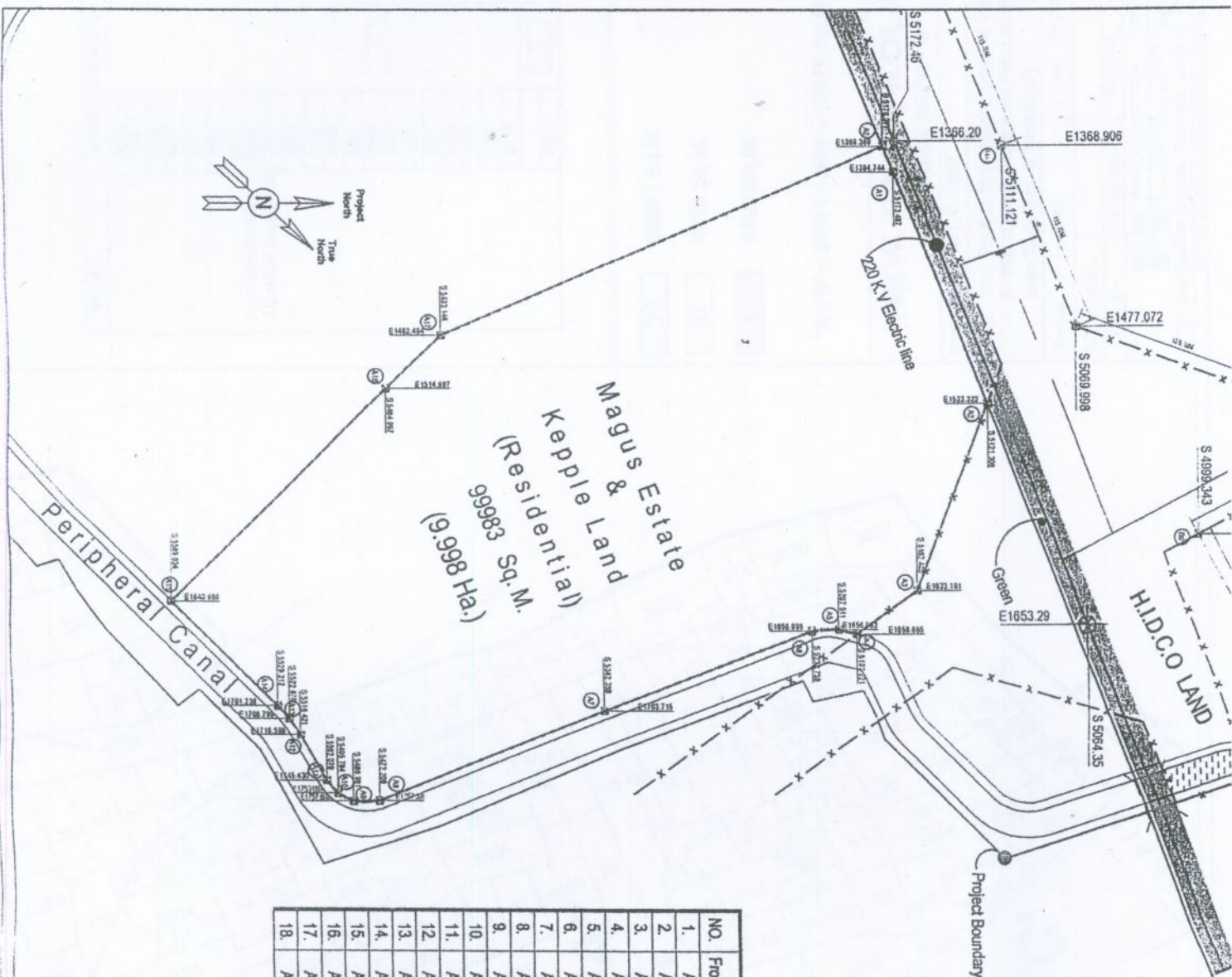
NO.	From St.	To St.	Length (m)
1.	A0	A1	16.43
2.	A1	A2	148.08
3.	A2	A3	117.30
4.	A3	A4	43.14
5.	A4	A5	10.62
6.	A5	A6	15.28
7.	A6	A7	128.43
8.	A7	A8	140.48
9.	A8	A9	14.78
10.	A9	A10	9.93
11.	A10	A11	9.89
12.	A11	A12	30.43
13.	A12	A13	11.63
14.	A13	A14	9.99
15.	A14	A15	85.12
16.	A15	A16	176.80
17.	A16	A17	45.29
18.	A17	A0	277.93



MOUZA	DAG NO.	AREA MKD.	REMARKS
PARTHARGHATA J.L. NO.36 Sheet No.3	3243		INCLUSION OF PART AREA
	3244		
	3245		
	3281		
	3517		
	3518		
	3546		
	3549		
	3551		
	3553		
	3555		
	3556		
	3558		
	3560		
	3561		
	3573		
	3574		
3575			
3577			
3578			
	3050		DELETION OF PART AREA

-  95081 Sq.M.
-  4898 Sq.M.
-  6098 Sq.M.

"A'+'B' = 95081+4898 = 99979 Sq.M. = 9.998 H<sub>z</sub>

## NEW TOWN, KOLKATA ACTION AREA - III

Drawing No. HIDCO/draft

Title: Plot Plan of M/S Magus Estate & Hotels Pvt. Ltd.  
& M/S Kepple Land Asia Pvt. Ltd. (Showing the  
area 'Deletion' & 'Inclusion')

Scale - 1:2000 Date: 05.09.2006

Drawn By: G.Pandey  
Architect Planner: S.O. (E.P.)  
G.M.(T&P)



Solt Lake Stadium Complex, Gate No.3, Sector III, Solt Lake, Cal-91.  
CAD FILE NO. F.VA. III. Gobiindo\KEPPLE\_mouza.dwg

