

SITE PLAN SHOWS THE LAND AT HOLDING NO.- 118/83, BOSEPARA OF ... DAG NO.- 2496 & 2497; L.R. DAG NO.- 2496/3873 & 3869 UNDER KHATIAN NO.- 830; J.L.NO.-2; R.S. NO.- 18; TOUJI NO.- 145, 2998 & 1505; WARD NO.- 14; MOUJA, MUNICIPALITY & P.S.- KHARDAHA; DISTRICT- NORTH 24 PARGANAS.

AREA STATEMENTS:-

LAND AREA AT DAG NO.- 2496 = 22KA.- 2CH.- 22 SQ.FT.

LAND AREA AT DAG NO.- 2497 = 5KA.- 10CH.- 38 SQ.FT.

TOTAL LAND AREA = 27KA.- 13CH.- 15SQ.FT. (MORE OR LESS)

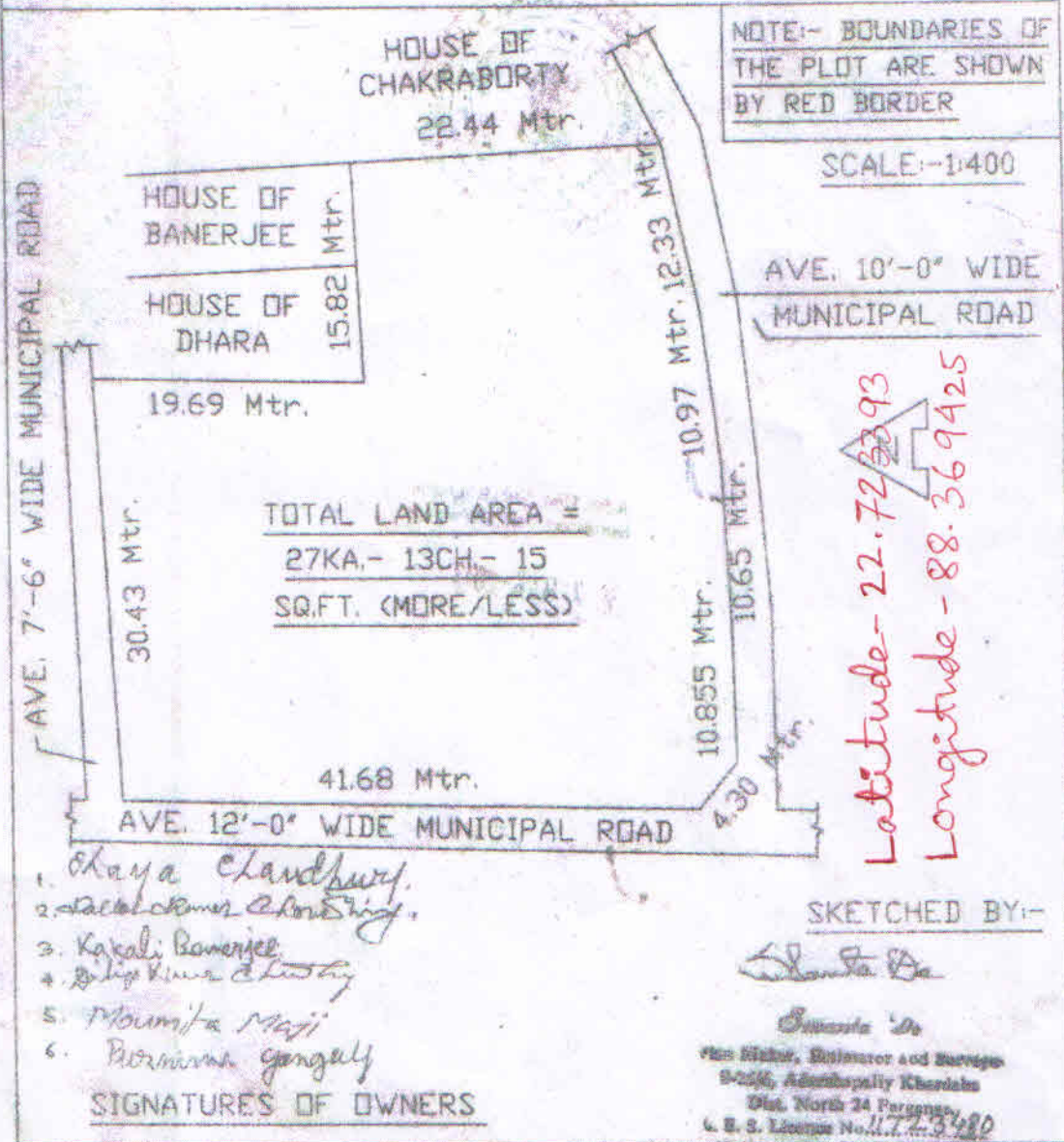

1. Shaya Chaudhuri.
2. Satish Kumar Choudhury.
3. Kankali Banerjee.
4. Bipin Kumar Choudhury.
5. Moumita Maji.
6. Prorinima Ganguly.

SIGNATURES OF OWNERS

ROY JOB ASSOCIATES MANagements PVT. LTD.

[Signature]
Director