

NOTES ON THE PLAN

1. THE FOUNDATION OF THE BUILDING SHALL BE AS PER THE SPECIFICATION.
2. THE FOUNDATION SHALL BE AS PER THE SPECIFICATION.
3. THE FOUNDATION SHALL BE AS PER THE SPECIFICATION.
4. THE FOUNDATION SHALL BE AS PER THE SPECIFICATION.
5. THE FOUNDATION SHALL BE AS PER THE SPECIFICATION.
6. THE FOUNDATION SHALL BE AS PER THE SPECIFICATION.
7. THE FOUNDATION SHALL BE AS PER THE SPECIFICATION.
8. THE FOUNDATION SHALL BE AS PER THE SPECIFICATION.
9. THE FOUNDATION SHALL BE AS PER THE SPECIFICATION.

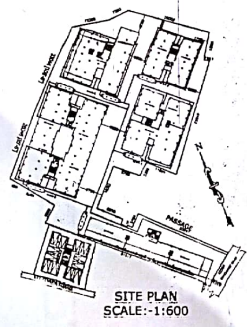
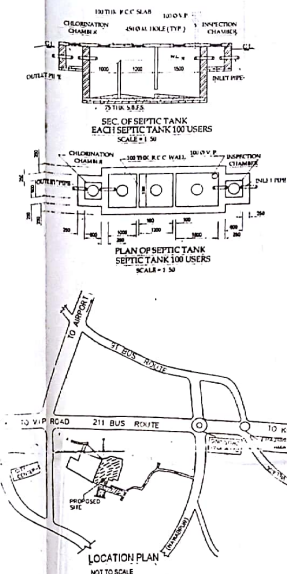

NAME OF THE OWNERS

1. BISWANATH ROY CHOWDHURY
2. MUKTINATH ROY CHOWDHURY
3. DILIP K. ROY CHOWDHURY
4. PRADIP ROY CHOWDHURY
5. MALAY ROY CHOWDHURY
6. KISHOR ROY CHOWDHURY
7. SHIKHA BARMAN ROY
8. NITAI CHANDRA DAS
9. SHOVON BHATTACHARYA

PROPOSED G+IV STORIED RESIDENTIAL BUILDING PLAN AT L.R.DAG NO:-1268

L.R. KHATTARNO:- 5635, 5637, 5638, 5639, 5640, 5641, 5642, 2629 & 5164, J.L.NO.-13, MUZA-RECKJOANI, DIST.-24 PGS(N), P.S. RAJARHAT WITHIN THE JURISDICTION OF RAJARHAT-BISHNUPUR 1 NO. GRAM PANCHAYET.

DETAILS OF AREA CALCULATION

TOTAL AREA OF LAND (AS PER DEED) 62.1211 HECTARE	= 449654 SQ.M
PERMISSIBLE GROUND COVER (G.C.) (5% OF 242754 SQ.M)	= 12137.71 SQ.M
PROPOSED GROUND COVER (G.C.) (5% OF 242754 SQ.M)	= 12137.71 SQ.M
PROPOSED GROUND FLOOR AREA (BLA+B+C+D+E+F)	= 118135.13 SQ.M
PROPOSED TYPICAL FLOOR AREA (BLA+B+C+D+E+F)	= 118135.13 SQ.M
PROPOSED TOTAL FLOOR AREA (BLA+B+C+D+E+F)	= 118135.13 SQ.M

GROUND FLOOR AREA OF BLOCK A

GROUND FLOOR AREA OF BLOCK A	= 31033.00 SQ.M
FIRST FLOOR AREA OF BLOCK A	= 31033.00 SQ.M
SECOND FLOOR AREA OF BLOCK A	= 31033.00 SQ.M
THIRD FLOOR AREA OF BLOCK A	= 31033.00 SQ.M
FOURTH FLOOR AREA OF BLOCK A	= 31033.00 SQ.M
TOTAL AREA OF BLOCK A	= 124135.00 SQ.M

GROUND FLOOR AREA OF BLOCK B

GROUND FLOOR AREA OF BLOCK B	= 31033.00 SQ.M
FIRST FLOOR AREA OF BLOCK B	= 31033.00 SQ.M
SECOND FLOOR AREA OF BLOCK B	= 31033.00 SQ.M
THIRD FLOOR AREA OF BLOCK B	= 31033.00 SQ.M
FOURTH FLOOR AREA OF BLOCK B	= 31033.00 SQ.M
TOTAL AREA OF BLOCK B	= 124135.00 SQ.M

GROUND FLOOR AREA OF BLOCK C

GROUND FLOOR AREA OF BLOCK C	= 31033.00 SQ.M
FIRST FLOOR AREA OF BLOCK C	= 31033.00 SQ.M
SECOND FLOOR AREA OF BLOCK C	= 31033.00 SQ.M
THIRD FLOOR AREA OF BLOCK C	= 31033.00 SQ.M
FOURTH FLOOR AREA OF BLOCK C	= 31033.00 SQ.M
TOTAL AREA OF BLOCK C	= 124135.00 SQ.M

GROUND FLOOR AREA OF BLOCK D

GROUND FLOOR AREA OF BLOCK D	= 31033.00 SQ.M
FIRST FLOOR AREA OF BLOCK D	= 31033.00 SQ.M
SECOND FLOOR AREA OF BLOCK D	= 31033.00 SQ.M
THIRD FLOOR AREA OF BLOCK D	= 31033.00 SQ.M
FOURTH FLOOR AREA OF BLOCK D	= 31033.00 SQ.M
TOTAL AREA OF BLOCK D	= 124135.00 SQ.M

GROUND FLOOR AREA OF BLOCK E

GROUND FLOOR AREA OF BLOCK E	= 31033.00 SQ.M
FIRST FLOOR AREA OF BLOCK E	= 31033.00 SQ.M
SECOND FLOOR AREA OF BLOCK E	= 31033.00 SQ.M
THIRD FLOOR AREA OF BLOCK E	= 31033.00 SQ.M
FOURTH FLOOR AREA OF BLOCK E	= 31033.00 SQ.M
TOTAL AREA OF BLOCK E	= 124135.00 SQ.M

GROUND FLOOR AREA OF BLOCK F

GROUND FLOOR AREA OF BLOCK F	= 31033.00 SQ.M
FIRST FLOOR AREA OF BLOCK F	= 31033.00 SQ.M
SECOND FLOOR AREA OF BLOCK F	= 31033.00 SQ.M
THIRD FLOOR AREA OF BLOCK F	= 31033.00 SQ.M
FOURTH FLOOR AREA OF BLOCK F	= 31033.00 SQ.M
TOTAL AREA OF BLOCK F	= 124135.00 SQ.M

GROUND FLOOR AREA OF BLOCK G

GROUND FLOOR AREA OF BLOCK G	= 31033.00 SQ.M
FIRST FLOOR AREA OF BLOCK G	= 31033.00 SQ.M
SECOND FLOOR AREA OF BLOCK G	= 31033.00 SQ.M
THIRD FLOOR AREA OF BLOCK G	= 31033.00 SQ.M
FOURTH FLOOR AREA OF BLOCK G	= 31033.00 SQ.M
TOTAL AREA OF BLOCK G	= 124135.00 SQ.M

GROUND FLOOR AREA OF BLOCK H

GROUND FLOOR AREA OF BLOCK H	= 31033.00 SQ.M
FIRST FLOOR AREA OF BLOCK H	= 31033.00 SQ.M
SECOND FLOOR AREA OF BLOCK H	= 31033.00 SQ.M
THIRD FLOOR AREA OF BLOCK H	= 31033.00 SQ.M
FOURTH FLOOR AREA OF BLOCK H	= 31033.00 SQ.M
TOTAL AREA OF BLOCK H	= 124135.00 SQ.M

GROUND FLOOR AREA OF BLOCK I

GROUND FLOOR AREA OF BLOCK I	= 31033.00 SQ.M
FIRST FLOOR AREA OF BLOCK I	= 31033.00 SQ.M
SECOND FLOOR AREA OF BLOCK I	= 31033.00 SQ.M
THIRD FLOOR AREA OF BLOCK I	= 31033.00 SQ.M
FOURTH FLOOR AREA OF BLOCK I	= 31033.00 SQ.M
TOTAL AREA OF BLOCK I	= 124135.00 SQ.M

GROUND FLOOR AREA OF BLOCK J

GROUND FLOOR AREA OF BLOCK J	= 31033.00 SQ.M
FIRST FLOOR AREA OF BLOCK J	= 31033.00 SQ.M
SECOND FLOOR AREA OF BLOCK J	= 31033.00 SQ.M
THIRD FLOOR AREA OF BLOCK J	= 31033.00 SQ.M
FOURTH FLOOR AREA OF BLOCK J	= 31033.00 SQ.M
TOTAL AREA OF BLOCK J	= 124135.00 SQ.M

GROUND FLOOR AREA OF BLOCK K

GROUND FLOOR AREA OF BLOCK K	= 31033.00 SQ.M
FIRST FLOOR AREA OF BLOCK K	= 31033.00 SQ.M
SECOND FLOOR AREA OF BLOCK K	= 31033.00 SQ.M
THIRD FLOOR AREA OF BLOCK K	= 31033.00 SQ.M
FOURTH FLOOR AREA OF BLOCK K	= 31033.00 SQ.M
TOTAL AREA OF BLOCK K	= 124135.00 SQ.M

GROUND FLOOR AREA OF BLOCK L

GROUND FLOOR AREA OF BLOCK L	= 31033.00 SQ.M
FIRST FLOOR AREA OF BLOCK L	= 31033.00 SQ.M
SECOND FLOOR AREA OF BLOCK L	= 31033.00 SQ.M
THIRD FLOOR AREA OF BLOCK L	= 31033.00 SQ.M
FOURTH FLOOR AREA OF BLOCK L	= 31033.00 SQ.M
TOTAL AREA OF BLOCK L	= 124135.00 SQ.M

GROUND FLOOR AREA OF BLOCK M

GROUND FLOOR AREA OF BLOCK M	= 31033.00 SQ.M
FIRST FLOOR AREA OF BLOCK M	= 31033.00 SQ.M
SECOND FLOOR AREA OF BLOCK M	= 31033.00 SQ.M
THIRD FLOOR AREA OF BLOCK M	= 31033.00 SQ.M
FOURTH FLOOR AREA OF BLOCK M	= 31033.00 SQ.M
TOTAL AREA OF BLOCK M	= 124135.00 SQ.M

GROUND FLOOR AREA OF BLOCK N

GROUND FLOOR AREA OF BLOCK N	= 31033.00 SQ.M
FIRST FLOOR AREA OF BLOCK N	= 31033.00 SQ.M
SECOND FLOOR AREA OF BLOCK N	= 31033.00 SQ.M
THIRD FLOOR AREA OF BLOCK N	= 31033.00 SQ.M
FOURTH FLOOR AREA OF BLOCK N	= 31033.00 SQ.M
TOTAL AREA OF BLOCK N	= 124135.00 SQ.M

GROUND FLOOR AREA OF BLOCK O

GROUND FLOOR AREA OF BLOCK O	= 31033.00 SQ.M
FIRST FLOOR AREA OF BLOCK O	= 31033.00 SQ.M
SECOND FLOOR AREA OF BLOCK O	= 31033.00 SQ.M
THIRD FLOOR AREA OF BLOCK O	= 31033.00 SQ.M
FOURTH FLOOR AREA OF BLOCK O	= 31033.00 SQ.M
TOTAL AREA OF BLOCK O	= 124135.00 SQ.M

GROUND FLOOR AREA OF BLOCK P

GROUND FLOOR AREA OF BLOCK P	= 31033.00 SQ.M
FIRST FLOOR AREA OF BLOCK P	= 31033.00 SQ.M
SECOND FLOOR AREA OF BLOCK P	= 31033.00 SQ.M
THIRD FLOOR AREA OF BLOCK P	= 31033.00 SQ.M
FOURTH FLOOR AREA OF BLOCK P	= 31033.00 SQ.M
TOTAL AREA OF BLOCK P	= 124135.00 SQ.M

GROUND FLOOR AREA OF BLOCK Q

GROUND FLOOR AREA OF BLOCK Q	= 31033.00 SQ.M
FIRST FLOOR AREA OF BLOCK Q	= 31033.00 SQ.M
SECOND FLOOR AREA OF BLOCK Q	= 31033.00 SQ.M
THIRD FLOOR AREA OF BLOCK Q	= 31033.00 SQ.M
FOURTH FLOOR AREA OF BLOCK Q	= 31033.00 SQ.M
TOTAL AREA OF BLOCK Q	= 124135.00 SQ.M

GROUND FLOOR AREA OF BLOCK R

GROUND FLOOR AREA OF BLOCK R	= 31033.00 SQ.M
FIRST FLOOR AREA OF BLOCK R	= 31033.00 SQ.M
SECOND FLOOR AREA OF BLOCK R	= 31033.00 SQ.M
THIRD FLOOR AREA OF BLOCK R	= 31033.00 SQ.M
FOURTH FLOOR AREA OF BLOCK R	= 31033.00 SQ.M
TOTAL AREA OF BLOCK R	= 124135.00 SQ.M

GROUND FLOOR AREA OF BLOCK S

GROUND FLOOR AREA OF BLOCK S	= 31033.00 SQ.M
FIRST FLOOR AREA OF BLOCK S	= 31033.00 SQ.M
SECOND FLOOR AREA OF BLOCK S	= 31033.00 SQ.M
THIRD FLOOR AREA OF BLOCK S	= 31033.00 SQ.M
FOURTH FLOOR AREA OF BLOCK S	= 31033.00 SQ.M
TOTAL AREA OF BLOCK S	= 124135.00 SQ.M

GROUND FLOOR AREA OF BLOCK T

GROUND FLOOR AREA OF BLOCK T	= 31033.00 SQ.M
FIRST FLOOR AREA OF BLOCK T	= 31033.00 SQ.M
SECOND FLOOR AREA OF BLOCK T	= 31033.00 SQ.M
THIRD FLOOR AREA OF BLOCK T	= 31033.00 SQ.M
FOURTH FLOOR AREA OF BLOCK T	= 31033.00 SQ.M
TOTAL AREA OF BLOCK T	= 124135.00 SQ.M

GROUND FLOOR AREA OF BLOCK U

GROUND FLOOR AREA OF BLOCK U	= 31033.00 SQ.M
FIRST FLOOR AREA OF BLOCK U	= 31033.00 SQ.M
SECOND FLOOR AREA OF BLOCK U	= 31033.00 SQ.M
THIRD FLOOR AREA OF BLOCK U	= 31033.00 SQ.M
FOURTH FLOOR AREA OF BLOCK U	= 31033.00 SQ.M
TOTAL AREA OF BLOCK U	= 124135.00 SQ.M

GROUND FLOOR AREA OF BLOCK V

GROUND FLOOR AREA OF BLOCK V	= 31033.00 SQ.M
FIRST FLOOR AREA OF BLOCK V	= 31033.00 SQ.M
SECOND FLOOR AREA OF BLOCK V	= 31033.00 SQ.M
THIRD FLOOR AREA OF BLOCK V	= 31033.00 SQ.M
FOURTH FLOOR AREA OF BLOCK V	= 31033.00 SQ.M
TOTAL AREA OF BLOCK V	= 124135.00 SQ.M

GROUND FLOOR AREA OF BLOCK W

GROUND FLOOR AREA OF BLOCK W	= 31033.00 SQ.M
FIRST FLOOR AREA OF BLOCK W	= 31033.00 SQ.M
SECOND FLOOR AREA OF BLOCK W	= 31033.00 SQ.M
THIRD FLOOR AREA OF BLOCK W	= 31033.00 SQ.M
FOURTH FLOOR AREA OF BLOCK W	= 31033.00 SQ.M
TOTAL AREA OF BLOCK W	= 124135.00 SQ.M

GROUND FLOOR AREA OF BLOCK X

GROUND FLOOR AREA OF BLOCK X	= 31033.00 SQ.M
FIRST FLOOR AREA OF BLOCK X	= 31033.00 SQ.M
SECOND FLOOR AREA OF BLOCK X	= 31033.00 SQ.M
THIRD FLOOR AREA OF BLOCK X	= 31033.00 SQ.M
FOURTH FLOOR AREA OF BLOCK X	= 31033.00 SQ.M
TOTAL AREA OF BLOCK X	= 124135.00 SQ.M

GROUND FLOOR AREA OF BLOCK Y

GROUND FLOOR AREA OF BLOCK Y	= 31033.00 SQ.M
FIRST FLOOR AREA OF BLOCK Y	= 31033.00 SQ.M
SECOND FLOOR AREA OF BLOCK Y	= 31033.00 SQ.M
THIRD FLOOR AREA OF BLOCK Y	= 31033.00 SQ.M
FOURTH FLOOR AREA OF BLOCK Y	= 31033.00 SQ.M
TOTAL AREA OF BLOCK Y	= 124135.00 SQ.M

GROUND FLOOR AREA OF BLOCK Z

GROUND FLOOR AREA OF BLOCK Z	= 31033.00 SQ.M
FIRST FLOOR AREA OF BLOCK Z	= 31033.00 SQ.M
SECOND FLOOR AREA OF BLOCK Z	= 31033.00 SQ.M
THIRD FLOOR AREA OF BLOCK Z	= 31033.00 SQ.M
FOURTH FLOOR AREA OF BLOCK Z	= 31033.00 SQ.M
TOTAL AREA OF BLOCK Z	= 124135.00 SQ.M

PROPOSED TOTAL FLOOR AREA (BLA+B+C+D+E+F)

PROPOSED TOTAL FLOOR AREA (BLA+B+C+D+E+F)	= 118135.13 SQ.M
TOTAL NO. OF TENANTS	= 118135.13

SIGNATURE OF OWNERS

APPROVED

SIGNATURE OF PANCHAYET PRODHAN

SIGNATURE OF ARCHITECT

SIGNATURE OF CIVIL ENGINEER

SIGNATURE OF ELECTRICAL ENGINEER

SIGNATURE OF MECHANICAL ENGINEER

SIGNATURE OF SANITARY ENGINEER

SIGNATURE OF STRUCTURAL ENGINEER

SIGNATURE OF WATER SUPPLY ENGINEER

SIGNATURE OF WASTE WATER ENGINEER

SIGNATURE OF AIR POLLUTION ENGINEER

SIGNATURE OF SOIL MECHANICS ENGINEER

SIGNATURE OF FOUNDATION ENGINEER

SIGNATURE OF ROADS ENGINEER

SIGNATURE OF BRIDGE ENGINEER

SIGNATURE OF TUNNEL ENGINEER

SIGNATURE OF DAM ENGINEER

SIGNATURE OF PORT ENGINEER

SIGNATURE OF COASTAL ENGINEER

SIGNATURE OF OFFSHORE ENGINEER

SIGNATURE OF MARINE ENGINEER

SIGNATURE OF AERONAUTICAL ENGINEER

SIGNATURE OF SPACE ENGINEER

SIGNATURE OF POLYMER ENGINEER

SIGNATURE OF CHEMICAL ENGINEER

SIGNATURE OF METALLURGICAL ENGINEER

SIGNATURE OF MATERIALS ENGINEER

SIGNATURE OF INDUSTRIAL ENGINEER

SIGNATURE OF AGRICULTURAL ENGINEER

SIGNATURE OF FOOD ENGINEER

SIGNATURE OF FIBRE ENGINEER

SIGNATURE OF TEXTILE ENGINEER

SIGNATURE OF LEATHER ENGINEER

SIGNATURE OF JEWELLERY ENGINEER

SIGNATURE OF OPTICAL ENGINEER

SIGNATURE OF ELECTRONIC ENGINEER

SIGNATURE OF TELECOMMUNICATION ENGINEER

SIGNATURE OF COMPUTER ENGINEER

SIGNATURE OF SOFTWARE ENGINEER

SIGNATURE OF INFORMATION ENGINEER

SIGNATURE OF SYSTEMS ENGINEER

SIGNATURE OF NETWORK ENGINEER

SIGNATURE OF SECURITY ENGINEER

SIGNATURE OF MANAGEMENT ENGINEER

SIGNATURE OF BUSINESS ENGINEER

SIGNATURE OF FINANCIAL ENGINEER

SIGNATURE OF MARKETING ENGINEER

SIGNATURE OF HUMAN RESOURCE ENGINEER

SIGNATURE OF TRAINING ENGINEER

SIGNATURE OF RESEARCH ENGINEER

SIGNATURE OF DEVELOPMENT ENGINEER

SIGNATURE OF PLANNING ENGINEER

SIGNATURE OF POLICY ENGINEER

SIGNATURE OF EVALUATION ENGINEER

SIGNATURE OF MONITORING ENGINEER

SIGNATURE OF IMPROVEMENT ENGINEER

SIGNATURE OF REFORM ENGINEER

SIGNATURE OF INNOVATION ENGINEER

SIGNATURE OF ENTREPRENEUR ENGINEER

SIGNATURE OF SOCIAL ENGINEER

SIGNATURE OF COMMUNITY ENGINEER

SIGNATURE OF ENVIRONMENTAL ENGINEER

SIGNATURE OF CONSERVATION ENGINEER

SIGNATURE OF RESTORATION ENGINEER

SIGNATURE OF PRESERVATION ENGINEER

SIGNATURE OF PROTECTION ENGINEER

SIGNATURE OF ENHANCEMENT ENGINEER

SIGNATURE OF REGENERATION ENGINEER

SIGNATURE OF REVITALIZATION ENGINEER

SIGNATURE OF RECONSTRUCTION ENGINEER

SIGNATURE OF REPAIR ENGINEER

SIGNATURE OF MAINTENANCE ENGINEER

SIGNATURE OF OPERATIONAL ENGINEER

SIGNATURE OF SUPPORT ENGINEER

SIGNATURE OF AUXILIARY ENGINEER

SIGNATURE OF SERVICE ENGINEER

SIGNATURE OF SUPPLY ENGINEER

SIGNATURE OF DISTRIBUTION ENGINEER

SIGNATURE OF COLLECTION ENGINEER

SIGNATURE OF TREATMENT ENGINEER

SIGNATURE OF DISPOSAL ENGINEER

SIGNATURE OF REUSE ENGINEER

SIGNATURE OF RECYCLING ENGINEER

SIGNATURE OF REDUCTION ENGINEER

SIGNATURE OF PREVENTION ENGINEER

SIGNATURE OF CONTROL ENGINEER

SIGNATURE OF CORRECTION ENGINEER

SIGNATURE OF MITIGATION ENGINEER

SIGNATURE OF AVOIDANCE ENGINEER

SIGNATURE OF TRANSFER ENGINEER

SIGNATURE OF ALLEVIATION ENGINEER

SIGNATURE OF ACCEPTANCE ENGINEER

SIGNATURE OF ADAPTATION ENGINEER

SIGNATURE OF ACCOMMODATION ENGINEER

SIGNATURE OF MODIFICATION ENGINEER

SIGNATURE OF ADJUSTMENT ENGINEER

SIGNATURE OF REVISION ENGINEER

SIGNATURE OF IMPROVEMENT ENGINEER

SIGNATURE OF OPTIMIZATION ENGINEER

SIGNATURE OF MAXIMIZATION ENGINEER

SIGNATURE OF MINIMIZATION ENGINEER

SIGNATURE OF BALANCE ENGINEER