

PROPOSED G+IV RESIDENTIAL BUILDING PLAN AT MOUZA - RAJPUR, J.L. NO - 55, R.S. DAG NO.- 591, KHATIAN NO - 2744, WARD NO-16, AT PREMISES NO - 68, S.B DAS ROAD, P.S - SONARPUR, KOLKATA - 700149, UNDER RAJPUR SONARPUR MUNICIPALITY.

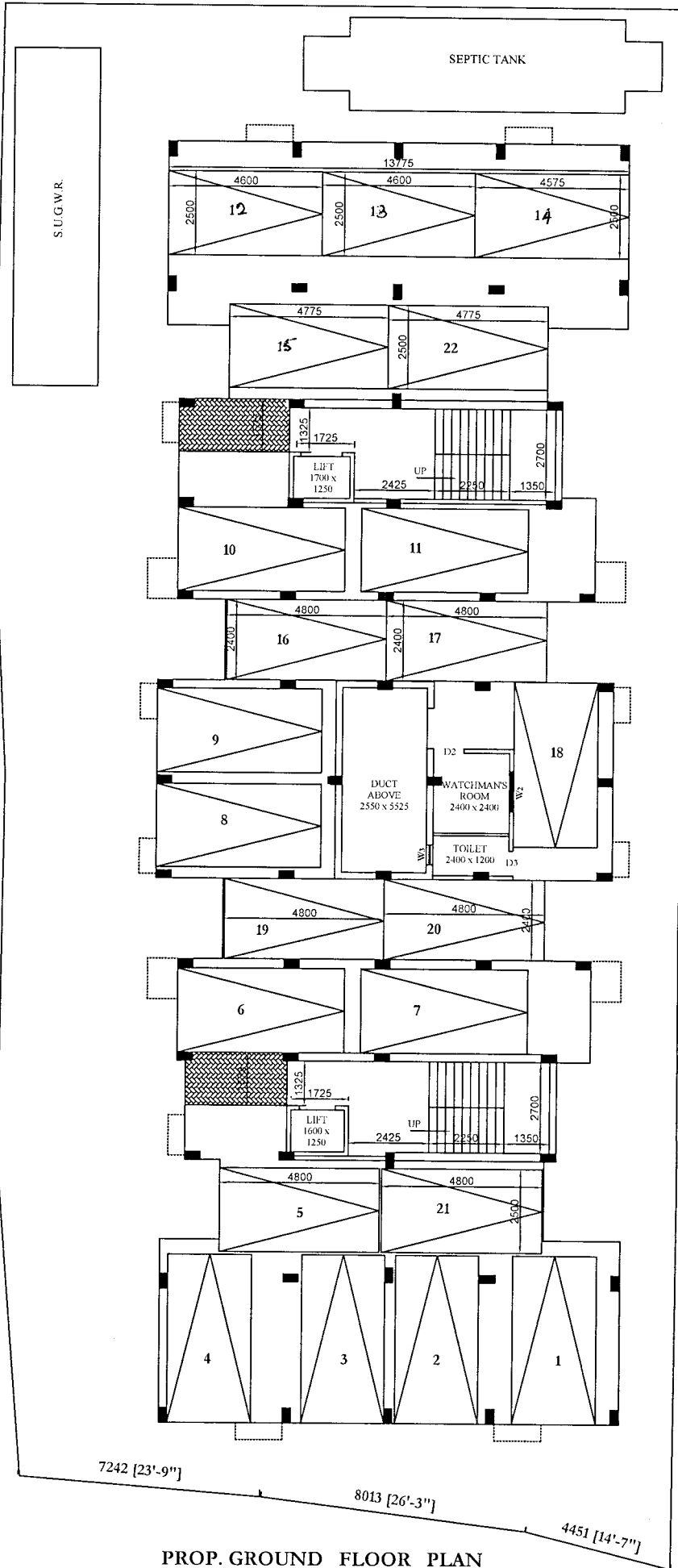

NO. OF PARKING - 2  
TOTAL PARKING AREA - 265 SQ.M

*Savitri Bhowari*  
Sonal Nag  
Ritika Mahamdar

PROP. GROUND FLOOR PLAN  
SCALE - 1:100