

SCHEDULE OF SLAB (G51)
THICKNESS AS MENTIONED -- 150 MM (M25 AND F75000)

| SPAN | THICKNESS |
|---------|-----------|
| Span | 150mm |
| Support | 150mm |

(ALONG SHORTER DIRECTION)
SPAN: 150mm (15mm c/c of span, all through)
SUPPORT: 150mm (15mm c/c of top of support)

(ALONG LONGER DIRECTION)
SPAN: 150mm (15mm c/c of span, all through)
SUPPORT: 150mm (15mm c/c of top of support)

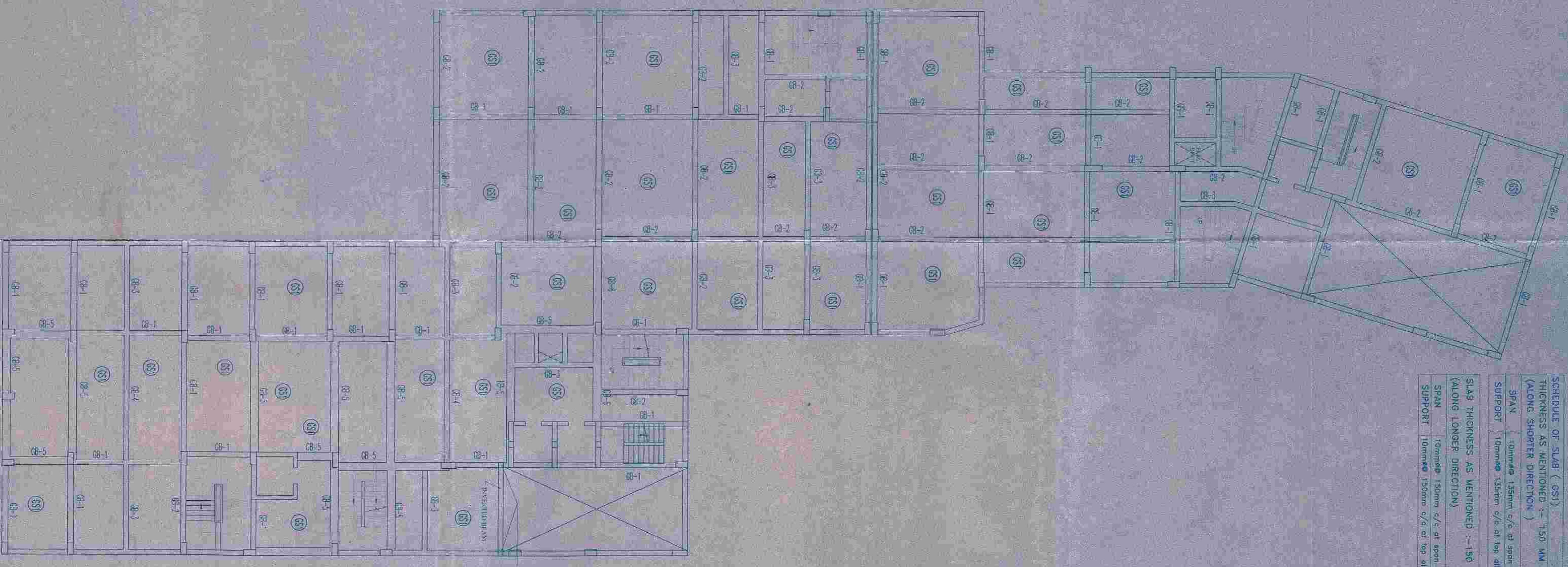

GROUND FLOOR BEAM LAYOUT

SCHEDULE OF 1ST FLOOR BEAM (M25 AND F7500)

| NO. | SIZE | TOP | BOTTOM | STIRRUPS (2 LEGGED) |
|-----|---------|------|--------|---------------------|
| G81 | 300x500 | 3-20 | 3-20 | 4@150mm c/c |
| G82 | 300x500 | 3-20 | 3-20 | 4@150mm c/c |
| G83 | 300x500 | 3-20 | 3-20 | 4@150mm c/c |
| G84 | 300x500 | 3-20 | 3-20 | 4@150mm c/c |
| G85 | 400x600 | 3-25 | 3-25 | 4@150mm c/c |
| G86 | 400x600 | 3-20 | 3-20 | 4@150mm c/c |

SCHEDULE OF 1ST FLOOR BEAM (M25 AND F7500)

| NO. | SIZE | TOP | BOTTOM | STIRRUPS (2 LEGGED) |
|-----|---------|------|--------|---------------------|
| I81 | 200x500 | 1-20 | 3-20 | 4@150mm c/c |
| I82 | 200x500 | 3-20 | 3-20 | 4@150mm c/c |
| I83 | 200x500 | 3-20 | 3-20 | 4@150mm c/c |
| I84 | 200x500 | 2-16 | 1-16 | 4@150mm c/c |
| I85 | 400x600 | 3-25 | 3-25 | 4@150mm c/c |
| I86 | 400x600 | 3-20 | 3-20 | 4@150mm c/c |

SCHEDULE OF SLAB (S11)
THICKNESS AS MENTIONED -- 125 MM (M25 AND F75000)

| SPAN | THICKNESS |
|---------|-----------|
| Span | 125mm |
| Support | 125mm |

(ALONG SHORTER DIRECTION)
SPAN: 125mm (15mm c/c of span & alternately curtailed at L/4 from beam support)
SUPPORT: 125mm (15mm c/c of top of support & alternately curtailed upto L/3 from beam)

(ALONG LONGER DIRECTION)
SPAN: 125mm (15mm c/c of span & alternately curtailed at L/4 from beam support)
SUPPORT: 125mm (15mm c/c of top of support & alternately curtailed upto L/3 from beam)

SCHEDULE OF SLAB (S12)
THICKNESS AS MENTIONED -- 150 MM (M25 AND F75000)

| SPAN | THICKNESS |
|---------|-----------|
| Span | 150mm |
| Support | 150mm |

(ALONG SHORTER DIRECTION)
SPAN: 150mm (15mm c/c of span & alternately curtailed at L/4 from beam support)
SUPPORT: 150mm (15mm c/c of top of support & alternately curtailed upto L/3 from beam)

(ALONG LONGER DIRECTION)
SPAN: 150mm (15mm c/c of span & alternately curtailed at L/4 from beam support)
SUPPORT: 150mm (15mm c/c of top of support & alternately curtailed upto L/3 from beam)

SCHEDULE OF SLAB (S13)
THICKNESS AS MENTIONED -- 150 MM (M25 AND F75000)

| SPAN | THICKNESS |
|---------|-----------|
| Span | 150mm |
| Support | 150mm |

(ALONG SHORTER DIRECTION)
SPAN: 150mm (15mm c/c of span & alternately curtailed at L/4 from beam support)
SUPPORT: 150mm (15mm c/c of top of support & alternately curtailed upto L/3 from beam)

(ALONG LONGER DIRECTION)
SPAN: 150mm (15mm c/c of span & alternately curtailed at L/4 from beam support)
SUPPORT: 150mm (15mm c/c of top of support & alternately curtailed upto L/3 from beam)

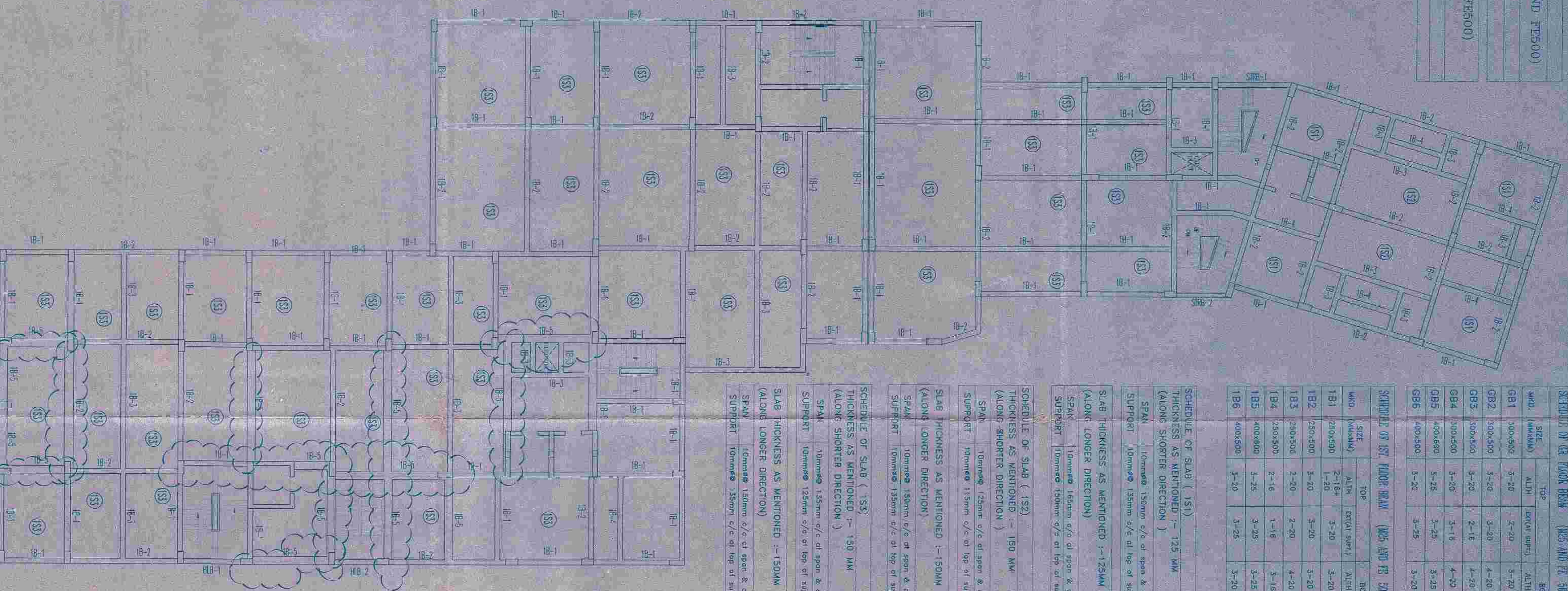

1ST FLOOR BEAM LAYOUT

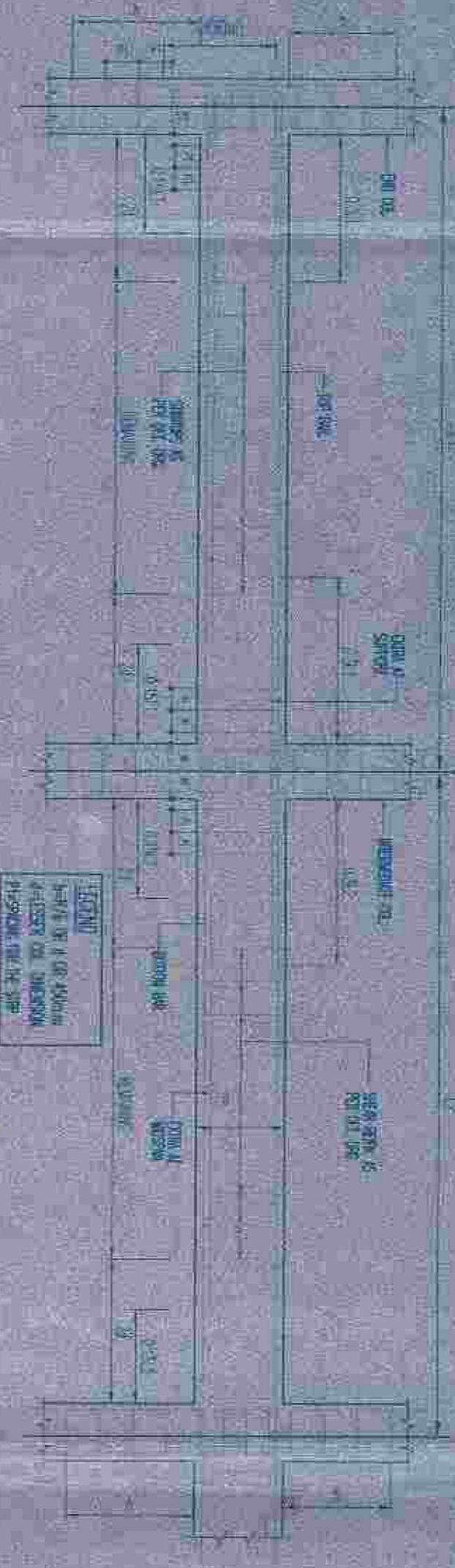

TYPICAL DETAIL OF BEAM COLUMN JUNCTION

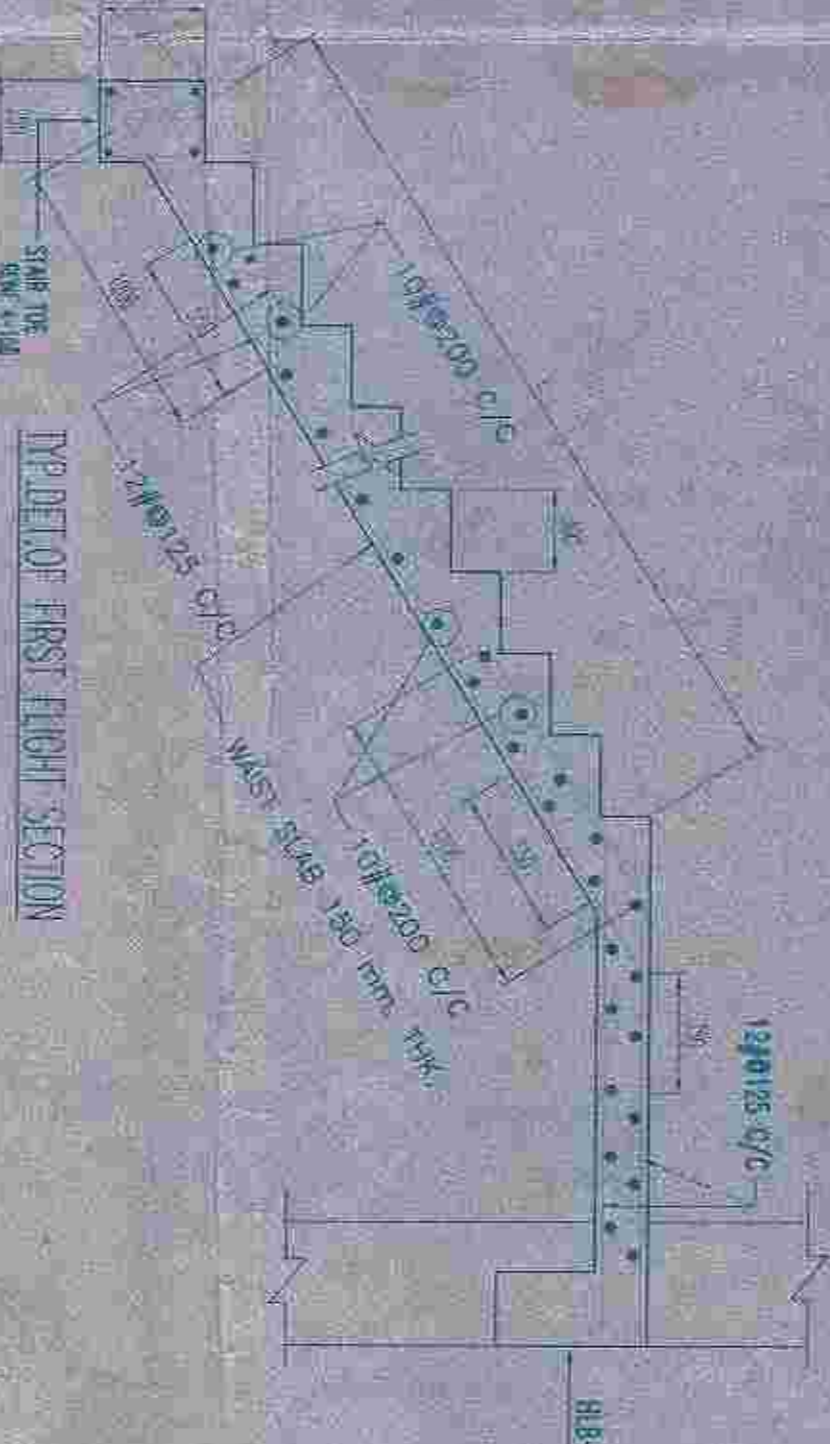

TYPICAL FIRST FLOOR SECTION



TYPICAL SECOND FLOOR SECTION

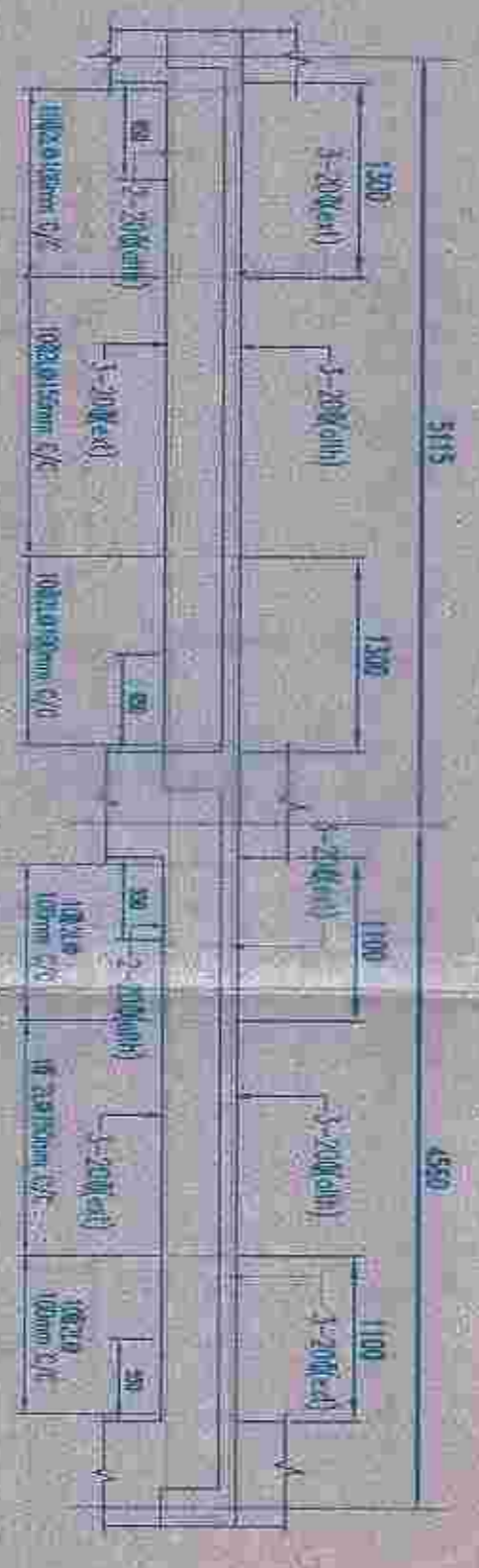

DETAIL OF BEAM (B-2/300x500)



SECTION (S1/S11)



SECTION (S1/S12)



SECTION (S1/S13)

- NOTES**
1. SPACING OF REINFORCEMENT SHALL BE AS PER IS 456:2000.
 2. ALL REINFORCEMENT SHALL BE PROVIDED AS PER IS 456:2000.
 3. ALL REINFORCEMENT SHALL BE PROVIDED AS PER IS 456:2000.
 4. ALL REINFORCEMENT SHALL BE PROVIDED AS PER IS 456:2000.
 5. ALL REINFORCEMENT SHALL BE PROVIDED AS PER IS 456:2000.
 6. ALL REINFORCEMENT SHALL BE PROVIDED AS PER IS 456:2000.
 7. ALL REINFORCEMENT SHALL BE PROVIDED AS PER IS 456:2000.
 8. ALL REINFORCEMENT SHALL BE PROVIDED AS PER IS 456:2000.
 9. ALL REINFORCEMENT SHALL BE PROVIDED AS PER IS 456:2000.
 10. ALL REINFORCEMENT SHALL BE PROVIDED AS PER IS 456:2000.

REVISIONS

| NO. | DATE | DESCRIPTION | BY | CHECKED |
|-----|----------|-------------------|----|---------|
| 1 | 05.05.14 | ISSUED FOR PERMIT | | |
| 2 | 05.05.14 | ISSUED FOR PERMIT | | |
| 3 | 05.05.14 | ISSUED FOR PERMIT | | |
| 4 | 05.05.14 | ISSUED FOR PERMIT | | |
| 5 | 05.05.14 | ISSUED FOR PERMIT | | |

DECLARATION OF THE BEAM

I, THE UNDERSIGNED, ARCHITECT, HEREBY CERTIFY THAT THE STRUCTURE DESCRIBED IN THE ABOVE DRAWING IS THE STRUCTURE AS APPROVED BY THE COMPETENT AUTHORITY AND THAT I AM NOT PROVIDING ANY OTHER INFORMATION THAT IS NOT MENTIONED IN THE ABOVE DRAWING.

SIGNATURE OF ARCHITECT

DATE

DECLARATION OF THE SLAB

I, THE UNDERSIGNED, ARCHITECT, HEREBY CERTIFY THAT THE STRUCTURE DESCRIBED IN THE ABOVE DRAWING IS THE STRUCTURE AS APPROVED BY THE COMPETENT AUTHORITY AND THAT I AM NOT PROVIDING ANY OTHER INFORMATION THAT IS NOT MENTIONED IN THE ABOVE DRAWING.

SIGNATURE OF ARCHITECT

DATE

PROJECT

REPOSED BASEMENT + C+VII STORED RESIDENTIAL BUILDINGS AT HOLDING NO. 141, GARDIA STATION ROAD, KASBAH NO. 18, 81, 82, 83, 84, 85, 86, 87, 88, 89, 90, 91, 92, 93, 94, 95, 96, 97, 98, 99, 100, FARSAHAD P.S., GARDIA DIST., PUNJAB, INDIA.

OWNER'S NAME

Sanjayson Associates Consultant Pvt. Ltd.

SCALE

AS SHOWN

DATE

05.05.14

APPROVED

SIGNATURE OF ARCHITECT

DATE

Sanjayson Associates Consultant Pvt. Ltd.

CONSULTANT PLANNER & STRUCTURAL ENGINEERS

KOLKATA - 700 084

APPROVED

SIGNATURE OF ARCHITECT

DATE

Stacking of building materials on /
beacon liability may constitute those
materials as per rule. ...

Transfer of occupancy right of any
part of the building before the
completion of construction
shall be void and the contractor
shall be held liable for the same.

7. The contractor shall be responsible for the safety of the workmen and the public during the construction of the building. The contractor shall be held liable for any accident or injury to the workmen or the public during the construction of the building.

DISCLAIMER

1) I, the undersigned, being the proprietor of the site of land bearing holding No. 1111, Ganga Station Road, Faridkot, J. No. 47, Kharan No. 318, 322, 12, Dist. No. 831, 830, 833, 835, 836, 837 of land measuring 57 satak, (50 baha 8 bithak 15 ghat)

M/s ADCC Construction Pvt. Ltd.
Sunder Lal
Charitable Trust
P.O. Faridkot

APPROVED PLANS IS REVISED FOR
VALID UP TO 15/07/2018
DATE 15/07/2018
BY 15/07/2018

APPROVED PLANS IS REVISED FOR
VALID UP TO 15/07/2018
DATE 15/07/2018
BY 15/07/2018