

ARCHITECTURAL DRAWING

PROPOSED RESIDENTIAL COMPLEX COMPRISING OF GROUND FLOOR TO 14TH FLOOR... MONOJIT DAS ARCHITECTS PVT. LTD. & OTHERS AT RAJARHAT, RAJARHAT, RAJARHAT...

LEIBURE STODOLSKY LIMITED

MONOJIT DAS ARCHITECTS PVT. LTD.

CERTIFICATE OF THE ARCHITECT

I HEREBY CERTIFY THAT THE ARCHITECTURAL DRAWINGS OF THE PROJECT AT RAJARHAT, RAJARHAT, RAJARHAT... HAVE BEEN PREPARED BY ME FOR DESIGN AND CALCULATION OF THE FOUNDATION...

MONOJIT DAS

Reg. No. CA/28/2017

HICO ENCLUMENT NO.

MONOJIT DAS

REGISTERED ARCHITECT

CERTIFICATE OF THE STRUCTURAL ENGINEER

I HEREBY CERTIFY THAT THE STRUCTURAL DRAWINGS AND DESIGN OF BOTH THE FOUNDATION AND SUPERSTRUCTURE... HAVE BEEN PREPARED BY ME FOR DESIGN AND CALCULATION OF THE FOUNDATION...

ARFAN DAS GUPTA

Reg. No. SE/10/2017

HICO ENCLUMENT NO.

ARFAN DAS GUPTA

REGISTERED STRUCTURAL ENGINEER

MONOJIT DAS ARCHITECTS PVT. LTD.

Reg. No. CA/28/2017

HICO ENCLUMENT NO.

MONOJIT DAS

REGISTERED ARCHITECT

CERTIFICATE OF THE GEO-TECHNICAL ENGINEER

I HEREBY CERTIFY THAT THE GEOTECHNICAL DRAWINGS AND DESIGN OF BOTH THE FOUNDATION AND SUPERSTRUCTURE... HAVE BEEN PREPARED BY ME FOR DESIGN AND CALCULATION OF THE FOUNDATION...

ARFAN DAS GUPTA

Reg. No. SE/10/2017

HICO ENCLUMENT NO.

ARFAN DAS GUPTA

REGISTERED GEO-TECHNICAL ENGINEER

MONOJIT DAS ARCHITECTS PVT. LTD.

Reg. No. CA/28/2017

HICO ENCLUMENT NO.

MONOJIT DAS

REGISTERED ARCHITECT

SCHEDULE OF DOORS & WINDOWS

Table with columns: SCHEDULE OF DOORS, SCHEDULE OF WINDOWS, AREA STATEMENT. Includes details like TYPE, HEIGHT, WIDTH, AREA.

AREA STATEMENT

Table with columns: AREA STATEMENT, DETAILS. Lists various areas and their corresponding details.

SCALE: 1:100, 1:500, 1:50. SHEET NO. 01/18. DESIGNED BY: MONOJIT DAS AND ASSOCIATES



Approval Order No. 1430/ERS
Date: 21/12/2020
Valid up to: 20/12/2025

Note:- The proposal is recommended for approval subject to submission of Environment Clearance.

SANCTIONED & APPROVED

[Signature]
Executive Officer
Rajaratn Panchayat Samity
Rajaratn, North 24 Parganas

J.C. OFFICER: MONAJIT DAS ARCHITECTURAL ENGINEER	Enrollment No.: ARCH - HDCC/09/00040
ENGINEER: BIBEK BIKASH MULLICK GEO-TECHNICAL ENGINEER	Enrollment No.: STER/NKDA/10/00008
ENGINEER: ALOK ROY GEO-TECHNICAL ENGINEER	Enrollment No.: STER - HDCC/09/00003
ENGINEER: ARPAN DAS GUPTA GEO-TECHNICAL ENGINEER	Enrollment No.: ACHR/NKDA/10/00220
ENGINEER: KOUSHIK SENGUPTA	Enrollment No.: STRV/NKDA/15/00002

Note: The REC is issued on the basis of documents submitted by the applicant and reviewed by the AEC, Executive Officer, North 24 Parganas. It is not a final approval of the project and the applicant is required to submit the project including the concerned land, water, and other details, to the REC and the AEC for their approval.

NEW TOWN KOLKATA DEVELOPMENT AUTHORITY
No Objection Certificate for
Specification of Building Plan for Construction Purpose
Memo No. 5375/NKDA/BPS-04(40)/2014
Date: 16.10.2020

Building Particulars
PROPOSED RESIDENTIAL COMPLEX OF G+XIV,
G+XII, MLC P 6 STORED, CLUB (G+III) FOR
LEISURE STOCKIST PVT LTD. & 63 OTHERS AT
MOUZA - RECKJANT, J.L. NO. 13, RS/LR. DAG NO- 404,
405, 406, 409(P), 413(P) - 416(P), 417, 421, 423, 424,
425(P), 426, 427(P), 428, 432(P), 441, 442(P),
443, 446 to 451, 454(P), 455(P), 472(P) &
473(P), PS - RAJARHAT, G.P. - P.B.I.
DIST - N. 24 P.S.

[Signature]
Assistant Architect
New Town Kolkata Development Authority

[Signature]
Tapan Kumar Dwarti
Chief Architect
New Town Kolkata Development Authority

MASTER PLAN - 1/1R

Note: - The proposal is recommended for approval subject to submission of Environment Clearance.

ARCHITECT: **MONOJIT DAS** Enrolment No: **AREH - HIDCO/09/00040**
CIVIL/STRUCTURAL ENGINEER: Enrolment No:
BIBEK BIKASH MULLICK Enrolment No: **SER/NKDA/10/00008**
GEN-TECHNICAL ENGINEER: Enrolment No:
ALOK ROY Enrolment No: **GTER - HIDCO/09/00003**
TOWN PLANNER/URBAN DESIGNER: Enrolment No:
ARPAN DAS GUPTA Enrolment No: **AER/NKDA/10/00220**
STRUCTURAL REVIEWER: Enrolment No:
KOUSHIK SENGUPTA Enrolment No: **STRV/NKDA/15/00002**

NOTE: The No. for this stamp on the back of this stamp is required for the registration and issuance of the All India Council of Technical Education (AICTE) and other relevant authorities. It is not valid for any other purpose. For more information, please visit the website of the Council of Architecture, New Delhi.

NEW TOWN KOLKATA DEVELOPMENT AUTHORITY
No Objection Certificate for
Submission of Building Plans for Construction Purpose
Name: / /
Date: / /
Building Particulars

Approval Order No. **M2C/RP**
Date: **21/10/2020**
Valid up to: **20/10/2021**

NEW TOWN KOLKATA DEVELOPMENT AUTHORITY
No Objection Certificate for
Submission of Building Plans for Construction Purpose

Name: **5373/NKDA/BPS-04(40)/2014**

Date: **14.10.2020**

Building Particulars -

PROPOSED RESIDENTIAL COMPLEX OF G+XIV, G+XI -
MUEP 6 STORED, CLUB(G+III) FOR LEISURE
STOCKIST PVT. LTD. & 63 OTHERS AT MOUZA - RECKJOANI,
J.L. NO. 13, RS JLR. DAG NO. 404, 405, 406, 407(P), 413(P),
416(P), 417, 421, 423, 424, 425(P), 426, 427(P), 428,
432(P), 441, 442(P), 443, 446 TO 451, 454(P), 455(P),
472(P) & 473(P), P.S. RAJARHAT, G.P. R-B-I.
Dist. N. 24 PGS.

SANCTIONED & APPROVED

Tapan Kumar Dwarti
Executive Officer
Rajarat Panchayat Samity
Rajarat, North 24 Parganas

Rana Anjan
Assistant Architect
New Town Kolkata Development Authority

Tapan Kumar Dwarti
Chief Architect
New Town Kolkata Development Authority

LEISURE STOCKS PRIVATE LIMITED
 Leisure Stocks Director
 NAME OF OWNERS: LEISURE STOCKS PVT. LTD. & OTHERS
 PROJECT NO. LS/2024/001

CERTIFICATE OF THE ARCHITECT

ACCEPTED THAT THE ARCHITECT HAS REVIEWED THE DRAWINGS AND SPECIFICATIONS AND IS SATISFIED THAT THE SAME COMPLY WITH THE REQUIREMENTS OF THE NATIONAL BUILDING CODE OF INDIA AND THE REGULATIONS OF THE GOVERNMENT OF WEST BENGAL, INDIA. THE ARCHITECT HAS NOT CONDUCTED A VISUAL SURVEY OF THE SITE AND HAS NOT CONDUCTED ANY INVESTIGATION OF THE SOIL OR FOUNDATION CONDITIONS. THE ARCHITECT HAS NOT CONDUCTED ANY INVESTIGATION OF THE FOUNDATION CONDITIONS OF THE EXISTING STRUCTURE. THE ARCHITECT HAS NOT CONDUCTED ANY INVESTIGATION OF THE FOUNDATION CONDITIONS OF THE EXISTING STRUCTURE. THE ARCHITECT HAS NOT CONDUCTED ANY INVESTIGATION OF THE FOUNDATION CONDITIONS OF THE EXISTING STRUCTURE.

MONOIT DAS
 ARCHITECT
 REG. NO. 12345
 ADDRESS: 123, ABC STREET, KOLKATA, WEST BENGAL, INDIA
 MOBILE: 98765 43210

CERTIFICATE OF THE STRUCTURAL ENGINEER

ACCEPTED THAT THE STRUCTURAL DESIGN AND DETAILS OF THE BUILDING ARE IN ACCORDANCE WITH THE REQUIREMENTS OF THE NATIONAL BUILDING CODE OF INDIA AND THE REGULATIONS OF THE GOVERNMENT OF WEST BENGAL, INDIA. THE STRUCTURAL ENGINEER HAS CONDUCTED A VISUAL SURVEY OF THE SITE AND HAS CONDUCTED ANY INVESTIGATION OF THE SOIL OR FOUNDATION CONDITIONS. THE STRUCTURAL ENGINEER HAS CONDUCTED ANY INVESTIGATION OF THE FOUNDATION CONDITIONS OF THE EXISTING STRUCTURE. THE STRUCTURAL ENGINEER HAS CONDUCTED ANY INVESTIGATION OF THE FOUNDATION CONDITIONS OF THE EXISTING STRUCTURE.

BIBHASKAR MULLICK
 STRUCTURAL ENGINEER
 REG. NO. 56789
 ADDRESS: 123, ABC STREET, KOLKATA, WEST BENGAL, INDIA
 MOBILE: 98765 43210

ABAN DAS GUPTA
 TOWN PLANNER
 REG. NO. 12345
 ADDRESS: 123, ABC STREET, KOLKATA, WEST BENGAL, INDIA
 MOBILE: 98765 43210

CERTIFICATE OF THE GEO-TECHNICAL ENGINEER

ACCEPTED THAT THE GEO-TECHNICAL REPORT ON THE SOIL INVESTIGATION CONDUCTED AT THE SITE IS IN ACCORDANCE WITH THE REQUIREMENTS OF THE NATIONAL BUILDING CODE OF INDIA AND THE REGULATIONS OF THE GOVERNMENT OF WEST BENGAL, INDIA. THE GEO-TECHNICAL ENGINEER HAS CONDUCTED A VISUAL SURVEY OF THE SITE AND HAS CONDUCTED ANY INVESTIGATION OF THE SOIL OR FOUNDATION CONDITIONS. THE GEO-TECHNICAL ENGINEER HAS CONDUCTED ANY INVESTIGATION OF THE FOUNDATION CONDITIONS OF THE EXISTING STRUCTURE. THE GEO-TECHNICAL ENGINEER HAS CONDUCTED ANY INVESTIGATION OF THE FOUNDATION CONDITIONS OF THE EXISTING STRUCTURE.

SCHEDULE OF DOORS & WINDOWS									
SCHEDULE OF WINDOWS									
TYPE	SHUTTER	HEIGHT	WIDTH	NO. OF WINDOWS	NO. OF DOORS	NO. OF WINDOWS	NO. OF DOORS	NO. OF WINDOWS	NO. OF DOORS
W1	1000	2000	1200	120	120	120	120	120	120
W2	1000	1500	800	80	80	80	80	80	80
W3	1000	1000	600	60	60	60	60	60	60
D1	1000	2000	1200	120	120	120	120	120	120
D2	1000	1500	800	80	80	80	80	80	80
D3	1000	1000	600	60	60	60	60	60	60
TOTAL					TOTAL				

SCALE: 1/100
 SHEET NO. 03/18
 DESIGNED BY: MONOIT DAS AND ASSOCIATES

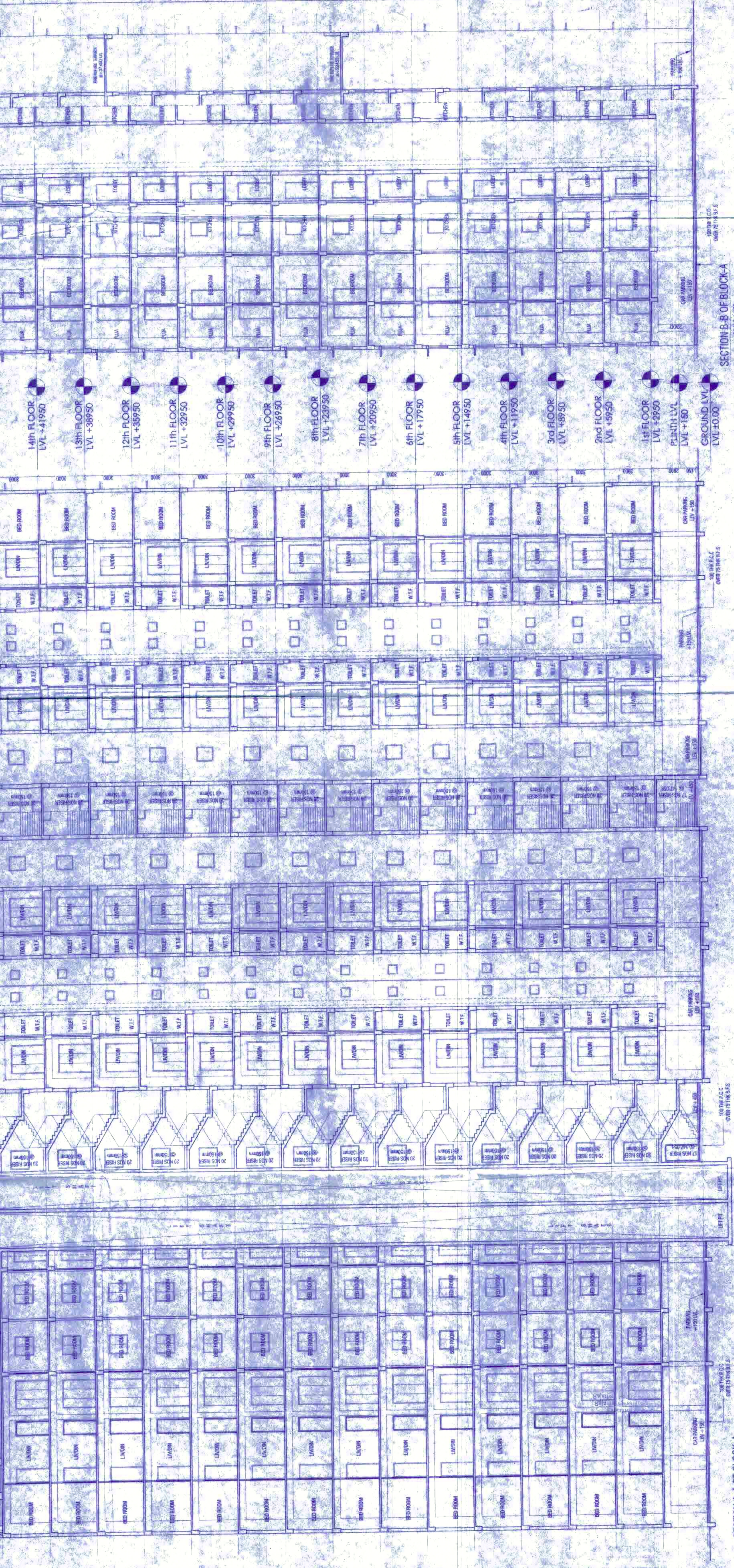

SECTION A-A OF BLOCK-A
SCALE: 1/100

SECTION B-B OF BLOCK-A
SCALE: 1/100

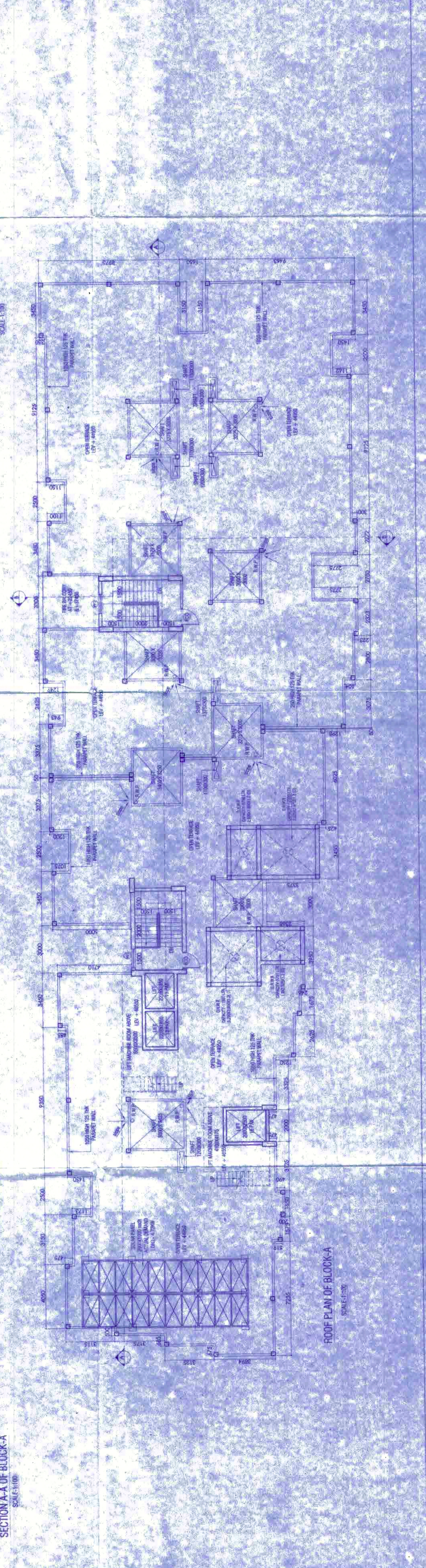

ROOF PLAN OF BLOCK-A
SCALE: 1/100