



NORTH SIDE ELEVATION
BLOCK-2
SCALE * 1:100



SECTION : C-C
BLOCK-2
SCALE * 1:100

- EXT. CONST. SHOWN IN COL.
- PROP. CONST. SHOWN IN COL.
- PROPERTY LINE SHOWN IN COL.
- ROAD SHOWN IN COL.
- DRAIN SHOWN IN COL.

SCHEDULE OF DOORS & WINDOWS

TYPE	SILL	LINTEL	SIZE	TYPE	SILL	LINTEL	SIZE
D1A	2100	2200X2100	W1	900	2100	1800X1200	
D1	2100	1800X2100	W2	900	2100	1500X1200	
D2	2100	1100X2100	W3	900	2100	950X1200	
D3	2100	900X2100	W4	1050	2100	950X1050	
D4	2100	825X2100	W5	1050	2100	850X1050	
D4	2100	750X2100	W6	900	2100	1125X1200	
D4	2100	1900X2100	W7	900	2100	1800X1200	
			V	1200	2100	600X900	

- SPECIFICATION OF BUILDING
- ALL DIMENSIONS ARE IN MM.
 - EARTH WORK IN EXCAVATION IN FOUNDATION TRENCHES.
 - 150MM THICK SAND FILLING OVER FOUNDATION BED.
 - 100MM THICK R.C.C. OVER SINGLE BAYER BRICK FLAT SOILING.
 - FIRST CLASS CEMENT BROCKWORK UP TO GROUND LEVEL.
 - R.C.C. WORK WILL BE AS PER DRAWING.
 - ALL STRUCTURAL CALCULATIONS MUST HAVE TO SATISFY IS 456 : 2000.
 - GRADE OF STEEL : Fe415
 - 250MM CEMENT BROCKWORK IN SUPERSTRUCTURE WITH 1:6 SAND CEMENT MORTAR.
 - 125MM CEMENT BROCKWORK IN PARTITION WALL WITH 1:4 SAND CEMENT MORTAR.
 - 12MM THICK PLASTERING ON INSIDE WALL WITH 1:6 SAND CEMENT MORTAR.
 - 20MM THICK PLASTERING ON OUTSIDE WALL WITH 1:6 SAND CEMENT MORTAR.
 - 12MM THICK PLASTERING ON CEILING WITH 1:6 SAND CEMENT MORTAR.
 - SAL WOOD WORK FOR DOOR & WINDOW FRAME.
 - GAMBER WOOD WORK FOR DOOR & WINDOW PANEL SHUTTERING.
 - TWO COATS COLOUR WASHING OVER GAMBER COAT PRIMER.
 - SEPTIC TANK & SOUP PIT WILL BE AS PER DRAWING.
 - LINTEL & CHAMIA WILL BE AS PER SCALE.
 - CAR PARKING SPACE WILL BE ALLOWED FLAT OWNERS' USERS OUT SIDERS NOT TO BE ALLOWED.

SIGNATURE OF MEMBER
CHAIRMAN IN COUNCIL

SIGNATURE OF HEALTH OFFICER

SIGNATURE OF ENGINEER

CERTIFICATE OF ARCHITECT

THE L.B.A. HAS CERTIFIED ON THE PLAN ITSELF WITH FULL RESPONSIBILITY THAT THE BUILDING PLAN HAS BEEN DRAWN UP AS PER PROVISION OF W.B.M. BLDG. RULES 2007, AS AMENDED FROM TIME TO TIME AND THAT THE SITE CONDITION INCLUDING THE WIDTH OF THE ABUTTING ROAD CONFIRM WITH THE PLAN AND IT IS A BUILD ABLE SITE AND NOT A TANK OR A FILLED UP TANK.

RAJ KUMAR AGARWAL
346/E/EXT-6
BURDWAN MUNICIPALITY

CERTIFICATE OF STRUCTURAL ENGINEER

CERTIFIED THAT THE SITE HAS BEEN INSPECTED PERSONALLY AND STRUCTURE OF THE BUILDING HAS BEEN DESIGNED BY ME AS TO BE SAFE IN ALL RESPECT INCLUDING CONSIDERATION OF BEARING CAPACITY AND SETTLEMENT OF SOIL ON THE BASIS OF RECOMMENDATION OF GEOTECHNICAL ENGINEER. ALSO THAT THE PLAN HAS BEEN DESIGNED AND DRAWN UP STRICTLY ACCORDING TO THE WEST BENGAL MUNICIPAL BUILDING RULES, 2006.

SANJIV J. PAREKH
M.E. (STRUCTURAL ENGINEERING)
R.C.E. (P.W. ENGINEER)
R.S.E. NO. 104 (H) K.M.C.

CERTIFICATE OF GEO-TECHNICAL ENGINEER

IT IS CERTIFIED THAT THE COMPREHENSIVE GEO-TECHNICAL REPORT ON SOIL INVESTIGATION HAS BEEN PREPARED BY ME FOR DESIGN AND CALCULATION OF THE FOUNDATION BY ANALYZING THE SOIL SAMPLE FOR ESTIMATING THE BEARING CAPACITY OF THE SOIL ON WHICH FOUNDATION OF THE STRUCTURE WILL BE CONSTRUCTED. I SHALL ALSO CHECK THE NATURE OF THE SOIL AFTER EXCAVATION AT SITE SO THAT FOUNDATION IS EXTENDED UP TO APPROPRIATE DEPTH THAT HAS BEEN PROPOSED IN THE GEO-TECHNICAL REPORT.

SIGNATURE OF GEO-TECHNICAL ENGINEER

CERTIFICATE OF OWNER

CERTIFIED THAT I/HAVE COME THROUGH THE WEST BENGAL MUNICIPAL BUILDING RULES 2007 AND UNDERTAKE TO ABIDE BY THOSE RULES DURING AND AFTER THE CONSTRUCTION OF BUILDING AND WE SHALL NOT ON LATER DATE MAKE ANY ADDITION OR ALTERATION TO THIS PLAN.

SIGNATURE OF OWNER

Proposed B-G-VIII (Ht. 29.70 M) FLAT TYPE RESIDENTIAL BLDG. OF,
1) SRI JAGADISH CH. SADIHU,
2) SRI ARABINDA KR. SADIHU BOTH S/O LATE TARAPADA SADIHU
3) SMT. RITA SADIHU W/O SRI ARABINDA SADIHU 4) SMT. SARMILA SADIHU
W/O SRI JAGADISH CH. SADIHU, IN MOUZA-KANAINATSAL, J.L. NO.-76, R.S.
PLOT NO.-128/129/130, L.R. PLOT NO.-128/129/130, R.S. KH. NO.-34/L.R.
KH. NO.-67/68/69/70, AT MANALI, KULDIRAM PALLY, WARD NO.-11, HOLDING
NO.-348, P.S. & DIST. BURDWAN, UNDER THE MUNICIPALITY OF
BURDWAN.

TITLE—
TYPICAL FLOOR PLAN (2ND TO 8TH), ROOF PLAN (BLOCK-1 & 2), SECTION- CC, & NORTH SIDE ELEVATION (BLOCK-2).

PROJECT—
PROPOSED B-G-VIII (HT. 29.70 M) FLAT TYPE RESIDENTIAL BLDG. OF,
1) SRI JAGADISH CH. SADIHU,
2) SRI ARABINDA KR. SADIHU BOTH S/O LATE TARAPADA SADIHU
3) SMT. RITA SADIHU W/O SRI ARABINDA SADIHU 4) SMT. SARMILA SADIHU
W/O SRI JAGADISH CH. SADIHU, IN MOUZA-KANAINATSAL, J.L. NO.-76, R.S.
PLOT NO.-128/129/130, L.R. PLOT NO.-128/129/130, R.S. KH. NO.-34/L.R.
KH. NO.-67/68/69/70, AT MANALI, KULDIRAM PALLY, WARD NO.-11, HOLDING
NO.-348, P.S. & DIST. BURDWAN, UNDER THE MUNICIPALITY OF
BURDWAN.

RAJ AGRAWAL & ASSOCIATES
ARCHITECTS, PLANNERS & INTERIOR DESIGNERS,
88, HOY STREET (2ND FLOOR), KOLKATA-16

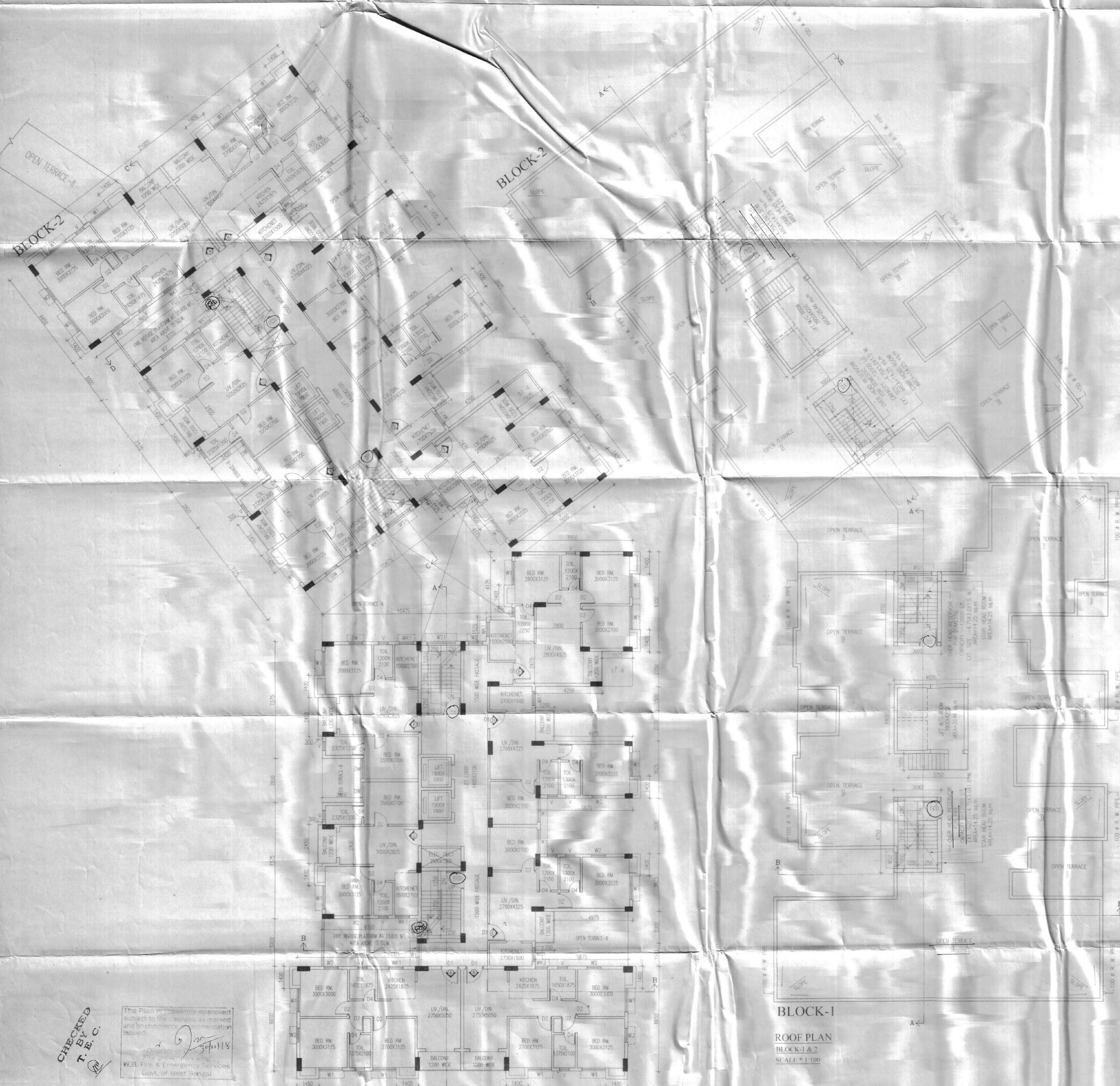

BLOCK-1
TYPICAL FLOOR (3RD TO 8TH) PLAN
BLOCK-1 & 2
SCALE * 1:100

BLOCK-1
ROOF PLAN
BLOCK-1 & 2
SCALE * 1:100

CHECKED
By
T. B. C.

The Plan is hereby approved
subject to the conditions as marked
and on compliance of the
recommendation issued.

Signature
The Chairman
W.B. Fire & Emergency Services
Govt. of West Bengal

Burdwan Municipality
Engineering Deptt. (Plan)
Regd. No. 1923
File Mark. 11-9
Date. 19/3/18