

PANCHMAHAL PROJECTS PVT. LTD.

11, MUKHRAM KANORIA ROAD, GROUND FLOOR,

HOWRAH - 711101

CIN NO: U45400WB2013PTC192403

LOCATION OF THE GULMOHAR HEIGHTS

"The Gulmohar Heights" is located at 11, Mukhram Kanoria Road, P.S – Golabari, P.O – Salkia, Howrah – 711101.

Latitude: - 48.833m=160'-2"

Longitude – 53.205m = 174'-6"

(angular distance)

[Boundary Declaration plan enclosed]

PANCHMAHAL PROJECTS PVT. LTD.

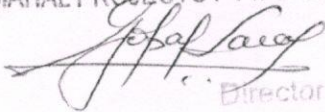
Director

SITE
PREMISES NO. - II,
MUKHARAM
KANORAI ROAD.

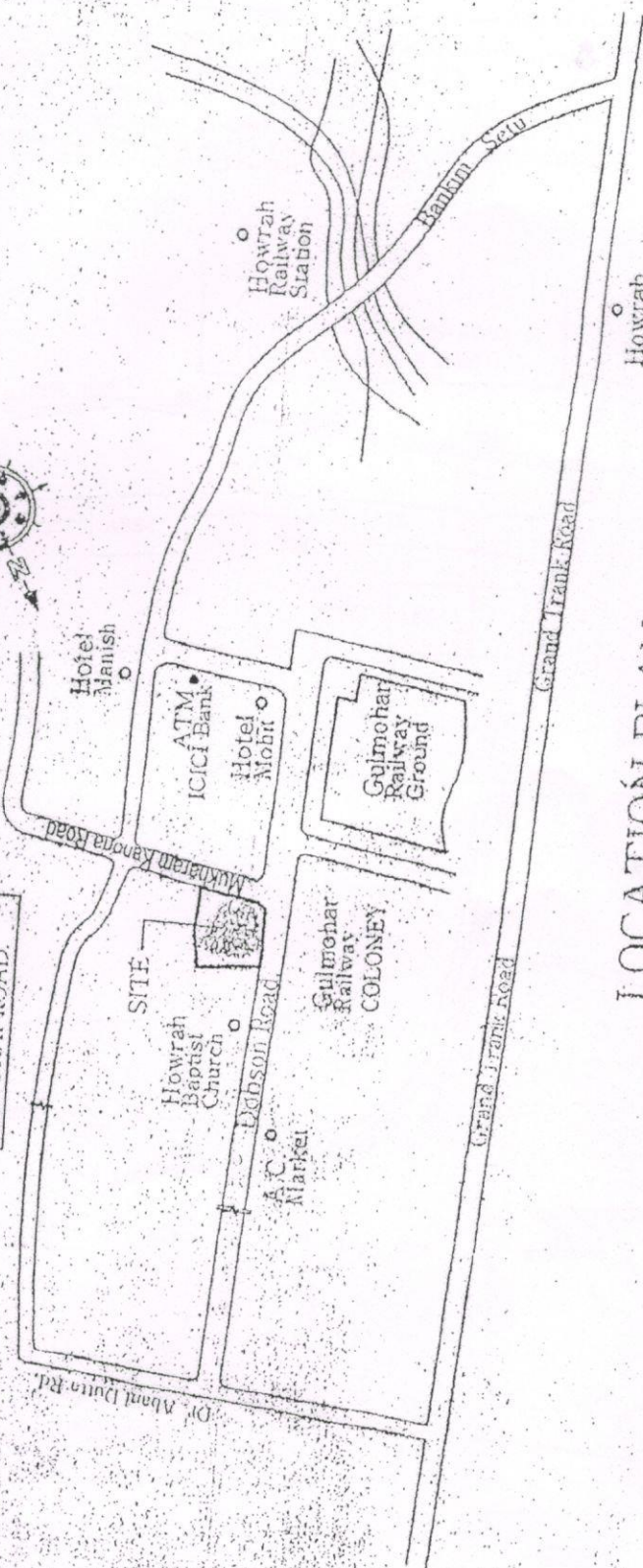

LOCATION PLAN
SCALE 1:4000

PANCHMAHAL PROJECTS PVT. LTD.

Director

SITE PLAN AT PREMISES NO. 11, MUKHRAM KANORIA ROAD, UNDER H.M.C.
 WARD NO.-14, DAG NO.-271 & 272, KHATIAN NO.-153, MOUZA & P.S.- GOLABARI,
 DISTRICT - HOWRAH

ASSEESSEE NO. - 21-06-72-0053-83
 AREA OF LAND (As per Physical Measurement) - 1329.431 Sq.M.(19K-14CH-00SQ.FT.)
 [N.B. : Boundary marked by Red Border Line]



SCALE 1:300

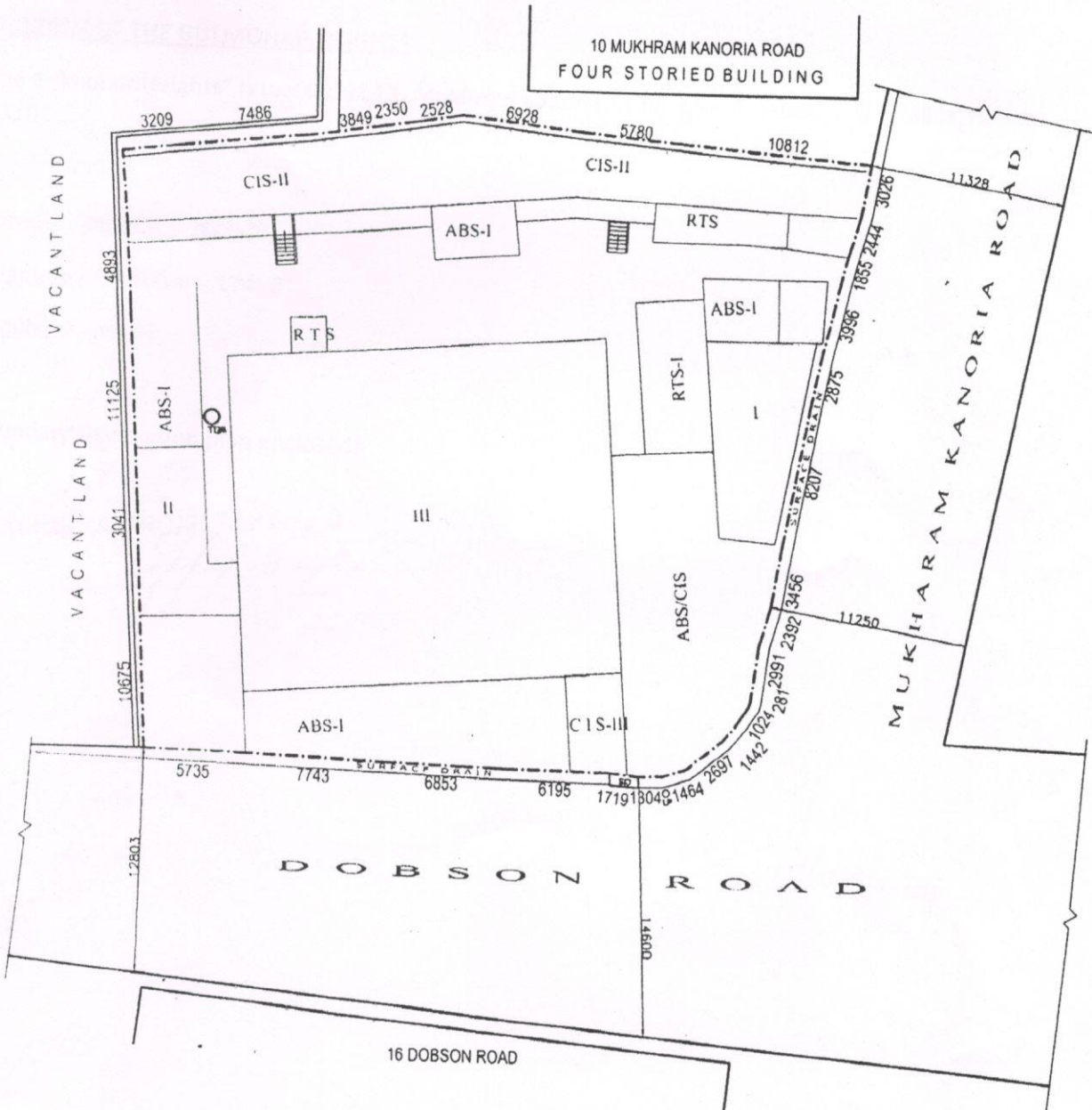

Drawn By : Architect ANANTA MONDAL

(Signature of Owners)