

ROOF PLAN
SCALE-1:100

FRONT ELEVATION
SCALE-1:100

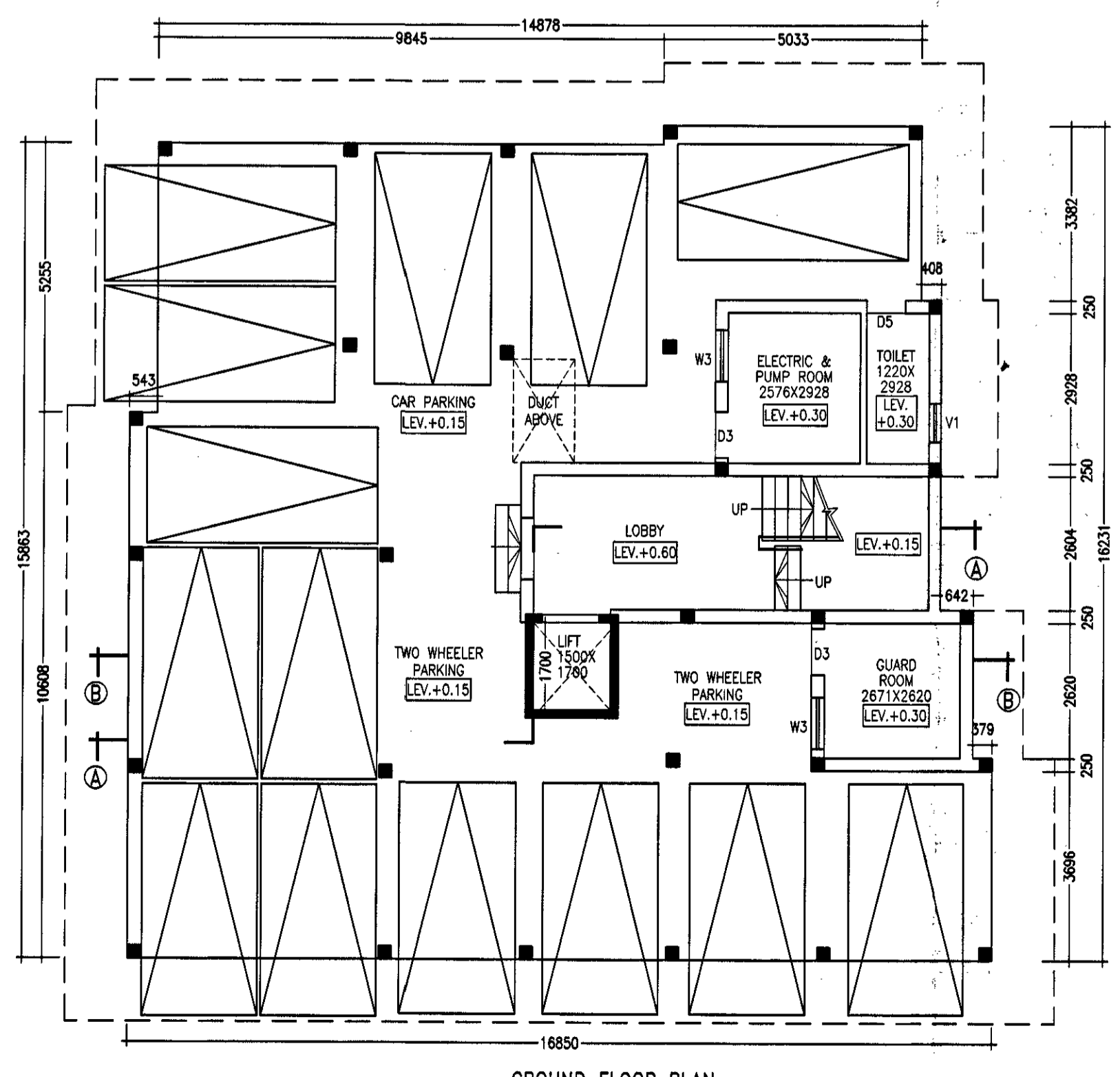

GROUND FLOOR PLAN
SCALE-1:100

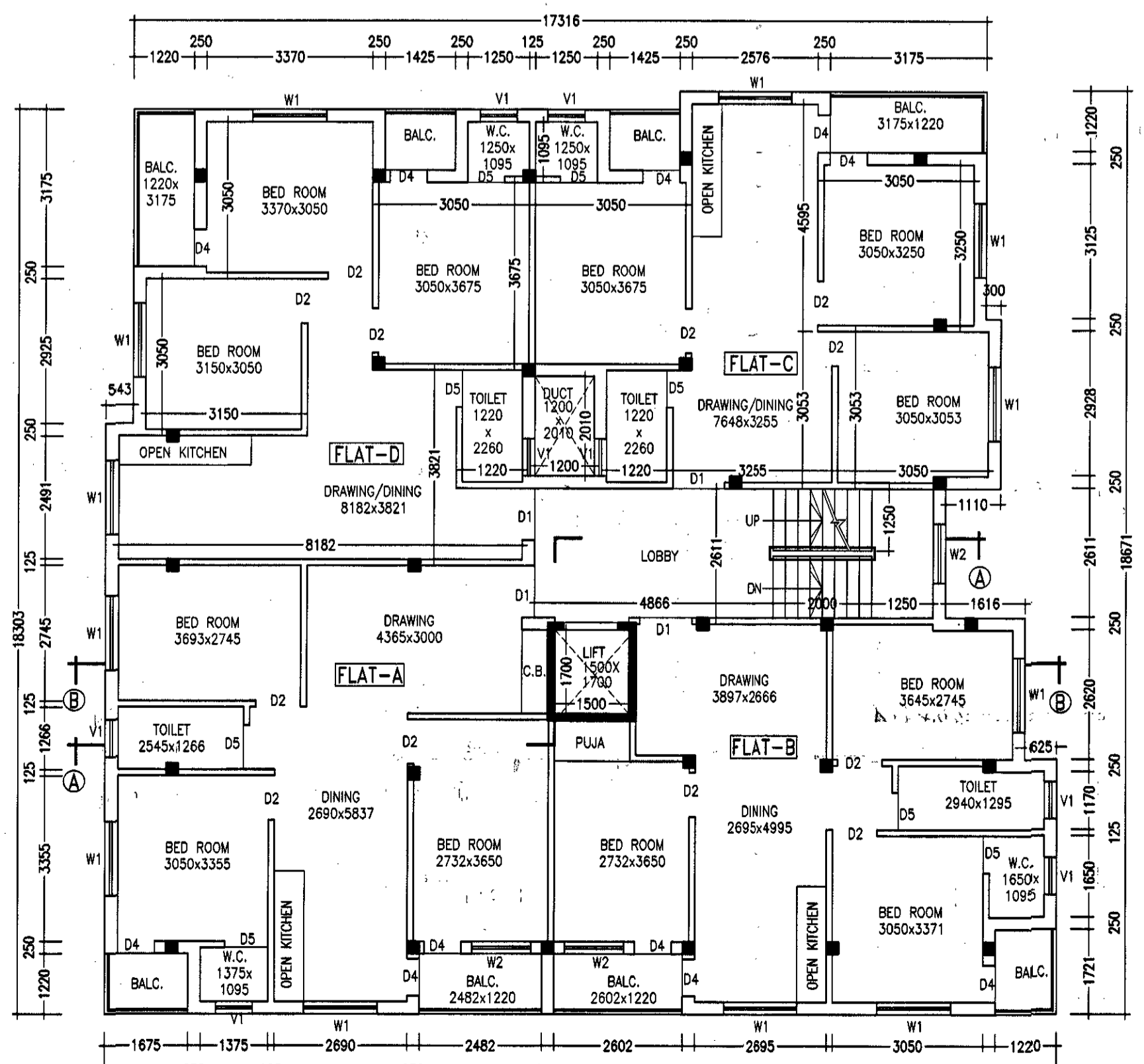

TYPICAL FLOOR PLAN
SCALE-1:100

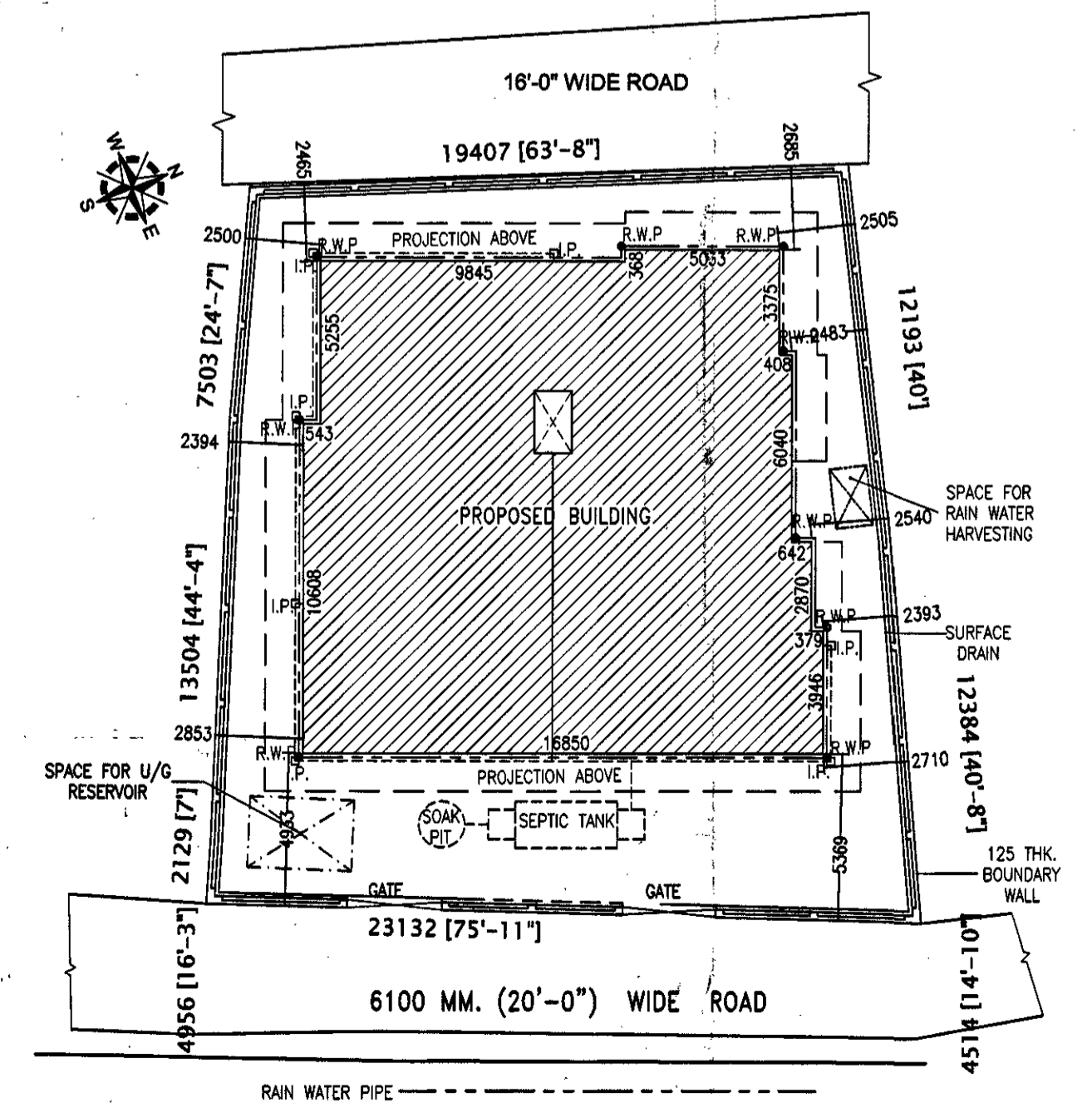

SITE PLAN
SCALE-1:200

NOTES
 • ALL DIMENSIONS ARE IN M.M. AND ALL LEVEL ARE IN M.
 • WRITTEN DIMENSIONS MUST BE FOLLOWED
 • OWNERS PLOT SHOWN IN RED COLOR

SPECIFICATIONS

1. ALL EXTERNAL WALLS 250TH. & INTERNAL WALLS 125 THK. UNLESS OTHERWISE MENTIONED.
2. ALL MASONRY WORKS ARE BOUNDED BY CEMENT MORTAR (1:6) & (1:4).
3. EXTERNAL PLASTER IS 25THK. & INTERNAL PLASTER IS 12MM. THK.
4. ALL CONC. GRADE IS M25 & AND GRADE OF STEEL FE-500
5. 250 THK. BRICK WORK IN 1:6 MORTAR
6. 125 THK. & 75 THK. BRICK WORK IN 1:4 MORTAR
9. 150 WIDE SURFACE DRAIN SHOULD BE PROVIDED ALL ROUND THE BUILDING.
10. 25% OF THE BUILDING TO BE CONSTRUCTED USING FLY-ASH BRICKS

DOORS AND WINDOWS SCHEDULE

TYPE	WIDTH	HEIGHT	REMARKS
D	1200	2100	PANEL DOOR
D1	1050	2100	DO
D2	900	2100	DO
D3	900	2100	FLUSH DOOR
D4	750	2100	DO
D5	750	2100	P.V.C DOOR
W1	1500	1300	GLAZED SHUTTER
W2	1200	1300	DO
W3	1000	1300	DO
V1	750	600	DO

AREA STATEMENT

1. LAND AREA - 486.24 SQ.M/ 5232.00 SQ.FT./7.26 Katha
2. GROUND FLOOR - 254.73 SQ.M/ 2740.89 SQ.FT.
3. FIRST FLOOR - 331.92 SQ.M/ 3571.46 SQ.FT.
4. SECOND FLOOR - 331.92 SQ.M/ 3571.46 SQ.FT.
5. THIRD FLOOR - 331.92 SQ.M/ 3571.46 SQ.FT.
6. FOURTH FLOOR - 331.92 SQ.M/ 3571.46 SQ.FT.
7. PROPOSED TOTAL BUILT UP AREA - 1582.41 SQ.M. / 17026.73 SQ.FT. (INCLUDING CAR PARKING)
8. TOTAL BUILT UP AREA FOR F.A.R - 1228.6 SQ.M. (EXCLUDING CAR PARKING & SERVICES AT EACH FL.)
9. FLOOR AREA RATIO - 1228.6 / 486.24 = 2.53
10. PARKING AT GROUND FL. - 202.52 SQ.M.
11. SERVICES IN GROUND FLOOR - 52.21 SQ.M.
12. SERVICES AT EACH FL. - 24.77 SQ.M.
13. GROUND COVERAGE - (254.73/486.24)*100 = 52.39 %

PROJECT NAME
 PROPOSED PLAN OF G+4 STORIED RESIDENTIAL (APARTMENT) BUILDING, BY THE NAME OF "SUNRISE" OF SMT. SANGEETA KUNDU & PRABUDDHA KUNDU OVER L.R. PLOT NO. - 2725, KHATIAN NO.-2875 & 2876, MOUZA -ARRAH, J.L. NO-91, P.S. KANKSHA, DIST- PASCHIM BARDHAMAN.

SIGNATURE OF OWNER
 Prabuddha Kundu
 Sangeeta Kundu

SIGNATURE OF L.B.S./ENGINEER/ARCHITECT
 VIJAYA SINGH MAZUMDER
 Consulting Architect
 DMC REGISTERED
 4332802166, 9476426108
 LIC NO. - DMC/BPD/60

SIGNATURE OF PANCHAYAT PRADHAN
 Approved vide Memo NO-DE/SP/BDP/146 Dt-21/01/2021 of District Engineer, Paschim Bardhaman. Billa furnished.
 APPROVED
 Pradhan
 01/02/2021
 Malaindighi Gram Panchayat

PROJECT TITLE
 GROUND FLOOR PLAN, TYPICAL FLOOR PLAN, SITE PLAN, FRONT ELEVATION.
 SCALE-1:100 OR AS SHOWN
 DATE- 28.09.2022
 SHEET NO.-MN/APT(PANC)-2020-08/GENS/A-1