

ELEVATION AT SIDE A

SECTION BB

SECTION AA

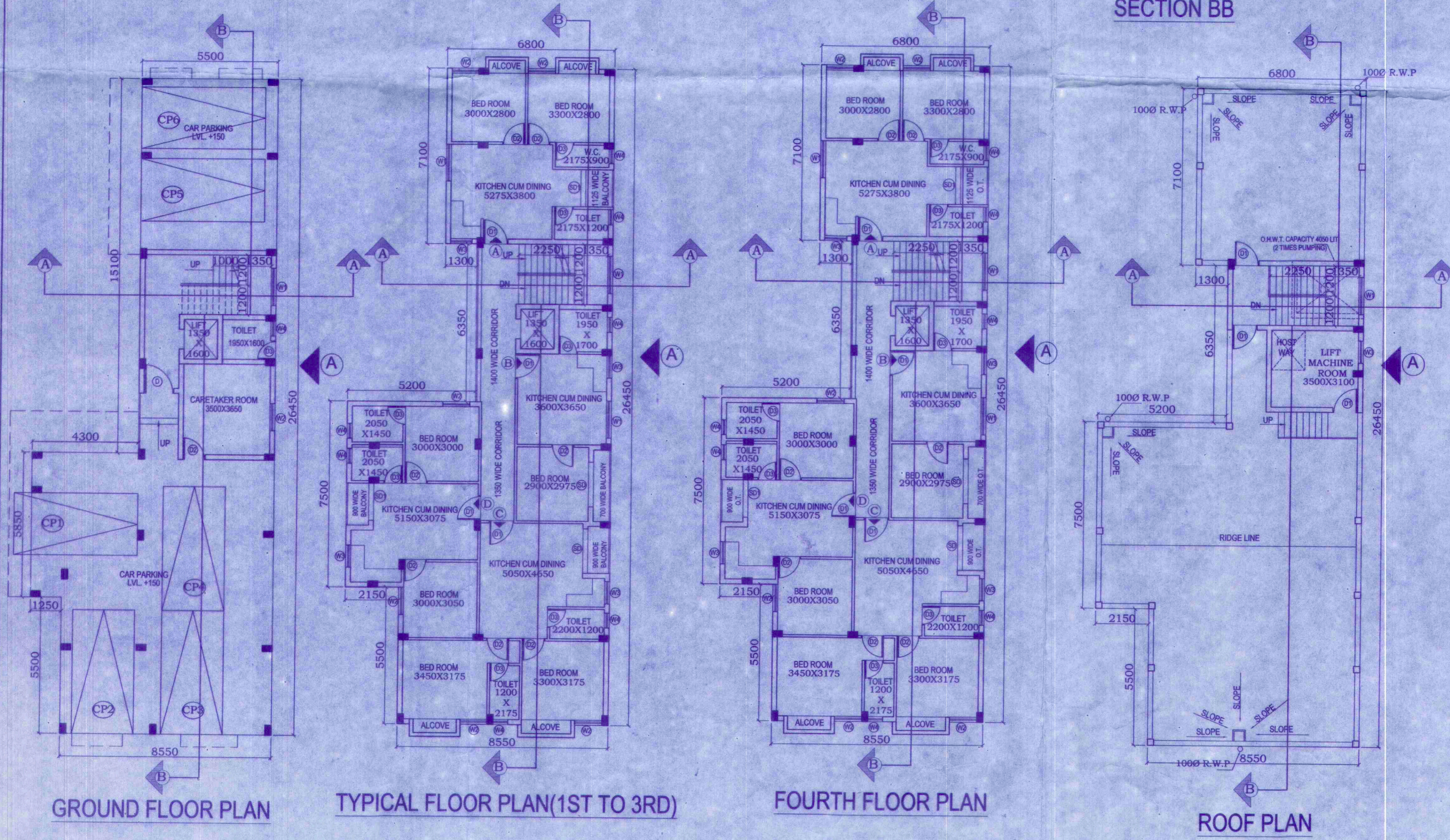

GROUND FLOOR PLAN

TYPICAL FLOOR PLAN(1ST TO 3RD)

FOURTH FLOOR PLAN

ROOF PLAN

REVISED G+4 STORIED RESIDENTIAL COMPLEX AT MOUZA-BHATENDA, J.L.NO.-28,L.R KHATIAN NO.- 483, 597, 692, 720, 1112,1501,1502, 1503, 2979, 2981,2984,2986,2987,4715,4145, R.S & L.R DAG NO.- 542, 545,546,542/806 (P), P.S.- RAJARHAT, DIST.- 24 PARGANAS (N) , UNDER RAJARHAT BISHNUPUR 1 NO. GRAM PANCHAYAT.

CERTIFICATE OF THE ARCHITECT:
I CERTIFY THAT ALL THE ARCHITECTURAL DRAWINGS OF REVISED G+4 STORIED RESIDENTIAL COMPLEX AT MOUZA-BHATENDA, J.L.NO.-28,L.R KHATIAN NO.- 483, 597, 692,720,1112,1501,1502, 1503, 2979, 2981, 2984, 2986, 2987, 4715,4145, R.S & L.R DAG NO.- 542, 545,546,542/806 (P) , P.S.- RAJARHAT, DIST.- 24 PARGANAS (N) , UNDER RAJARHAT BISHNUPUR 1 NO. GRAM PANCHAYAT HAVE BEEN DESIGNED AND DRAW UP STRICTLY AND ACCORDINGLY, AS STIPULATED IN THE NEW TOWN KOLKATA PLANNING AREA BUILDING RULES 2014, AND ALSO THE GENERAL BUILDING REQUIREMENTS OF THE NATIONAL BUILDING CODE OF INDIA AND OTHER RELEVANT CODES.

(Signature)
AMITAV BISWAS
Chartered Architect
CA/2010/47702

SIGNATURE OF ARCHITECT
PRAKALPA
145, NAM GOPAL ROY CHOWDHURY AVENUE, Mezzanine & 2nd floor, KOLKATA - 700 014
T: 033 64507757, WEB SITE: www.prakalpa.in
E-MAIL: prakalpa.arch@gmail.com

CERTIFICATE OF THE STRUCTURAL ENGINEER:
I CERTIFY THE STRUCTURE DESIGN AND DRAWING OF THE BOTH FOUNDATION AND SUPER STRUCTURE OF THE BUILDING HAVE BEEN MADE BY ME CONSIDERING ALL POSSIBLE LOADS INCLUDING SEISMIC LOAD AS PER N.B.C. OF INDIA AND CERTIFIED THAT IT IS SAFE AND STABLE IN ALL RESPECT SOIL TESTING REPORT HAS BEEN DONE BY SRI. SUBHANKAR ROY OF BS PROJECTS & ENGINEERS PVT.LTD, HAS BEEN CONSIDERED DURING STRUCTURAL CALCULATIONS.

(Signature)
M.S. WASHA
M.E. (Struct), C.E.
258-92 (I)
AO-89, Sec-II, Salt Lake

SIGNATURE OF THE STRUCTURAL ENGINEER

CERTIFICATE OF OWNER:
I DO HEREBY UNDERTAKE WITH FULL RESPONSIBILITY THAT:
i) I SHALL ENGAGE L.B./A/ E.S.E DURING CONSTRUCTION.
ii) I SHALL FOLLOW THE INSTRUCTION OF L.B./A/ E.S.E DURING CONSTRUCTION OF THE BUILDING AS PER B.S. PLAN.
iii) IF ANY SUBMITTED DOCUMENTS ARE FOUND TO BE FAKE, THE AUTHORITY WILL REVOKE THE SANCTION PLAN.
iv) CERTIFIED THAT I SHALL NOT ON A LATER DATE MAKE ANY ADDITION OR ALTERATION TO THIS PLAN.
v) CERTIFIED THAT I HAVE GONE THROUGH THE NATIONAL BUILDING CODE OF INDIA AND ALSO ABIDE BY THOSE RULES DURING AND AFTER CONSTRUCTION OF THE BUILDING.

(Signature)
DR. ROMAN
DIRECTOR OF BASU CONSTRUCTION PVT. LTD
CONSTITUTED BODY OF AUTHORITY MEMBER OF:
1) SANJIT SADRUKHAN 2) REKHAWATI SADRUKHAN
3) SHENATI SADRUKHAN 4) RAJATI SADRUKHAN
5) ANUVA SADRUKHAN 6) KANITA SADRUKHAN
7) RANU SADRUKHAN 8) RANU SADRUKHAN
9) SUPARNA PALIY SANGITA PRASAD
10) MUKTI SANA 11) ANUVA SADRUKHAN

AUTHORIZED SIGNATORY
TITLE: GROUND FLOOR PLAN, TYPICAL FLOOR PLAN(FIRST TO THIRD),FOURTH FLOOR PLAN, ELEVATION OF SIDE A, SECTION AT 'A-A' & 'B-B' OF BLOCK 3

DRAWN BY: DEBINA	DATE: 17.10.19
CHECKED BY: AMITAV BISWAS	REVISION NO.
APPROVED BY:	
SCALE: 1:100	SUBMISSION DRAWING
BASU CONSTRUCTION PVT. LTD	

WINDOWS				DOORS		
MARKED	WIDTH	HEIGHT	SILL	MARKED	WIDTH	HEIGHT
W1	1500	1350	750	D	2000	2100
W2	1100	1350	750	D1	1000	2100
W3	900	1100	1000	D2	900	2100
W4	600	900	1200	D3	750	2100
				SD	1800	2100
				SD1	1500	2100

1. ALL DIMENSIONS ARE IN MM

FOR APPROVAL:
The structural analysis reports & soil reports are kept for reference in this office. The certificate is accorded subject to certificate of Architect, Sr. Engineer, Geo. Tech. Engineer.
(Signature)
District Engineer
24 Parganas Zilla Parishad