

SITE PLAN OF PLOT NO.- A&B, AREA= 9K.-04CH.-20Sft (M/L), HOLDING-.....(ANANDAPURI 'A' ROAD), WARD NO.-....., UNDER BARRACKPORE MUNICIPALITY, BEING IN THE PART OF C.S. DAG.NOS.-1187,1188&1186, R.S. DAG. NOS.- 7687,7651&7688, R.S KHATIAN NO.-711&992, OF MOUZA 'CHANAK', J.L. NO.-04, R.S. NO.-39 TOUZI NO.-2998, P.S.-TITAGARH, DIST.-NORTH 24 PARGANAS.

"ACCORDING TO MOUZA MAP & PEVIOUS PLAN FROM DEED NO.-1-5594/1991 PLOT POSITION RECOMMENDED"

P/R.S. DAG. NO.-7687,7651&7688, AREA= 9K.-04Ch.-20Sft (M/L)
SHOWN IN RED MARKED

SCALE - 1" = 18'

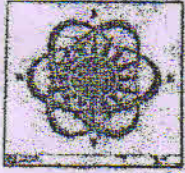

OWNER OF THE PROPERTY

- 1) শ্রী পরিচয় কুমার সিংহ
- 2) শ্রী মনীষ কুমার সিংহ
- উজ্জয়ন্ত গির্জা
- শ্রী পুন চন্দ্র সিংহ

DETAIL OF PLOT				
MOUZA	C.S. DAG.	R.S. DAG.	PLOT	TOTAL AREA
CHANAK, J.L. NO.-04	1187	7687	-	4K.-07CH.-37Sft (M/L)
	1188	7651	-	3K.-00CH.-16Sft (M/L)
	1186&1187	7688	-	1K.-12CH.-12Sft (M/L)
TOTAL AREA				9K.-04CH.-20Sft (M/L)

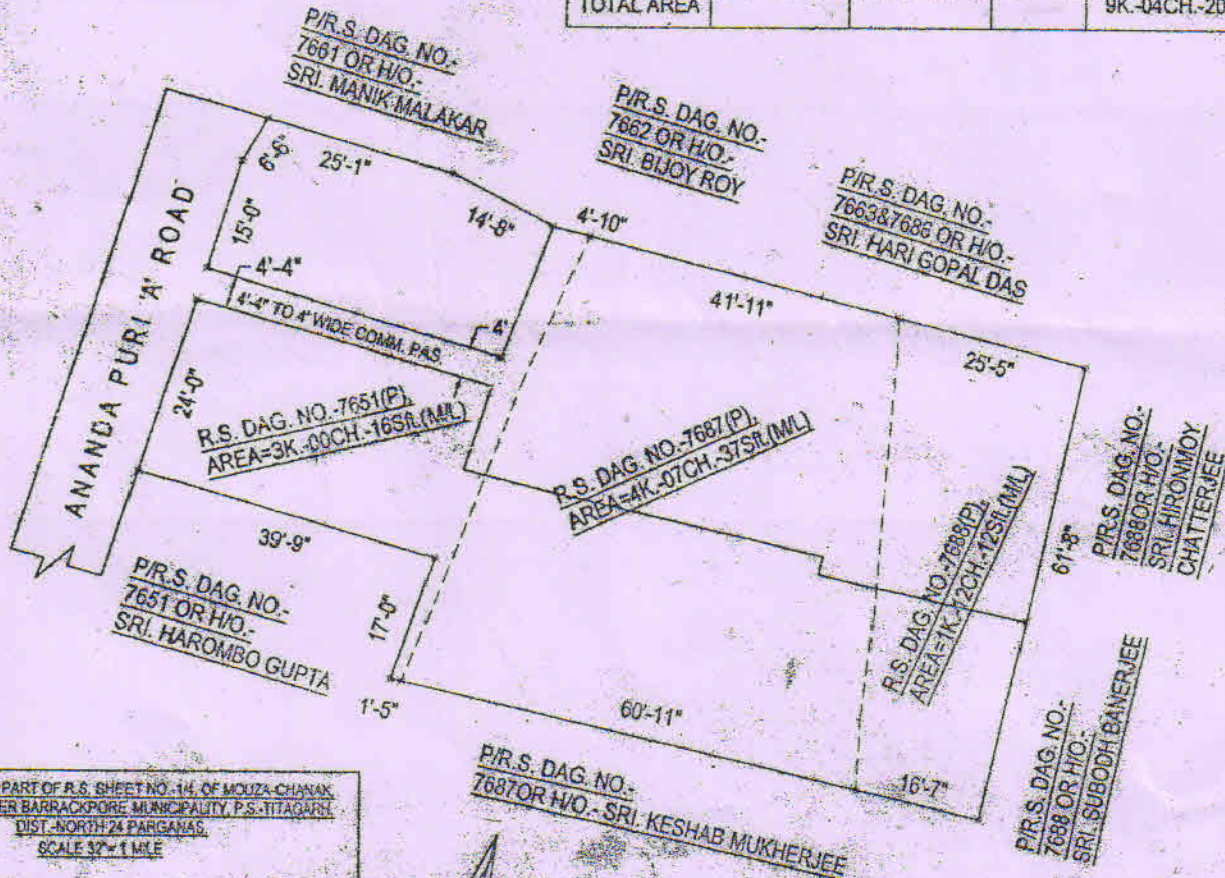

AN EXTRACTED PART OF R.S. SHEET NO. 14, OF MOUZA CHANAK, J.L. NO. 04, UNDER BARRACKPORE MUNICIPALITY, P.S. TITAGARH, DIST. NORTH 24 PARGANAS, SCALE 32" = 1 MILE

OWNER SIGNATURES

SATISH CONSTRUCTION

Satish Roy

Proprietor

SK. UJIR ALI
SURVEYOR WITH PLANNER
(ALIAH UNIVERSITY, W.B.)
C. R. No. - 5791
L. C. No. - AA1035
Res. :- Rulya, Patulia, Kol-780110
Date :- 12/07/2015

DRAWING BY