

LONGITUDE-22.770259

LATITUDE-88.339236

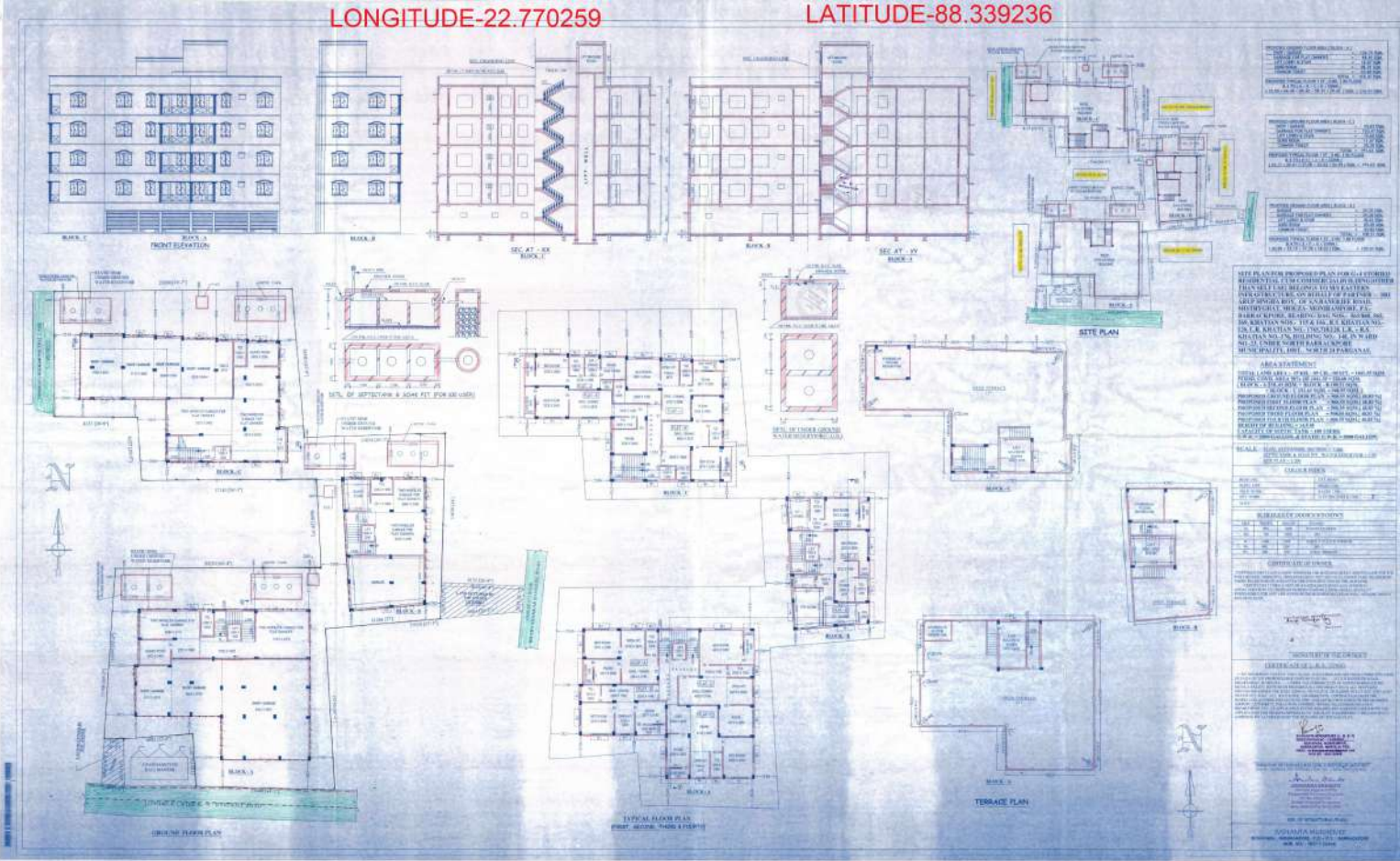

NO.	DESCRIPTION	DATE
1	PRELIMINARY	10/10/2010
2	REVISED	10/10/2010
3	REVISED	10/10/2010
4	REVISED	10/10/2010
5	REVISED	10/10/2010
6	REVISED	10/10/2010
7	REVISED	10/10/2010
8	REVISED	10/10/2010
9	REVISED	10/10/2010
10	REVISED	10/10/2010

NOTE: THIS PLAN IS FOR INFORMATION ONLY. IT IS NOT TO BE USED FOR CONSTRUCTION. THE CLIENT IS RESPONSIBLE FOR OBTAINING ALL NECESSARY PERMITS AND APPROVALS FROM THE LOCAL AUTHORITIES. THE ARCHITECT ASSUMES NO LIABILITY FOR ANY DAMAGE OR INJURY RESULTING FROM THE USE OF THIS PLAN.

AREA STATEMENT: THE AREA IS A MIXED-USE DEVELOPMENT. THE BUILDING WILL BE USED FOR OFFICE, RETAIL, AND RESIDENTIAL PURPOSES. THE ARCHITECT HAS CONDUCTED VISUAL ANALYSES AND HAS IDENTIFIED VISUAL CORRIDORS AND VIEWSHEDS. THE ARCHITECT HAS DESIGNED THE BUILDING TO BE SENSITIVE TO THE SURROUNDING ENVIRONMENT AND TO PRESERVE AND ENHANCE THE VISUAL QUALITY OF THE AREA.

SCALE: 1/8" = 1'-0" (VERTICAL) AND 1/4" = 1'-0" (HORIZONTAL). UNLESS OTHERWISE NOTED, ALL DIMENSIONS ARE IN FEET AND INCHES.

REVISIONS:

NO.	DESCRIPTION	DATE
1	ISSUED FOR PERMITTING	10/10/2010
2	REVISED	10/10/2010
3	REVISED	10/10/2010
4	REVISED	10/10/2010
5	REVISED	10/10/2010
6	REVISED	10/10/2010
7	REVISED	10/10/2010
8	REVISED	10/10/2010
9	REVISED	10/10/2010
10	REVISED	10/10/2010

DESIGNER: [Signature]

DATE: 10/10/2010

PROJECT: [Project Name]

LOCATION: [Location]

SCALE: 1/8" = 1'-0" (VERTICAL) AND 1/4" = 1'-0" (HORIZONTAL). UNLESS OTHERWISE NOTED, ALL DIMENSIONS ARE IN FEET AND INCHES.