

SCHEDULE OF R.C.C COLUMN

COLUMN MKD.	SIZE UP TO 10TH FL.	REINFORCEMENT			SIZE UP TO 10TH FL.	REINFORCEMENT			SIZE UP TO 10TH FL.	REINFORCEMENT			LINKS
		BMT FL. BAR	GR. FL. BAR	1ST FL. BAR		2ND FL. BAR	3RD FL. BAR	4TH FL. BAR		5TH FL. BAR	6TH FL. BAR	7TH FL. BAR	
C1	2000	26-25E	26-25E	4-25E @ 22.20E	200 X 1500	26-16E	26-16E	26-16E	200 X 1500	26-16E	26-16E	26-16E	
C1CR	300 X 1500	26-25E	26-25E	4-25E @ 22.20E	300 X 1500	26-16E	26-16E	26-16E	300 X 1500	26-16E	26-16E	26-16E	
C9	350 X 1500	24-32E	24-32E	24-25E	350 X 1500	24-20E	24-20E	24-20E	350 X 1500	24-20E	24-20E	24-20E	
C15	400 X 1500	22-32E	22-32E	22-25E	400 X 1500	22-20E	22-20E	22-20E	400 X 1500	22-20E	22-20E	22-20E	
C4	1000 X 1200	24-32E	24-32E	4-25E @ 20-20E	1000 X 1200	24-16E	24-16E	24-16E	1000 X 1200	24-16E	24-16E	24-16E	
C5 C6	1000E	26-32E	26-32E	6-25E @ 20-20E	1000 X 1500	26-20E	26-20E	26-20E	1000 X 1500	26-20E	26-20E	26-20E	
C2	250 X 4000	44-25E	44-25E	10-25E @ 24-20E	250 X 4000	44-20E	44-20E	44-20E	250 X 4000	44-20E	44-20E	44-20E	
C11	12000	20-32E	20-32E	10-25E @ 10-25E	300 X 1500	20-25E	20-25E	20-25E	300 X 1500	20-25E	20-25E	20-25E	
C16	12000	20-32E	20-32E	10-25E @ 10-25E	300 X 1500	20-25E	20-25E	20-25E	300 X 1500	20-25E	20-25E	20-25E	
C10 C13	11000	20-32E	20-32E	10-25E @ 10-25E	300 X 1500	20-25E	20-25E	20-25E	300 X 1500	20-25E	20-25E	20-25E	
C17 C18	11000	18-32E	18-32E	8-25E @ 10-25E	300 X 1500	18-25E	18-25E	18-25E	300 X 1500	18-25E	18-25E	18-25E	
C19	11000	20-25E	20-25E	20-25E	300 X 1500	20-20E	20-20E	20-20E	300 X 1500	20-20E	20-20E	20-20E	
C20 C21	11000	24-25E	24-25E	12-25E @ 12-20E	300 X 1500	24-20E	24-20E	24-20E	300 X 1500	24-20E	24-20E	24-20E	
C12	11000	22-32E	22-32E	12-25E @ 14-20E	300 X 1500	22-20E	22-20E	22-20E	300 X 1500	22-20E	22-20E	22-20E	
C14	400 X 4250	46-32E	46-32E	12-25E @ 14-20E	400 X 4250	46-20E	46-20E	46-20E	400 X 4250	46-20E	46-20E	46-20E	
C7	2500 X 300	26-25E	26-25E	2500 X 300	26-16E	26-16E	26-16E	2500 X 300	26-16E	26-16E	26-16E		
LIFT SHAFT	200 THK.	12E @ 150 C/C VERTICAL & 10E @ 200 C/C HORIZONTAL (B/W)											

SCHEDULE OF TIE BEAM

BEAM MKD.	BEAM SIZE	MAIN REINFORCEMENT		STIRRUPS	
		CONT. SUPPORT	SPAN	SUPPORT	SPAN
TB1	400 X 550	3-20E	3-20E	8E-2L @ 125 C/C	8E-2L @ 250 C/C
TB2	400 X 550	3-20E	3-20E	8E-2L @ 100 C/C	8E-2L @ 200 C/C
TB3	400 X 550	3-20E	3-20E	8E-2L @ 200 C/C ALTH.	
TB4	400 X 550	3-16E	3-16E	8E-2L @ 125 C/C	8E-2L @ 250 C/C

PILE CAP SCHEDULE

PILE CAP MKD.	DEPTH	ALONG LONGER SIDE		ALONG SHORTER SIDE		SKIN BAR
		TOP	BOT	TOP	BOT	
1000-3P	2000	25E @ 150 C/C	25E @ 100 C/C	25E @ 150 C/C	25E @ 150 C/C	5-12E
1000-2SP	2000	20E @ 118 C/C	20E @ 100 C/C	20E @ 100 C/C	20E @ 100 C/C	5-12E
1000-4P	2000	32E @ 100 C/C	25E @ 150 C/C	32E @ 125 C/C	25E @ 150 C/C	5-12E
1000-3P	2000	16E @ 200 C/C	20E @ 130 C/C	16E @ 130 C/C	20E @ 130 C/C	5-12E
600-1P	1200	6-12E	6-12E	6-12E	6-12E	3-12E

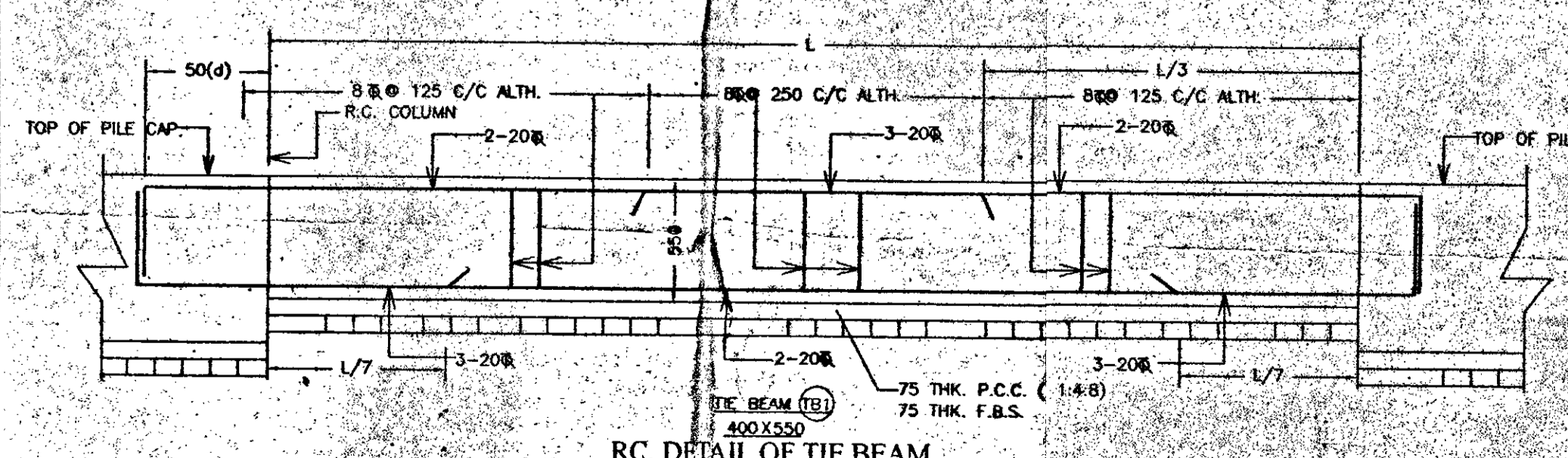
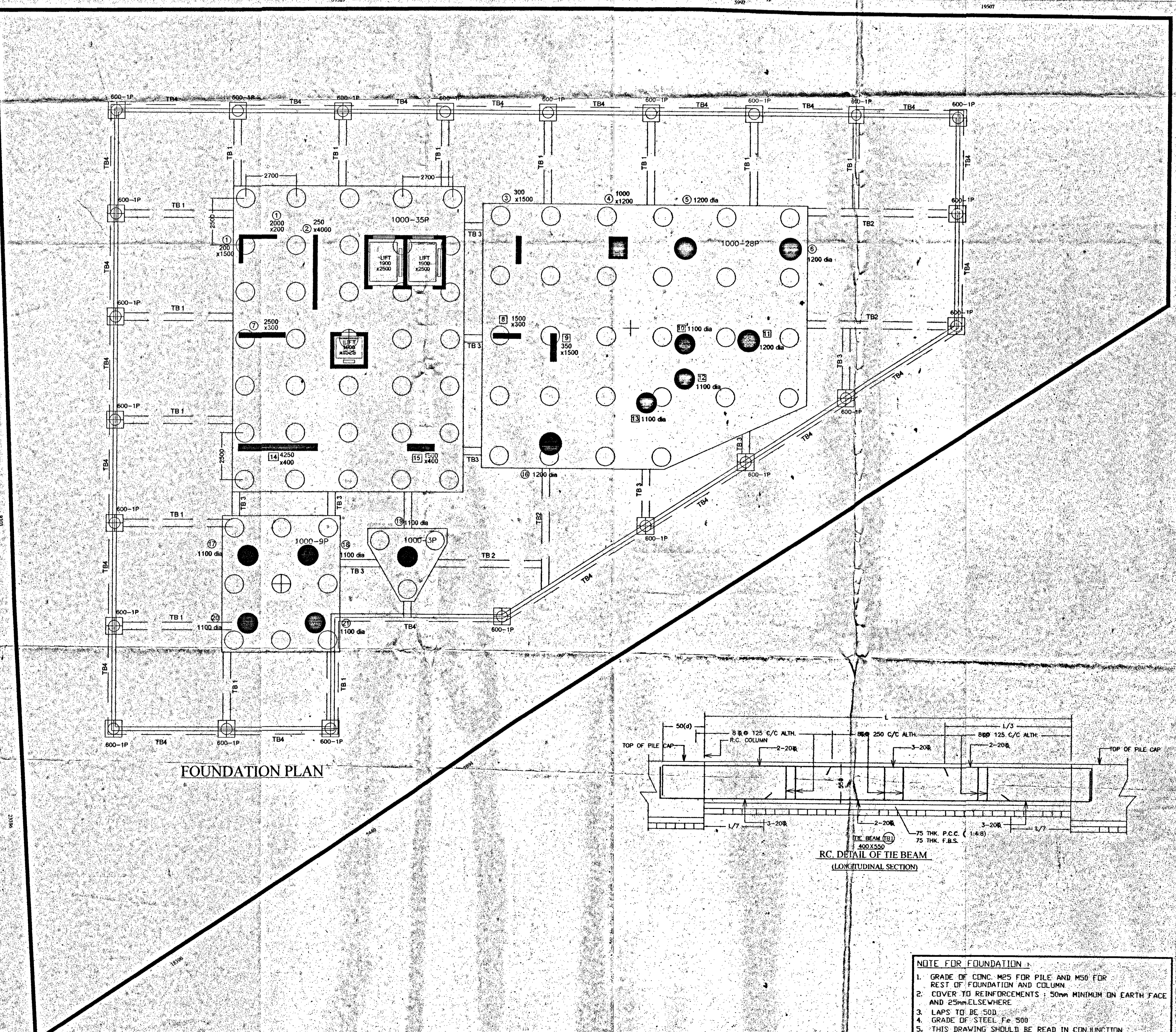
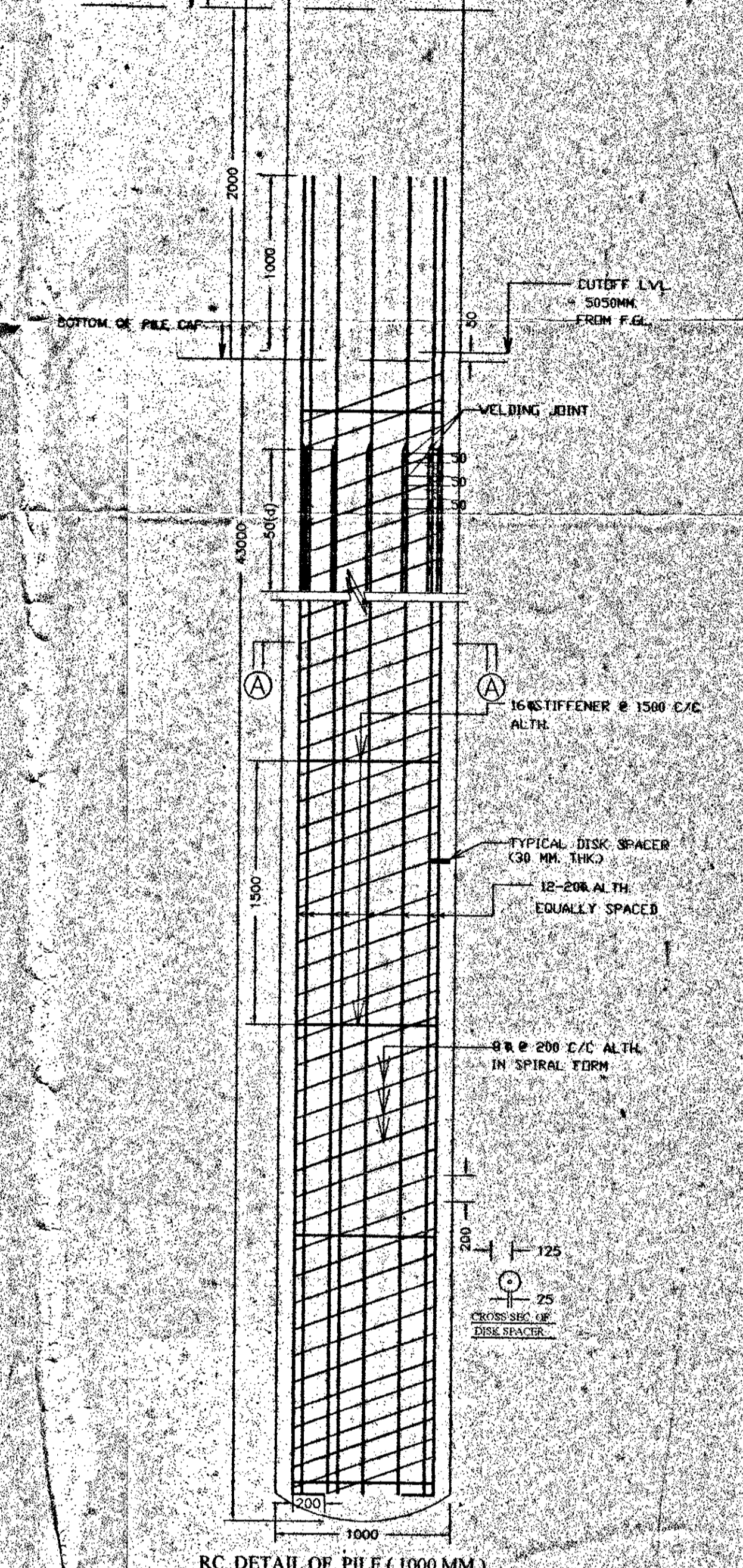
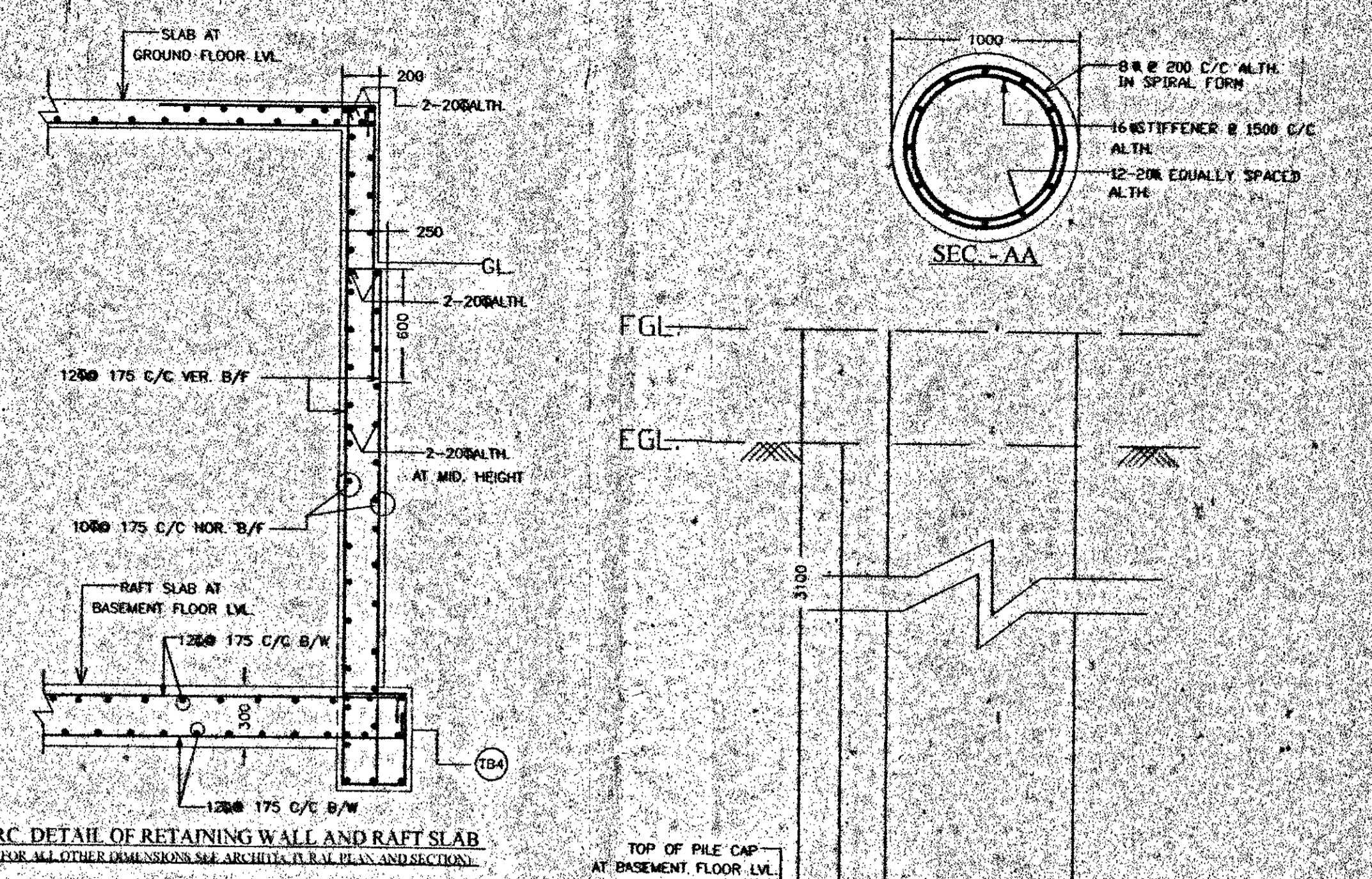
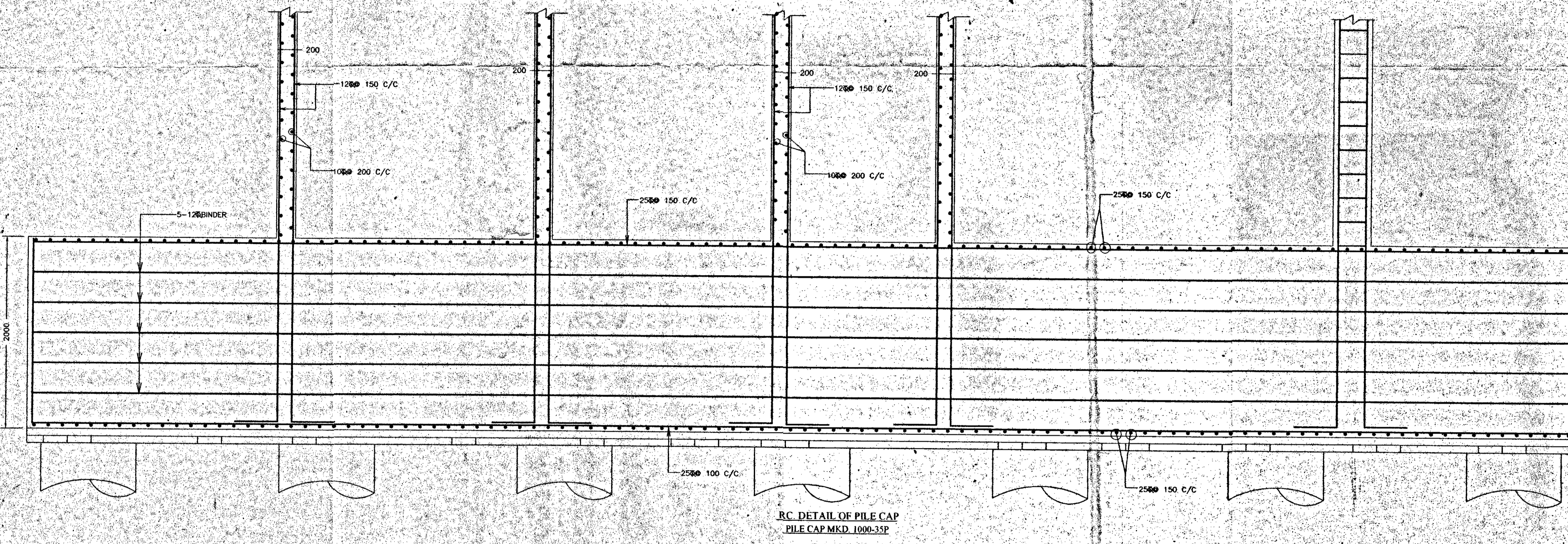

CHIRKASHING TANNERY

Signature of owner: *[Signature]*

THE STRUCTURAL DESIGNS DRAWINGS OF BOTH FOUNDATION AND SUPERSTRUCTURE OF THE BUILDING HAS BEEN MADE BY ME CONSIDERING ALL POSSIBLE LOADS INCLUDING THE SEISMIC LOAD AS PER THE NATIONAL BUILDING CODE OF INDIA AND CERTIFIED THAT IT IS SAFE AND STABLE IN ALL RESPECTS.

Signature of Structural Engineer: *[Signature]*

THE BUILDING HAS BEEN DRAWN UP AS PER THE PROVISION OF THE K.M.C. BUILDING RULES 2009 AND THAT THE SITE CONDITIONS INCLUDING THE WIDTH OF THE ABUTTING K.M.C. ROAD CONFIRM WITH THE PLAN AND THAT IT IS A BUILDABLE SITE AND NOT A TANK OR FILLED UP TANK. THE PLOT IS LYING VACANT AND DEMARCATED BY BRICK BUILT BOUNDARY WALL.

Signature of Architect: *[Signature]*

HARSH SANON
COUNCIL OF ARCHITECTURE
REGISTRATION NO. CA/90/13556

HARSH SANON
COUNCIL OF ARCHITECTURE
REGISTRATION NO. CA/90/13556

Signature of Architect: *[Signature]*

PROPOSED B+G+21 STORED RESIDENTIAL BUILDING (HT-80 M) AT PREMISES NO.104D/2 MATHESHWARTALA ROAD, KOLKATA-700046 WARD NO.-66, BOROUGH-VII, P.S.-TILJALA

FOUNDATION PLAN WITH REINFORCEMENT OF PILE, PILE CAP, TIE BEAM, COLUMN, RETAINING WALL AND RAFT SLAB

SCALE: 1:100 (1:25)

DATE: 10/06/2013

DESIGN BY: *[Signature]*

CHECKED BY: *[Signature]*

S&S

SANON SEN & ASSOCIATES (P) LTD.
ARCHITECTS, ENGINEERS & INTERIOR DESIGNERS
5, RUSSELL STREET, KOLKATA-700 071
PHONE: 221-2264579, 22172555
FAX: 2264 6917, E-MAIL: ssa@ssand.com

- NOTE FOR FOUNDATION:
- GRADE OF CONC. M25 FOR PILE AND M30 FOR REST OF FOUNDATION AND COLUMN
 - COVER TO REINFORCEMENTS: 50mm MINIMUM ON EARTH FACE AND 25mm ELSEWHERE
 - LAPS TO BE 50D
 - GRADE OF STEEL: Fe 500
 - THIS DRAWING SHOULD BE READ IN CONJUNCTION WITH RELEVANT ARCHITECTURAL DRAWINGS

PRODUCED BY AN AUTODESK EDUCATIONAL PRODUCT