

MAIN REINFORCEMENT										
BEAM MKD	BEAM SIZE	CONC. SUPPORT	TOP	BOT	SPAN	DISCONT. SUPPORT	TOP	BOT	STIRRUPS	SPAN
B1	300 X 600	2.10E+	4.25E	3.10E	4.25E	A.10E	3.25E	8E-2I @ 125 C/C	8E-2I @ 250 C/C	
B2	300 X 600	2.25E+	3.25E	1.10E+	5.25E	4.10E+	3.25E	8E-2I @ 100 C/C	8E-2I @ 200 C/C	
B3	300 X 600	2.10E+	6.30E	2.10E+	6.30E	2.10E+	5.30E	8E-4I @ 150 C/C	8E-4I @ 250 C/C	
B4	400 X 600	2.10E+	6.30E	2.10E+	6.30E	2.10E+	3.25E	10E-4I @ 150 C/C	10E-4I @ 250 C/C	
B5	500 X 600	2.10E+	8.25E	2.10E+	8.25E	2.10E+	2.10E+	10E-4I @ 150 C/C	10E-4I @ 250 C/C	
B6	500 X 600	2.10E+	5.25E	2.10E+	5.25E	2.10E+	4.25E	8E-4I @ 100 C/C	8E-4I @ 200 C/C	
B7	500 X 600	2.10E+	10.30E	2.10E+	10.30E	2.10E+	8.25E	10E-4I @ 150 C/C	10E-4I @ 250 C/C	
B8	400 X 600	2.10E+	9.30E	2.10E+	9.30E	2.10E+	7.25E	10E-4I @ 125 C/C	10E-4I @ 250 C/C	
B9	300 X 600	2.25E+	1.20E	2.25E+	1.20E	2.25E+	8E-2I @ 100 C/C	8E-2I @ 100 C/C		
B10	300 X 600	2.10E+	5.10E	2.10E+	5.10E	2.10E+	4.10E	8E-2I @ 125 C/C	8E-2I @ 250 C/C	
B11	500 X 600	2.25E+	7.25E	1.25E+	7.25E	2.10E+	5.25E	8E-2I @ 125 C/C	8E-2I @ 250 C/C	
B12	300 X 600	2.25E+	1.10E	2.25E+	1.10E	2.25E+	8E-2I @ 125 C/C	8E-2I @ 250 C/C		
B13	300 X 600	2.10E	3.10E	2.10E	3.10E	2.10E	8E-2I @ 150 C/C	8E-2I @ 250 C/C		

REINFORCEMENT				
SLAB MKD	SLAB THK	SHORTER SPAN	LONGER SPAN	SPAN (BOT)
S1	300 MM	10E @ 150 C/C	10E @ 175 C/C	14E @ 175 C/C
S2	143 MM	8E @ 150 C/C	8E @ 175 C/C	14E @ 175 C/C
S3	143 MM	8E @ 150 C/C	8E @ 175 C/C	14E @ 175 C/C
S4	100 MM	8E @ 200 C/C	8E @ 200 C/C	8E @ 200 C/C
S5	150 MM	10E @ 150 C/C	10E @ 150 C/C	8E @ 150 C/C
S6	150 MM	8E @ 150 C/C	8E @ 150 C/C	8E @ 150 C/C
S7	175 MM	17E @ 100 C/C	17E @ 100 C/C	17E @ 100 C/C

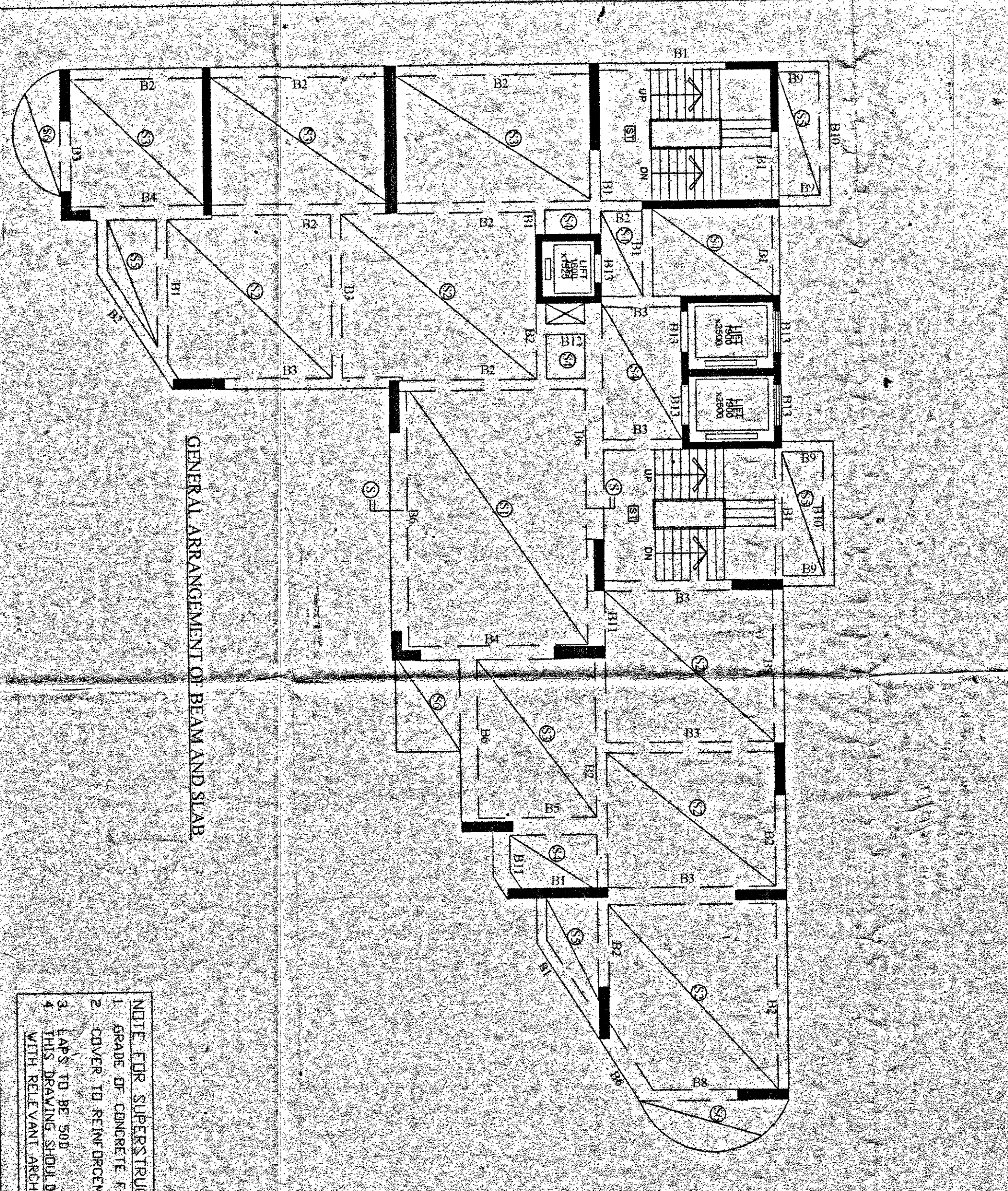
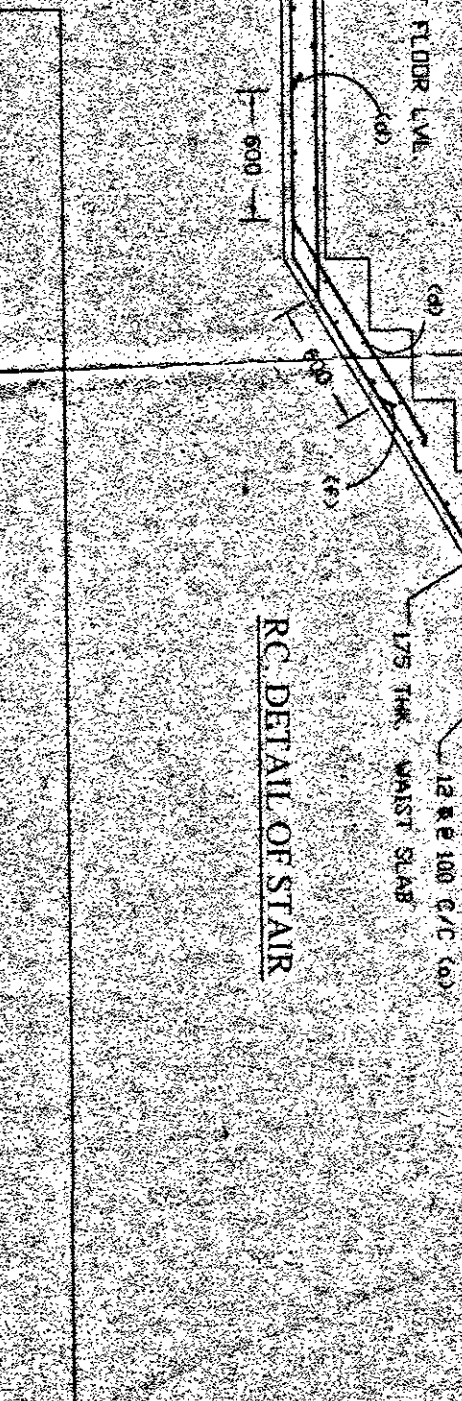
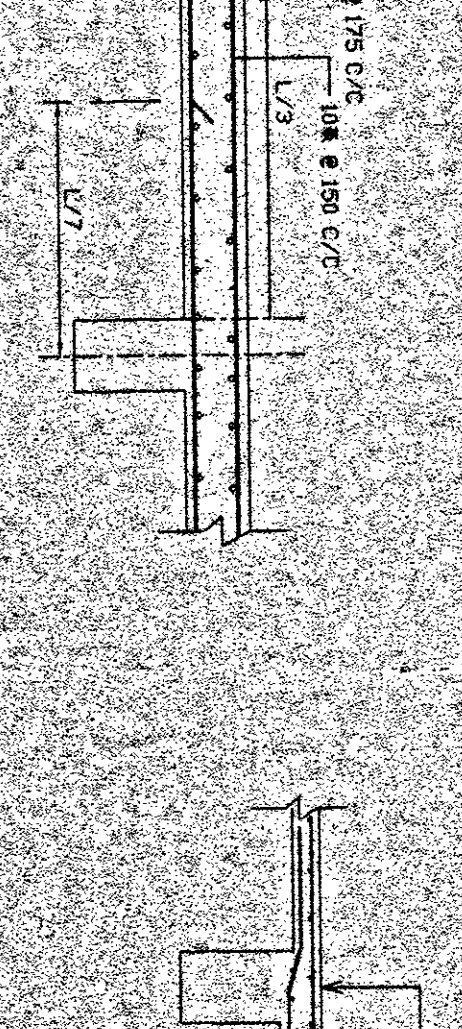
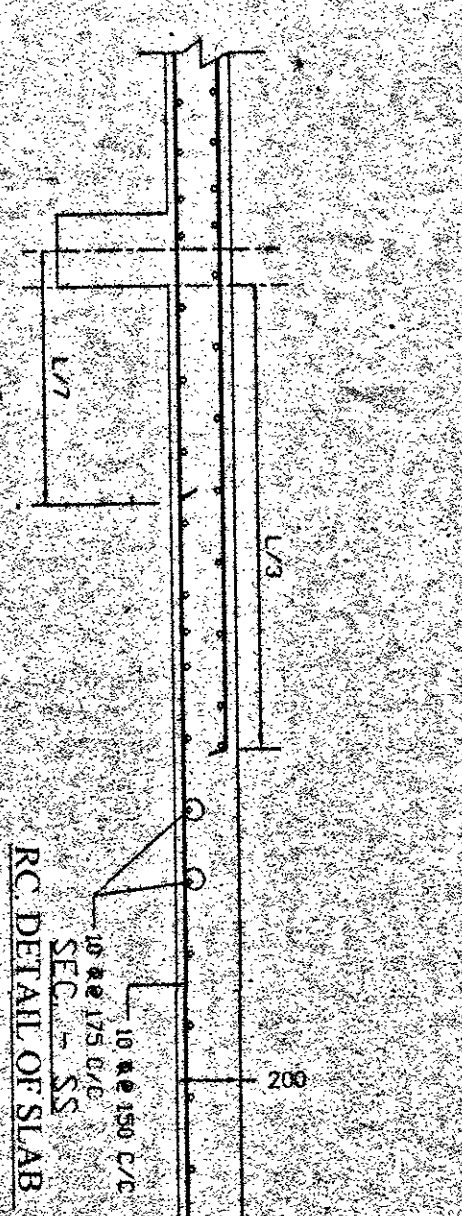

Signature of owner
CHITRA SHING JANNERY
 Director
 Signature of owner

Signature of Structural Engineer
Harsh Sandon
 COUNCIL OF ARCHITECTURE
 REGISTRATION NO. CA/90/13556
 Signature of Architect

Signature of Architect
Harsh Sandon
 COUNCIL OF ARCHITECTURE
 REGISTRATION NO. CA/90/13556
 Signature of Architect

THE BUILDING HAS BEEN DRAWN UP AS PER THE PROVISION OF THE K.M.C. BUILDING RULES 2009 AND THAT THE SITE CONDITIONS INCLUDING THE WIDTH OF THE ABUTTING K.M.C. ROAD CONFIRM WITH THE PLAN AND THAT IT IS A BUILDABLE SITE AND NOT A TANK OR FILLED UP TANK. THE PLOT IS DIVING VACANT AND DEMARCATED BY BRICK BUILT BOUNDARY WALL.

PROPOSED B+G+21 STORED RESIDENTIAL BUILDING (HT. -80 M) AT PREMISES NO. 104D/2 MATHESHWARTALA ROAD, KOLKATA-700046 WARD NO. -66, BOROUGH-VII, P.S. -TILJUALA

FOUNDATION PLAN WITH REINFORCEMENT OF PILE, PILE CAP, THE BEAM, COLUMN, RETAINING WALL AND RAFT SLAB

DATE: 02/09/2013

SCALE: 1/100

DR. NO: E/S-2

NO. OF SHEETS: 1

DATE: 02/09/2013

SCALE: 1/100

DR. NO: E/S-2

NO. OF SHEETS: 1

DATE: 02/09/2013

SCALE: 1/100

DR. NO: E/S-2

NO. OF SHEETS: 1

S&S ARCHITECTS ENGINEERS & INTERIOR DESIGNERS
 SANON SEN & ASSOCIATES (P) LTD.
 ARCHITECTS ENGINEERS & INTERIOR DESIGNERS
 PHONE: 91 33 272064578 / 22172505
 FAX: 2228 6917 E-MAIL: spon@sen.com