

SECTION XX

SCALE 1:50

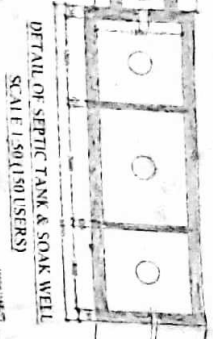

DETAIL OF SEPTIC TASK & SOAK WELL

SCALE 1:50 (150 LITERS)

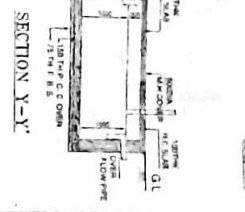

SECTION Y-Y'

SCALE 1:50

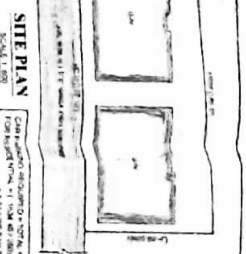

SITE PLAN

SCALE 1:50

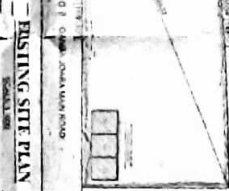

FINISHING SITE PLAN

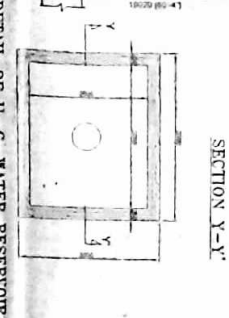

DETAIL OF U. G. WATER RESERVOIR

(CAPACITY - 16,000 LITERS)

SCALE = 1:50

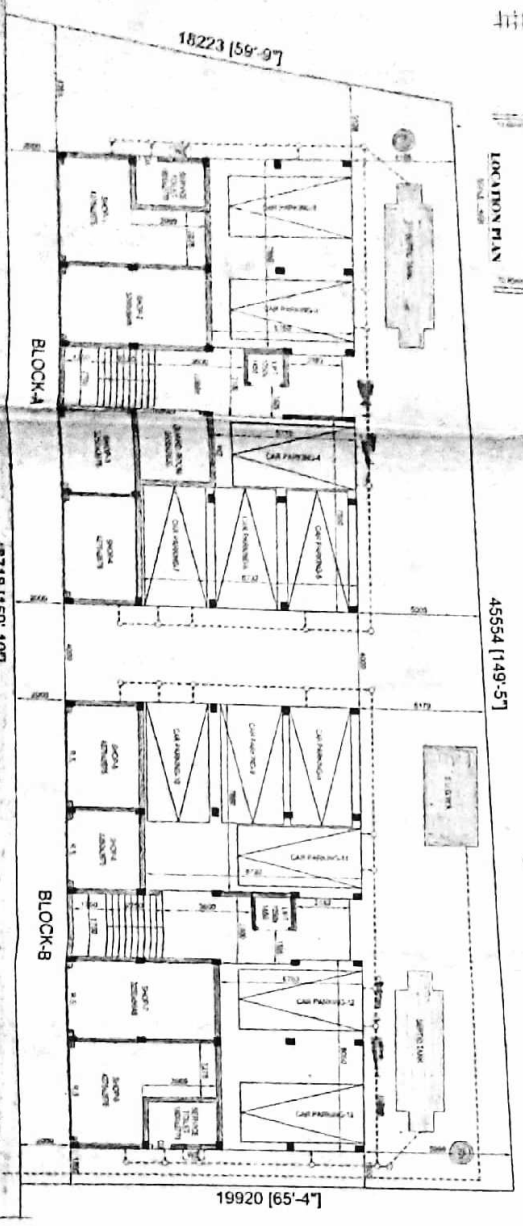

PROPOSED GROUND FLOOR PLAN

AVG 10.0M W I D E GANGA JOARA MAIN ROAD

18223 [59-97]

45718 [159-107]

19920 [65-4]

45554 [149-57]

FLOOR	BLOCK	PROPOSED (SQ.M)	ACTUAL (SQ.M)	REMARKS
GROUND FLOOR	BLOCK-A	221.96	221.96	
	BLOCK-B	221.96	221.96	
	BLOCK-C	221.96	221.96	
	BLOCK-D	221.96	221.96	
	BLOCK-A	221.96	221.96	
	BLOCK-B	221.96	221.96	
	BLOCK-C	221.96	221.96	
	BLOCK-D	221.96	221.96	
	BLOCK-A	221.96	221.96	
	BLOCK-B	221.96	221.96	
TOTAL		2219.6	2219.6	
TOTAL FLOOR AREA WITHOUT CUP BOARD - 2158.80 SQ.M				
TOTAL FLOOR AREA WITH CUP BOARD - 2258.80 SQ.M				

AREA STATEMENT

LAND AREA: 2158.80 SQ.M
 COVERED AREA: 2258.80 SQ.M
 UNCOVERED AREA: 900.00 SQ.M
 TOTAL AREA: 3158.80 SQ.M

PROPOSED G+1 STORED RESIDENTIAL WITH COMMERCIAL BUILDING PLAN AT MOITLA - PANCHSOTRA, JL. NO. - 42, B.S. D.G. NO. - 496, L.R. D.G. NO. - 506, B.S. NEARITY NO. - 38, L.R. NEARITY NO. - 287, 299, 298, 295, 294, 293, 292, 291, 290, 289, 288, 287, 286, 285, 284, 283, 282, 281, 280, 279, 278, 277, 276, 275, 274, 273, 272, 271, 270, 269, 268, 267, 266, 265, 264, 263, 262, 261, 260, 259, 258, 257, 256, 255, 254, 253, 252, 251, 250, 249, 248, 247, 246, 245, 244, 243, 242, 241, 240, 239, 238, 237, 236, 235, 234, 233, 232, 231, 230, 229, 228, 227, 226, 225, 224, 223, 222, 221, 220, 219, 218, 217, 216, 215, 214, 213, 212, 211, 210, 209, 208, 207, 206, 205, 204, 203, 202, 201, 200, 199, 198, 197, 196, 195, 194, 193, 192, 191, 190, 189, 188, 187, 186, 185, 184, 183, 182, 181, 180, 179, 178, 177, 176, 175, 174, 173, 172, 171, 170, 169, 168, 167, 166, 165, 164, 163, 162, 161, 160, 159, 158, 157, 156, 155, 154, 153, 152, 151, 150, 149, 148, 147, 146, 145, 144, 143, 142, 141, 140, 139, 138, 137, 136, 135, 134, 133, 132, 131, 130, 129, 128, 127, 126, 125, 124, 123, 122, 121, 120, 119, 118, 117, 116, 115, 114, 113, 112, 111, 110, 109, 108, 107, 106, 105, 104, 103, 102, 101, 100, 99, 98, 97, 96, 95, 94, 93, 92, 91, 90, 89, 88, 87, 86, 85, 84, 83, 82, 81, 80, 79, 78, 77, 76, 75, 74, 73, 72, 71, 70, 69, 68, 67, 66, 65, 64, 63, 62, 61, 60, 59, 58, 57, 56, 55, 54, 53, 52, 51, 50, 49, 48, 47, 46, 45, 44, 43, 42, 41, 40, 39, 38, 37, 36, 35, 34, 33, 32, 31, 30, 29, 28, 27, 26, 25, 24, 23, 22, 21, 20, 19, 18, 17, 16, 15, 14, 13, 12, 11, 10, 9, 8, 7, 6, 5, 4, 3, 2, 1, 0.

APPROVED
 11/06/2023
 11/06/2023

SIGNATURE OF OWNER

OFFICE USE ONLY

SIGNATURE OF S.E.

STAMP