

SITE PLAN OF A PROJECT OF LAND in R.S. Dag Nos. 409, 410, 411, 425(P), 426, 427, 428, 429, 430 under Mouza Raigachi, J.L. No.12, R.S. No. 194 , L.R.KE No. 1383 & 1141 ,P.S. Rajarhat, Dist North 24 Parganas. Under Rajarhat Bishnupur 1 No. Gram Panchayet.

NAME OF OWNER : TIRATH PROJECT

TOTAL AREA OF LAND (IN DEED) =3722.32 SQM
 TOTAL AREA OF LAND (IN PHYSICAL) =3722.32 SQM

Latitude 22°37'59.74" N
 Longitude 88°28'16.60" E

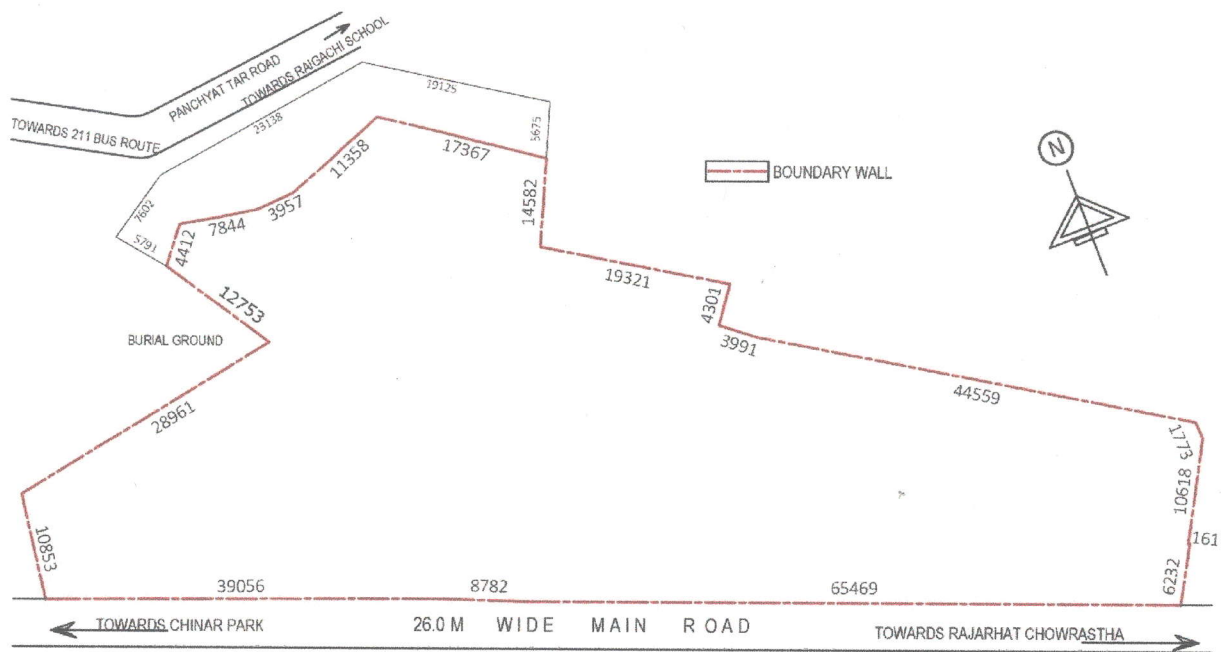

Signature of Architect
 Sanjay Mandal
 ACHR/NKDA/09/00002

Sanjay Mandal
 ACHR/NKDA/09/00002