

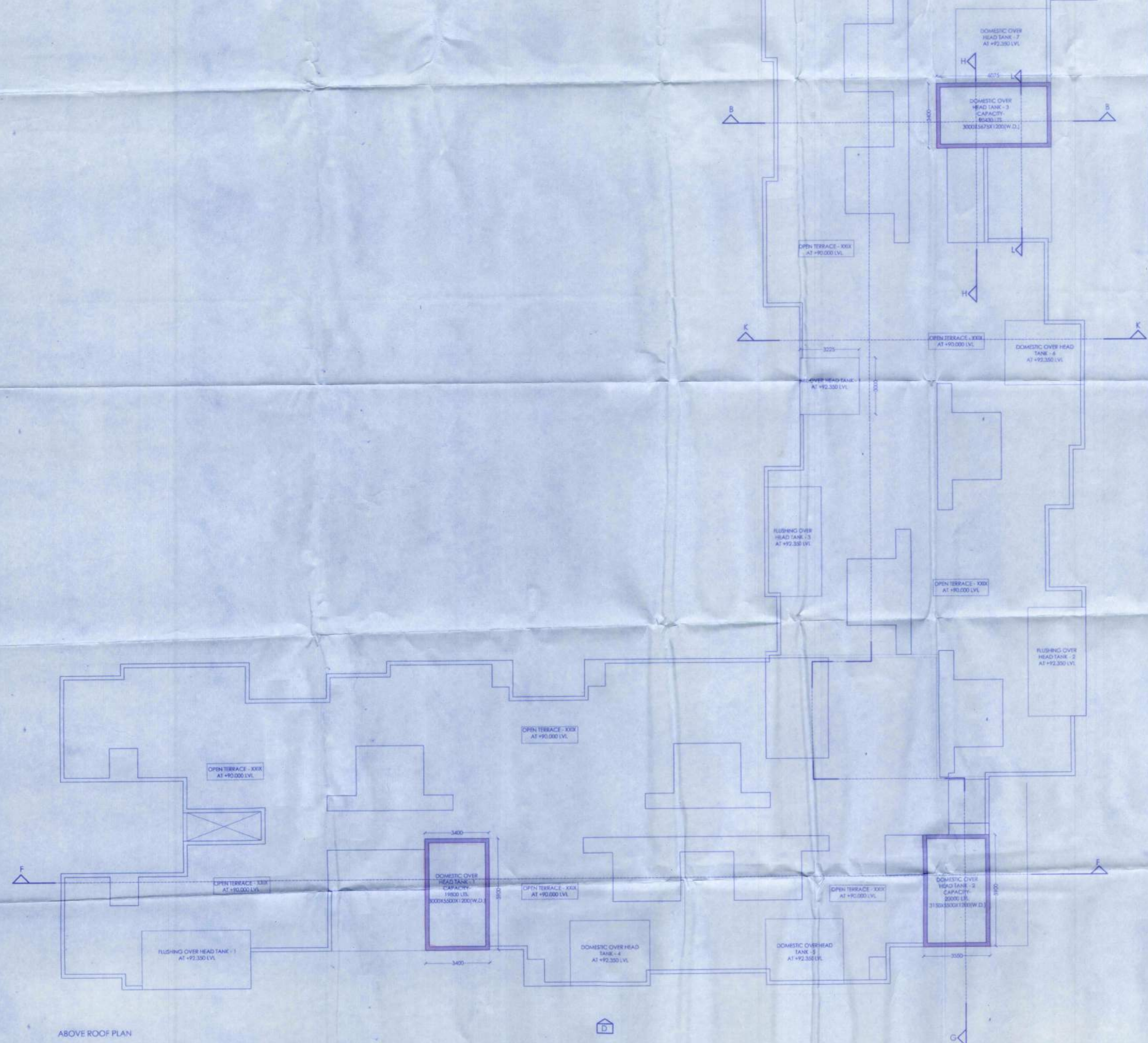

MKD	Type	Sill Height	Width	Height	Lintel Ht.
LV	750X750/735	2150	700	750/735	upto slab bottom
LVa	550X750/735	2150	550	750/735	
LVb	825X750/735	2150	825	750/735	
LVc	575X735	2150	575	735	
LVd	1000X735	2150	1000	735	
LVe	500X735	2150	500	735	
LVf	1350X735	2150	1350	735	
LVg	1225X735	2150	1225	735	
LVh	600X450	1850	600	450	2100
LVi	675X1100	1000	675	1100	2100
LVj	975X1100	1000	975	1100	2100
LVk	1725X1100	1000	1725	1100	2100
LVl	1800X1100	1000	1800	1100	2100
LVm	2100X1100	1000	2100	1100	2100
LVn	2500X1100	1000	2500	1100	2100
LVo	3025X1100	1000	3025	1100	2100
LVp	900X1100	1000	900	1100	2100
LVq	925X1100	1000	925	1100	2100
LVr	1425X1100	1000	1425	1100	2100
LVs	2875X1100	1000	2875	1100	2100
LVt	1550X1100	1000	1550	1100	2100
LVu	1700X1100	1000	1700	1100	2100
LVv	1100X1100	1000	1100	1100	2100
LVw	2350X1100	1000	2350	1100	2100
LVx	1750X1100	1000	1750	1100	2100
LVy	2075X1100	1000	2075	1100	2100

MKD	Type	Height	Width
FD	1200X2100	2100	1200
D1	1100X2100	2100	1100
D2	900X2100	2100	900
D3	750X2100	2100	750
D4	1000X2400	2400	900
SD	2100X2400	2400	2100
LD	900X2100	2100	900
LD1	1200X2100	2100	1200

MKD	Type	Sill Height	Width	Height	Lintel Ht.
W1	1800X1500	900	1800	1500	2400
W2	1000X1800	900	1000	1500	2400
W3	800X1200	900	800	1200	2100
W4	450X1200	1200	450	1200	2400
W5	1500X1500	900	1500	1500	2400
W4a	450X900	1200	450	900	2100
DW	750X2400	1500	750	2400	2400
	750X1200	1500	750	1200	2400



PROJECT
PROPOSED TOWNSHIP "CALCUTTA RIVERSIDE" PROJECT AT BATANAGAR, MOUZA - MIRPUR, BANGLA, JAGTALA AND NANGI WARD NO. 27 & 28 MAHESHTALA MUNICIPALITY, SOUTH 24 PARGANAS FOR RIVERBANK DEVELOPERS PVT. LTD.

Parcel Name :
 HILAND RIVER (FORMERLY KNOWN AS RIVERFRONT HOUSING)

MOUZA - MIRPUR, J.L. NO. - 42, KHATAN NO. - 03 R.S. DAG NO. - 2(P), 3(P), 7(P), 8(P), 3/54(P) & 8/98(P)

Title :
 HILAND RIVER - TOWER - 2 ABOVE ROOF PLAN

Date : 09.07.18 **Drawing No.** CRS/HR2/ARF/LGL-11

Scale : 1:100

DRAWING STATUS : For MUNICIPAL SANCTION

Note :
 ALL EXTERNAL STRUCTURAL & NON STRUCTURAL R.C.C. WALLS ARE 300 THK., 250 THK. & 300THK. AND INTERNAL WALLS ARE 125 THK., 200 THK., 250 THK., 300 THK. BRICK WALL UNLESS STATED OTHERWISE.
 ALL DIMENSIONS ARE IN MM.

DECLARATION OF OWNER
 THE CERTIFIED DRAWINGS HAVE BEEN DONE THROUGH THE WEST BENGAL MUNICIPALITY BUILDING RULES, 2011 AND ALSO THROUGH THE APPROVALS BY THE LOCAL GOVT. AND AFTER CONSTRUCTION OF THE BUILDING.

Riverbank Developers Pvt. Ltd.
Signature
 Authorised Signatory

SIGNATURE OF OWNER
 RIVERBANK DEVELOPERS PVT. LTD.

CERTIFICATE OF STRUCTURAL STABILITY
 WE HEREBY CERTIFY THAT THE FOUNDATION AND SUPER STRUCTURE OF THE BUILDING PROPOSED FOR CONSTRUCTION ON THE PLOT NO. 1, NEW BATA ROAD, MOUZA - MIRPUR, JAGTALA, BANGLA & NANGI, WARD NO. - 27 & 28, MAHESHTALA MUNICIPALITY HAVE BEEN SO DESIGNED BY ME/US WILL MAKE SUCH FOUNDATION AND SUPER STRUCTURE SAFE IN ALL RESPECT INCLUDING THE CONSIDERATION OF BEARING CAPACITY AND SETTLEMENT OF SOIL ETC.

Pallabi Gupta Roy
 PALLABI GUPTA ROY
 Registered Architect
 Regn. No. - CA/95/18558.

SIGNATURE OF ARCHITECT
 NAME, ADDRESS & EMPANELMENT NO.

UTTAL SANTRA
 B.E., M.C.E. (STRUCTURES)
 FILE-12/2001
 M.C.E. (Structures) (Unsubstantiated Engineer)
 Regn. No. - CA/95/18558.

SIGNATURE OF STRUCTURAL ENGINEER
 NAME, ADDRESS & EMPANELMENT NO.

ALOK ROY
 Empanelled Geotechnical Engineer
 Kolkata Municipal Corporation
 Class. No. - G7/11
 6A, Milan Park, Kolkata-700 084

SIGNATURE OF GEO-TECHNICAL ENGINEER
 NAME, ADDRESS & EMPANELMENT NO.

STRUCTURAL CONSULTANTS
M.N. Consultants (Pvt.) Ltd.
 MNC House
 1518, RAJANGA MAIN ROAD
 KOLKATA - 700107
 Phone No. - (033) 4016 5712

GEO TECHNICAL CONSULTANTS
Geotest Engineering Pvt. Ltd.
 (An ISO9001:2000 Certified Company)
 Soil Investigators & Foundation Consultants 6A, Milan Park, Kolkata-700084.
 Phone No. - (033) 2430 3494 / 8103

RIVER BANK DEVELOPERS PVT. LTD.
 225 C, A.J.C. Bose Road, 4th Floor
 Kolkata - 700020.
 Phone No. - (033) 2281 9015-17
 Fax No. 91-33-2280 2140
 W - www.hilandcal.com

RIVER

L&L-11

ORIGINAL COPY / DUPLICATE COPY
DEVIATION WOULD MEAN
DEMOLITION
FINAL / PROVISIONALLY SANCTIONED
RESIDENTIAL BUILDING PLAN

Necessary Steps should be taken for the safety
of the lives of the adjoining public and private
properties during construction

Plan No. BB-0/MW/BLDG/21 578 / 2006 /SRBP

Date: _____

Name: Riverbank Developers Pvt. Ltd.

Address: 1, Anna Salai, Chennai

Ward No: 12

Sub-Engineer Building Section
Municipality

CIC Member
Social Welfare
Municipality

APARTMENT BUILDING

Before starting any construction site must conform
with the plan Sanctioned and all the Conditions as proposed
in the plan. The validity of the written permission to execute
the work is subject to the above conditions

BUILDING PLAN SANCTIONED DATE: 5/12/18

Valid upto: _____

Renewal Within: 1/10/19

Construction should be made strictly according to sanctioned plan