

SCHEDULE - " F "

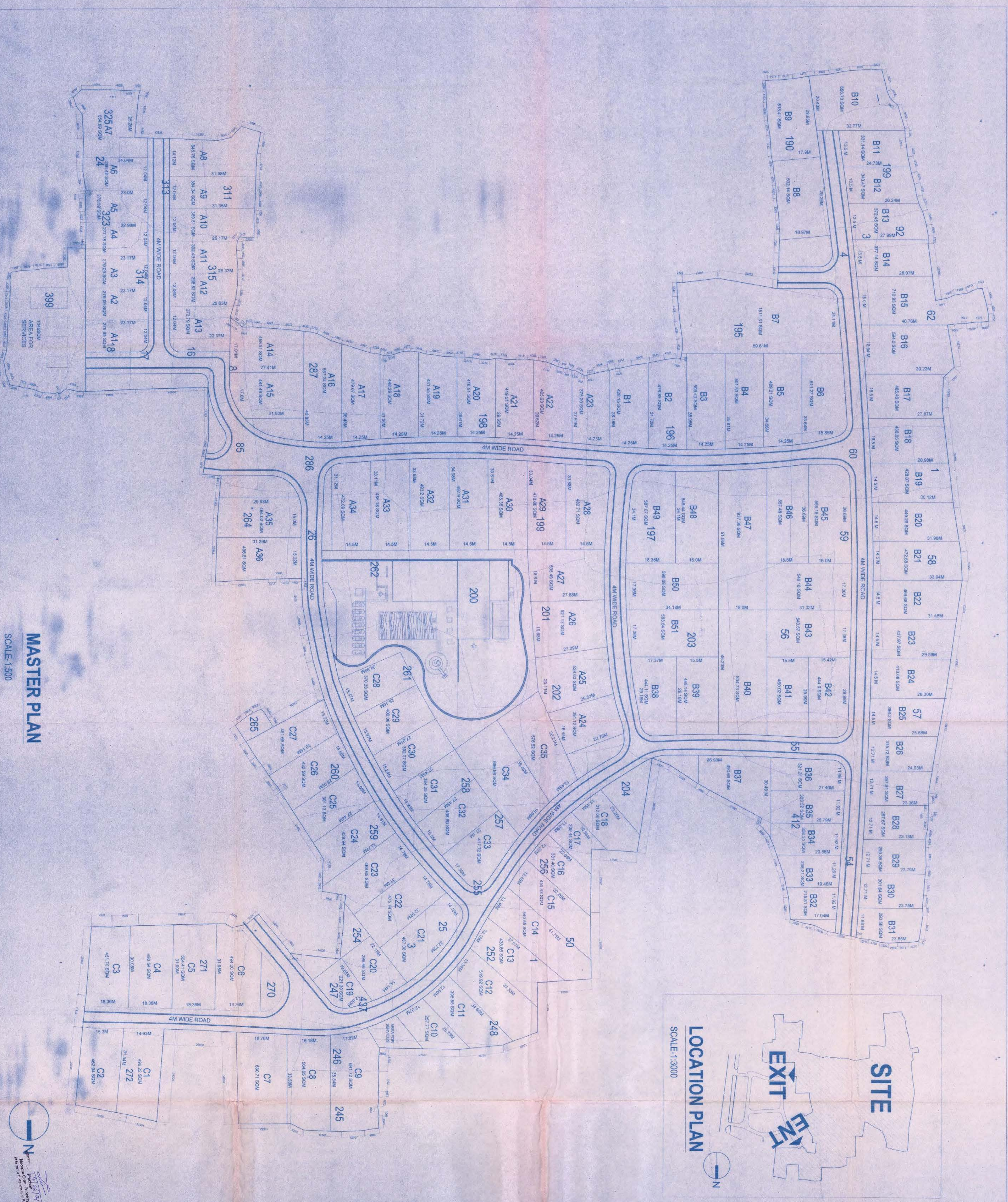

MASTER PLAN
SCALE: 1:500

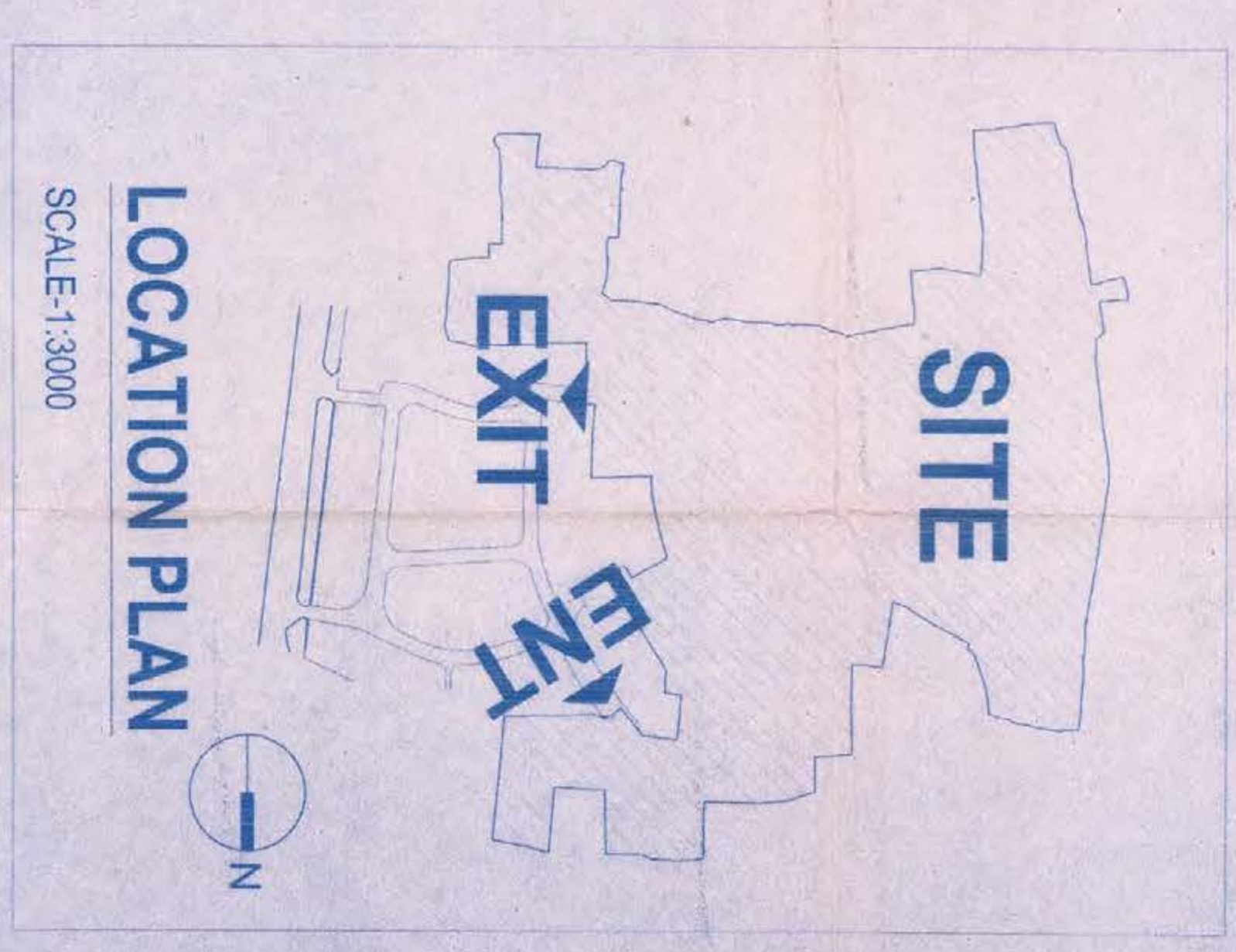

LOCATION PLAN
SCALE: 1:3000

A. GENERAL NOTES:

1. ALL DIMENSIONS ARE IN MM UNLESS OTHERWISE SPECIFIED.
2. ALL EXTERNAL WALLS ARE 19 MM THK. AND INTERNAL WALLS ARE 12 MM THK. RESPECTIVELY.
3. ALL EXTERNAL WALLS ARE 250 THK. & INTERNAL PARTITION WALLS ARE 125 THK. UNLESS OTHERWISE MENTIONED.
4. ALL ELECTRICAL AND PLUMBING WORKS ARE CONSIDERED AS PER IS CODE.

AREA STATEMENT:-

- 1) AREA OF LAND(CEED) - 76019.29SQM.
- 2) NO. OF INTERNAL DIVISION OF PLOT - 122
- 3) TOTAL AREA OF 122 NOS. OF PLOT - 55630 SQM.
- 4) ROAD AREA - 6077.29 SQM. = 8% OF PLOT AREA
- 5) COMMON GREEN AREA - 8491.93 SQM.
- 6) SERVICE AREA - 1643 SQM.
- 7) AREA FOR CLUB - 4171.25SQM = 5% OF PLOT AREA

D. SIGNATURE OF OWNER :

Classical Hospital
Signature of Owner

E. CERTIFICATE OF STRUCTURAL ENGINEER :

CERTIFIED THAT THE STRUCTURAL DESIGN & DRAWINGS OF BOTH FOUNDATION & SUPER STRUCTURE OF THE BUILDING HAS BEEN MADE BY THE COMPETENT ALL POSSIBLE LOADS DERIVED FROM THE SITE AND STABLE IN ALL RESPECTS.

G. R. BAO
BE. ESE. 1193
CONSULTANT ENGINEER

F. CERTIFICATE OF ARCHITECT :

THE L&A HAS CONSIDERED THE SANITATION & UTILITIES RESPONSIBILITIES THAT THE BUILDING PLANS AND DRAWINGS AS SUBMITTED BY THE CLIENT AND THAT THE SITE CONVENTION INCLUDING THE WIDTH OF THE ABUTTING ROAD CONFORM WITH THE REGULATIONS AND STANDARDS AND NOTION VARIOUS RULES AND REGULATIONS.

G. R. BAO
BE. ESE. 1193
CONSULTANT ARCHITECT

G. PROJECT:

PROPOSED PLOTTED DEVELOPMENT FOR RESIDENTIAL/ COMMERCIAL COMPLEX AT MOUZZA-CHAKRAKUNATH, DAG NO. 325/24/323/311, 313/314, 315, 3599/16/17/18, 6/5, 50, 298/287, 198, 199/200, 201, 203, 204, 28/284, 202, 245, 246, 247, 248, 252, 254, 255, 256, 257, 258, 259, 260, 261, 262, 263, 270, 271, 272, 437, 125, 3/4, 12/54, 55, 56, 57, 58, 59, 60, 1/3, 4, 185, 196, 197, 62, 190, 199 P.S.- RAJNAGAR, DIST.- SOUTH 24 PGS. WEST BENGAL.

H. CLIENT:

CLASSICAL HOSPITALITY VENTURE CO. LTD
Developed by: G.G.L. HOTEL & RESORT CO. LTD
Rajaj office: Vivekananda, 88 C/Topra Road(South)
Kolkata-700046, Phone: (033)22523000

I. ARCHITECTS:

salient
Salient Engineering & Architecture Pvt. Ltd.
Specialized for architectural, landscape, interiors and carpentry work.

DESIGN BY: SALIENT
CHECKED BY: SALIENT
DATE: 21/11/21
SCALE: 1:500



Prepared by: Salient Engineering & Architecture Pvt. Ltd.
Kolkata-700046, Phone: (033)22523000