

FOOTING SCHEDULE (ISOLATED)					
MARKED	SIZE	g1	g2	REINFORCEMENT (AT BOTTOM ONLY)	
F-1	1200 X 1200	125	200	12 @ 125 C/C BOTHWAYS	
F-2	1400 X 1400	150	250	12 @ 125 C/C BOTHWAYS	
F-3	AS PER DRAWING	500	-	12 @ 125 C/C BOTHWAYS TOP AND BOTTOM	

THE BEAM SCHEDULE						
BEAM MKD	BEAM SIZE	MAIN REINFORCEMENT				STIRRUPS
		TOP	BOTTOM	SUPPORT	SPAN	
TB1	250X400	4-12	4-12	2-12	4-12	8 @ 125 C/C
TB2	250X400	4-12	4-12	2-12	4-12	8 @ 125 C/C
TB3	250X400	4-12	4-12	2-12	4-12	8 @ 125 C/C

COLUMN SCHEDULE					
COLUMN MARKED	COLUMN SIZE	REINFORCEMENT			
		FROM FOUNDATION TO 1ST FLOOR LVL	1ST FLOOR LVL TO 2ND FLOOR LVL	2ND FLOOR LVL TO ROOF LVL	FROM 2ND FLOOR LVL TO ROOF LVL
C-1	200 X 300	4-16	4-12	6-12	6-12
C-2	200 X 300	4-16	4-12	6-12	6-12

COLUMN SCHEDULE					
COLUMN MARKED	COLUMN SIZE	REINFORCEMENT			
		FROM FOUNDATION TO 1ST FLOOR LVL	1ST FLOOR LVL TO 2ND FLOOR LVL	2ND FLOOR LVL TO ROOF LVL	FROM 2ND FLOOR LVL TO ROOF LVL
C-3	200 X 300	4-16	4-12	6-12	6-12
C-4	200 X 300	4-16	4-12	6-12	6-12

COLUMN SCHEDULE					
COLUMN MARKED	COLUMN SIZE	REINFORCEMENT			
		FROM FOUNDATION TO 1ST FLOOR LVL	1ST FLOOR LVL TO 2ND FLOOR LVL	2ND FLOOR LVL TO ROOF LVL	FROM 2ND FLOOR LVL TO ROOF LVL
C-5	200 X 300	4-16	4-12	6-12	6-12
C-6	200 X 300	4-16	4-12	6-12	6-12

COLUMN SCHEDULE					
COLUMN MARKED	COLUMN SIZE	REINFORCEMENT			
		FROM FOUNDATION TO 1ST FLOOR LVL	1ST FLOOR LVL TO 2ND FLOOR LVL	2ND FLOOR LVL TO ROOF LVL	FROM 2ND FLOOR LVL TO ROOF LVL
C-7	200 X 300	4-16	4-12	6-12	6-12
C-8	200 X 300	4-16	4-12	6-12	6-12

BEAM SCHEDULE							
BEAM MKD	BEAM SIZE	REINFORCEMENT				STIRRUPS	
		TOP	BOTTOM	SUPPORT	SPAN	SPAN	SPAN
B1	250 X 500	3-16	2-16	2-16	2-16	8 @ 250 C/C	8 @ 250 C/C
B2	250 X 500	2-16	2-16	2-16	2-16	8 @ 250 C/C	8 @ 250 C/C
B3	250 X 500	4-16	3-16	3-16	3-16	8 @ 250 C/C	8 @ 250 C/C
B4	250 X 500	4-16	3-16	3-16	3-16	8 @ 250 C/C	8 @ 250 C/C

SLAB SCHEDULE					
SLAB MARKED	SLAB THICKNESS	SUPPORT		MID SPAN	
		STRENGTH	STRENGTH	STRENGTH	STRENGTH
S1	125	8 @ 125 C/C	8 @ 125 C/C	8 @ 125 C/C	8 @ 200 C/C
S2	100	8 @ 150 C/C	8 @ 150 C/C	8 @ 200 C/C	8 @ 200 C/C
S3	150	8 @ 100 C/C	8 @ 125 C/C	8 @ 150 C/C	8 @ 175 C/C

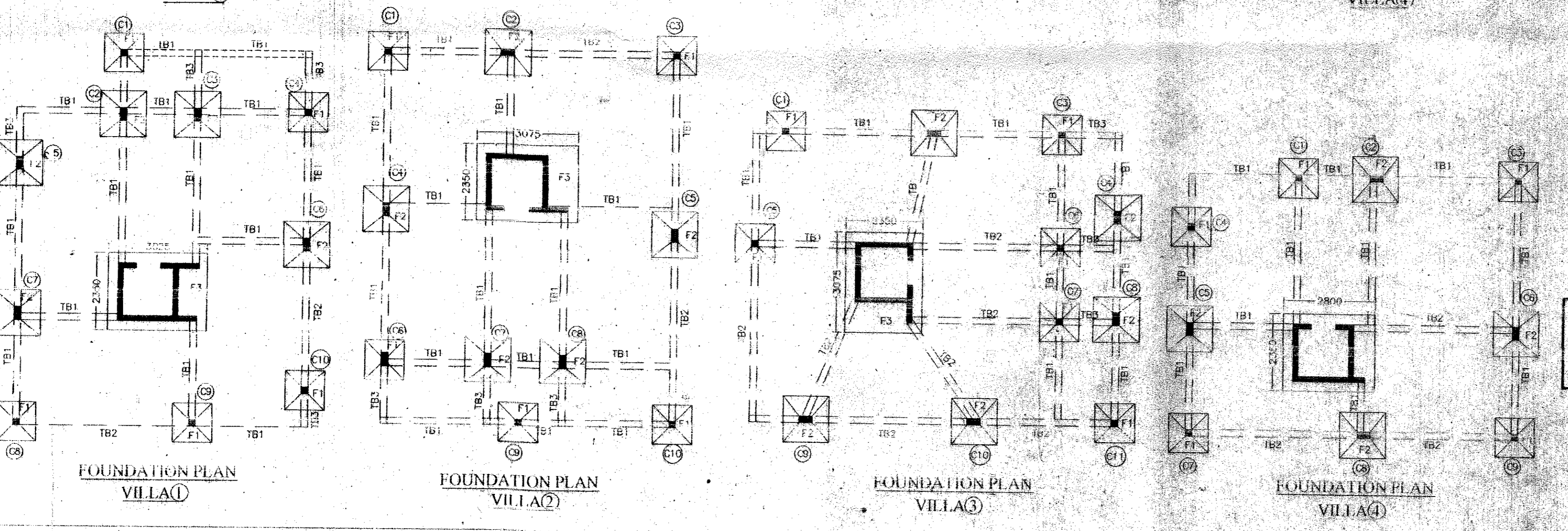
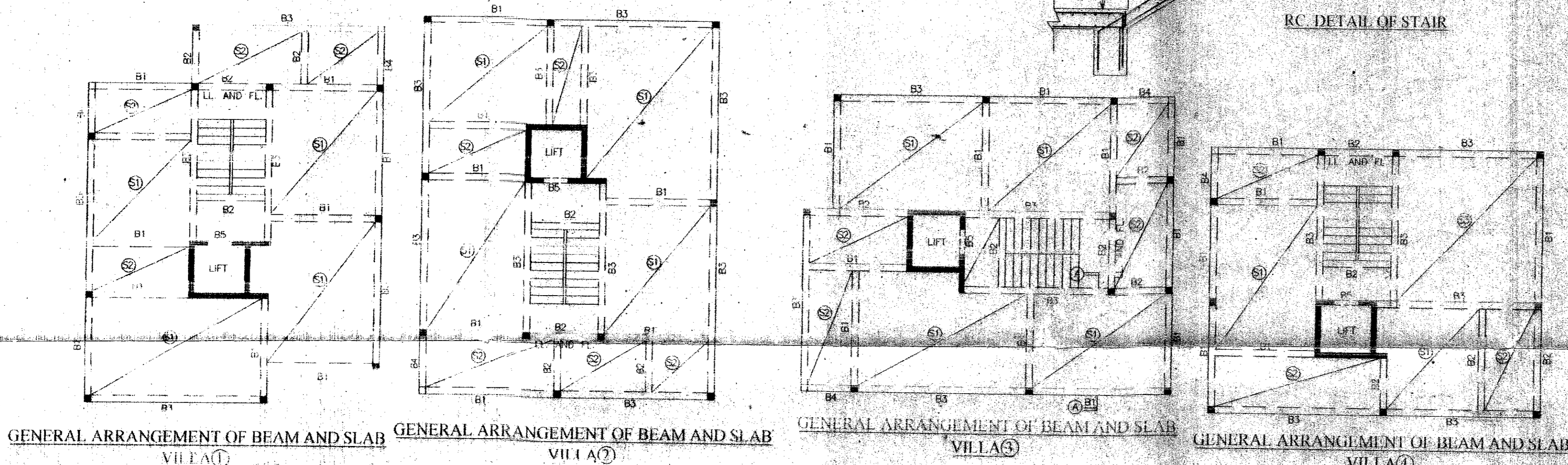
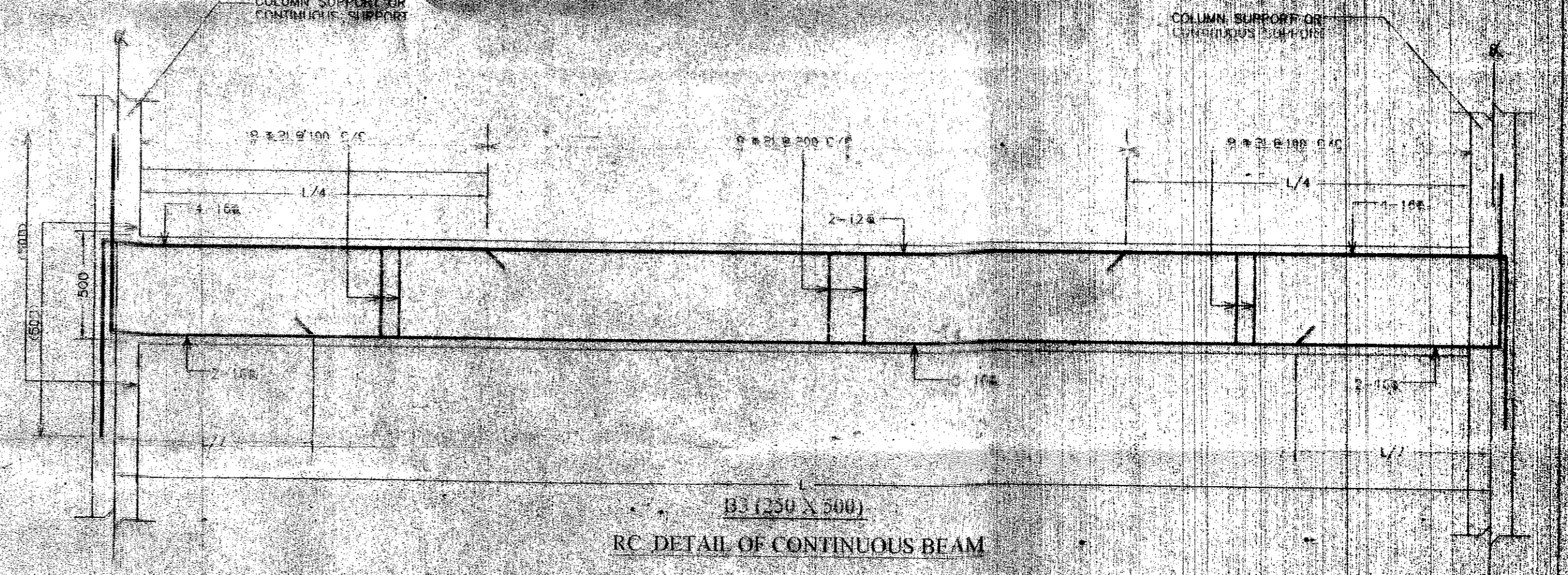
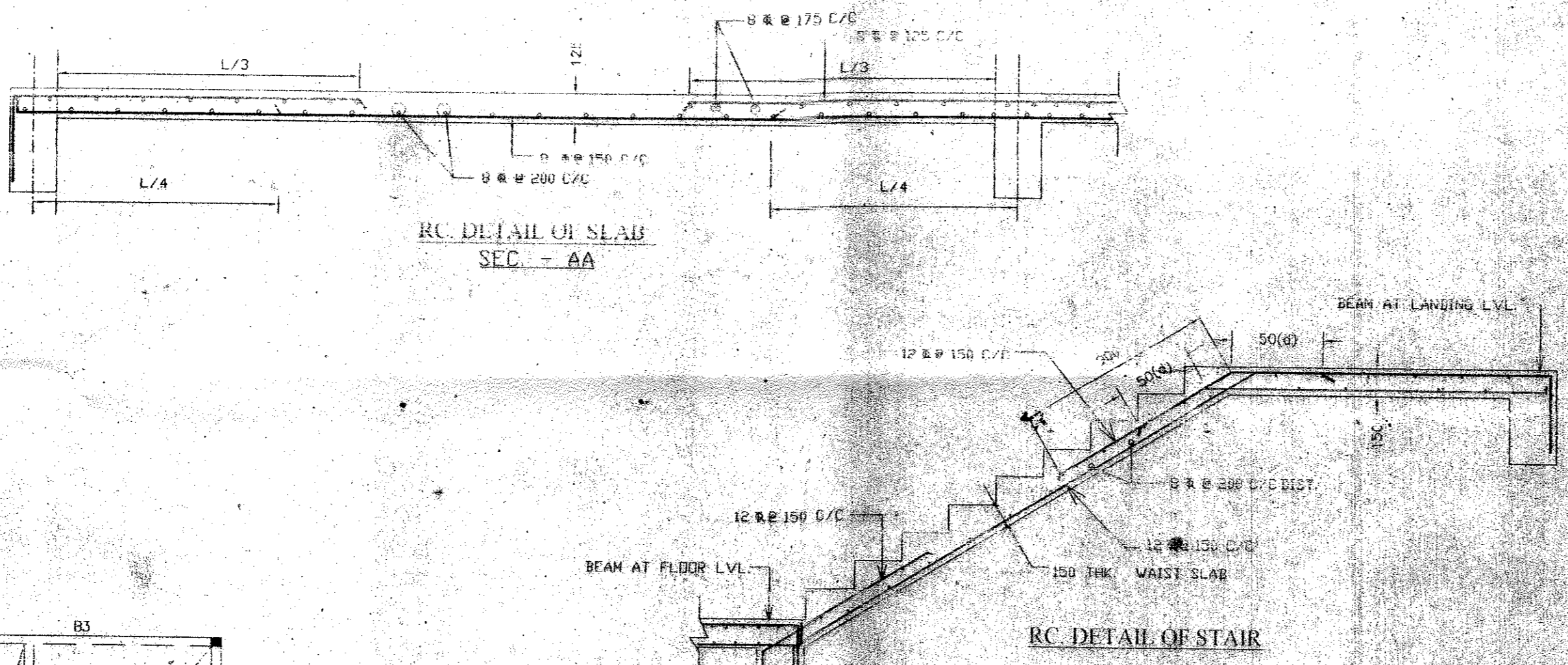
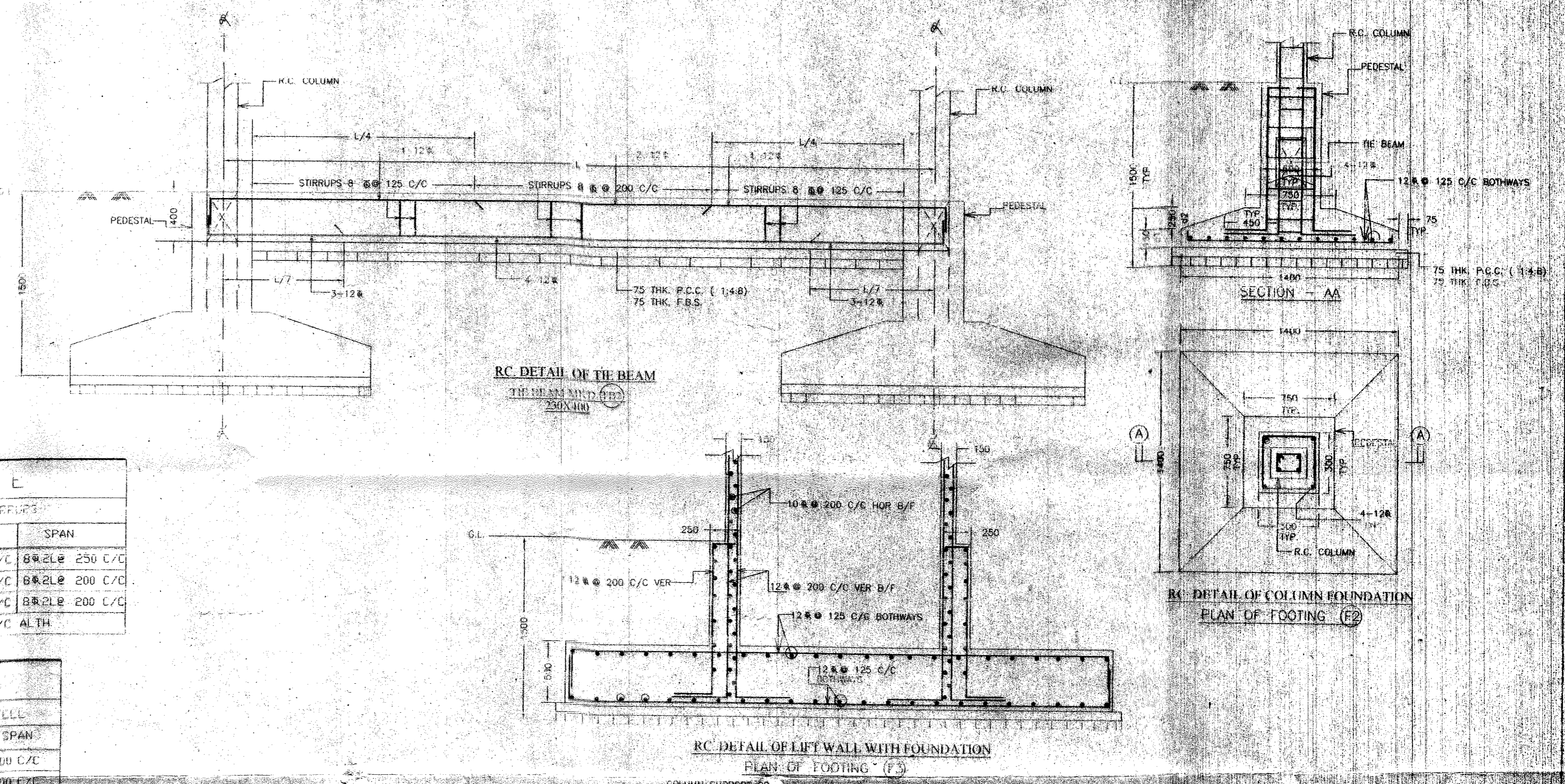

DECLARED THAT THE BUILDING PLAN HAS BEEN DRAWN UP AS PER REGULATION OF WEST BENGAL MUNICIPALITY RULES 2007 AS AMENDED FROM TIME TO TIME AND THAT THE SITE CONDITIONS INCLUDING THE WIDTH OF THE ADJOINING ROAD BEING 18.30 MTS. CONFORM WITH PLAN AND THAT IT IS A BUILDING SITE AND NOT A TANK OR FILLED UP TANK.

**HARSH SANON**  
COUNCIL OF ARCHITECTURE  
REGISTRATION NO. CA/90/13984

**CHANDI PRASAD KHANNA**  
REGISTERED ARCHITECT  
COUNCIL OF ARCHITECTURE  
REGISTRATION NO. CA/90/13984

THE STRUCTURAL DESIGN, DRAWINGS OF BOTH FOUNDATION AND SUPERSTRUCTURE OF THE BUILDING HAS BEEN MADE BY ME CONSIDERING ALL POSSIBLE LOADS INCLUDING THE SEISMIC LOAD AS PER THE NATIONAL BUILDING CODE OF INDIA AND CERTIFIED THAT IT IS SAFE AND STABLE IN ALL RESPECTS.

**CHANDI PRASAD KHANNA**  
REGISTERED ARCHITECT  
COUNCIL OF ARCHITECTURE  
REGISTRATION NO. CA/90/13984

**Lofty Estates Pvt. Ltd.**  
SIGNATURE OF OWNERS  
NAME OF OWNER  
LOFTY ESTATES PVT. LTD. & OTHERS

- NOTE:
1. CONCRETE MIX TO BE USED IN TOTAL RC WORK (BOTH FOUNDATION AND SUPERSTRUCTURE) - M20
  2. COVER TO REINFORCEMENTS - 50mm MINIMUM ON EARTHFACE AND 25mm ELSEWHERE
  3. THIS DRAWING SHOULD BE READ IN CONJUNCTION WITH RELEVANT ARCHITECTURAL DWGS.

TITLE  
PROPOSED G+2 STORIED BLOCK OF BUILDINGS  
AT DAG NOS: 521, 522, 523, 524, 525, 526, 527, 528, 538, 539,  
535/558, JL NO. 3 MOUZA - SALUA, DIST - 24 PGS (N  
WARD - 3 & 7 P.S. AIRPORT

SCALE: 1:100, 1:25

DATE: 12/06/2014

DESIGNED BY: N. RAY

CHECKED BY: S. K. SARKAR

**S&S** ANON SEN & ASSOCIATES (P) LTD.  
APARTMENT ENCLAVE, 1ST FLOOR, MARKET STREET,  
KOLKATA - 700 077  
PHONE: 033-22264574, 22172505  
FAX: 033-22264574, E-MAIL: anonsen@rediffmail.com

EXCHANGED HAVE BEEN KEPT IN THE FILE FOR RECORD OF MAINTAIN  
COPIES SEPARATELY WITHOUT VARIATION IN THE RECORD OF MAINTAIN  
FROM THE ORIGINAL RECORDS. THE ORIGINAL RECORDS OF MAINTAIN  
THESE RECORDS WITHOUT VARIATION IN THE RECORD OF MAINTAIN  
ALONG WITH DESIGN DEVELOPMENT AND CONSTRUCTION RECORDS.  
AS APPLICABLE TO THE DESIGN AND CONSTRUCTION RECORDS AND SAFETY  
IS HUMAN LIFE DURING CONSTRUCTION.



S. J. No. 1887/12/15