





SITE PLAN FOR PROP. G+VI STD. RESI. FLAT BLDG. OF 1) SMT. SUMITA RANI MONDAL, W/O SRI AMAL KUMAR MONDAL ALIAS GOPAL CHADRA MODAL, 2) SRI AMAL KUMAR MONDAL ALIAS GOPAL CHADRA MODAL S/O LATE BANOWARI LAL MONDAL AT MAHALLA - BIRHATA, AT MOUZA- RADHANAGAR, J.L. NO - 39, R.S. PLOT - 7039/7339, R.S. KH. NO - 1636, L.R. PLOT NO - 5861, L.R. KH. NO - 7892, 7893, WARD NO - 09, HOLDING NO - 110, UNDER BURDWAN MUNICIPALITY, P.S. BURDWAN, DIST. - PURBA BARDHAMAN (SCALE - 1" = 20' - 0")

AREA OF LAND — 2989.21 SFT
NATURE OF LAND — BASTU

EXT. CONST. SHOWN IN COL — 
PROPERTY LINE SHOWN IN COL — 
ROAD SHOWN IN COL — 
DRAIN SHOWN IN COL — 

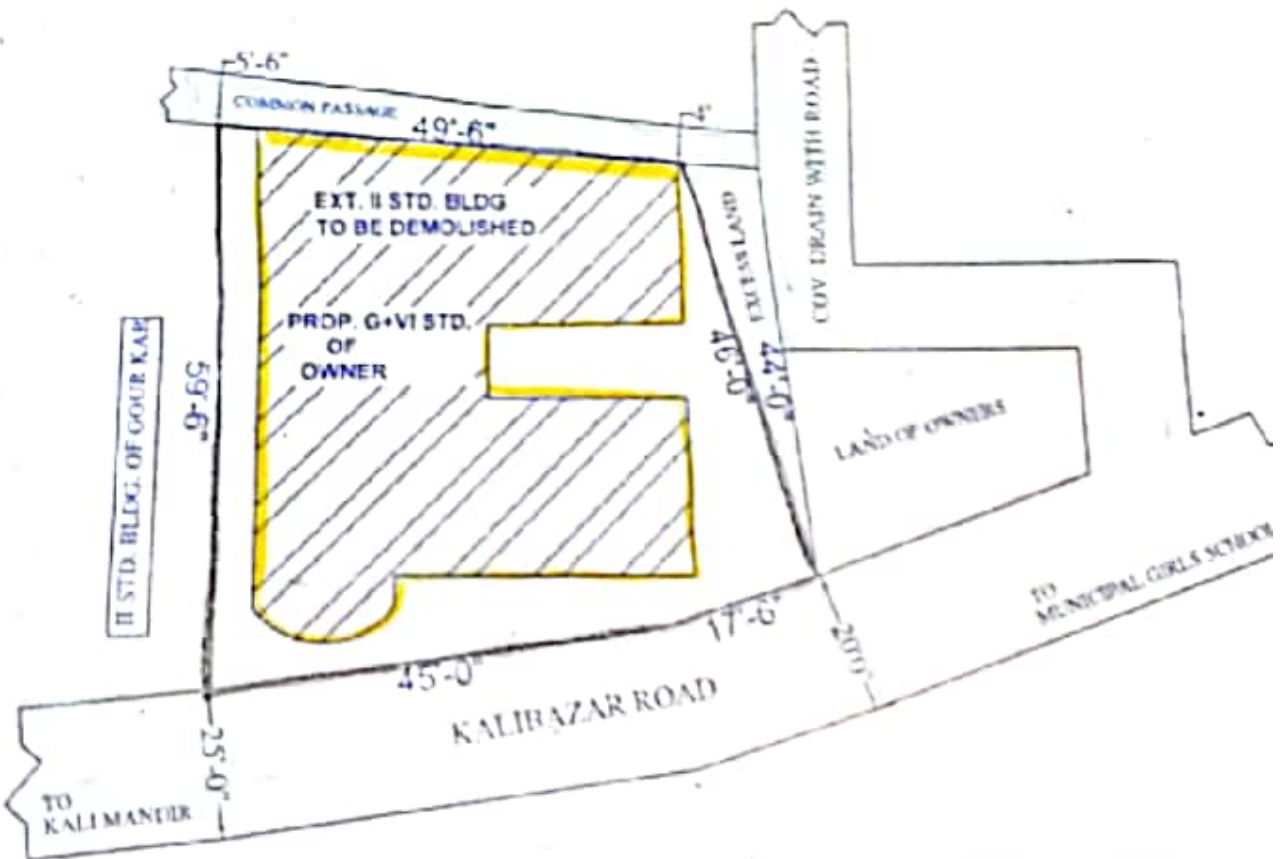

Radhika
Harekrishna Adhikari
Enlisted Civil Engineer under
Burdwan Municipality
Road No. 27/11E/XII-6
DRAWN BY

[Signature] 27/11/18
Burdwan Municipality
CHAIRMAN

POWER OF ATTORNEY
[Signature]
OWNERS

[Signature] 27/11/18
ENGINEER.

[Signature] 27/11/18
HEALTH OFFICER