

THIRD FLOOR PLAN (CLUB)
SCALE - 1:150

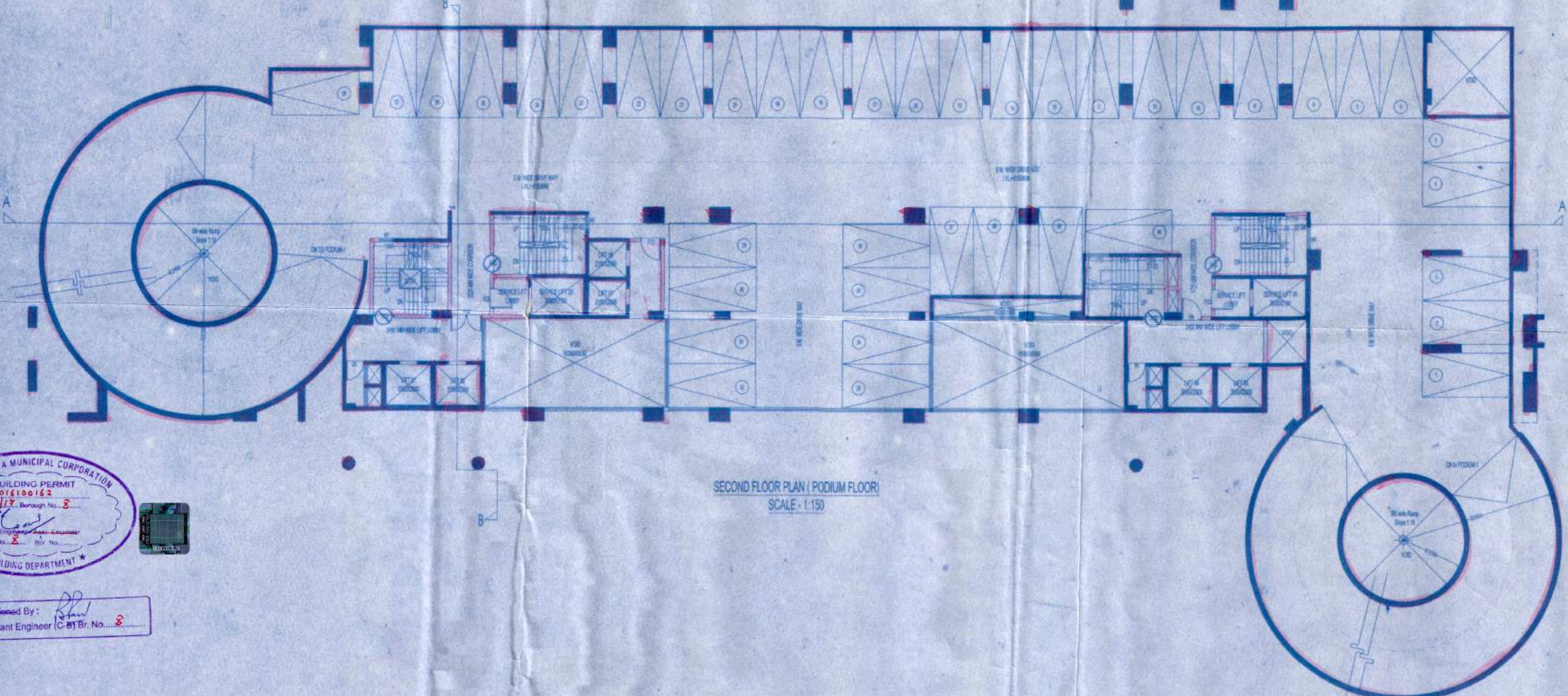

SECOND FLOOR PLAN (PODIUM FLOOR)
SCALE - 1:150

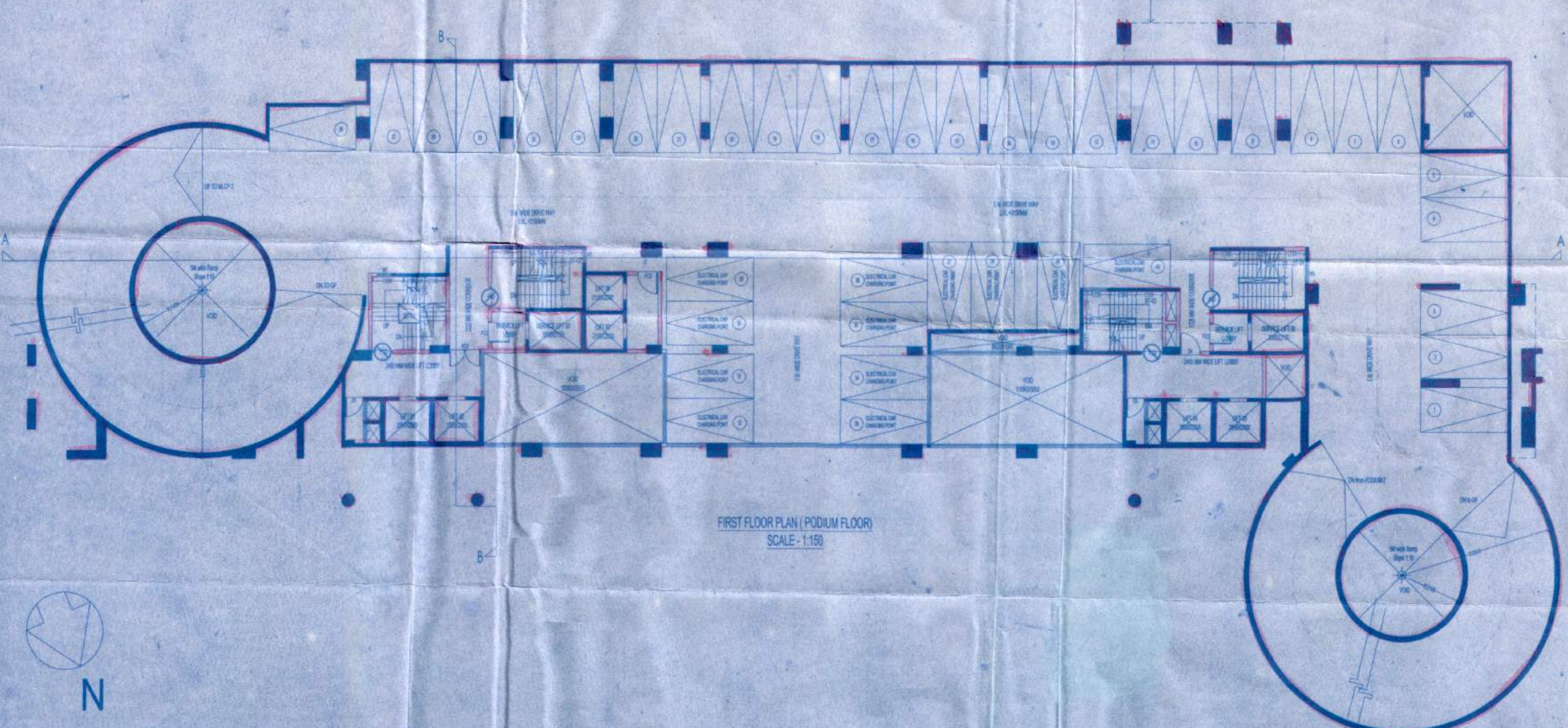

FIRST FLOOR PLAN (PODIUM FLOOR)
SCALE - 1:150



Submitted By: *[Signature]*
Assistant Engineer (C.B) No. 2

- SPECIFICATIONS:**
- ALL DIMENSIONS ARE UNLESS OTHERWISE STATED
 - ALL EXTERNAL WALLS ARE 230MM & ALL INTERNAL WALLS ARE 100MM & 75MM
 - THE TOP OF ALL WALLS & STRUCTURE SHALL NEVER EXCEED THE TOP OF FOUNDATION
 - BRICK WORK IN 230MM & 100MM SHALL BE IN ACCORDANCE WITH IS: 4620 PART 1 & 2
 - ALL ALUMINUM WORK AS SPECIFIED BY STRUCTURAL ENGINEER
 - GRADE OF STEEL AS SPECIFIED BY STRUCTURAL ENGINEER
 - ALL SORTS OF PRECAUTIONARY MEASURES WILL BE TAKEN AT THE TIME OF CONSTRUCTION
 - OTHER DETAILS AS PER IS SPECIFICATION

THE STRUCTURAL DESIGN OF THIS BUILDING IS IN ACCORDANCE WITH THE REQUIREMENTS OF THE BRITISH STANDARD BS 8103:1990 AND IS BASED ON THE ASSUMPTIONS THAT THE FOUNDATION SHALL BE PROVIDED WITH A MINIMUM BEARING CAPACITY OF 150 TONS PER SQUARE METRE. THE DESIGNER HAS NOT CONDUCTED ANY INVESTIGATION OF THE SOIL CONDITIONS AT THE SITE. THE DESIGNER IS NOT RESPONSIBLE FOR THE ACCURACY OF THE INFORMATION PROVIDED BY THE CLIENT.

[Signature]
Utpal Sankar
R.C.E. (Mumbai) No. 1000
R.C.E. (Kolkata) No. 1000
R.C.E. (Delhi) No. 1000
R.C.E. (Chennai) No. 1000
R.C.E. (Hyderabad) No. 1000
R.C.E. (Bangalore) No. 1000
R.C.E. (Lucknow) No. 1000
R.C.E. (Jaipur) No. 1000
R.C.E. (Bhopal) No. 1000
R.C.E. (Patna) No. 1000
R.C.E. (Raipur) No. 1000
R.C.E. (Gwalior) No. 1000
R.C.E. (Indore) No. 1000
R.C.E. (Dehradun) No. 1000
R.C.E. (Shimla) No. 1000
R.C.E. (Durgam) No. 1000
R.C.E. (Chandigarh) No. 1000
R.C.E. (Dispur) No. 1000
R.C.E. (Gangtok) No. 1000
R.C.E. (Itanagar) No. 1000
R.C.E. (Silchar) No. 1000
R.C.E. (Dibrugarh) No. 1000
R.C.E. (Jorhat) No. 1000
R.C.E. (Tezpur) No. 1000
R.C.E. (Guwahati) No. 1000
R.C.E. (Dispur) No. 1000
R.C.E. (Gangtok) No. 1000
R.C.E. (Itanagar) No. 1000
R.C.E. (Silchar) No. 1000
R.C.E. (Dibrugarh) No. 1000
R.C.E. (Jorhat) No. 1000
R.C.E. (Tezpur) No. 1000
R.C.E. (Guwahati) No. 1000

[Signature]
Mr. Subir Kumar Basu
R.C.E. (Mumbai) No. 1000
R.C.E. (Kolkata) No. 1000
R.C.E. (Delhi) No. 1000
R.C.E. (Chennai) No. 1000
R.C.E. (Hyderabad) No. 1000
R.C.E. (Bangalore) No. 1000
R.C.E. (Lucknow) No. 1000
R.C.E. (Jaipur) No. 1000
R.C.E. (Bhopal) No. 1000
R.C.E. (Patna) No. 1000
R.C.E. (Raipur) No. 1000
R.C.E. (Gwalior) No. 1000
R.C.E. (Indore) No. 1000
R.C.E. (Dehradun) No. 1000
R.C.E. (Shimla) No. 1000
R.C.E. (Durgam) No. 1000
R.C.E. (Chandigarh) No. 1000
R.C.E. (Dispur) No. 1000
R.C.E. (Gangtok) No. 1000
R.C.E. (Itanagar) No. 1000
R.C.E. (Silchar) No. 1000
R.C.E. (Dibrugarh) No. 1000
R.C.E. (Jorhat) No. 1000
R.C.E. (Tezpur) No. 1000
R.C.E. (Guwahati) No. 1000

[Signature]
Tollymore Estates Pvt. Ltd.
Subir Kumar Basu
Registered Architect
Regn. No. - CAT/24375

[Signature]
Subir Kumar Basu
Registered Architect
Regn. No. - CAT/24375

DOORS AND WINDOW SCHEDULE -

DOOR/WINDOW NO.	DOOR		WINDOW		REMARKS
	WIDTH	HEIGHT	WIDTH	LINTEL HT.	
D1	2400	2100	2400	2100	
D2	2400	2100	2400	2100	
D3	1800	2100	2400	2100	
D4	1800	2100	2400	2100	
D5	1800	2100	2400	2100	
D6	1800	2100	2400	2100	
D7	1800	2100	2400	2100	
D8	1800	2100	2400	2100	
D9	1800	2100	2400	2100	
D10	1800	2100	2400	2100	
D11	1800	2100	2400	2100	
D12	1800	2100	2400	2100	
D13	1800	2100	2400	2100	
D14	1800	2100	2400	2100	
D15	1800	2100	2400	2100	
D16	1800	2100	2400	2100	
D17	1800	2100	2400	2100	
D18	1800	2100	2400	2100	
D19	1800	2100	2400	2100	
D20	1800	2100	2400	2100	
D21	1800	2100	2400	2100	
D22	1800	2100	2400	2100	
D23	1800	2100	2400	2100	
D24	1800	2100	2400	2100	
D25	1800	2100	2400	2100	
D26	1800	2100	2400	2100	
D27	1800	2100	2400	2100	
D28	1800	2100	2400	2100	
D29	1800	2100	2400	2100	
D30	1800	2100	2400	2100	
D31	1800	2100	2400	2100	
D32	1800	2100	2400	2100	
D33	1800	2100	2400	2100	
D34	1800	2100	2400	2100	
D35	1800	2100	2400	2100	
D36	1800	2100	2400	2100	
D37	1800	2100	2400	2100	
D38	1800	2100	2400	2100	
D39	1800	2100	2400	2100	
D40	1800	2100	2400	2100	
D41	1800	2100	2400	2100	
D42	1800	2100	2400	2100	
D43	1800	2100	2400	2100	
D44	1800	2100	2400	2100	
D45	1800	2100	2400	2100	
D46	1800	2100	2400	2100	
D47	1800	2100	2400	2100	
D48	1800	2100	2400	2100	
D49	1800	2100	2400	2100	
D50	1800	2100	2400	2100	
D51	1800	2100	2400	2100	
D52	1800	2100	2400	2100	
D53	1800	2100	2400	2100	
D54	1800	2100	2400	2100	
D55	1800	2100	2400	2100	
D56	1800	2100	2400	2100	
D57	1800	2100	2400	2100	
D58	1800	2100	2400	2100	
D59	1800	2100	2400	2100	
D60	1800	2100	2400	2100	
D61	1800	2100	2400	2100	
D62	1800	2100	2400	2100	
D63	1800	2100	2400	2100	
D64	1800	2100	2400	2100	
D65	1800	2100	2400	2100	
D66	1800	2100	2400	2100	
D67	1800	2100	2400	2100	
D68	1800	2100	2400	2100	
D69	1800	2100	2400	2100	
D70	1800	2100	2400	2100	
D71	1800	2100	2400	2100	
D72	1800	2100	2400	2100	
D73	1800	2100	2400	2100	
D74	1800	2100	2400	2100	
D75	1800	2100	2400	2100	
D76	1800	2100	2400	2100	
D77	1800	2100	2400	2100	
D78	1800	2100	2400	2100	
D79	1800	2100	2400	2100	
D80	1800	2100	2400	2100	
D81	1800	2100	2400	2100	
D82	1800	2100	2400	2100	
D83	1800	2100	2400	2100	
D84	1800	2100	2400	2100	
D85	1800	2100	2400	2100	
D86	1800	2100	2400	2100	
D87	1800	2100	2400	2100	
D88	1800	2100	2400	2100	
D89	1800	2100	2400	2100	
D90	1800	2100	2400	2100	
D91	1800	2100	2400	2100	
D92	1800	2100	2400	2100	
D93	1800	2100	2400	2100	
D94	1800	2100	2400	2100	
D95	1800	2100	2400	2100	
D96	1800	2100	2400	2100	
D97	1800	2100	2400	2100	
D98	1800	2100	2400	2100	
D99	1800	2100	2400	2100	
D100	1800	2100	2400	2100	

PROJECT TITLE:
PROPOSED (B+G+26) STORED RESIDENTIAL BUILDING
AT 3, NETAJI SUGHASH CHANDRA BOSE ROAD,
KOLKATA - 700040, P.S. - REGENT PARK, WARD - 97,
BOROUGH - X.

SHEET TITLE: PODIUM FLOORS & THIRD FLOOR PLANS

ARCHITECT:
Subir Kumar Basu
CONSULTING ARCHITECTS & ENGINEERS
4, BROAD STREET
CALCUTTA-700019

DESIGNED BY: SUBIR KUMAR BASU
CHECKED BY: SUBIR KUMAR BASU
APPROVED BY: SUBIR KUMAR BASU
SCALE: 1:150 SHEET NO. 1 OF 4 DATE: 20/01/17
DRAWING NO. - SP07TOLLYMORE03