

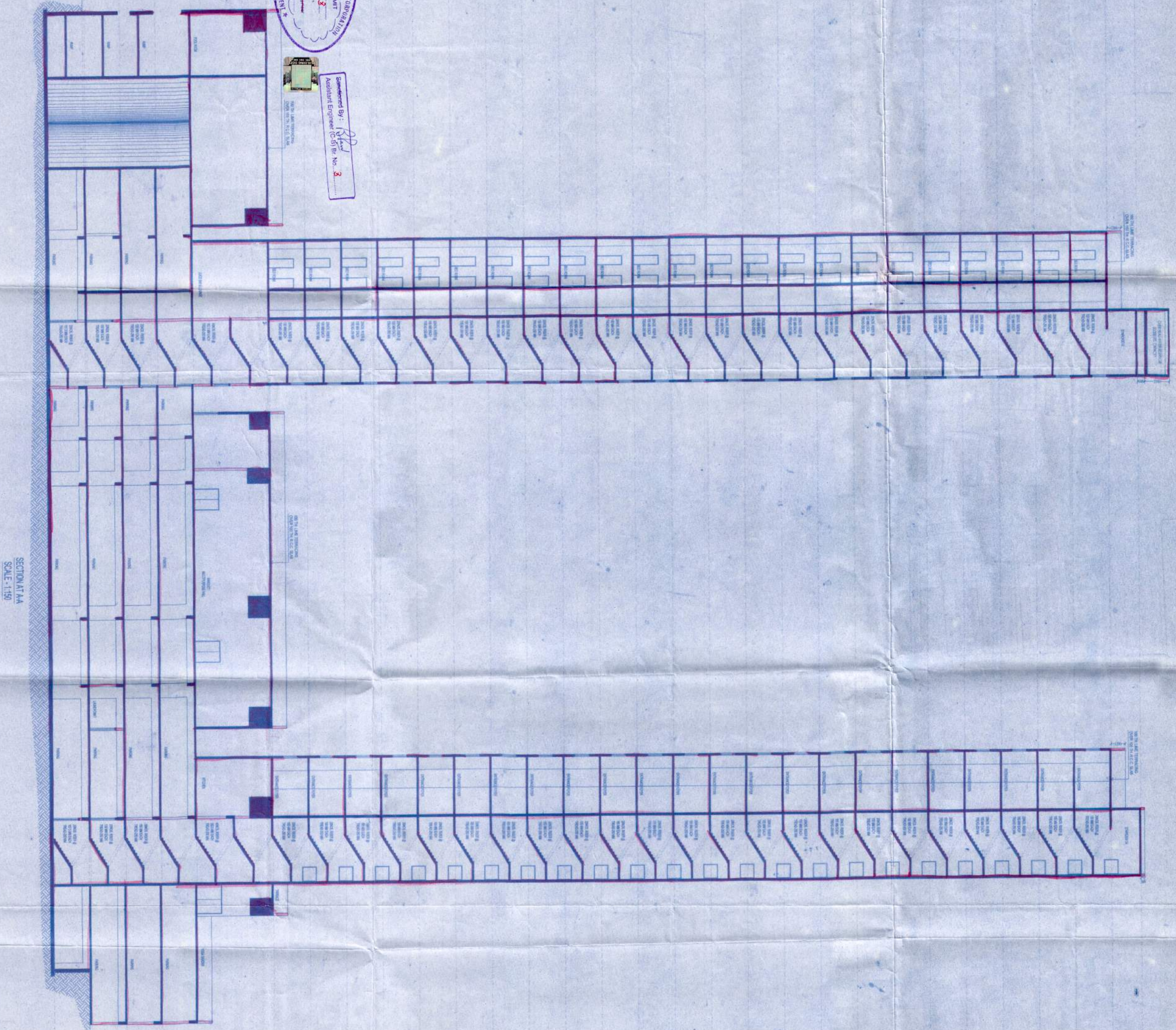

Prepared by: *Subir Kumar Basu*
 Assistant Engineer (S.D) No. 3
 State of West Bengal
 Date: 09/11/2018

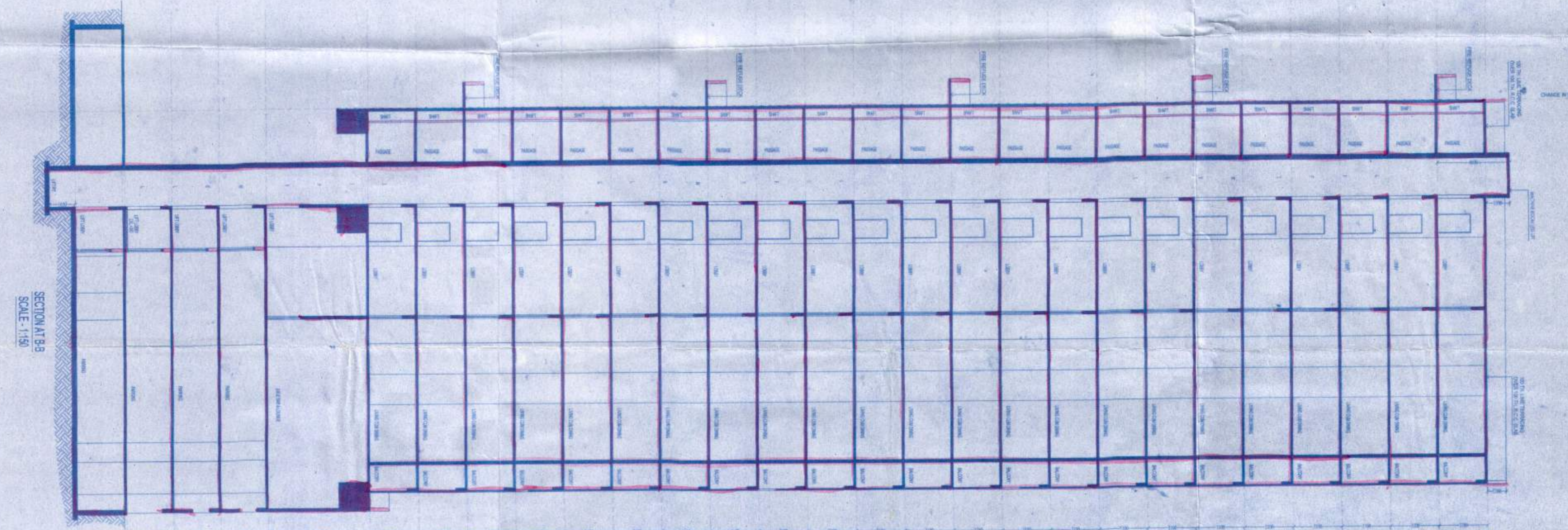

SECTION A1A
SCALE: 1/10



SECTION A1B
SCALE: 1/10

- SPECIFICATIONS:**
- All construction shall be in accordance with the latest Indian Standards.
 - The proposed structure shall be a permanent structure and shall be designed for a life span of 50 years.
 - The structure shall be designed for a maximum ground reaction of 150 kN/m².
 - The structure shall be designed for a maximum wind speed of 40 m/s.
 - The structure shall be designed for a maximum seismicity of 0.15.
 - The structure shall be designed for a maximum temperature of 40°C.
 - The structure shall be designed for a maximum humidity of 75%.
 - The structure shall be designed for a maximum rainfall of 1500 mm.
 - The structure shall be designed for a maximum snow load of 0.5 kN/m².
 - The structure shall be designed for a maximum ice load of 0.5 kN/m².
 - The structure shall be designed for a maximum wind load of 2.0 kN/m².
 - The structure shall be designed for a maximum seismic load of 0.15.
 - The structure shall be designed for a maximum temperature of 40°C.
 - The structure shall be designed for a maximum humidity of 75%.
 - The structure shall be designed for a maximum rainfall of 1500 mm.
 - The structure shall be designed for a maximum snow load of 0.5 kN/m².
 - The structure shall be designed for a maximum ice load of 0.5 kN/m².
 - The structure shall be designed for a maximum wind load of 2.0 kN/m².
 - The structure shall be designed for a maximum seismic load of 0.15.

M. K. ROY
 A. E. (S. D. CIVIL) (1977) E. No. 11
 State of West Bengal
 Date: 09/11/2018

Subir Kumar Basu
 Registered Architect
 Regn. No. CA/1842/18

TOLLANDUS SERVICES PVT. LTD.
 4/10, Sector 1, Salt Lake, Kolkata - 700061
 Contact: 98304 44444

Subir Kumar Basu
 Registered Architect
 Regn. No. CA/1842/18

DOORS AND WINDOW SCHEDULES:

NO.	DESCRIPTION	QTY	UNIT	REMARKS
01	WOODEN DOOR	10	NO.	
02	WOODEN WINDOW	20	NO.	
03	ALUMINIUM WINDOW	10	NO.	
04	ALUMINIUM DOOR	5	NO.	
05	GLASS WINDOW	10	NO.	
06	GLASS DOOR	5	NO.	
07	WOODEN DOOR	10	NO.	
08	WOODEN WINDOW	20	NO.	
09	ALUMINIUM WINDOW	10	NO.	
10	ALUMINIUM DOOR	5	NO.	
11	GLASS WINDOW	10	NO.	
12	GLASS DOOR	5	NO.	
13	WOODEN DOOR	10	NO.	
14	WOODEN WINDOW	20	NO.	
15	ALUMINIUM WINDOW	10	NO.	
16	ALUMINIUM DOOR	5	NO.	
17	GLASS WINDOW	10	NO.	
18	GLASS DOOR	5	NO.	
19	WOODEN DOOR	10	NO.	
20	WOODEN WINDOW	20	NO.	
21	ALUMINIUM WINDOW	10	NO.	
22	ALUMINIUM DOOR	5	NO.	
23	GLASS WINDOW	10	NO.	
24	GLASS DOOR	5	NO.	
25	WOODEN DOOR	10	NO.	
26	WOODEN WINDOW	20	NO.	
27	ALUMINIUM WINDOW	10	NO.	
28	ALUMINIUM DOOR	5	NO.	
29	GLASS WINDOW	10	NO.	
30	GLASS DOOR	5	NO.	

PROJECT TITLE:
 PROPOSED B+C+D STORED RESIDENTIAL BUILDING
 AT 3, NEETA SIBHASH CHANDRA BOSE ROAD,
 KOLKATA - 700040, P.S. - REGEN PARK, WARD - 97,
 BOROUGH - X

SHEET TITLE: SECTION A1 & SECTION A2

Sd/- Subir Kumar Basu
 CONSULTING ARCHITECTS & ENGINEERS
 CALCUTTA-700033

DRAWN BY: SUBIR KUMAR BASU
 CHECKED BY: SUBIR KUMAR BASU
 DATE: 09/11/2018
 SHEET NO: 1/1