

**SCHEDULE OF DOORS & WINDOWS**

DOOR/WINDOW NO.	DOOR/WINDOW TYPE	DOOR/WINDOW SIZE	DOOR/WINDOW QTY.	DOOR/WINDOW MATERIAL
D1	DOOR	1500 X 2100	1	ALUMINUM
D2	DOOR	900 X 2100	1	ALUMINUM
D3	DOOR	1800 X 2100	1	ALUMINUM
D4	DOOR	1800 X 2100	1	ALUMINUM
D5	DOOR	1800 X 2100	1	ALUMINUM
D6	DOOR	1800 X 2100	1	ALUMINUM
D7	DOOR	1800 X 2100	1	ALUMINUM
D8	DOOR	1800 X 2100	1	ALUMINUM
D9	DOOR	1800 X 2100	1	ALUMINUM
D10	DOOR	1800 X 2100	1	ALUMINUM
W1	WINDOW	1800 X 1500	1	ALUMINUM
W2	WINDOW	1800 X 1500	1	ALUMINUM
W3	WINDOW	1800 X 1500	1	ALUMINUM
W4	WINDOW	1800 X 1500	1	ALUMINUM
W5	WINDOW	1800 X 1500	1	ALUMINUM
W6	WINDOW	1800 X 1500	1	ALUMINUM
W7	WINDOW	1800 X 1500	1	ALUMINUM
W8	WINDOW	1800 X 1500	1	ALUMINUM
W9	WINDOW	1800 X 1500	1	ALUMINUM
W10	WINDOW	1800 X 1500	1	ALUMINUM

**STATEMENT OF THE PLAN PROPOSAL**

1. ASSESSOR NO: 41/1/31/34/2008-7  
 2. DETAIL OF RECORDED DEED: ...  
 3. DETAIL OF POWER OF ATTORNEY: ...  
 4. DETAIL OF BOUNDARY DEC.: ...  
 5. DETAIL OF SPVAY COMMITTEE: ...  
 6. NAME OF LAND: ...  
 7. AREA OF LAND: ...  
 8. SIZE OF TOWNSHIP: ...

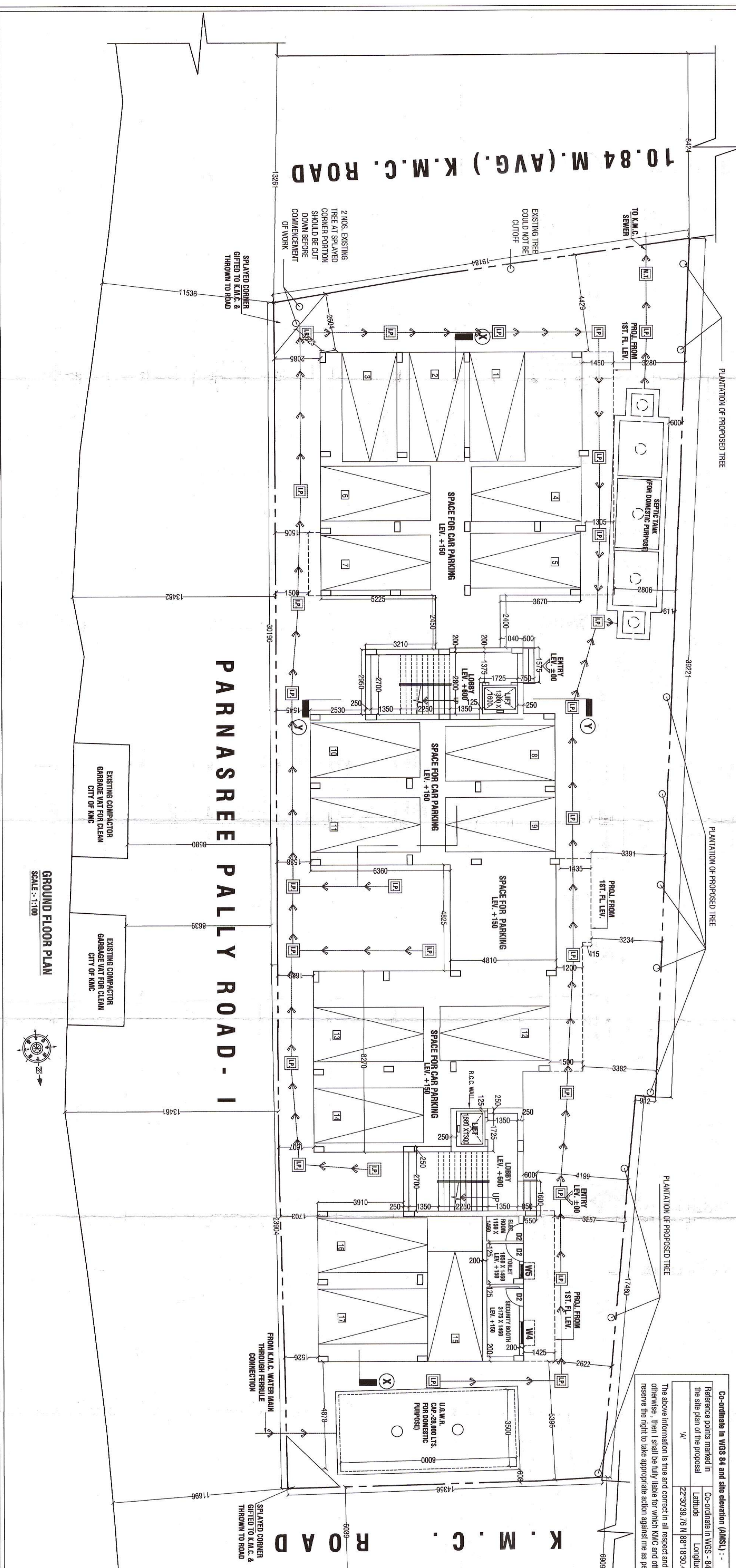

**Co-ordinate in WGS 84 and site elevation (AMSLL)**

Reference points marked in the site plan of the proposal	Co-ordinate in WGS - 84	Site elevation (AMSLL)	
	Latitude	Longitude	
A	22°30'39.70" N	88°16'30.43" E	10.0 M.

The above information is true and correct in all respect and if at any stage, it found otherwise, then I shall be fully liable for which K.M.C. and other appropriate authority reserve the right to take appropriate action against me as per law.

**DECLARATION OF ARCHITECT:**  
 I, the undersigned, being a duly qualified and licensed Architect, do hereby declare that the information furnished above is true and correct in all respects and if at any stage, it is found otherwise, then I shall be fully liable for which K.M.C. and other appropriate authority reserve the right to take appropriate action against me as per law.

**DECLARATION OF OWNERS:**  
 I, the undersigned, do hereby declare that the information furnished above is true and correct in all respects and if at any stage, it is found otherwise, then I shall be fully liable for which K.M.C. and other appropriate authority reserve the right to take appropriate action against me as per law.

**JAYANTA NATH (CA/027/4438)**  
 SIGNED AND SEALED  
 REGISTERED ARCHITECT  
 REGD. NO: CA/027/4438

**PARTY'S COPY**

**RESIDENTIAL BUILDING**

**DEVIATION WOULD BE A DENOTATION**

**-CONSTRUCTION SITE SHALL BE MAINTAINED TO PREVENT MOSQUITO BREEDING AS REQUIRED U/S 486(1) & (3) OF CPC ACT 1989, IN SUCH MANNER SO THAT ALL WATER COLLECTIONS PARTICULARLY WATER VESSELS, VANS, BASKETS, SOILING SITES OPEN RECEPTACLES ETC AS MENTIONED CONSTRUCTION SITEWORK & VESSEL**

No rain water pipe should be fixed or discharged on Road or Footpath. The rain water pipe should be submitted at the Principal Executive Engineer's Office and the sanction obtained before proceeding with the drainage work.

Before starting any Construction the site must conform with plans sanctioned and all the conditions as produced in the plan should be fulfilled.

The validity of the written permission to execute the work is subject to the above conditions.

A suitable pump has to be provided i.e., pumping up rain water for the distribution to the houses. Unfiltered water from street must be not available.

Plan for Water Supply arrangement including SEMI L.I. & O. N. reservoirs should be submitted at the Office of the Executive Engineer Supply and the sanction obtained before proceeding with the work of construction. Deviation may lead to discontinuation of permission.

Non Commencement of Erection/ Re-Erection within 30 days will Require Fresh Application for Sanction.

All Building Materials to necessary & construction should conform to standards specified in the National Building Code of India.

Design of all Structural Members including that of the foundations should conform to the National Building Code of India.

CHECKED AND VERIFIED  
A.E.(C)/S.A.E.(C)



Necessary steps should be taken for the safety of the lines of the adjoining public and private properties during construction.

Structural plan and design calculation as submitted by the structural engineer have to be kept with B. P. No. 113 (B/L) 117. The original design calculation should be retained at the time of erection without making any alterations along with design calculation and stability conditions in the presence of the adjoining premises and public properties and safety of human life during construction.

By No. XTB/2017/117  
113 (B/L) 117