

**SITE PLAN OF 493 / B / 66 G.T ROAD (SOUTH) HOWRAH P.S - SHIBPUR
BOROUGH NO.- IV**

MOUZA - BAJE SHIBPUR UNDER HOWRAH MUNICIPAL CORPORATION

**TOTAL PROPERTY- 6 B - 07 K - 14 CH - 02 SFT. SHOWN IN [red] COLOUR ,
RESIDENTIAL BUILDING & LAND OF PART-I = 02 B - 02 K- 08 CH -30 SFT.
SHOWN IN [blue] COLOUR ,**

**RESIDENTIAL BUILDING & LAND OF PART-II = 02 B - 11 K- 07 CH - 15 SFT
SHOWN IN [green] COLOUR ,**

**SCHOOL BUILDING & LAND =11K- 02 CH - 32 SFT. SHOWN IN [brown] COLOUR ,
REHABILITATION & COMMERCIAL BUILDING & LAND =**

**16 K- 01CH -32 SFT.SHOWN IN [yellow] COLOUR ,
DRIVE WAY(PROPOSED) EAST SIDE OF SCHOOL & REHABILITATION &
COMMERCIAL BUILDING = 06K - 09 CH -28 SFT. SHOWN IN [pink] COLOUR**

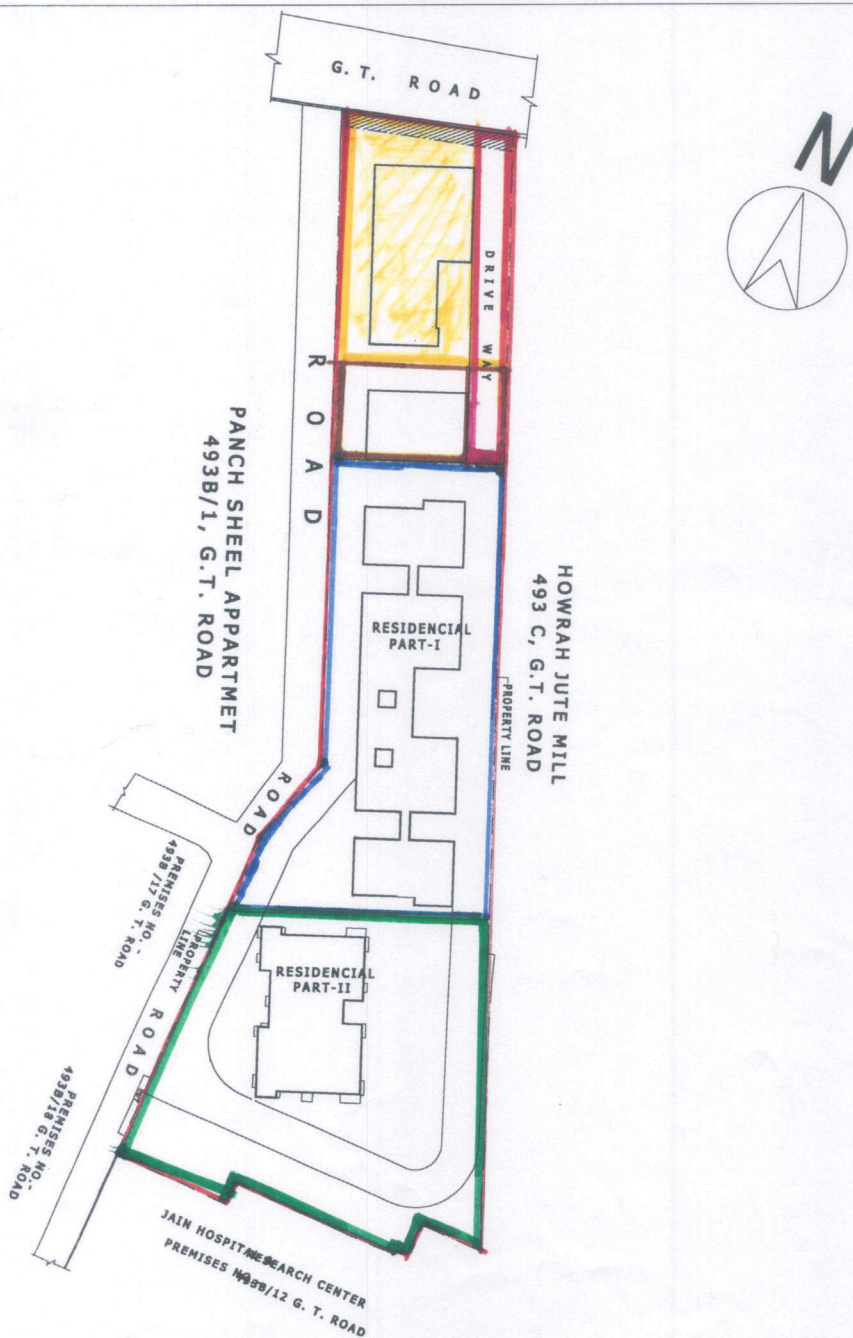

**DRAWN BY
K.CHOWDHURY**