

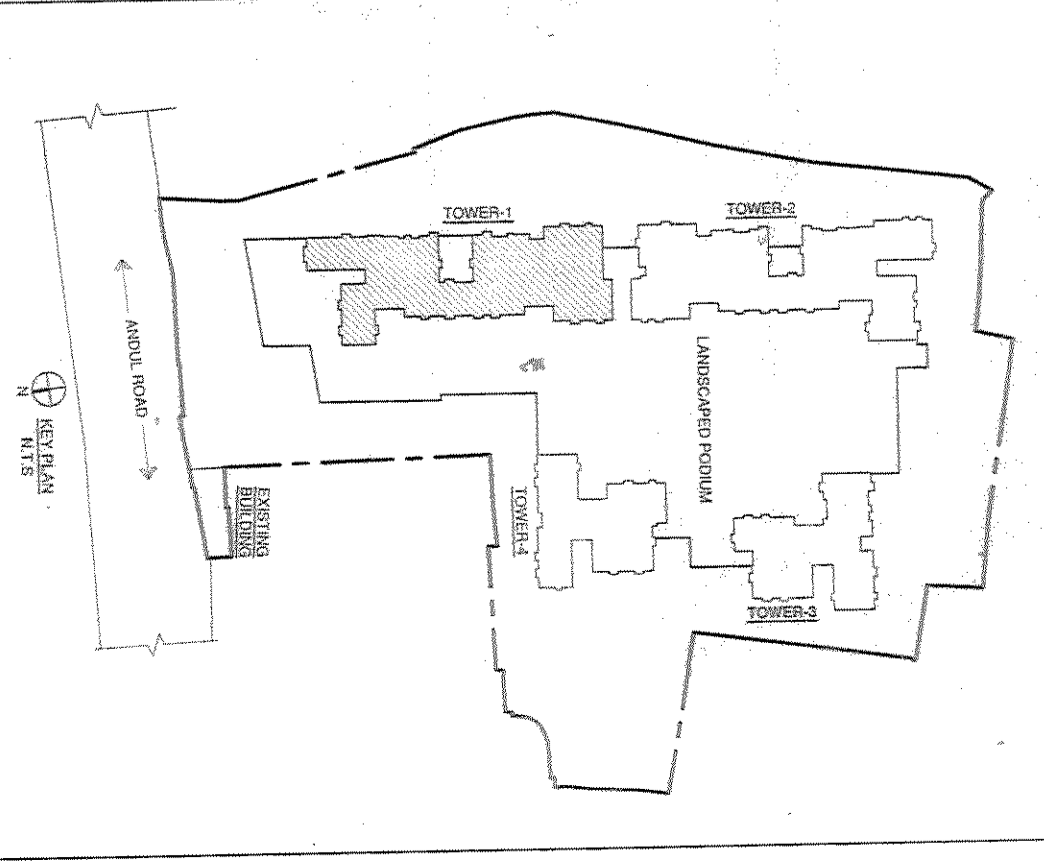

4TH FLOOR PLAN



5TH TO 8TH & 14TH TO 15TH FLOOR TYPICAL FLOOR PLAN



SCHEDULE OF FLOORS

NO	FLOOR	LEVEL	SIZE
01	1100 X 2150	LEVEL	
02	800 X 2150	LEVEL	
03	750 X 2150	LEVEL	
04	800 X 2150	LEVEL	
05	1475 X 2150	LEVEL	
06	1475 X 2150	LEVEL	
07	1475 X 2150	LEVEL	
08	1475 X 2150	LEVEL	
09	1000 X 2150	LEVEL	
10	1000 X 2150	LEVEL	
11	800 X 2150	LEVEL	
12	800 X 2150	LEVEL	
13	800 X 2150	LEVEL	
14	800 X 2150	LEVEL	
15	800 X 2150	LEVEL	
16	800 X 2150	LEVEL	
17	800 X 2150	LEVEL	
18	800 X 2150	LEVEL	
19	800 X 2150	LEVEL	
20	800 X 2150	LEVEL	
21	800 X 2150	LEVEL	
22	800 X 2150	LEVEL	
23	800 X 2150	LEVEL	
24	800 X 2150	LEVEL	
25	800 X 2150	LEVEL	
26	800 X 2150	LEVEL	
27	800 X 2150	LEVEL	
28	800 X 2150	LEVEL	
29	800 X 2150	LEVEL	
30	800 X 2150	LEVEL	
31	800 X 2150	LEVEL	
32	800 X 2150	LEVEL	
33	800 X 2150	LEVEL	
34	800 X 2150	LEVEL	
35	800 X 2150	LEVEL	
36	800 X 2150	LEVEL	
37	800 X 2150	LEVEL	
38	800 X 2150	LEVEL	
39	800 X 2150	LEVEL	
40	800 X 2150	LEVEL	
41	800 X 2150	LEVEL	
42	800 X 2150	LEVEL	
43	800 X 2150	LEVEL	
44	800 X 2150	LEVEL	
45	800 X 2150	LEVEL	
46	800 X 2150	LEVEL	
47	800 X 2150	LEVEL	
48	800 X 2150	LEVEL	
49	800 X 2150	LEVEL	
50	800 X 2150	LEVEL	
51	800 X 2150	LEVEL	
52	800 X 2150	LEVEL	
53	800 X 2150	LEVEL	
54	800 X 2150	LEVEL	
55	800 X 2150	LEVEL	
56	800 X 2150	LEVEL	
57	800 X 2150	LEVEL	
58	800 X 2150	LEVEL	
59	800 X 2150	LEVEL	
60	800 X 2150	LEVEL	
61	800 X 2150	LEVEL	
62	800 X 2150	LEVEL	
63	800 X 2150	LEVEL	
64	800 X 2150	LEVEL	
65	800 X 2150	LEVEL	
66	800 X 2150	LEVEL	
67	800 X 2150	LEVEL	
68	800 X 2150	LEVEL	
69	800 X 2150	LEVEL	
70	800 X 2150	LEVEL	
71	800 X 2150	LEVEL	
72	800 X 2150	LEVEL	
73	800 X 2150	LEVEL	
74	800 X 2150	LEVEL	
75	800 X 2150	LEVEL	
76	800 X 2150	LEVEL	
77	800 X 2150	LEVEL	
78	800 X 2150	LEVEL	
79	800 X 2150	LEVEL	
80	800 X 2150	LEVEL	
81	800 X 2150	LEVEL	
82	800 X 2150	LEVEL	
83	800 X 2150	LEVEL	
84	800 X 2150	LEVEL	
85	800 X 2150	LEVEL	
86	800 X 2150	LEVEL	
87	800 X 2150	LEVEL	
88	800 X 2150	LEVEL	
89	800 X 2150	LEVEL	
90	800 X 2150	LEVEL	
91	800 X 2150	LEVEL	
92	800 X 2150	LEVEL	
93	800 X 2150	LEVEL	
94	800 X 2150	LEVEL	
95	800 X 2150	LEVEL	
96	800 X 2150	LEVEL	
97	800 X 2150	LEVEL	
98	800 X 2150	LEVEL	
99	800 X 2150	LEVEL	
100	800 X 2150	LEVEL	

**SCHEDULE OF WINDOWS**

NO	TYPE	SIZE
W1	650 X 2150	1650 X 1200
W2	650 X 2150	600 X 1500
W3	650 X 2150	1200 X 1100
W4	1250 X 2150	1050 X 900
W5	1250 X 2150	1050 X 900
W6	950 X 2150	1600 X 1200
W7	950 X 2150	1600 X 1200
W8	950 X 2150	1475 X 1200
W9	950 X 2150	1475 X 1200
W10	950 X 2150	1400 X 425
W11	950 X 2150	700 X 425
W12	950 X 2150	700 X 425

**OWNER'S REQUIREMENTS**

1. THE DOOR TO BE BY REAR WITH FULL RESPONSIBILITY FOR THE CONSTRUCTION OF THE DOOR AND FRAME.

2. THE DOOR TO BE BY REAR WITH FULL RESPONSIBILITY FOR THE CONSTRUCTION OF THE DOOR AND FRAME.

3. THE DOOR TO BE BY REAR WITH FULL RESPONSIBILITY FOR THE CONSTRUCTION OF THE DOOR AND FRAME.

**REMARKS**

1. THE ARCHITECT HAS REVIEWED THE DRAWINGS AND FOUND THEM TO BE IN ACCORDANCE WITH THE REQUIREMENTS OF THE LOCAL AUTHORITY.

2. THE ARCHITECT HAS REVIEWED THE DRAWINGS AND FOUND THEM TO BE IN ACCORDANCE WITH THE REQUIREMENTS OF THE LOCAL AUTHORITY.

3. THE ARCHITECT HAS REVIEWED THE DRAWINGS AND FOUND THEM TO BE IN ACCORDANCE WITH THE REQUIREMENTS OF THE LOCAL AUTHORITY.

**APPROVALS**

FOR THE ARCHITECT: *[Signature]*

FOR THE OWNER: *[Signature]*

**NOTES**

1. THE ARCHITECT HAS REVIEWED THE DRAWINGS AND FOUND THEM TO BE IN ACCORDANCE WITH THE REQUIREMENTS OF THE LOCAL AUTHORITY.

2. THE ARCHITECT HAS REVIEWED THE DRAWINGS AND FOUND THEM TO BE IN ACCORDANCE WITH THE REQUIREMENTS OF THE LOCAL AUTHORITY.

**GENERAL NOTES**

1. ALL WORK TO BE DONE IN ACCORDANCE WITH THE REQUIREMENTS OF THE LOCAL AUTHORITY.

2. ALL WORK TO BE DONE IN ACCORDANCE WITH THE REQUIREMENTS OF THE LOCAL AUTHORITY.

**ARCHITECTS**

**SDB architects**

SCALE: 1:100

DATE: 01/03/18

CHECKED: *[Signature]*

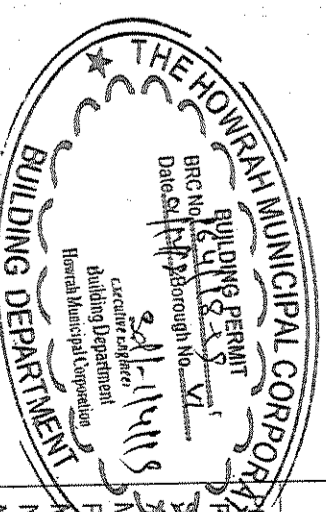

**PROJECT INFORMATION**

PROJECT NAME: **THE TOWER**

LOCATION: **11th TO 15th Floor**

OWNER: **PERMAL CONSTRUCTIONS LTD**

ARCHITECT: **SDB architects**