



SITE PLAN OF LAND & AREA OF PROPOSED B + G + IV BUILDING CONSTRUCTED BY SARITHA CONSTRUCTION & LAND OWNER'S I. SMT. SWAPNA GHOSH, W/O SRI AMAL GHOSH, 2. SMT. SHELLY CHOWDHURY, W/O LATE HEM CHANDRA CHOWDHURY, AT MOUZA- KHARIDA, J.L. NO- 194, R.S. KHAYLAN NO- 19/17, R.S. PLOT NO- 153, WARD NO- 17, HOLDING NO- P.S.- KHARAGPUR (C) DIST.- PASCHIM MEDINIPUR, UNDER KHARAGPUR MUNICIPALITY.

TOTAL AREA OF LAND = 929.85 SQ.MT

PERMISSIBLE CONSTRUCTION AREA = 464.94 SQ.MT = 50%

PLOT LINE _____ DRAIN _____

ELECTRIC POST 

EXISTING ROAD 

BUILDING HEIGHT - 19.5 M

SITE PLAN
SCALE :- 1:200

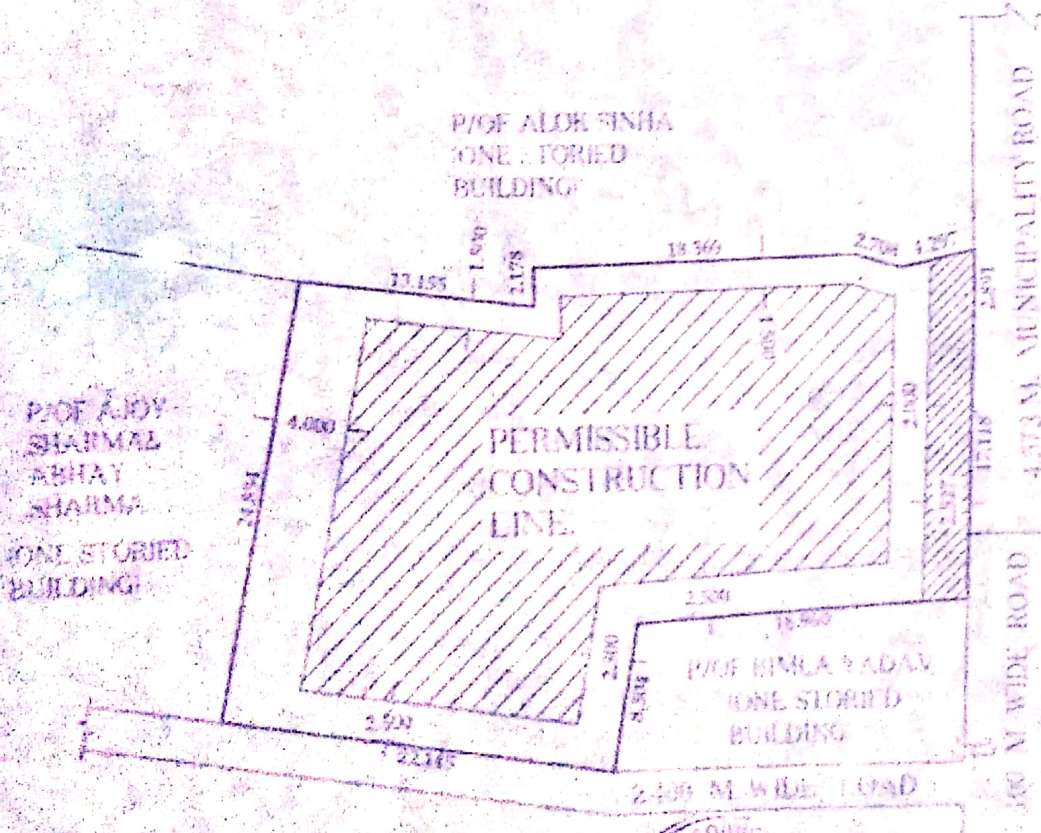
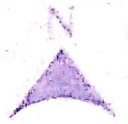

Received without Verification
KHARAGPUR MUNICIPALITY

OPEN SPACE AS PER W.B. MUNICIPAL BUILDING RULES 2007
SURVEYOR

2.527 M WIDE STRIP OF ROAD GIFTED TO MUNICIPALITY

Technically the plan is Acceptable
Sub-Assistant Engineer
Khargapur Municipality

SARITHA CONSTRUCTIONS
Mr. Swarna Swarna
PARTNER

SARITHA CONSTRUCTIONS
M. Saritha
PARTNER



It may be sanctioned on Terms and Condition given to the Surveyor

Asst. Engineer
Khargapur Municipality

SAISONED
ON TERMS & CONDITION
GIVEN BY SURVEYOR & A.E

TUSHAR KANTI CHAUDHURI
CIVIL ENGINEER
Class-I, L.B.S., Khargapur Municipality
Paschim Medinipore
Licence No-K.M.L.B.S./19-20/1

SIGNATURE OF OWNER

SITE PLAN OF LAND & AREA OF PROPOSED B + G + IV BUILDING CONSTRUCTED BY SARITHA CONSTRUCTION & LAND OWNER'S I. SMT. SWAPNA GHOSH, W/O SRI AMAL GHOSH, 2. SMT. SHELLY CHOWDHURY, W/O LATE HEM CHANDRA CHOWDHURY, AT MOUZA - KHARIDA, J.L. NO- 194, R.S. KHATAN NO- 19/17, R.S. PLOT NO- 153, WARD NO- 17, HOLDING NO- P.S. - KHARAGPUR (D) DIST. PASCHIM MEDINIPUR, UNDER KHARAGPUR MUNICIPALITY.

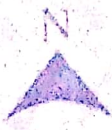

TOTAL AREA OF LAND = 929.55 SQ.MT
 PERMISSIBLE CONSTRUCTION AREA = 464.77 SQ.MT = 50%

PLOT LINE _____ DRAIN _____
 ELECTRIC POST [Symbol] BUILDING HEIGHT - 13.5 M
 EXISTING ROAD [Symbol]

SITE PLAN
SCALE : 1:300

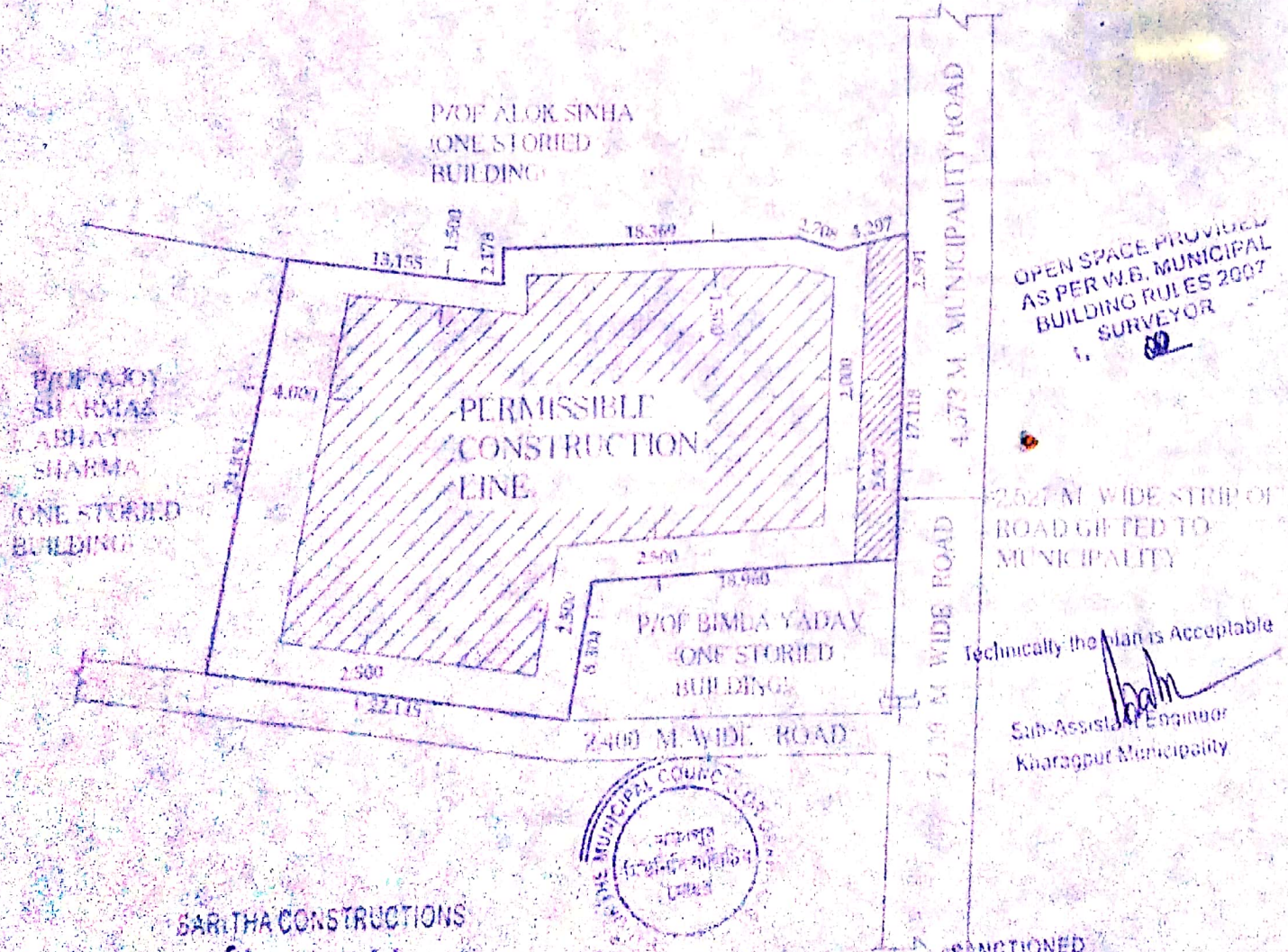

OPEN SPACE PROVIDED AS PER W.B. MUNICIPAL BUILDING RULES 2007
 I. SURVEYOR

Technically the plan is Acceptable
 Sub-Assistant Engineer
 Kharagpur Municipality

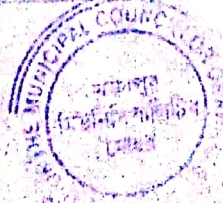

SARITHA CONSTRUCTIONS
 M. Shiva Shankar
 PARTNER

SARITHA CONSTRUCTIONS
 M. Ranika
 PARTNER

It may be sanctioned on Terms and Condition given by the Surveyor

Asst. Engineer
 Kharagpur Municipality

Sanctioned on terms & condition given by Surveyor & A.E

CHAIRMAN / VICE CHAIRMAN
TUSHAR KANTI CHAUDHURI
 CIVIL ENGINEER
 Class-I, L.B.S., Kharagpur Municipality
 Paschim Medinipore
 Licence No-K.M.J.L.B.S./19-20/1

(Handwritten signature)

SIGNATURE OF OWNER