

CO-ORDINATE LIST OF STATION POINT

STN. NO	EASTING	NORTHING
ST-01	1000.000	1000.000
ST-02	1000.000	1006.7470
ST-21	1011.9639	991.5330
ST-22	1017.9570	987.4050
BW-01	1018.9210	999.7770
BW-02	996.0510	985.5260
BW-03	1007.2525	969.3258
BW-04	1031.8460	985.2830

N=1015.00
N=1010.00
N=1005.00
N=1000.00
N=995.00
N=990.00
N=985.00
N=980.00
N=975.00
N=970.00
N=965.00
E=980.00
E=985.00
E=990.00
E=995.00
E=1000.00
E=1005.00
E=1010.00
E=1015.00
E=1020.00
E=1025.00
E=1030.00
E=1035.00
E=1040.00

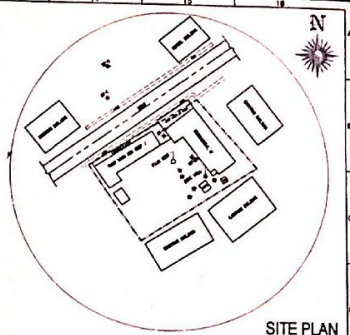
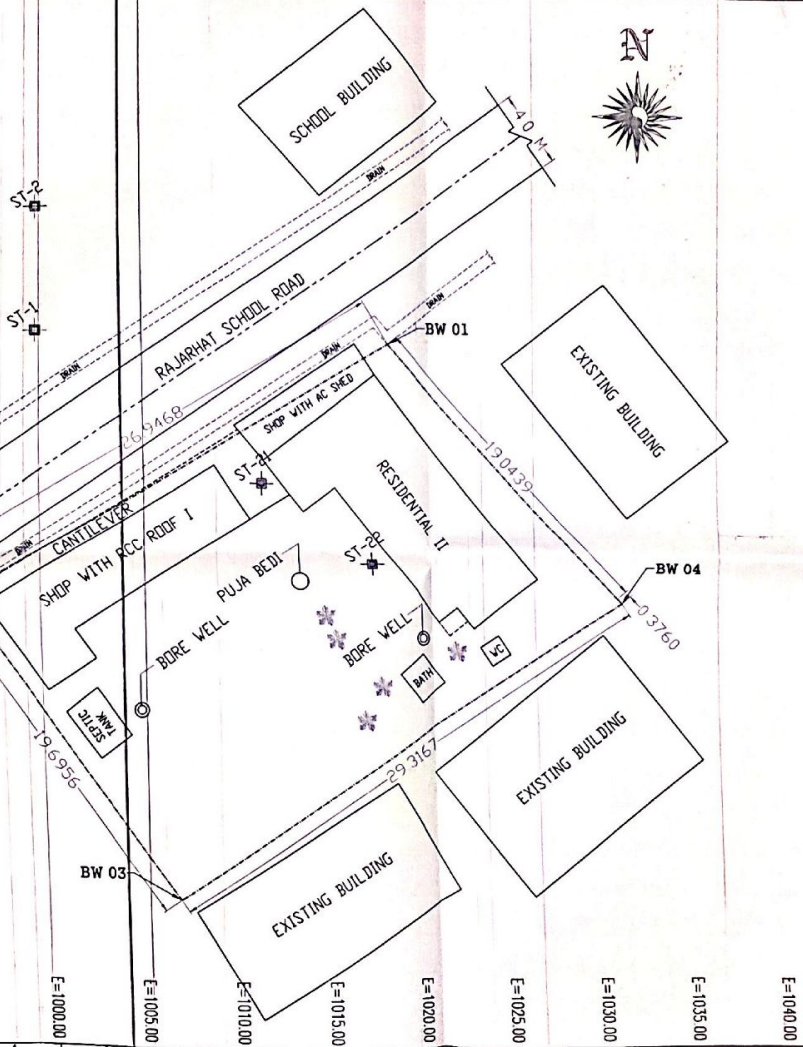

SITE PLAN
SCALE - 1:800

- NOTES:**
1. ALL DIMENSIONS ARE IN METRES, EXCEPT IF STATED OTHERWISE
 2. SURVEY BASED ON ASSUMED CO-ORDINATE (E=1000.000, N=1000.000) OF STATION POINT ST1
 3. PROPERTY AREA 546.2003 SQM. (0.13496 ACRE)

LEGEND

	PROPERTY LINE		DRAIN
	EXISTING FACILITIES		GRIDE LINE
	ROAD		STATION POINT

Signature of Surveyor: *Dr. Mahendra K. J. 14/01/18*

Signature of Engineer: _____

SIGNATURE OF ENGINEER		SIGNATURE OF SURVEYOR	
DATE	DESCRIPTION	DRAWING NO.	REV. DEPT.

NILADRI MUKHERJEE & ADITYA MUKHERJEE

ENGINEERS CONSULTANTS

115, K. L. KHOSLA ROAD, BUDGE BUDGE, PO. 753, 17
M.C.D. DISTRICT, A.P. 500038

REGISTRATION NO. 140, CIVIL ENGINEERS, 2002 - HYDRABAD, INDIA.

SCALE: 1:800
SHEET 1 OF 1
DATE: 14/01/18

PROJECT: AREA SURVEY REPORT OF LAND