

PROPOSED SITE PLAN OF  
745 BANDHGORA POLLY SOUTH  
BOLPUR BIRBHUM

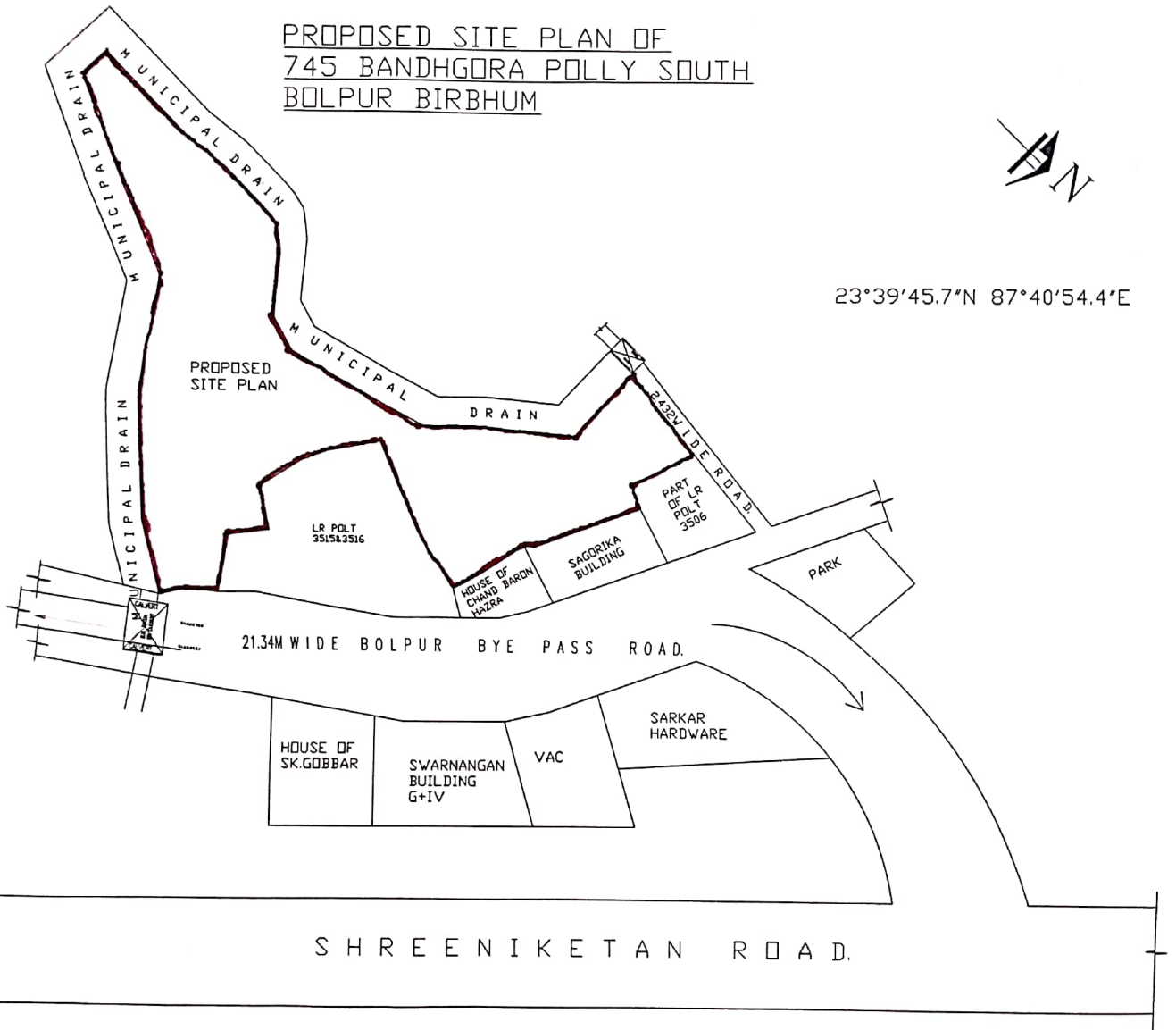

23°39'45.7"N 87°40'54.4"E



PRODUCED BY AN AUTODESK EDUCATIONAL PRODUCT

PRODUCED BY AN AUTODESK EDUCATIONAL PRODUCT

LOCATION PLAN

ARSUDAY EVERA GARDEN LLP

*Manish Singh*  
Designater

SIGN. OF OWNER

*M. Mondal*  
1137(i)  
(MANAS KUMAR MONDAL)  
L.B.S.No.- 1137 (I)

DRAWN BY - M. MONDAL