

"SITE - PLAN" IN R.S. DAG
 NO. 344 AND 344/436, AT MOUJA: BAIKUNTHAPUR, J.L. 37,
 KHATIYAN NO. FROM 1414 TO 1421, WARD No. 17, P.S: SONAR-
 PUR, DIST. 24 PGS(S). SCALE: 40' = 1".

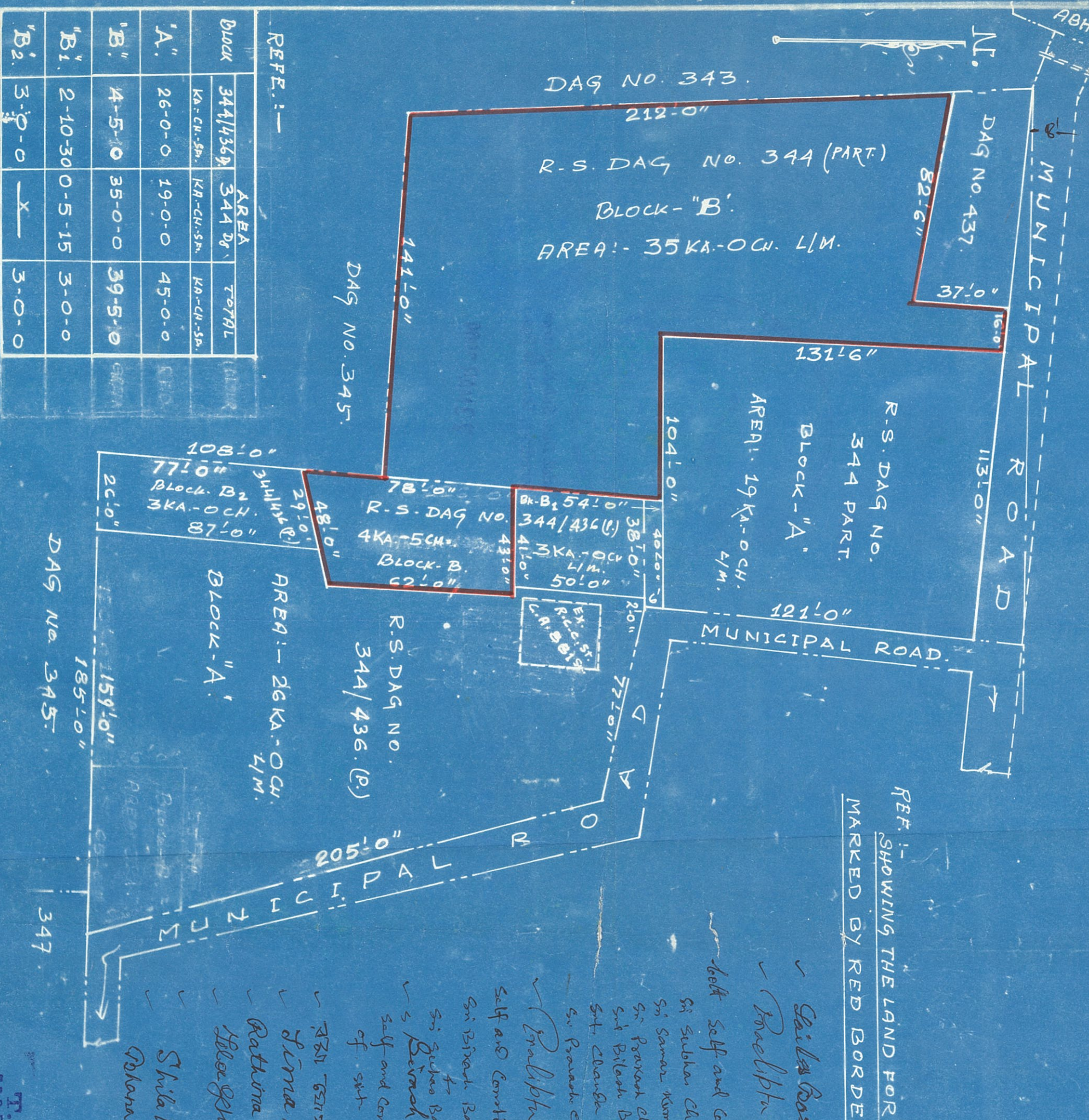

REFE.:-

Block	344/436	344 Dg	TOTAL
"A"	26-0-0	19-0-0	45-0-0
"B"	4-5-10	35-0-0	39-5-10
"B1"	2-10-30	0-5-15	3-0-0
"B2"	3-0-0	X	3-0-0

REF.:-
 SHOWING THE LAND FOR
 MARKED BY RED BORDER

- ✓ Sailas Das
- ✓ Pralipha
- ✓ Self and Co
- ✓ Sri Subhan Das
- ✓ Sri Saman Kumar
- ✓ Sri Praveer Das
- ✓ Sri Bilash Das
- ✓ Sri. Claude
- ✓ Sri Praveer Das
- ✓ Pralipha
- ✓ Self and Co
- ✓ Sri Binod Das
- ✓ Sri Gulab Das
- ✓ Sri Beemoh
- ✓ Self and Co
- ✓ of Sri
- ✓ Sri Das
- ✓ Jina
- ✓ Rathina
- ✓ Hara Das
- ✓ Shilpa
- ✓ Debona