

SCHEDULE OF ROOFS & WINDOWS

TYPE	AREA (SQ. M)	PERCENTAGE	NO. OF UNITS	UNIT PRICE (RS)	TOTAL VALUE (RS)
1	1200	10.00	1200	1000	1200000
2	1500	12.50	1500	1000	1500000
3	1800	15.00	1800	1000	1800000
4	2100	17.50	2100	1000	2100000
5	2400	20.00	2400	1000	2400000
6	2700	22.50	2700	1000	2700000
7	3000	25.00	3000	1000	3000000
8	3300	27.50	3300	1000	3300000
9	3600	30.00	3600	1000	3600000
10	3900	32.50	3900	1000	3900000
11	4200	35.00	4200	1000	4200000
12	4500	37.50	4500	1000	4500000
13	4800	40.00	4800	1000	4800000
14	5100	42.50	5100	1000	5100000
15	5400	45.00	5400	1000	5400000
16	5700	47.50	5700	1000	5700000
17	6000	50.00	6000	1000	6000000
18	6300	52.50	6300	1000	6300000
19	6600	55.00	6600	1000	6600000
20	6900	57.50	6900	1000	6900000
21	7200	60.00	7200	1000	7200000
22	7500	62.50	7500	1000	7500000
23	7800	65.00	7800	1000	7800000
24	8100	67.50	8100	1000	8100000
25	8400	70.00	8400	1000	8400000
26	8700	72.50	8700	1000	8700000
27	9000	75.00	9000	1000	9000000
28	9300	77.50	9300	1000	9300000
29	9600	80.00	9600	1000	9600000
30	9900	82.50	9900	1000	9900000
31	10200	85.00	10200	1000	10200000
32	10500	87.50	10500	1000	10500000
33	10800	90.00	10800	1000	10800000
34	11100	92.50	11100	1000	11100000
35	11400	95.00	11400	1000	11400000
36	11700	97.50	11700	1000	11700000
37	12000	100.00	12000	1000	12000000

SPECIFICATION OF BUILDING

1. ALL DIMENSIONS ARE IN MM.
2. ALL WORK SHALL BE DONE IN ACCORDANCE WITH THE SPECIFICATIONS OF THE BIDDING DOCUMENTS.
3. ALL MATERIALS SHALL BE OF THE BEST QUALITY AND SHALL BE SUPPLIED BY THE CONTRACTOR.
4. ALL WORK SHALL BE DONE IN ACCORDANCE WITH THE IS CODES.
5. ALL WORK SHALL BE DONE IN ACCORDANCE WITH THE LOCAL LAWS AND REGULATIONS.
6. ALL WORK SHALL BE DONE IN ACCORDANCE WITH THE REQUIREMENTS OF THE ARCHITECT.
7. ALL WORK SHALL BE DONE IN ACCORDANCE WITH THE REQUIREMENTS OF THE ENGINEER.
8. ALL WORK SHALL BE DONE IN ACCORDANCE WITH THE REQUIREMENTS OF THE CONTRACTOR.
9. ALL WORK SHALL BE DONE IN ACCORDANCE WITH THE REQUIREMENTS OF THE OWNER.
10. ALL WORK SHALL BE DONE IN ACCORDANCE WITH THE REQUIREMENTS OF THE AUTHORITY.
11. ALL WORK SHALL BE DONE IN ACCORDANCE WITH THE REQUIREMENTS OF THE GOVERNMENT.
12. ALL WORK SHALL BE DONE IN ACCORDANCE WITH THE REQUIREMENTS OF THE SOCIETY.
13. ALL WORK SHALL BE DONE IN ACCORDANCE WITH THE REQUIREMENTS OF THE NEIGHBOURHOOD.
14. ALL WORK SHALL BE DONE IN ACCORDANCE WITH THE REQUIREMENTS OF THE ENVIRONMENT.
15. ALL WORK SHALL BE DONE IN ACCORDANCE WITH THE REQUIREMENTS OF THE CLIMATE.
16. ALL WORK SHALL BE DONE IN ACCORDANCE WITH THE REQUIREMENTS OF THE CULTURE.
17. ALL WORK SHALL BE DONE IN ACCORDANCE WITH THE REQUIREMENTS OF THE HISTORY.
18. ALL WORK SHALL BE DONE IN ACCORDANCE WITH THE REQUIREMENTS OF THE ART.
19. ALL WORK SHALL BE DONE IN ACCORDANCE WITH THE REQUIREMENTS OF THE SCIENCE.
20. ALL WORK SHALL BE DONE IN ACCORDANCE WITH THE REQUIREMENTS OF THE TECHNOLOGY.

SECTION AT XX
SCALE: 1:50

SECTION AT YY
SCALE: 1:50

DETAIL PLAN OF S.T.P.
CAPACITY: 120 KLD
SCALE: 1:50

DETAIL OF BORE HOLES

THE LINE OF WORKING OF THE CONTRACTOR SHOULD CONDUCT THE BORE HOLES IN SUCH A MANNER THAT THE BORE HOLES SHOULD NOT BE NEARER THAN 1.0 M TO THE EXISTING BORE HOLES. THE BORE HOLES SHOULD BE NEARER THAN 1.0 M TO THE EXISTING BORE HOLES.

NO. OF BORE HOLES: 12 NOS. OF BORE HOLES @ 25000 LITERS PER HOUR.

NO. OF FEEDS: 12 NOS.

NO. OF LADDERS: 12 NOS.

NO. OF COMMERCIAL: 12 NOS.

NO. OF RESIDENTIAL: 12 NOS.

NO. OF INDUSTRIAL: 12 NOS.

NO. OF OTHER: 12 NOS.

UNDERGROUND WATER RESERVOIR
CAPACITY: 10000 LITERS

UNDERGROUND WATER RESERVOIR
CAPACITY: 10000 LITERS

UNDERGROUND WATER RESERVOIR
CAPACITY: 10000 LITERS

PROPOSED GATE PAVED (38.50 METER) RESIDENTIAL BUILDING
DISTRICT: NORTH OF PANCHAYAT UNDER TRANCER BHITHARA
GATE NO: 101

DATE: 10/10/2023
JOB NO.: 2023/101
BEAT: 101
CHECKED: 10/10/2023
SCALE: 1:100
DATE: 10/10/2023
JOB NO.: 2023/101
BEAT: 101
CHECKED: 10/10/2023
SCALE: 1:100

RAJ AGRAWAL & ASSOCIATES
ARCHITECTS

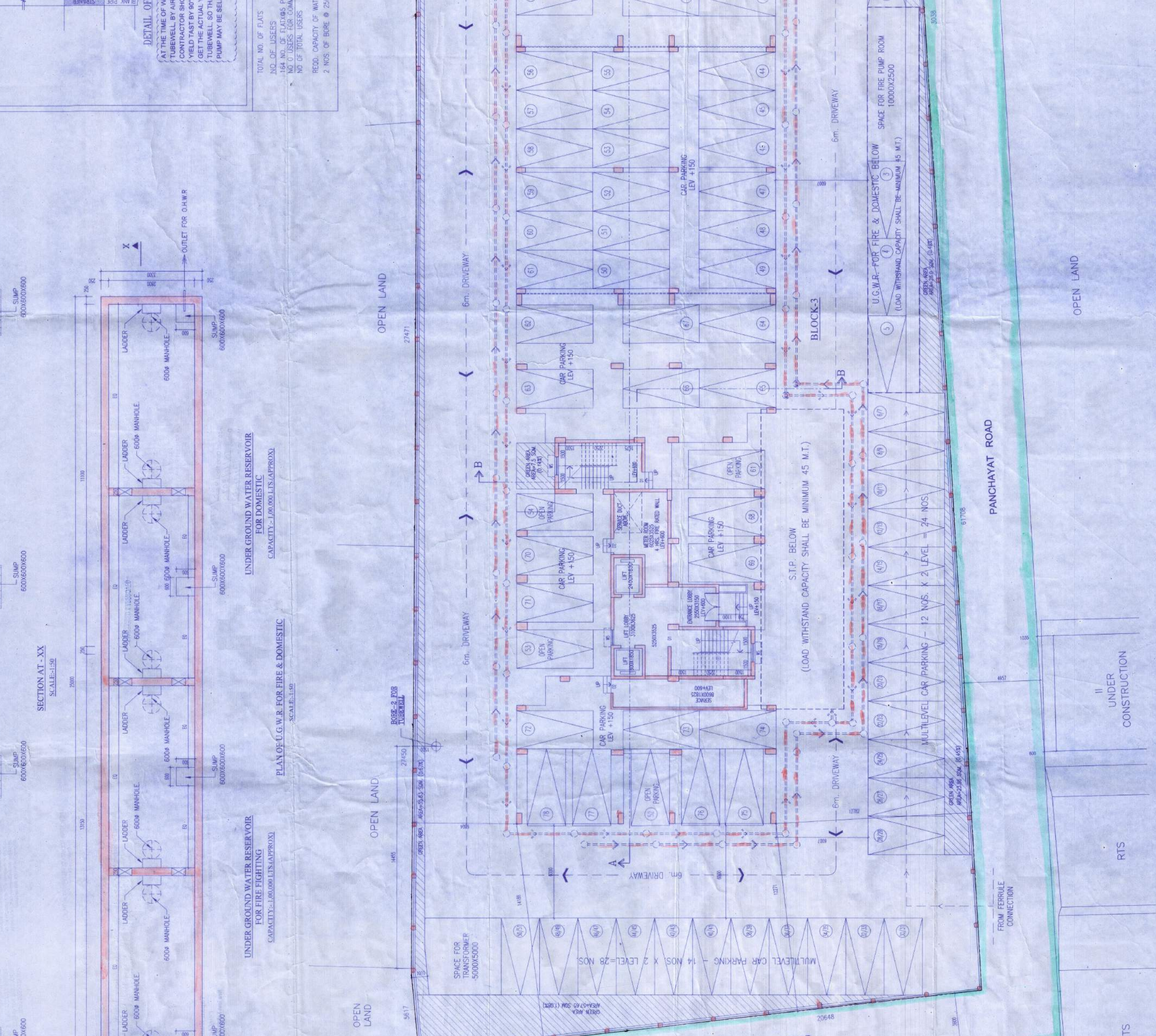
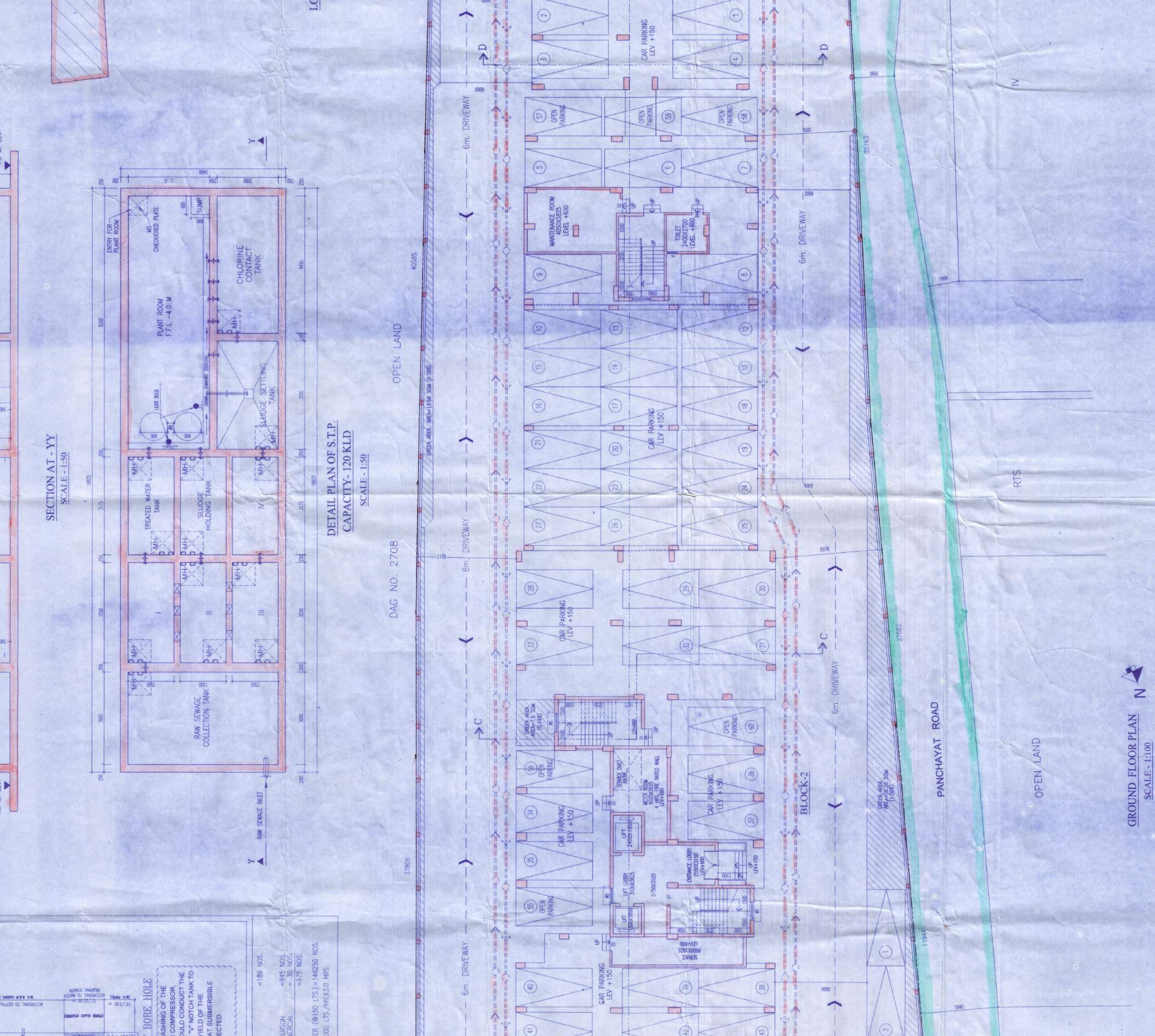
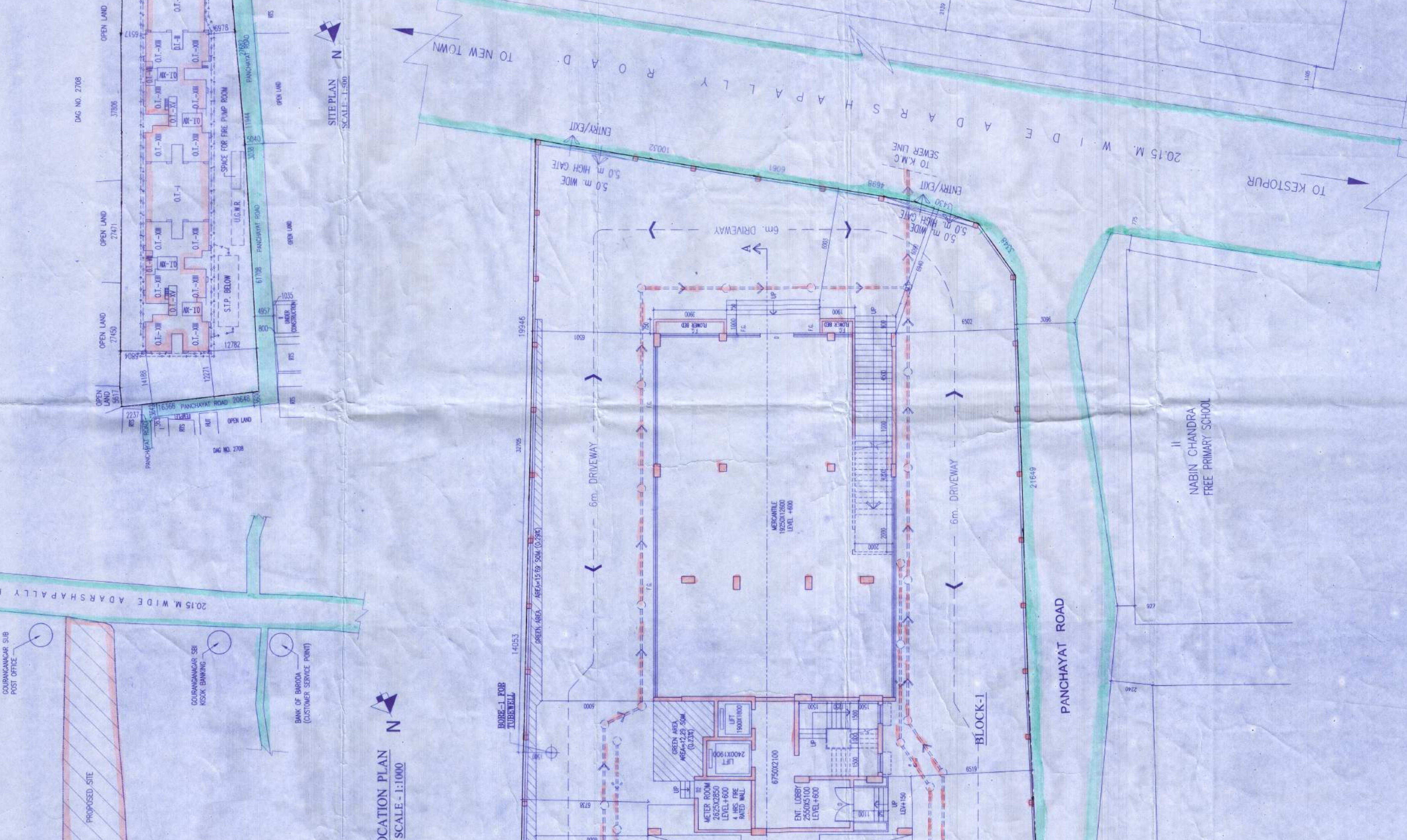

AREA STATEMENT

NO. OF CAR PARKING: 12 NOS. OF CAR PARKING @ 25000 LITERS PER HOUR.

NO. OF FEEDS: 12 NOS.

NO. OF LADDERS: 12 NOS.

NO. OF COMMERCIAL: 12 NOS.

NO. OF RESIDENTIAL: 12 NOS.

NO. OF INDUSTRIAL: 12 NOS.

NO. OF OTHER: 12 NOS.