

SALE DEED PLAN OF 6 K. 10 CH. LAND, MARKED
 BY RED BOUNDARY LINES, UNDER G.S. DAG
 NO:- 4141 AND 4142, KHATIAN NO:- 1924,
 MOUZA :- KHARDAH, J.L. NO:- , P.S. KHARDAH,
 DIST. 24-PARGANAS (NORTH).
 SCALE :- 1" = 20'-0"

* NAME OF VENDEES (বিক্রেতার নাম):-
 1. SRI BANSHIDHAR AGARWAL.
 2. SMT. GOMATI DEVI

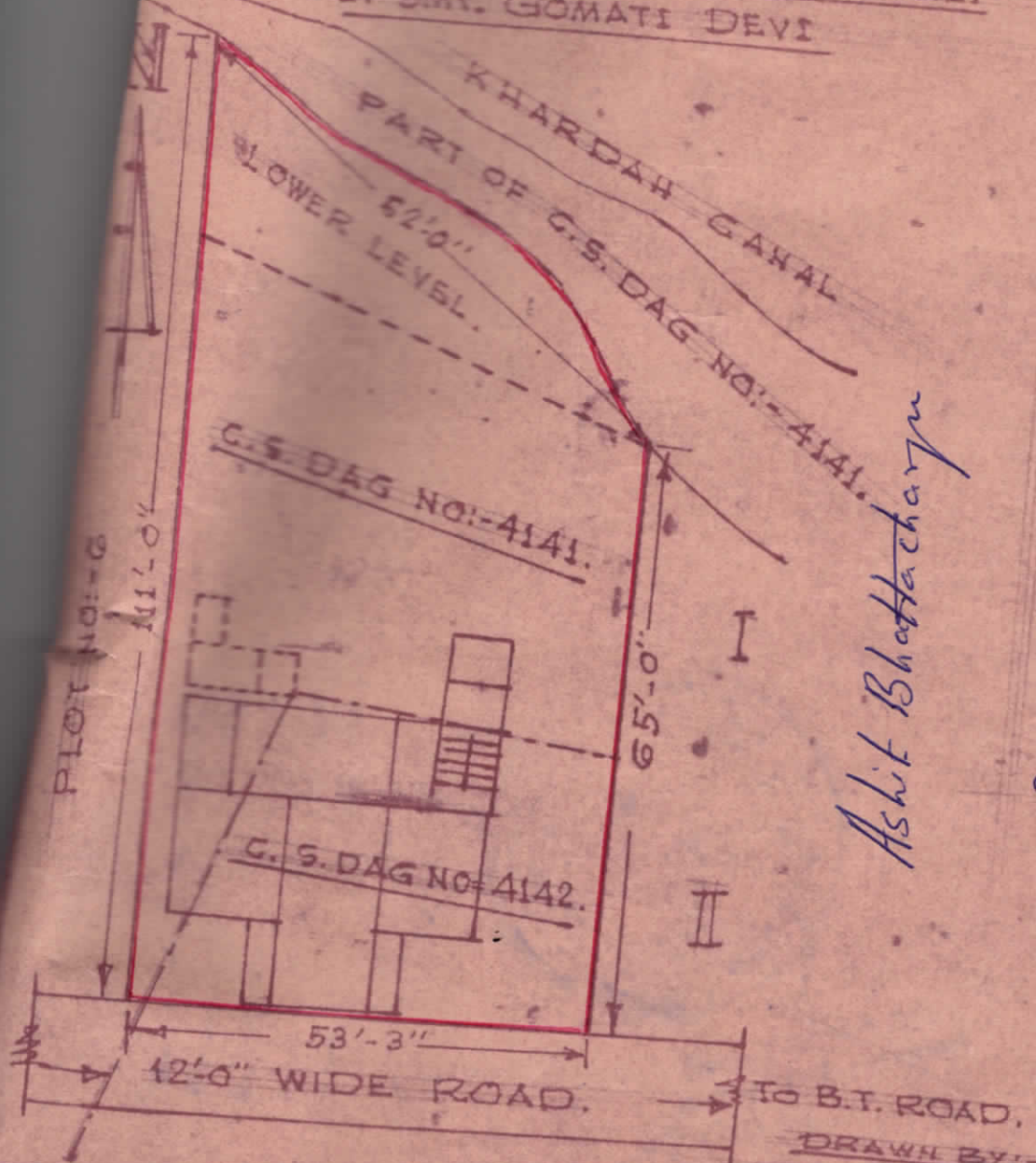

Ashit Bhattacharya

*Reynxmi Devi
 Aparna Chakraborty*

* SIGNATURE OF VENDORS (বিক্রেতার স্বাক্ষর):-

DRAWN BY:-
A. Singha D/MAN.
 CALCUTTA-14. 10.10.28

THE DAY OF 1988

DEED OF SALE

BETWEEN

1. Asit Bhattacharya
2. Smt. Rajluxmi Devi
3. Smt. Aparna Chakraborti

... VENDORS

AND

1. Sri Banshidhar Agarwala
2. Smt. Gomati Devi

... PURCHASERS



12/10/88

Drafted & prepared by
~~SOOY SIK BOOK SOCIETY,~~
RABINDRA NATH MAITY
Advocate,
Sealdah Civil Court,
Calcutta-14.

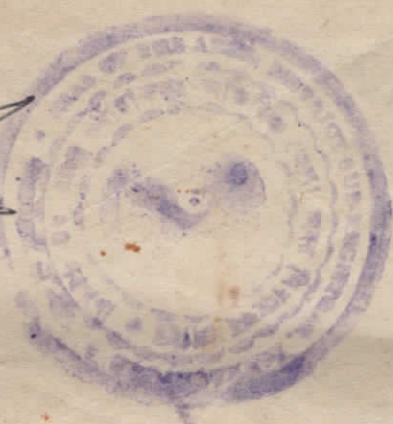

18.10.88

88
2072
114
T
7