

GROUND FLOOR PLAN  
SCALE-1:300

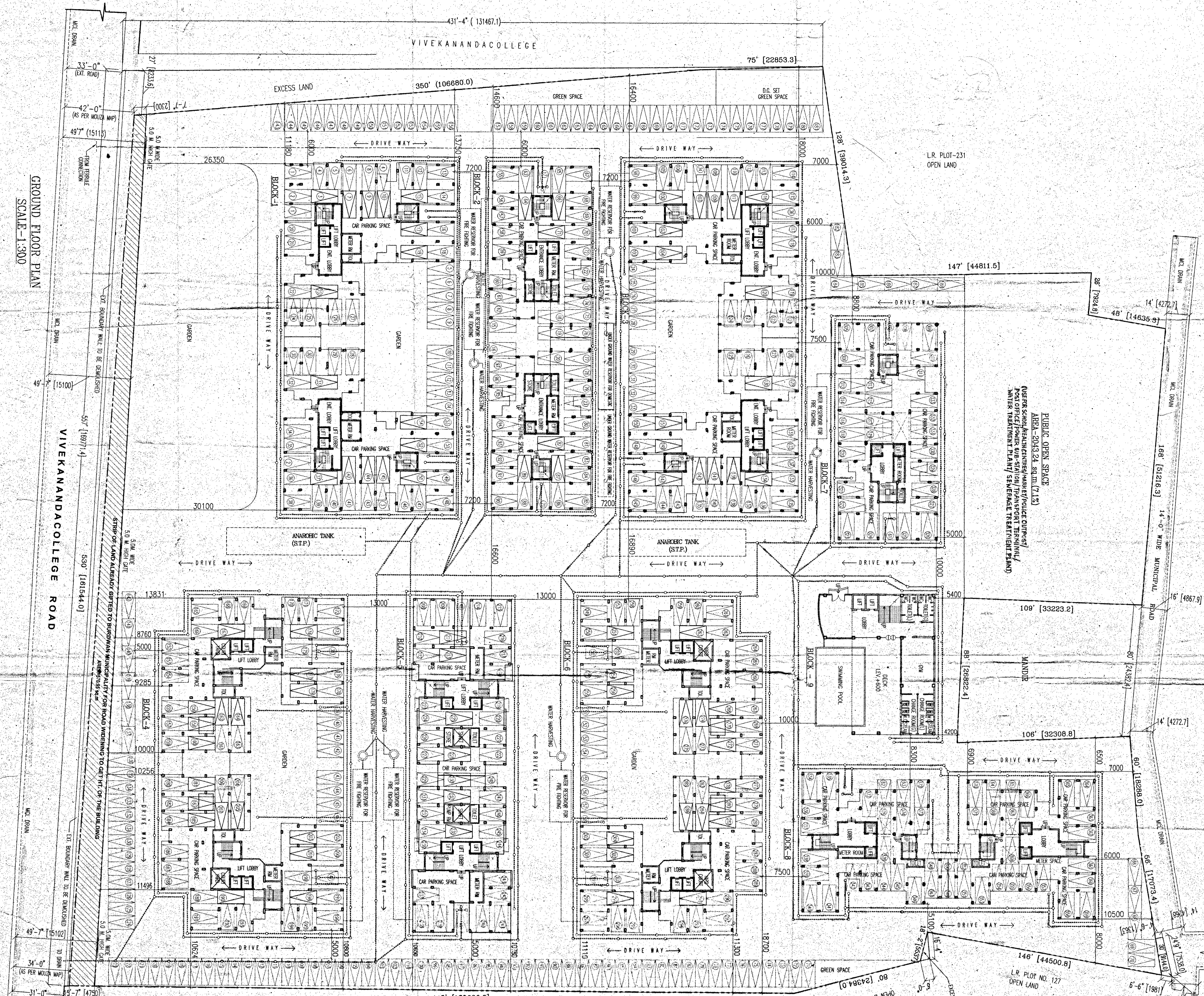

Signature of Member  
CHAIRMAN IN COUNCIL

Signature of Health Officer

Signature of Engineer

CERTIFICATE OF ARCHITECT  
THE L.B.A. HAS CERTIFIED ON THE PLAN ITSELF WITH FULL RESPONSIBILITY THAT THE BUILDING PLAN HAS BEEN DRAWN UP AS PER PROVISION OF W.B.M. BLDG. RULES 2007, AS AMENDED FROM TIME TO TIME AND THAT THE SITE CONDITION INCLUDING THE WIDTH OF THE ADJUTING ROAD CONFORM WITH THE PLAN AND IT IS A BUILDABLE SITE AND NOT A TANK OR A FILLED UP TANK.

CERTIFICATE OF STRUCTURAL ENGINEER  
PERSONALLY AND STRUCTURE OF THE BUILDING HAS BEEN DESIGNED BY ME AS TO BE SAFE IN ALL RESPECT INCLUDING CONSIDERATION OF BEARING CAPACITY AND SETTLEMENT OF SOIL ON THE BASIS OF RECOMMENDATION HAS BEEN OBTAINED FROM THE L.B.A. UP STRICTLY ACCORDING TO THE WEST BENGAL MUNICIPAL BUILDING RULES, 2006.

CERTIFICATE OF GEO-TECHNICAL ENGINEER  
IT IS CERTIFIED THAT THE COMPREHENSIVE GEO-TECHNICAL REPORT ON SOIL INVESTIGATION HAS BEEN PREPARED BY ME FOR DESIGN AND CALCULATION OF THE FOUNDATION BY ANALYZING THE SOIL SAMPLE FOR ESTIMATING OF THE BEARING CAPACITY OF THE SOIL ON WHICH FOUNDATION OF THE STRUCTURE WILL BE CONSTRUCTED. I SHALL ALSO CHECK THE NATURE OF THE SOIL AFTER EXCAVATION AT SITE SO THAT FOUNDATION IS EXTENDED UP TO APPROPRIATE DEPTH THAT HAS BEEN PROPOSED IN THE GEO-TECHNICAL REPORT.

CERTIFICATE OF OWNER  
CERTIFIED THAT I/WE HAVE GONE THROUGH THE WEST BENGAL MUNICIPAL BUILDING RULES 2007 AND UNDERTAKE TO ABIDE BY THOSE RULES DURING AND AFTER THE CONSTRUCTION OF BUILDING AND WE SHALL NOT ON LATER DATE MAKE ANY ADDITION OR ALTERATION TO THIS PLAN.

PROJECT -  
ADDITION & ALTERATION PROPOSED G+1 (25.0 MT. H) STORED RESIDENTIAL OWNERSHIP FLAT BUILDING WITH HIGHRISE PVT. LTD. & ABHILASHA HEIGHTS PVT. LTD. AT MOUZA KHAZANBERH, T.L. NO. 138, 139, 140, 142, 143, 144, 145, 146, 147, 148, 149, 150, R.S. KHAIJAN NO.- 37, 42, 43, 44, 45, 46, 47, 149, L.R. D/G. NO.- 181 & L.R. KHAIJAN NO. 1449, 1450, HOLDING NO. 320, WARD NO. 16, UNDER BURDWAN MUNICIPALITY, P.S. & DIST-BURDWAN.

RAJ AGARWAL & ASSOCIATES  
ARCHITECTS PLANNERS AND INTERIOR DESIGNERS  
6B, 6TH STREET (2ND FLOOR), KOLKATA-16.

RAJ AGARWAL & ASSOCIATES  
ARCHITECTS PLANNERS AND INTERIOR DESIGNERS  
6B, 6TH STREET (2ND FLOOR), KOLKATA-16.

RAJ AGARWAL & ASSOCIATES  
ARCHITECTS PLANNERS AND INTERIOR DESIGNERS  
6B, 6TH STREET (2ND FLOOR), KOLKATA-16.

RAJ AGARWAL & ASSOCIATES  
ARCHITECTS PLANNERS AND INTERIOR DESIGNERS  
6B, 6TH STREET (2ND FLOOR), KOLKATA-16.

RAJ AGARWAL & ASSOCIATES  
ARCHITECTS PLANNERS AND INTERIOR DESIGNERS  
6B, 6TH STREET (2ND FLOOR), KOLKATA-16.