



APPROVED

PLAN No. CB/492/18
RB/CB/18/4/11/11
APN: 1802
2019
Date: 28.08.2019

Structural Safety should be Assured by the Party.

PROVISIONS AS MENTIONED AT THE TOP AND BUILDING RULES REGULATIONS (B.R.) LAWS APPLICABLE.

Commissioner
Durgapur Municipal Corporation

Moham Lal Majhi
Planner in-Charge, Building Plan
Durgapur Municipal Corporation

BUILDING PLAN APPROVED ON THE BASIS OF THE INDENTIFICATION NO. 14333 MUTATION & CONVERSION IS THE RESPONSIBILITY OF THE OWNER.

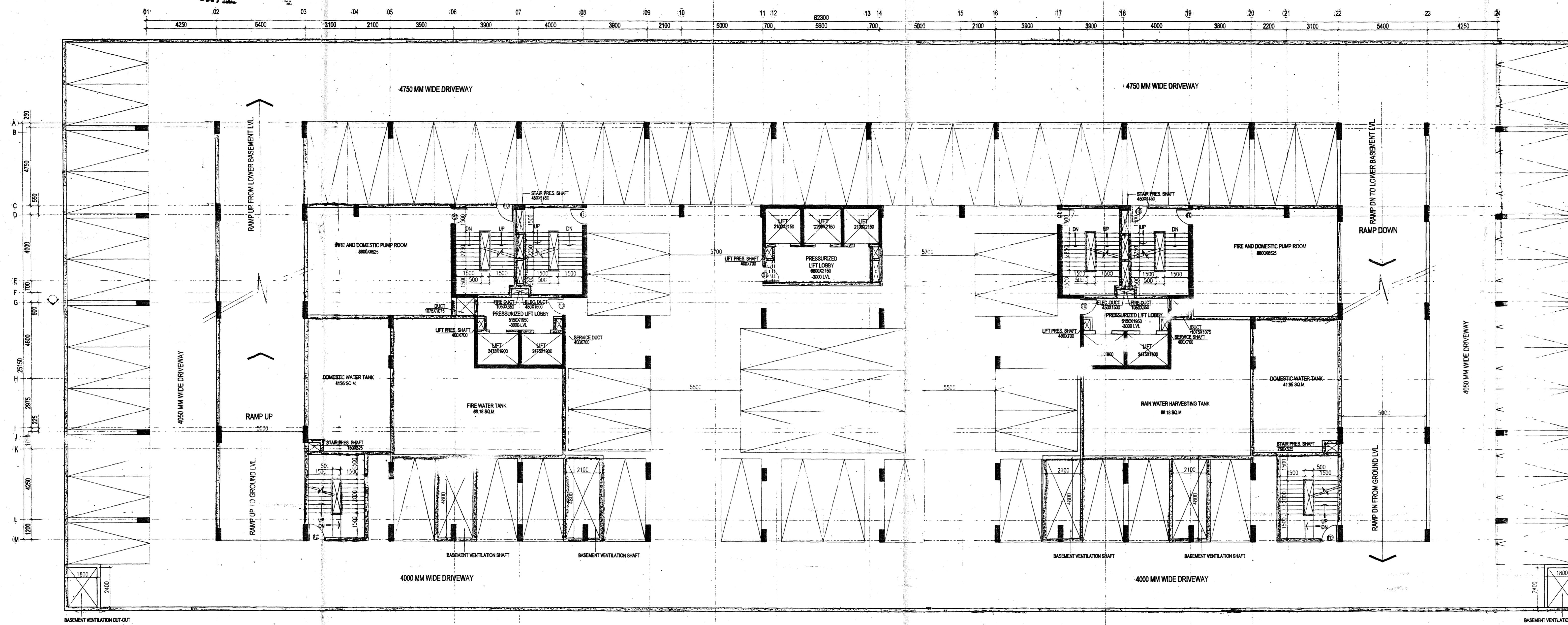

TOTAL FIRE TANK CAPACITY - 2.5 LAKHS LITRES

UPPER BASEMENT PLAN SCALE: 1:100

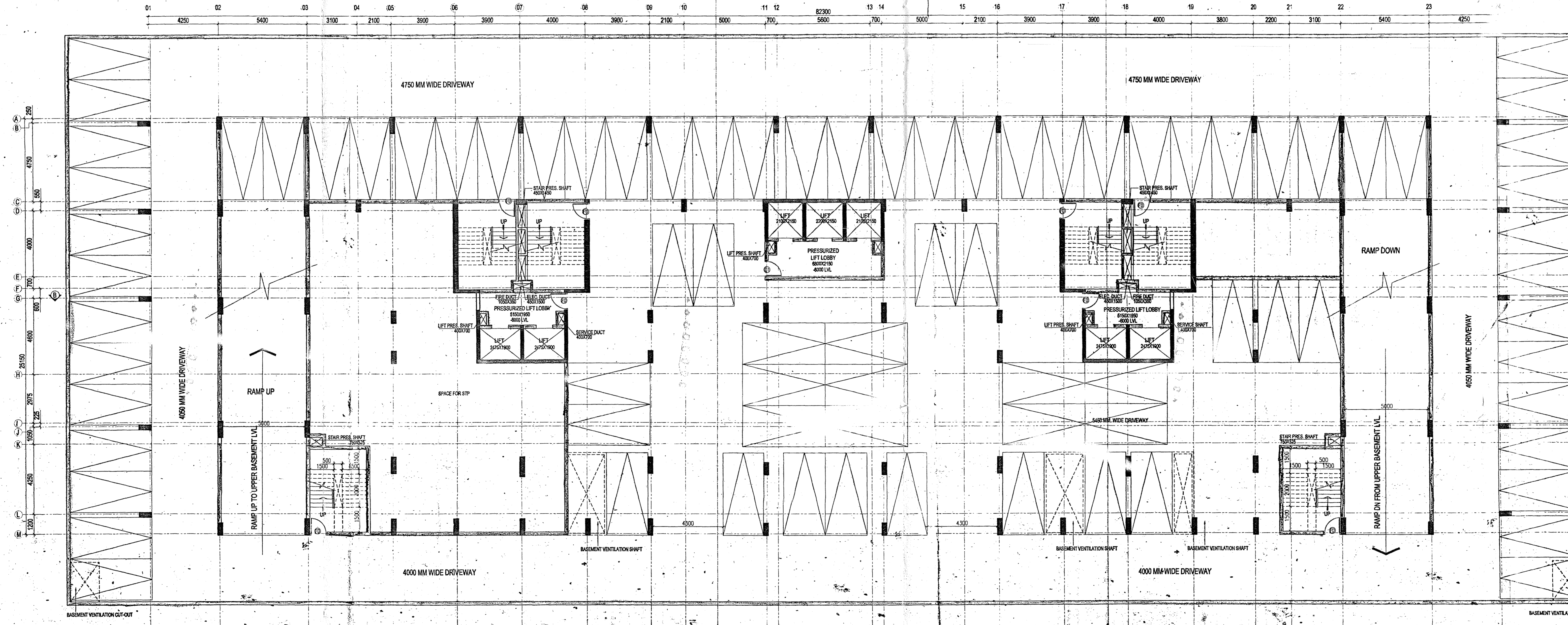

LOWER BASEMENT PLAN SCALE: 1:100

NOTES:
ALL DIMENSIONS ARE IN MILLIMETERS
ALL EXTERIOR WALLS ARE 200 MM THICK
ALL INTERIOR WALLS ARE 100 MM THICK
ALL CEILING ARE TO BE PROTECTED

WINDOW SCHEDULE				
NO.	OPENING SIZE	SILL HT.	INCE. HT.	TYPE
W1	1800X1350	750	2100	SLIDING WINDOW
W2	1500X1350	750	2100	SLIDING WINDOW
W3	900X1200	900	2100	SLIDING WINDOW
W4	600X600	1500	2100	LOUVERED WINDOW
W5	1800X450	1650	2100	SLIDING WINDOW

DOOR SCHEDULE			
NO.	OPENING SIZE	INTEL HT.	TYPE
D1	1050X2100	2100	SINGLE LEAF PANEL DOOR
D12	1075X2100	2100	SINGLE LEAF PANEL DOOR
D2	900X2100	2100	SINGLE LEAF PANEL DOOR
D3	900X2100	2100	SINGLE LEAF PVC DOOR
D4	750X2100	2100	SINGLE LEAF PVC DOOR
D5	1000X2100	2100	SINGLE LEAF PANEL DOOR
D6	1200X2100	2100	DOUBLE LEAF PANEL DOOR
D7	750X2100	2100	SINGLE LEAF PVC DOOR
D8	1200X2100	2100	SINGLE LEAF PANEL DOOR
GD1	800X2100	2100	GLASS DOOR
GD2	1500X2100	2100	GLASS DOOR
FD	1050X2100	2100	GLASS FIRE DOOR
FD1	1050X2100	2100	FIRE DOOR
SD1	2100X2400	2400	ALUMINIUM SLIDING DOOR
SD2	1800X2400	2400	ALUMINIUM SLIDING DOOR

CERTIFICATE BY THE OWNER
CERTIFIED THAT I HAVE GONE THROUGH THE BUILDING RULES FOR DURGAPUR AND ALSO UNDERTAKE TO ABIDE BY THOSE RULES DURING AND AFTER THE CONSTRUCTION OF THE BUILDING.

CERTIFIED THAT I SHALL NOT ON A LATER DATE MAKE ANY ADDITION AND ALTERATION TO THIS PLAN.

SANJIV J. PATIL
SIGNATURE OF OWNER

CERTIFICATE BY STRUCTURAL ENGINEER
CERTIFIED THAT THE STRUCTURAL DRAWING AND DESIGN & DRAWINGS OF BOTH THE FOUNDATION & SUPER STRUCTURE OF THE BUILDING HAVE BEEN MADE BY ME CONSIDERING THE SOIL TEST REPORT AND ALSO CONSIDERING ALL POSSIBLE LOADS, SEISMIC LOAD AND THE MOMENTS GENERATED BY THE PROPOSED STRUCTURES AS PER THE BUREAU OF INDIAN STANDARD AND THE NATIONAL BUILDING CODE OF INDIA & CERTIFIED THAT IT IS SAFE & STABLE IN ALL RESPECT & THESE PROVISIONS SHALL BE ADHERED TO DURING THE CONSTRUCTION.

SANJIV J. PATIL
SIGNATURE OF STRUCTURAL ENGINEER

CERTIFICATE BY GEO TECHNICAL ENGINEER
CERTIFIED THAT THE FOUNDATION AND SUPERSTRUCTURE OF THE BUILDING PROPOSED FOR CONSTRUCTION, HAVE BEEN PERSONALLY INSPECTED AND SOIL CONDITION HAS BEEN CHECKED BY ME THAT WILL MAKE SUCH FOUNDATION AND SUPERSTRUCTURE SAFE IN ALL RESPECT INCLUDING THE CONSIDERATION OF BEARING CAPACITY AND SETTLEMENT OF SOIL AND OTHER CONDITIONS, IF ANY, CONFORMING TO ALL REGULATIONS OF ALL RELEVANT IS CODE OF PRACTICE AND NATIONAL BUILDING CODE.

SANJIV J. PATIL
SIGNATURE OF GEO TECHNICAL ENGINEER

CERTIFICATE BY ARCHITECT
CERTIFIED THAT THE PLAN HAS BEEN DESIGNED AND DRAWN UP STRICTLY ACCORDING TO THE BUILDING RULES OF DURGAPUR. CERTIFIED THAT THE FOUNDATION AND SUPERSTRUCTURE OF THE BUILDING HAS BEEN SO DESIGNED BY ME AS TO BE SAFE IN ALL RESPECT INCLUDING THE CONSIDERATION OF SAFE BEARING CAPACITY AND SETTLEMENT OF SOIL.

SANJIV J. PATIL
SIGNATURE OF ARCHITECT

PROJECT:
PROPOSED B1+B2+G+16 STORED RESIDENTIAL CUM PARTLY COMMERCIAL BUILDING OF 'DUTTA AUTOMOBILES' AT MOUZA - FARIDPUR, J.L. NO. - 74, P.S. - DURGAPUR, DIST - PASCHIM BARDHAMAN, LAYOUT PLAN NO. - C2/1 & C2/1A, C.S. PLOT NO. - 856(P), 854(P), 3030(P), KHATIAN NO. - 1382, SUB REG. OFFICER, CITY CENTRE, DURGAPUR - 16
HOLDING NO. 334/N, ASSESSMENT NO. 3300401403945
WARD NO. 32, STREET RD. NO. PALASDIHA, DURGAPUR 08

CONTENT:
UPPER BASEMENT & LOWER BASEMENT PLAN.

CLIENT:
DUTTA AUTOMOBILES,
NACHAN ROAD, DURGAPUR

Architects:
SBA SPECTRA CONSULTANTS
Architects Planners, Engineers, Valuers.
DA - 170, Salt Lake, Kolkata - 700 064.

SCALE	AS SHOWN	REVISION	NO.
DATE	02.03.2019	DRG. NO.	
DEALT			
CHKD.		DBD/ARCH-02	

