

NAME OF THE LAND OWNER:-

- 1) ALPANANA ASHISH JASWAL
W/O. LT. ASHISH JASWAL.
- 2) ASHA PRASAD
W/O. LT. ARVIND KUMAR PRASAD.
- 3) ALKA JASWAL.
W/O. ABHAY JASWAL.
- 4) i) KUSHAGRA SAHU S/O. RAJESH SAHU
ii) HANSIKA SAHU. S/O. RAJESH SAHU
ALL OF SEVOKE ROAD SILIGURI.
P.S. BHAKTINAGAR. DIST. JALPAIGURI

LATITUDE OF THE PROPOSED SITE :-26° - 43' - 36.97"

LONGITUDE OF THE PROPOSED SITE :-88° - 26' - 10.85"

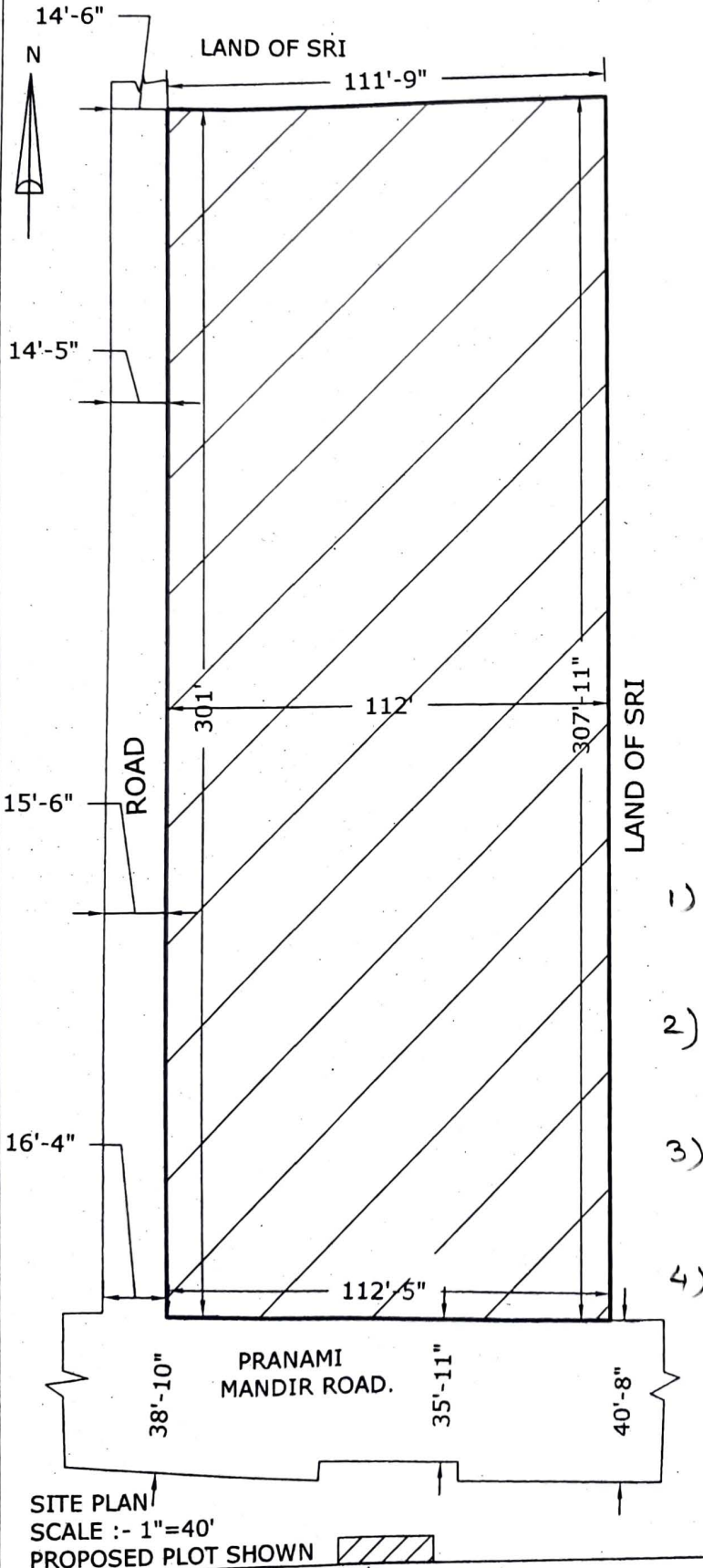

LAND SCHEDULE :-

MOUZA :-DABGRAM,
J.L.NO. :-2
SHEET NO. :- R.S.AS PER PARTITION DEED - 7
PHYSICALLY- 8,
L.R. RECORD - 39
PHYSICALLY - 38,
KHATIAN NO.:- R.S.321 /1
L.R. 108,109,110,111 & 112
PLOT NO. :- R.S. 429(P) PHYSICALLY -429(P)
AS PER LR. KH.- 86
PHYSICALLY - 33
POLICE STN. :-BHAKTINAGAR,
DISTRICT. :-JALPAIGURI.

LAND AREA AS PER DEED :- 48.000 KATHA
AS PER L.R. KHATIAN :- 47.916 KATHA
PHYSICALLY :- 47.357 KATHA

- 1)
- 2)
- 3)
- 4)

M. Acharya
(SURVEYOR)
Regd. No. 3895/75

SURVEYED & DRAWN BY:-
M.ACHARYA.
CIVIL CONSULTANT.
SUBHASHPALLY, SILIGURI

SITE PLAN
SCALE :- 1"=40'
PROPOSED PLOT SHOWN