

SCHEDULE OF COLUMNS FOR BLOCK 1 & 3									
COLUMN MARKED	NOS. OF COLUMN SIZE COLUMNS (mm x mm)	FOUNDATION TO 2ND FLOOR	2ND FLOOR TO 3RD FLOOR	3RD FLOOR TO 4TH FLOOR	4TH FLOOR TO 5TH FLOOR	5TH FLOOR TO ROOF	NEAR JUNCTION (Ø)	STRIP ARRANGEMENT & SPACING REST PORTION	
C1	01 300X700	300X700 MAIN RNF: -14.25	300X700 MAIN RNF: -14.25	300X700 MAIN RNF: -14.25	300X700 MAIN RNF: -14.25	300X700 MAIN RNF: -14.25	Ø 8@75 C/C (2 NOS. CLOSED LINK & 1 NO. OPEN LINK PER SET)	Ø 8@75 C/C (2 NOS. CLOSED LINK & 1 NO. OPEN LINK PER SET)	
C2, C3, C47	05 300X600	300X600 MAIN RNF: -16.25	300X600 MAIN RNF: -16.25	300X600 MAIN RNF: -16.25	300X600 MAIN RNF: -16.25	300X600 MAIN RNF: -16.25	Ø 8@75 C/C (2 NOS. CLOSED LINK & 1 NO. OPEN LINK PER SET)	Ø 8@75 C/C (2 NOS. CLOSED LINK & 1 NO. OPEN LINK PER SET)	
C4, C30, C37, C48, C49, C50, C51	07 300X700	300X700 MAIN RNF: -14.25	300X700 MAIN RNF: -14.25	300X700 MAIN RNF: -14.25	300X700 MAIN RNF: -14.25	300X700 MAIN RNF: -14.25	Ø 8@75 C/C (2 NOS. CLOSED LINK & 1 NO. OPEN LINK PER SET)	Ø 8@75 C/C (2 NOS. CLOSED LINK & 1 NO. OPEN LINK PER SET)	
C5, C8, C17, C18, C24, C25, C28, C29	08 300X600	300X600 MAIN RNF: -16.25	300X600 MAIN RNF: -16.25	300X600 MAIN RNF: -16.25	300X600 MAIN RNF: -16.25	300X600 MAIN RNF: -16.25	Ø 8@75 C/C (2 NOS. CLOSED LINK & 1 NO. OPEN LINK PER SET)	Ø 8@75 C/C (2 NOS. CLOSED LINK & 1 NO. OPEN LINK PER SET)	
C6, C10, C13, C14, C15, C34, C35, C36, C41, C42, C43, C44, C45, C46	16 300X700	300X700 MAIN RNF: -14.25	300X700 MAIN RNF: -14.25	300X700 MAIN RNF: -14.25	300X700 MAIN RNF: -14.25	300X700 MAIN RNF: -14.25	Ø 8@75 C/C (2 NOS. CLOSED LINK & 1 NO. OPEN LINK PER SET)	Ø 8@75 C/C (2 NOS. CLOSED LINK & 1 NO. OPEN LINK PER SET)	
C7, C11, C12, C19, C31	05 300X700	300X700 MAIN RNF: -14.25	300X700 MAIN RNF: -14.25	300X700 MAIN RNF: -14.25	300X700 MAIN RNF: -14.25	300X700 MAIN RNF: -14.25	Ø 8@75 C/C (2 NOS. CLOSED LINK & 1 NO. OPEN LINK PER SET)	Ø 8@75 C/C (2 NOS. CLOSED LINK & 1 NO. OPEN LINK PER SET)	
C22, C23, C33, C38	04 300X700	300X700 MAIN RNF: -14.25	300X700 MAIN RNF: -14.25	300X700 MAIN RNF: -14.25	300X700 MAIN RNF: -14.25	300X700 MAIN RNF: -14.25	Ø 8@75 C/C (2 NOS. CLOSED LINK & 1 NO. OPEN LINK PER SET)	Ø 8@75 C/C (2 NOS. CLOSED LINK & 1 NO. OPEN LINK PER SET)	
C9, C20, C21, C27, C32, C35	06 300X750	300X750 MAIN RNF: -16.25	300X750 MAIN RNF: -16.25	300X750 MAIN RNF: -16.25	300X750 MAIN RNF: -16.25	300X750 MAIN RNF: -16.25	Ø 8@75 C/C (2 NOS. CLOSED LINK & 1 NO. OPEN LINK PER SET)	Ø 8@75 C/C (2 NOS. CLOSED LINK & 1 NO. OPEN LINK PER SET)	
C26	01 350X850	350X850 MAIN RNF: -16.25	350X850 MAIN RNF: -16.25	350X850 MAIN RNF: -16.25	350X850 MAIN RNF: -16.25	350X850 MAIN RNF: -16.25	Ø 8@75 C/C (2 NOS. CLOSED LINK & 1 NO. OPEN LINK PER SET)	Ø 8@75 C/C (2 NOS. CLOSED LINK & 1 NO. OPEN LINK PER SET)	
STOOL COLUMNS									
ROOF TO L.W.R. ROOF									
ST1, ST3	02 250X250	250X250 MAIN RNF: -16.25	250X250 MAIN RNF: -16.25	250X250 MAIN RNF: -16.25	250X250 MAIN RNF: -16.25	250X250 MAIN RNF: -16.25	Ø 8@75 C/C (2 NOS. CLOSED LINK PER SET)	Ø 8@75 C/C (2 NOS. CLOSED LINK PER SET)	
ROOF TO WATER TANK ROOF									
ST2, ST4	02 250X250	250X250 MAIN RNF: -16.25	250X250 MAIN RNF: -16.25	250X250 MAIN RNF: -16.25	250X250 MAIN RNF: -16.25	250X250 MAIN RNF: -16.25	Ø 8@75 C/C (2 NOS. CLOSED LINK PER SET)	Ø 8@75 C/C (2 NOS. CLOSED LINK PER SET)	

SCHEDULE OF COLUMNS FOR BLOCK 2									
COLUMN MARKED	NOS. OF COLUMN SIZE COLUMNS (mm x mm)	FOUNDATION TO 2ND FLOOR	2ND FLOOR TO 3RD FLOOR	3RD FLOOR TO 4TH FLOOR	4TH FLOOR TO 5TH FLOOR	5TH FLOOR TO ROOF	NEAR JUNCTION (Ø)	STRIP ARRANGEMENT & SPACING REST PORTION	
C52, C53, C56, C72, C77, C78, C86, C87, C88, C91, C93, C92	17 300X500	300X500 MAIN RNF: -14.25	300X500 MAIN RNF: -14.25	300X500 MAIN RNF: -14.25	300X500 MAIN RNF: -14.25	300X500 MAIN RNF: -14.25	Ø 8@75 C/C (2 NOS. CLOSED LINK & 2 NOS. OPEN LINK PER SET)	Ø 8@75 C/C (2 NOS. CLOSED LINK & 2 NOS. OPEN LINK PER SET)	
C54, C55, C58, C60, C67	05 300X500	300X500 MAIN RNF: -14.25	300X500 MAIN RNF: -14.25	300X500 MAIN RNF: -14.25	300X500 MAIN RNF: -14.25	300X500 MAIN RNF: -14.25	Ø 8@75 C/C (2 NOS. CLOSED LINK & 2 NOS. OPEN LINK PER SET)	Ø 8@75 C/C (2 NOS. CLOSED LINK & 2 NOS. OPEN LINK PER SET)	
C59, C70, C89, C90, C94	05 300X500	300X500 MAIN RNF: -14.25	300X500 MAIN RNF: -14.25	300X500 MAIN RNF: -14.25	300X500 MAIN RNF: -14.25	300X500 MAIN RNF: -14.25	Ø 8@75 C/C (2 NOS. CLOSED LINK & 2 NOS. OPEN LINK PER SET)	Ø 8@75 C/C (2 NOS. CLOSED LINK & 2 NOS. OPEN LINK PER SET)	
C73, C81	02 300X650	300X650 MAIN RNF: -14.25	300X650 MAIN RNF: -14.25	300X650 MAIN RNF: -14.25	300X650 MAIN RNF: -14.25	300X650 MAIN RNF: -14.25	Ø 8@75 C/C (2 NOS. CLOSED LINK & 2 NOS. OPEN LINK PER SET)	Ø 8@75 C/C (2 NOS. CLOSED LINK & 2 NOS. OPEN LINK PER SET)	
C88, C80	02 300X650	300X650 MAIN RNF: -14.25	300X650 MAIN RNF: -14.25	300X650 MAIN RNF: -14.25	300X650 MAIN RNF: -14.25	300X650 MAIN RNF: -14.25	Ø 8@75 C/C (2 NOS. CLOSED LINK & 2 NOS. OPEN LINK PER SET)	Ø 8@75 C/C (2 NOS. CLOSED LINK & 2 NOS. OPEN LINK PER SET)	
C89, C74	02 300X650	300X650 MAIN RNF: -14.25	300X650 MAIN RNF: -14.25	300X650 MAIN RNF: -14.25	300X650 MAIN RNF: -14.25	300X650 MAIN RNF: -14.25	Ø 8@75 C/C (2 NOS. CLOSED LINK & 2 NOS. OPEN LINK PER SET)	Ø 8@75 C/C (2 NOS. CLOSED LINK & 2 NOS. OPEN LINK PER SET)	
C75, C76	02 300X650	300X650 MAIN RNF: -14.25	300X650 MAIN RNF: -14.25	300X650 MAIN RNF: -14.25	300X650 MAIN RNF: -14.25	300X650 MAIN RNF: -14.25	Ø 8@75 C/C (2 NOS. CLOSED LINK & 2 NOS. OPEN LINK PER SET)	Ø 8@75 C/C (2 NOS. CLOSED LINK & 2 NOS. OPEN LINK PER SET)	
C65, C79, C84	03 300X650	300X650 MAIN RNF: -14.25	300X650 MAIN RNF: -14.25	300X650 MAIN RNF: -14.25	300X650 MAIN RNF: -14.25	300X650 MAIN RNF: -14.25	Ø 8@75 C/C (2 NOS. CLOSED LINK & 2 NOS. OPEN LINK PER SET)	Ø 8@75 C/C (2 NOS. CLOSED LINK & 2 NOS. OPEN LINK PER SET)	
C86, C85	02 375X800	375X800 MAIN RNF: -14.25	375X800 MAIN RNF: -14.25	375X800 MAIN RNF: -14.25	375X800 MAIN RNF: -14.25	375X800 MAIN RNF: -14.25	Ø 8@75 C/C (2 NOS. CLOSED LINK & 2 NOS. OPEN LINK PER SET)	Ø 8@75 C/C (2 NOS. CLOSED LINK & 2 NOS. OPEN LINK PER SET)	
C79, C82, C83, C95, C96, C97	06 300X500	300X500 MAIN RNF: -14.25	300X500 MAIN RNF: -14.25	300X500 MAIN RNF: -14.25	300X500 MAIN RNF: -14.25	300X500 MAIN RNF: -14.25	Ø 8@75 C/C (2 NOS. CLOSED LINK & 2 NOS. OPEN LINK PER SET)	Ø 8@75 C/C (2 NOS. CLOSED LINK & 2 NOS. OPEN LINK PER SET)	
STOOL COLUMNS									
ROOF TO L.W.R. ROOF									
ST1, ST2, ST3, ST4									

SCHEDULE OF COLUMNS FOR POOLUM PORTION									
COLUMN MARKED	NOS. OF COLUMN SIZE COLUMNS (mm x mm)	FOUNDATION TO DP	NEAR JUNCTION (Ø)	STRIP ARRANGEMENT & SPACING REST PORTION					
PC1, PC3, PC16, PC18	04 300X500	300X500 MAIN RNF: -4.25	Ø 8@75 C/C (2 NOS. CLOSED LINK & 2 NOS. OPEN LINK PER SET)	Ø 8@75 C/C (2 NOS. CLOSED LINK & 2 NOS. OPEN LINK PER SET)					
PC2, PC17	02 300X500	300X500 MAIN RNF: -4.25	Ø 8@75 C/C (2 NOS. CLOSED LINK & 2 NOS. OPEN LINK PER SET)	Ø 8@75 C/C (2 NOS. CLOSED LINK & 2 NOS. OPEN LINK PER SET)					
PC4, PC7, PC10, PC12, PC13	05 300X500	300X500 MAIN RNF: -14.25	Ø 8@75 C/C (2 NOS. CLOSED LINK & 2 NOS. OPEN LINK PER SET)	Ø 8@75 C/C (2 NOS. CLOSED LINK & 2 NOS. OPEN LINK PER SET)					
PC5, PC6, PC8, PC9, PC14	05 300X650	300X650 MAIN RNF: -14.25	Ø 8@75 C/C (2 NOS. CLOSED LINK & 2 NOS. OPEN LINK PER SET)	Ø 8@75 C/C (2 NOS. CLOSED LINK & 2 NOS. OPEN LINK PER SET)					
PC15	01 300X500	300X500 MAIN RNF: -14.25	Ø 8@75 C/C (2 NOS. CLOSED LINK & 2 NOS. OPEN LINK PER SET)	Ø 8@75 C/C (2 NOS. CLOSED LINK & 2 NOS. OPEN LINK PER SET)					
PC11	01 300X700	300X700 MAIN RNF: -14.25	Ø 8@75 C/C (2 NOS. CLOSED LINK & 2 NOS. OPEN LINK PER SET)	Ø 8@75 C/C (2 NOS. CLOSED LINK & 2 NOS. OPEN LINK PER SET)					
EQ. COLUMN									
ROOF TO TOP									
PST1, PST2, PST3, PST4, PST5, PST6	06 300X300	300X300 MAIN RNF: -8.25	Ø 8@75 C/C (2 NOS. CLOSED LINK PER SET)	Ø 8@75 C/C (2 NOS. CLOSED LINK PER SET)					

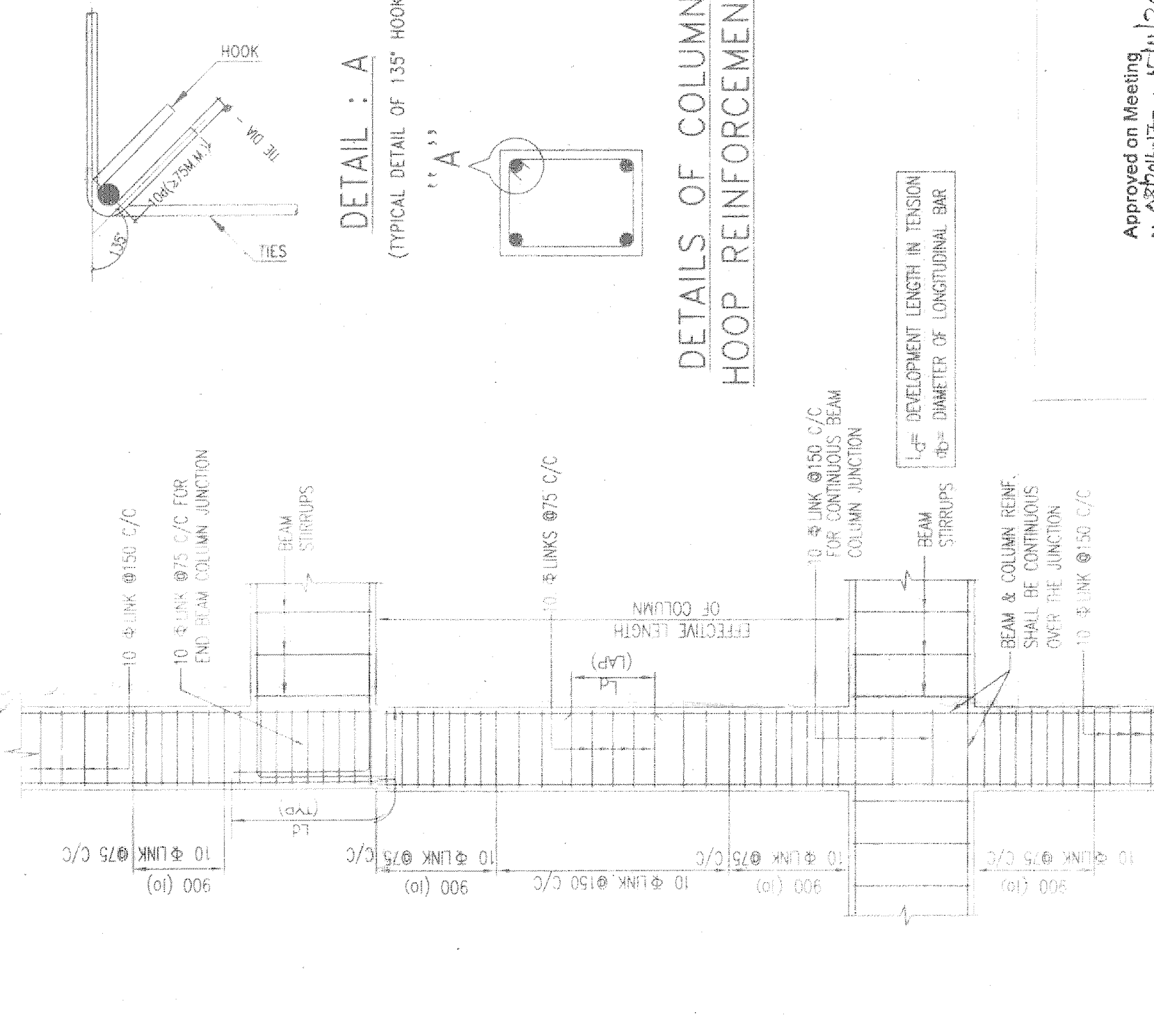

CERTIFICATE OF STRUCTURAL ENGINEER

I hereby certify that the structural design drawings of both foundation & superstructure of the building shown above are in accordance with the provisions of the Indian Standards Code of Practice for Reinforced Concrete Structures (IS:456-2000) and the Indian Standard Code of Practice for Earthquake Resistant Design and Construction of Buildings (IS:1893-2001).

Signature of Structural Engineer: M.D. ...

Signature of Architect: ...

PROPOSED PLAN OF G-VII STORED RESIDENTIAL COMPLEX AT MOZAR ROAD, ...

ENGINEER'S FORUM

AGRIWAL & ASSOCIATES

PROJ. NO. ...

DATE: ...

SCALE: ...

PREPARED BY: ...

CHECKED BY: ...

APPROVED BY: ...

NOTES:

1. ALL DIMENSIONS ARE IN MILLIMETERS UNLESS OTHERWISE SPECIFIED.
2. ALL DIMENSIONS ARE IN MILLIMETERS UNLESS OTHERWISE SPECIFIED.
3. ALL DIMENSIONS ARE IN MILLIMETERS UNLESS OTHERWISE SPECIFIED.
4. ALL DIMENSIONS ARE IN MILLIMETERS UNLESS OTHERWISE SPECIFIED.
5. ALL DIMENSIONS ARE IN MILLIMETERS UNLESS OTHERWISE SPECIFIED.
6. ALL DIMENSIONS ARE IN MILLIMETERS UNLESS OTHERWISE SPECIFIED.
7. ALL DIMENSIONS ARE IN MILLIMETERS UNLESS OTHERWISE SPECIFIED.
8. ALL DIMENSIONS ARE IN MILLIMETERS UNLESS OTHERWISE SPECIFIED.
9. ALL DIMENSIONS ARE IN MILLIMETERS UNLESS OTHERWISE SPECIFIED.
10. ALL DIMENSIONS ARE IN MILLIMETERS UNLESS OTHERWISE SPECIFIED.

REVISIONS:

NO. 1: ...

NO. 2: ...

NO. 3: ...

NO. 4: ...

NO. 5: ...

SPECIAL NOTES

THE MAXIMUM HEIGHT OF SOIL TAIL IN THE FOUNDATION SHALL BE 1.2 M.

THE FOUNDATION SHALL BE PROVIDED WITH ANCHORAGE BARS AS PER IS:456-2000.

THE FOUNDATION SHALL BE PROVIDED WITH ANCHORAGE BARS AS PER IS:456-2000.

THE FOUNDATION SHALL BE PROVIDED WITH ANCHORAGE BARS AS PER IS:456-2000.

THE FOUNDATION SHALL BE PROVIDED WITH ANCHORAGE BARS AS PER IS:456-2000.