



DECLARATION OF OWNER  
I HEREBY CERTIFY THAT I HAVE GONE THROUGH THE BUILDING BY LAINE FOR BEST BEING...  
I HEREBY CERTIFY THAT I SHALL NOT AT A LATER DATE MAKE ANY ALTERATION OR ADDITION TO THIS PLAN WITHOUT CONSTRUCTION I SHALL BE FULLY RESPONSIBLE FOR ANY VIOLATION OF THE BUILDING RULES AS WELL AS THE SANCTIONED BUILDING PLAN.

BELMONT ENCLAVE LLP  
Designated Partner

SIGNATURE OF ARCHITECT  
T. N. K. P. BERA  
TAPAS KUMAR BERA  
Licentiate in Architecture  
Hoovers, 222A Parikh Road  
Class - 1, Reg. No. - 55

SIGNATURE OF ARCHITECT  
Rajkumar Agarwal  
Licentiate in Architecture  
Member of Council of Architecture CA / 54 / 17540

SIGNATURE OF THE ARCHITECT  
Rajkumar Agarwal  
Licentiate in Architecture  
Member of Council of Architecture CA / 54 / 17540  
ADDRESS:  
RAJ AGARWAL & ASSOCIATES  
80, ROYD STREET (2ND FLOOR), KOLKATA-16.

CERTIFICATE OF STRUCTURAL ENGINEER  
I HEREBY CERTIFY THAT THE STRUCTURAL DRAWING AND DESIGN OF THE FOUNDATION AND SUPERSTRUCTURE OF THE BUILDING...  
I HAVE ALSO CHECKED THE DESIGN OF THE SOIL AFTER EXAMINATION AT SITE SO THAT FOUNDATION IS ENFORCED UPON THE APPROPRIATE REPORT THAT HAS BEEN PROVIDED IN THE GEO-TECHNICAL REPORT.

SIGNATURE OF THE STRUCTURAL ENGINEER  
SANJIV J. PAREKH  
M.E. CIVIL (ENGRG.) M.S.C.E.  
REGISTERED MEMBER AM-23522 (EST-1987) M.C.E.  
ADDRESS:  
S.P.A. CONSULTANTS  
53, JUSTICE CHANDRA MADHAR ROAD, KOLKATA-20

CERTIFICATE OF GEO-TECHNICAL ENGINEER  
I HEREBY CERTIFY THAT THE COMPREHENSIVE GEO-TECHNICAL REPORT ON SOIL INVESTIGATION HAS BEEN PREPARED BY ME FOR DESIGN AND CALCULATION OF THE FOUNDATION BY ANALYSING THE SOIL SAMPLES FOR ESTIMATING THE BEARING CAPACITY OF THE SOIL...  
I HAVE ALSO CHECKED THE DESIGN OF THE SOIL AFTER EXAMINATION AT SITE SO THAT FOUNDATION IS ENFORCED UPON THE APPROPRIATE REPORT THAT HAS BEEN PROVIDED IN THE GEO-TECHNICAL REPORT.

SIGNATURE OF THE GEO-TECHNICAL ENGINEER  
B. K. SINGH  
M.E. CIVIL (ENGRG.) M.S.C.E. (DIPLOMA)  
REGISTERED MEMBER AM-23522 (EST-1987) M.C.E.  
ADDRESS:  
S.P.A. CONSULTANTS  
53, JUSTICE CHANDRA MADHAR ROAD, KOLKATA-20

AREA STATEMENT	
LAND AREA (AS PERMITTED)	7811.971 SQ.M. ( 188.33 ACRES )
LAND AREA (AS CONCESSION)	7811.971 SQ.M. ( 188.33 ACRES )
ROAD WIDTH	8.85 M.
PENETRABLE ROAD	412.150 SQ.M.
PENETRABLE TOTAL FLOOR AREA	22767.700 SQ.M.
PROPOSED GROUND COVER (80%)	18214.160 SQ.M.
PROPOSED TOTAL FLOOR AREA	18214.160 SQ.M.

TYPE	NUMBER	AREA (SQ.M.)
3	156	156.00
4	156	156.00
5	156	156.00

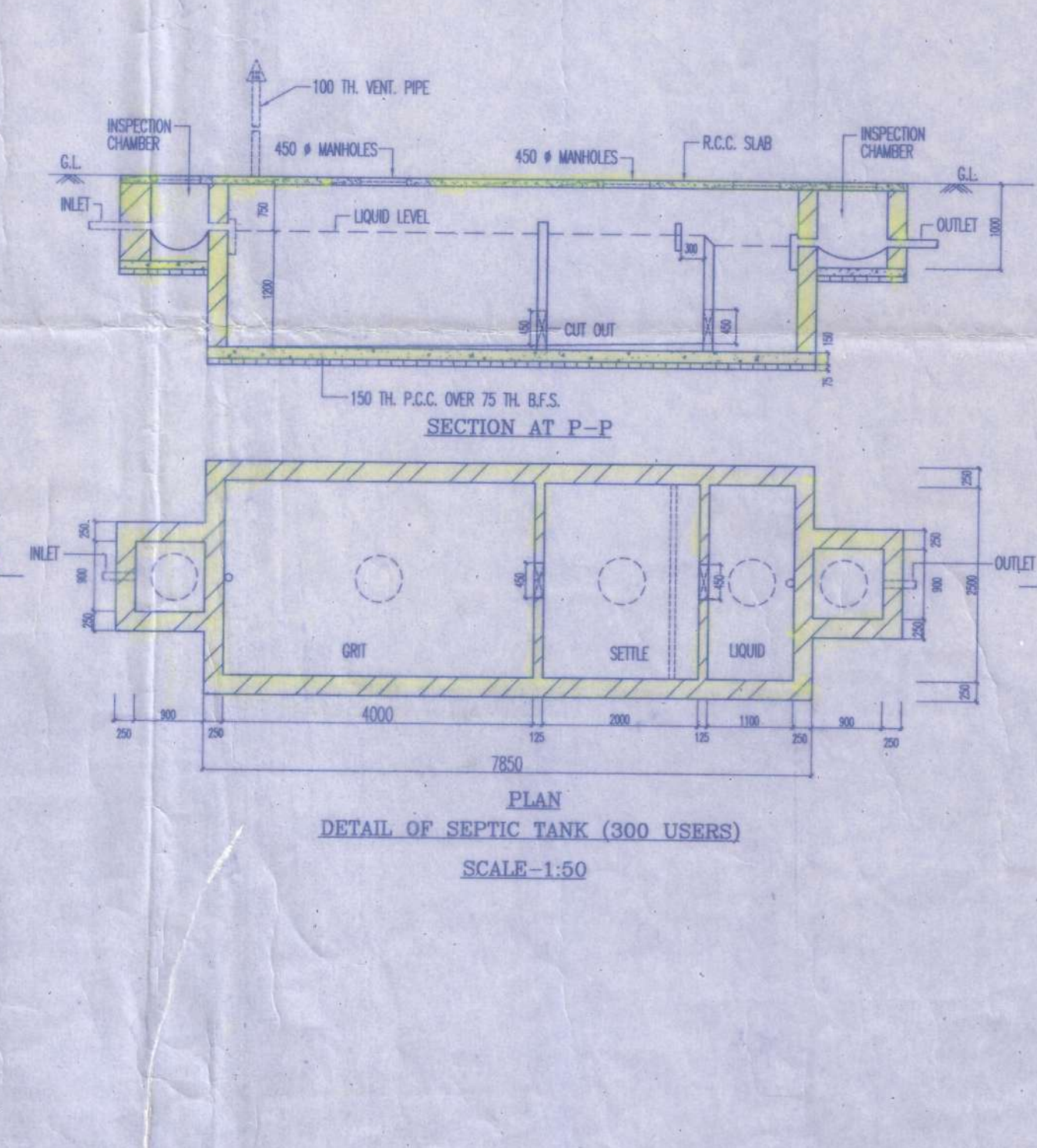
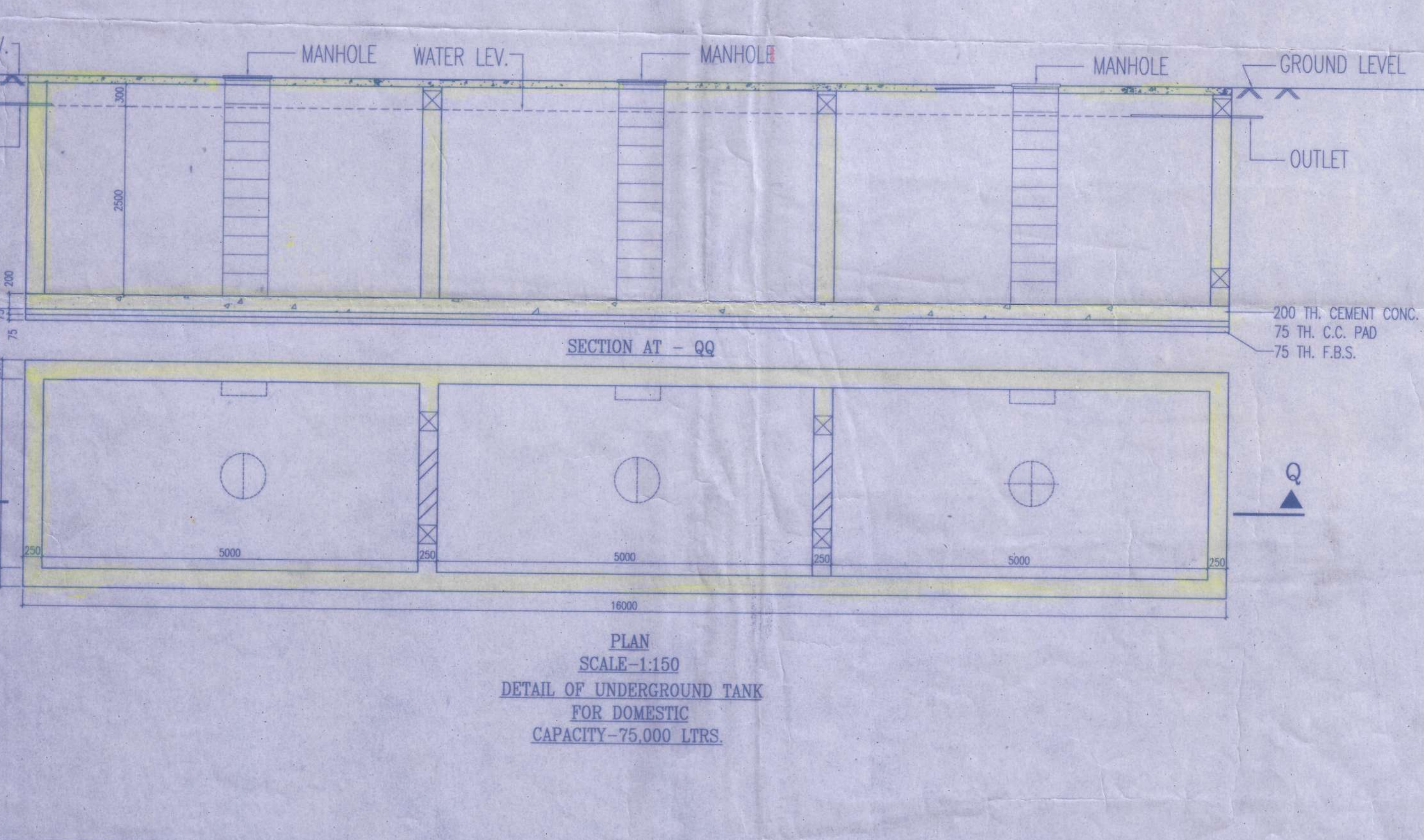

GENERAL NOTES  
1. ALL DIMENSIONS ARE IN METERS.  
2. ALL EXISTING UTILITIES AND MANHOLE SHALL BE TO BE PRESERVED.  
3. ALL WORKING HOURS ARE BOUND BY CONSTRUCTION (14) & ADDITIONAL PROVISIONS IS 2574 & INTERNATIONAL PLASTERING TANKS, DIMENSIONS IN METERS.

SCHEDULE OF DOORS & WINDOWS

TYPE	NUMBER	AREA (SQ.M.)
1	156	156.00
2	156	156.00
3	156	156.00

TITLE  
GROUND FLOOR PLAN, DETAIL OF U.G.R. DETAIL OF SEPTIC TANK, SITE PLAN, LOCATION PLAN.

PROJECT  
PROPOSED ADDITION & ALTERATION OF BLOCK-1 & BLOCK-2 SANCTIONED G + IV HOUSING COMPLEX AT P.S. DAG NO- 46, 47, 48 J.L. NO.-15, L.R. DAG NO.- 47, 48, 49 L.R. KHATIAN NO.-7932, NEW KHATIAN NO.-8259, 8260, 8261, 8262, 8294, 8298, 8299, 8298, 8291, 8292, 8298, 8297, 8287, MOZA-DASHIN HANGORAH, POLICE STATION-DOMAIR, DIST.-HOWRAH.

DATE: 20/05/2019  
JOB NO.: 2019/197  
SCALE: 1/50  
DRAWN BY: S.A. AGARWAL  
CHECKED BY: S.A. AGARWAL