

PROPOSED G+4 STORED RESIDENTIAL BLOCK AT BOOTH NO.-62, 63, R.S. DAG NO. - 1358(P), 858(P), 748(P), 854(P), 860(P), 1361(P), 1360(P), 878(P), 832(P), 878(P), MOUZA- SATULLI, J.L. NO.-48, L.R. KHATIAN NO.-2129, 2166, 2175, 2191, 2181, 2172, PS kashipur(formerly Bhangar), PO Pithapur UNDER "BHAGWANPUR GRAM PANCHAYAT" DIST-24 PARAGANAS(S).

I CERTIFY THAT ALL THE ARCHITECTURAL DRAWINGS OF PROPOSED G+4 STORED RESIDENTIAL BLOCK AT BOOTH NO.-62, 63, R.S. DAG NO. - 1358(P), 858(P), 748(P), 854(P), 860(P), 1361(P), 1360(P), 878(P), 832(P), 878(P), MOUZA- SATULLI, J.L. NO.-48, L.R. KHATIAN NO.-2129, 2166, 2175, 2191, 2181, 2172, PS kashipur(formerly Bhangar), PO Pithapur UNDER "BHAGWANPUR GRAM PANCHAYAT" DIST-24 PARAGANAS(S) HAVE BEEN PREPARED BY ME COMPLYING WITH THE PROVISIONS OF THE NATIONAL BUILDING CODE PART-III-2005 AND THE WEST BENGAL MUNICIPAL BUILDING RULES, NO SUCH WRONG AND INCORRECT INFORMATION HAS BEEN FURNISHED BY ME INCLUDING AREA CALCULATION CHARTS IN THIS DRAWINGS AND NO VIOLATION OF THE PROVISIONS OF THESE RULES WILL BE FOUND IN ANY OF THE DRAWINGS AND DOCUMENTS, SUBMITTED TO THE SANCTIONING AUTHORITY FOR OBTAINING SANCTIONS.

**AMITAV BISWAS**  
Chartered Architect  
CA/2010/47702

Signature of Architect  
**PRAKALPA**  
16, NEW COLONY CHANDRABAGICHA, HOWRAH & 2nd FLOOR, SOUASTRA-751014  
TEL: 9334877777  
WEB SITE: www.praakalpa.com  
EMAIL: www.praakalpa.com

I CERTIFY THAT THE STRUCTURAL DRAWING AND DESIGN OF BOTH THE FOUNDATION AND SUPERSTRUCTURE OF THE BUILDING, BUILDINGS HAS BEEN MADE CONSIDERING THE SOIL TEST REPORT AS PER THESE SCALE AND REGULATIONS MADE UNDER THE ACT AND ALSO CONSIDERING ALL POSSIBLE LOADS, VIBRATION AND THE MOMENTS GENERATED BY THE PROPOSED STRUCTURE AS PER CURRENT CODES. THE BUREAU OF INDIAN STANDARDS NATIONAL BUILDING CODE OF PRACTICE AND PART III OF IS 4762 IS SAFE AND APPLICABLE IN ALL RESPECT UP TO G+4 STOREY STORES AND THESE PROVISIONS SHALL BE ADHERED TO DURING THE CONSTRUCTION.

**Mrs. MITA SAHA**  
M.T.E., M.E., STRUCT. C.E.  
16/10/1, SOUASTRA, SOUASTRA  
Howrah-751014

Signature of the Structural Engineer  
**MAK ENGINEERS**  
16/10/1, SOUASTRA, SOUASTRA  
Howrah-751014  
E-mail: www.makengineers.com

IT IS CERTIFIED THAT THE COMPREHENSIVE GEO-TECHNICAL REPORT ON SOIL INVESTIGATION HAS BEEN PREPARED BY ME FOR DESIGN AND CALCULATION OF THE FOUNDATION BY ANALYZING THE SOIL SAMPLES FOR ESTIMATING THE BEARING CAPACITY OF THE SOIL ON WHICH FOUNDATION OF THE STRUCTURE WILL BE CONSTRUCTED.

**DR. SUNIT KUMAR BOSE**  
Ph.D., M.C.E. (Soil) B.C.E. (Hons.)  
M.I.S.  
Licence No.-BM-I-Group-Tech/17  
Signature of the Geo-Technical Engineer  
**BOSE ENGINEERS**  
Dr. S.K. Bose  
P.O. MCZE SCE, MIDC, MIRC  
SEKATAPATI, SOUASTRA-751014  
E-mail: www.boseengineers.com

**SUN CONCLAVE PVT LTD**  
16/10/1, SOUASTRA, SOUASTRA  
Howrah-751014  
E-mail: www.sunconclave.com

AUTHORISED SIGNATORY  
**Chiranjit Ghose**  
Authorized Signatory

TITLE:  
OVER ALL SITE PLAN SHOWING GROUND FLOOR PLAN, SITE PLAN, LOCATION PLAN, DETAIL OF BOUNDARY WALL AND U.G.R.  
PROJECT ARCHITECT  
**PRAKALPA**  
16, NEW COLONY CHANDRABAGICHA, HOWRAH & 2nd FLOOR, SOUASTRA-751014  
TEL: 9334877777  
WEB SITE: www.praakalpa.com  
EMAIL: www.praakalpa.com  
DRAWN BY: DEBANGA  
CHECKED BY: ATANK C  
APPROVED BY: DATE: 08.05.17  
SCALE: 1:250  
SUBMISSION DRAWING  
DRAWING NO.:  
SOPAR: 1710/2016/1686/01

- 1. All building materials shall be tested as per specification of I.S. Code and the test results shall be submitted to the sanctioning authority.
- 2. The construction should be completed within the stipulated time.
- 3. The construction should be completed within the stipulated time.
- 4. The construction should be completed within the stipulated time.
- 5. The construction should be completed within the stipulated time.
- 6. The construction should be completed within the stipulated time.
- 7. The construction should be completed within the stipulated time.
- 8. The construction should be completed within the stipulated time.
- 9. The construction should be completed within the stipulated time.
- 10. The construction should be completed within the stipulated time.



AREA CALCULATION

Sl. No.	Particulars	Area (sq.m)	Remarks
1	Plot Area	14200.00	
2	Area of Building Footprints	12000.00	
3	Area of Green Spaces	1000.00	
4	Area of Driveways	1200.00	
5	Area of Boundary Wall	1000.00	
6	Area of U.G.R.	1000.00	
7	Total Area	17400.00	

Sl. No.	Particulars	Area (sq.m)	Remarks
1	Building-1	2000.00	
2	Building-2	2000.00	
3	Building-3	2000.00	
4	Building-4	2000.00	
5	Building-5	2000.00	
6	Building-6	2000.00	
7	Total	12000.00	

Sl. No.	Particulars	Area (sq.m)	Remarks
1	Building-1	2000.00	
2	Building-2	2000.00	
3	Building-3	2000.00	
4	Building-4	2000.00	
5	Building-5	2000.00	
6	Building-6	2000.00	
7	Total	12000.00	

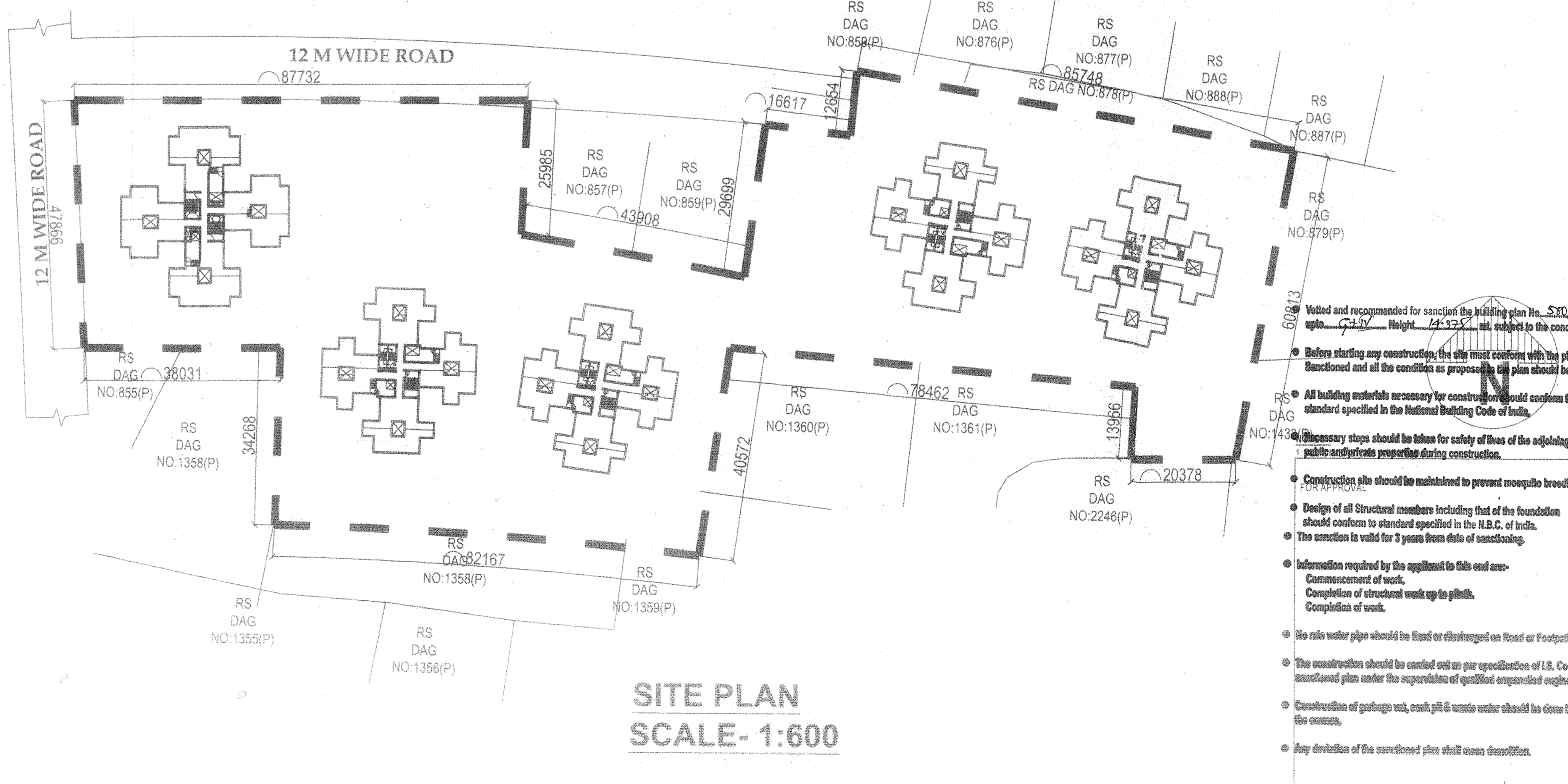
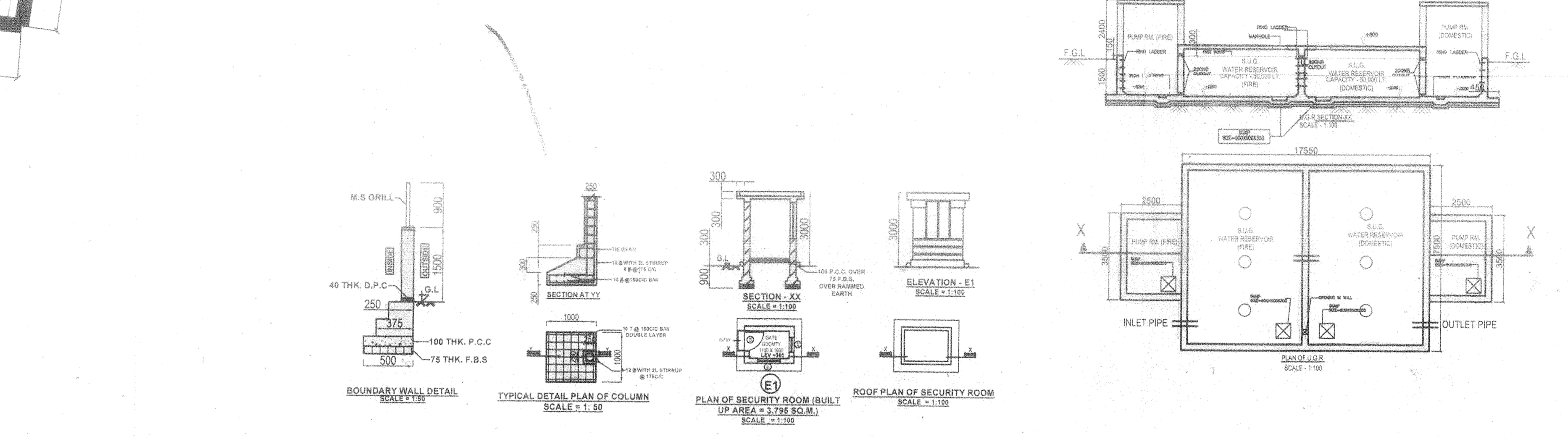
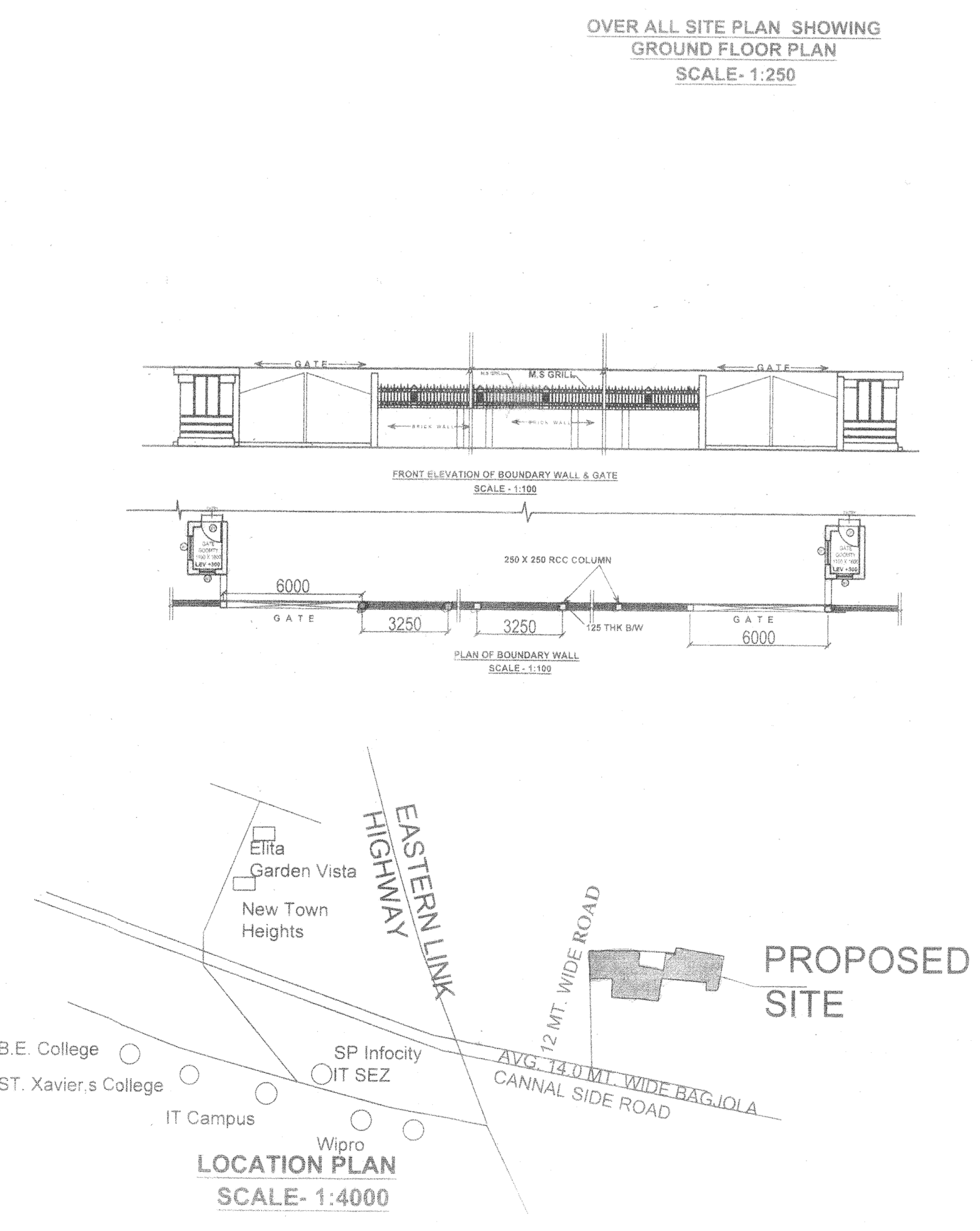

Asstt. Engineer  
South 24 P.S. Z.P.  
District Engineer  
South 24 P.S. Z.P.  
Signature of the District Engineer  
12.09.19  
Signature of the Project Architect  
12.09.19