

PLAN SHOWING AREA OF 8182.08 SQ.M / 216.84 DECIMAL, MORE OR LESS
 TAKEN FROM R.S. PLOT NO .853,842/5006,4512,R.S-KHAITAN NO-2696,2697,2698
 LR PLOT NO. 640,641,4427 J.L.NO:58, L.R.KHATIAN NO : 3081,2921,3062,3063,3060
 & 3061. MOUZA:BAMUNARA,PS:KANKSHA,DT.-PASCHIM BARDHAMAN SHOWN WITH RED COLOUR
 OWNERS: SRI.ANUP PURAKAYASTHA,SMT.CHANDANA PURAKAYASTHA,SRI.PANKAJ MUKHERJEE
 DR.MALAYA MUKHERJEE,SRI.MADHUSUDAN SAHA,SMT.RATNA SAHA

PROJECT LOCATION: Bamunara , Durgapur-713212

NORTH : 25ft wide Kacha Road,R.S Plot
 No 853,842

EAST : Land of Gppalpur Mouza

SOUTH : R.S Plot No 4511(P)

WEST : R.S Plot No-852(P),854,4507

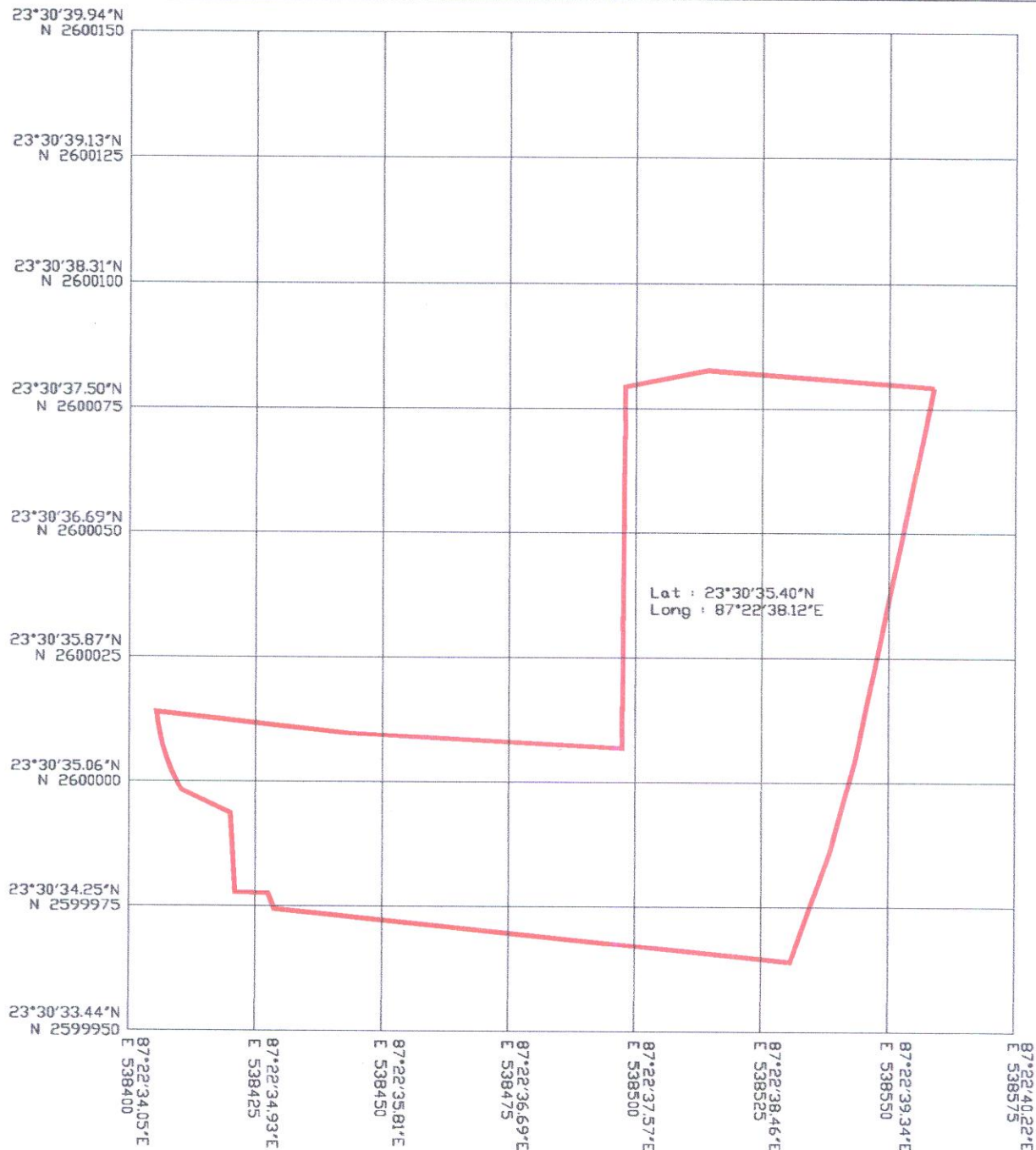

Lat : 23°30'35.40\"/>



PROJECT NAME : TAPOBON HOUSING PHASE-I

PROJECT LOCATION : BAMUNARA,DURGAPUR

ACME SURVEY

DEVELOPED BY : TAPOBON HOUSING DEV. PVT. LTD.

Authorised Signatory

SCALE : NTS

TOTAL AREA: 8782.08 Sq.M

ALL DIMENSIONS ARE IN METER

SURVEYED BY: ACME Survey

60, DEBI CHOUDHURANI PATH

CITY CENTRE,DURGAPUR-713216