

LEVEL 3 PLAN FOR PARKING
SCALE- 1:200

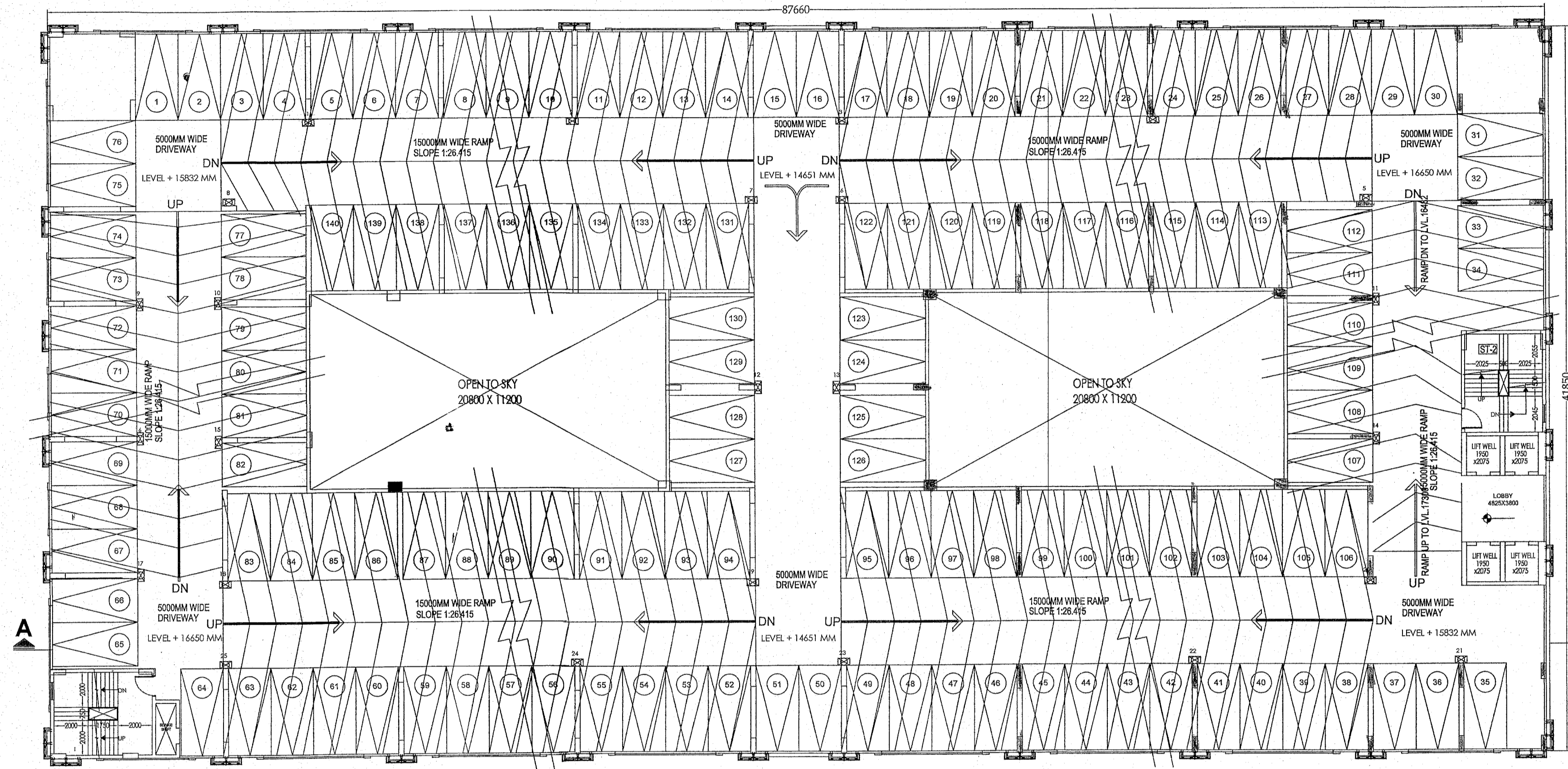

LEVEL 3.5 PLAN FOR PARKING
SCALE- 1:200

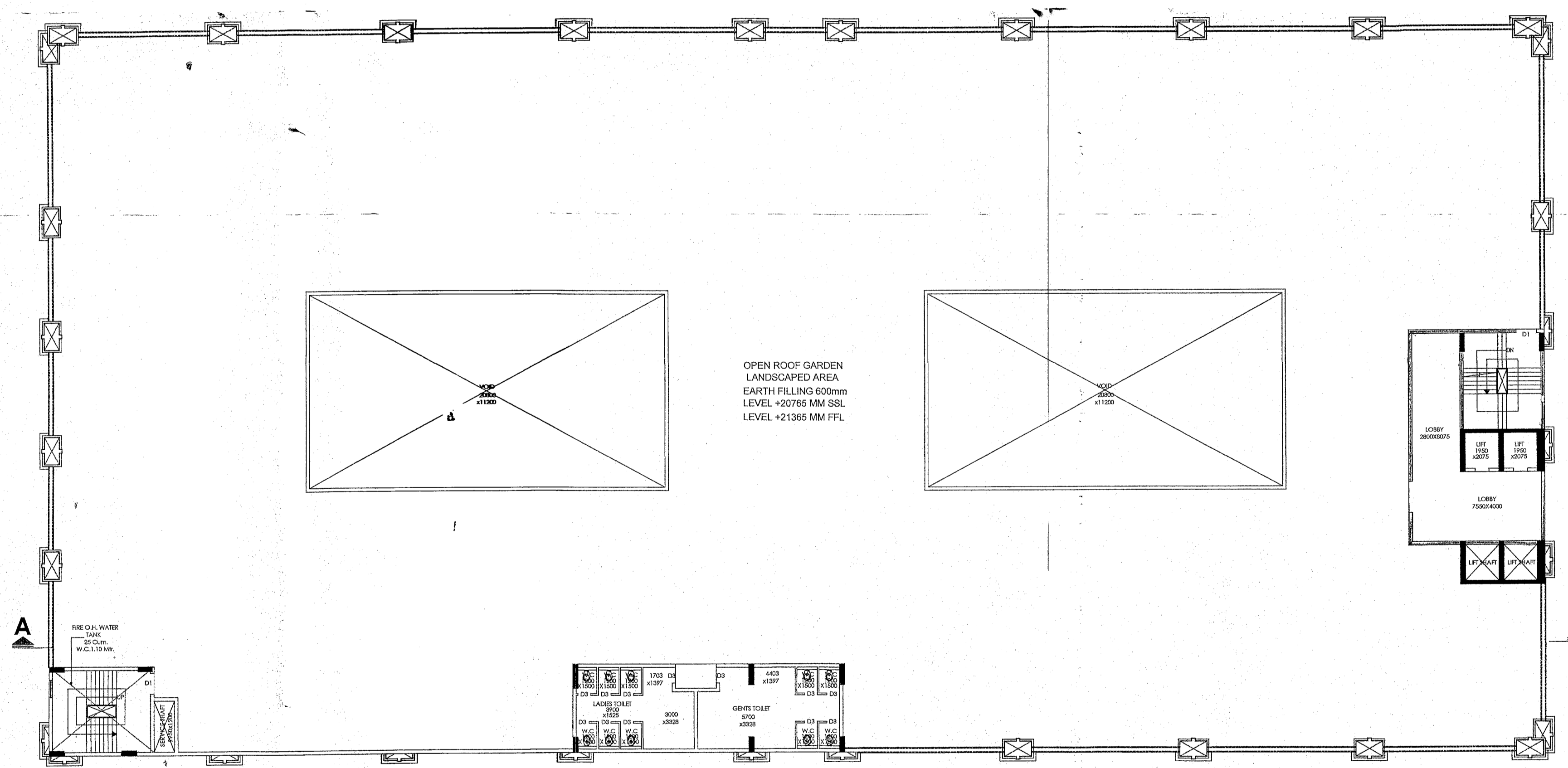

PLAN AT +21214 MM LEVEL
SCALE- 1:200

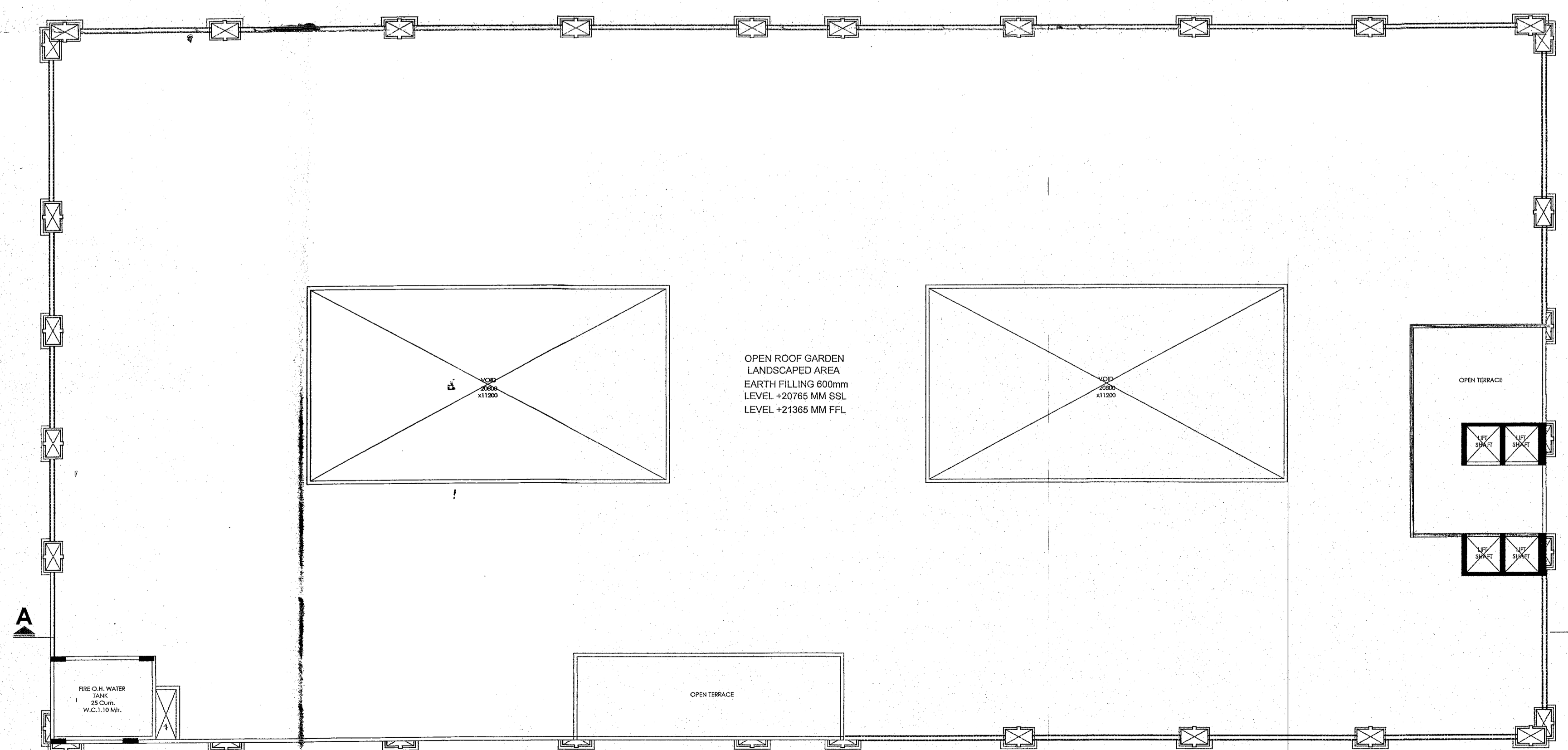

ROOF PLAN
SCALE- 1:200

I HAVE CHECKED THE STRUCTURAL CALCULATIONS MADE BY SRI CHANDI PRASAD KHANRA, E.S.E. : 1/2. THE CALCULATION IS FOUND CORRECT AND STRUCTURE IS SAFE AND STABLE IN ALL RESPECT.

Mita Saha
MITA SAHA
M.I.E., M.E. (Struct), C.E.
Structural Revision: 2222 (181C)
AG-89, Sec-II, Salt Lake,
Mod.-9031888112

DECLARATION OF REVIEWER:

I HAVE CHECKED THE EXISTING FOUNDATION AND SUPERSTRUCTURE OF THE BUILDING AND CERTIFIED THAT THE BUILDING IS SAFE AND STABLE IN ALL RESPECT AND CAPABLE OF TAKING ADDITIONAL LOAD FOR THE PROPOSED CONSTRUCTION.

Dr. R. S. Jangid
Dr. R. S. JANGID
Professor
Department of Civil Engineering
I.I.T. Bombay, Powai, Mumbai-76

DR. R.S. JANGID
PROFESSOR
DEPARTMENT OF CIVIL ENGINEERING
I.I.T. BOMBAY, POWAI, MUMBAI-76

Amul Ahmed Khan
Amul Ahmed Khan
Parviz Ahmed Khan
Sia. Yousang Hossain
Javed Ahmed Khan
Sdr. Shabbir Ahmad
Sdr. Shabbir Ahmad
S. K. Hossain
Constituted Attorney

SIG. OF OWNER

THE STRUCTURAL DESIGNS DRAWINGS OF BOTH FOUNDATION AND SUPERSTRUCTURE HAS BEEN MADE CONSIDERING ALL POSSIBLE LOADS INCLUDING THE SEISMIC LOAD AS PER THE NATIONAL BUILDING CODE OF INDIA AND CERTIFIED THAT IT IS SAFE AND STABLE IN ALL RESPECTS. THE ABOVE CALCULATION HAVE BEEN MADE BASED ON SOIL TEST REPORT.

Dr. Sujit Kumar Bose
DR. SUJIT KUMAR BOSE
P.D., M.C.E. (Struct), B.C.P. (Hons.)
MGS, MIR
Registered Geotechnical
Engineer (I) under ISE
License No. GT-12

Chandi Prasad Khanra
CHANDI PRASAD KHANRA
BE (Civil), ME (Struct), MIE (India)
ESE-12

SIGNATURE OF GEO. TECH. ENGR.

SIG. OF STRUCTURAL ENGR.

CERTIFIED THAT THE BUILDING PLAN HAS BEEN DRAWN UP AS PER PROVISION OF K.M.C. BUILDING RULES 2009 AS AMENDED FROM TIME TO TIME AND THAT THE SITE CONDITIONS INCLUDING THE WIDTH OF THE ABUTTING ROAD BEING 67.5 MTS. CONFORM WITH PLAN AND THAT IT IS A BUILDING SITE AND NOT A TANK OR FILLED UP TANK.

Harsh Sanon
HARSH SANON
COUNCIL OF ARCHITECTURE
REGISTRATION No. CA/90/13556
Signature of Architect

HARSH SANON
COUNCIL OF ARCHITECTURE
REGISTRATION NO. CA/90/13556
Signature of Architect

PROJECT : PLAN FOR PROPOSED ADDITIONAL 4 FLOORS OVER SANCTIONED G+2F STORED COMMERCIAL BUILDING AND PARTIAL EXTENSION OF 5TH FLOOR OF 5 STORED M.L.C.P BLOCK UNDER RULE 28 (2a & 2b) READ WITH RULE 88A (1)-(3) OF KMC BUILDING RULE 2009, PREVIOUSLY BUILDING PLAN WAS SANCTIONED VIDE B.P. NO. -201107500, DATED: 12-12-2011, AND SUBSEQUENTLY REVALLIDATE FOR FIVE YEARS W.E.F 12-12-2016 AND REGULARIZED PLAN UNDER RULE 28 (2a) & (2b) OF KMC BUILDING RULES 2009, VIDE M.B.C. MEETING NO-864, ITEM NO. -12819-20, DATED: 07.11.2019, AT PREMISES NO 10, EAST TOPSIA ROAD, WARD NO-66, BOROUGH NO-VII, KOLKATA - 700 046, UNDER KOLKATA MUNICIPAL CORPORATION.

JOB NO: 670	TITLE: M.L.C.P. BLOCK (FLOOR PLANS) WITH ELECTRICAL CHARGING POINTS
DRG. NO: CA/KMC-11	
REVISION NO: 0	SCALE: As Mentioned
	DEALT BY: Moumita
	CHECKED BY: Suvadip
	DATE: 03.09.2020

S&S
SANON SEN & ASSOCIATES (P) LTD.
ARCHITECTS, ENGINEERS & INTERIOR DESIGNERS
5, RUSSEL STREET, KOLKATA-700 071
PHONE: 91-33-22264579, 22172505, 22294402
FAX: 2226 6917, E-MAIL: sanonsen@vsnl.com