

NINETEENTH FLOOR PLAN
SCALE- 1:100

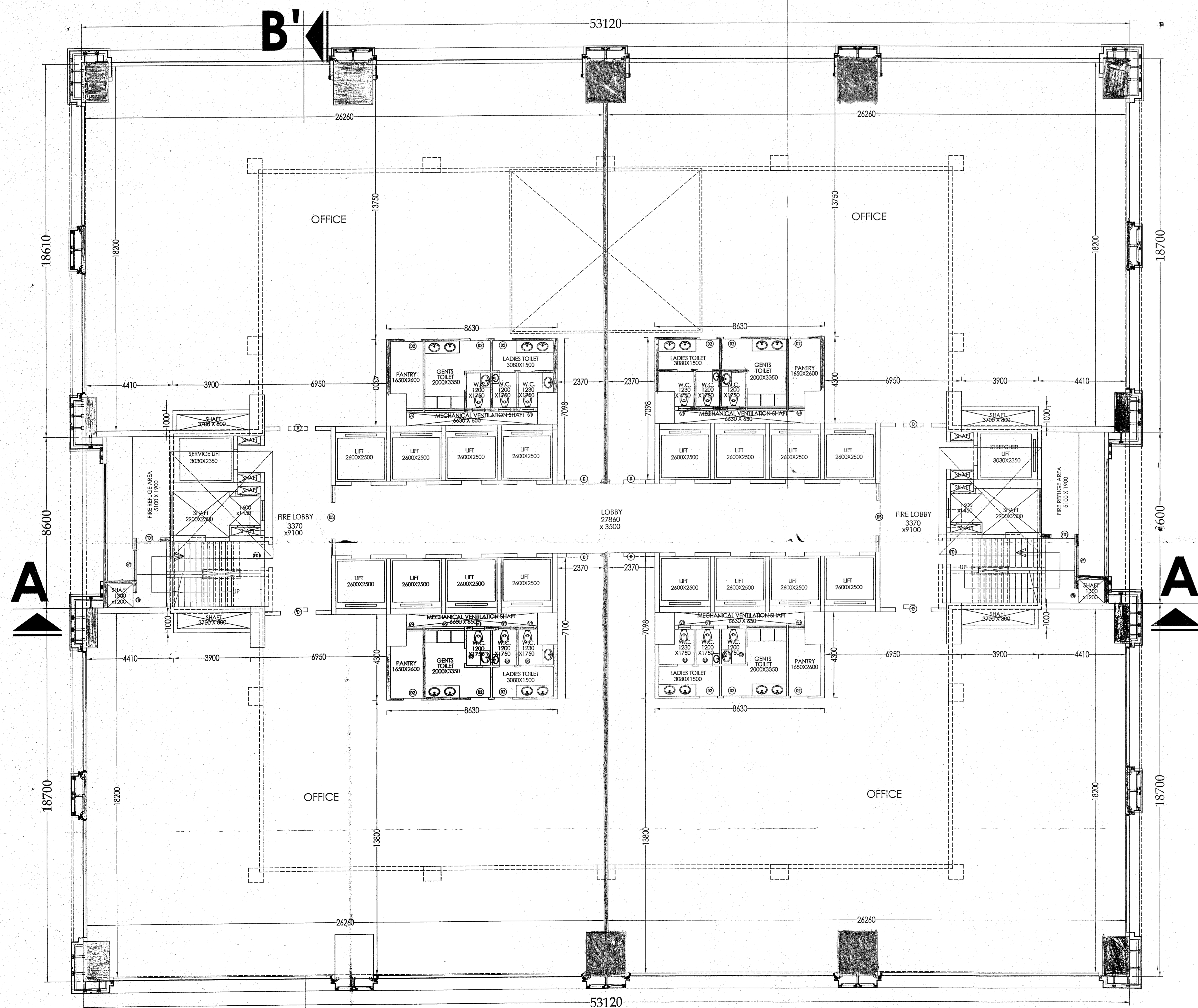

27TH FLOOR PLAN
SCALE- 1:100

I HAVE CHECKED THE STRUCTURAL CALCULATIONS MADE BY SRI CHANDI PROSAD KHANRA, E.S.E.T. 1/2. THE CALCULATION IS FOUND CORRECT AND STRUCTURE IS SAFE AND STABLE IN ALL RESPECT.			
MITA SAHA PROFESSOR M.I.E. (Struct), C.E. Structural Reviewer-22/23 (KMC) AG-89, Sec-1, Salt Lake, Mob-9821688112 DECLARATION OF REVIEWER:			
I HAVE CHECKED THE THE EXISTING FOUNDATION AND SUPERSTRUCTURE OF THE BUILDING AND CERTIFIED THAT THE BUILDING IS SAFE AND STABLE IN ALL RESPECT AND CAPABLE OF TAKING ADDITIONAL LOAD FOR THE PROPOSED CONSTRUCTION.			
Dr. R. S. JANGID Professor Department of Civil Engineering I.I.T. Bombay, Powai, Mumbai-76		DR. R.S. JANGID PROFESSOR DEPARTMENT OF CIVIL ENGINEERING I.I.T. BOMBAY, POWAI, MUMBAI-76	
Anul Ahmed Khan Parvez Ahmed Khan Mr. Yashwantrao Kulkarni Javed Ahmed Khan Mr. Shantanu Kulkarni Mr. Shantanu Auditor S. S. H. & Co. Chartered Accountants SIG. OF OWNER			
THE STRUCTURAL DESIGNS DRAWINGS OF BOTH FOUNDATION AND SUPERSTRUCTURE HAS BEEN MADE/ CONSIDERING ALL POSSIBLE LOADS INCLUDING THE SEISMIC LOADS PER THE NATIONAL BUILDING CODE OF INDIA, AND CERTIFIED THAT IT IS SAFE AND STABLE IN ALL RESPECTS. THE ABOVE CALCULATION HAVE BEEN MADE BASED ON SOIL TEST REPORT.			
DR. SUJIT KUMAR BOSE M.E., M.C.E. (SOIL), B.C.E. - HON'BLE MRS. MRS. Registered Geotechnical Engineer (I) under R.S.P. License No. GE-17 SIGNATURE OF GEO. TECH. ENGR.:		CHANDI PROSAD KHANRA BE (CIVIL), ME (Struct), MBE (Struct) 1988-19 SIG. OF STRUCTURAL ENGR.	
CERTIFIED THAT THE BUILDING PLAN HAS BEEN DRAWN UP AS PER PROVISION OF K.M.C. BUILDING RULES 2009 AS AMENDED FROM TIME TO TIME AND THAT THE SITE CONDITIONS INCLUDING THE WIDTH OF THE ADJUTING ROAD BEING 47.50 METERS, CONFORM WITH PLAN AND THAT IT IS A BUILDING SITE AND NOT A TANK OR FILLED UP TANK.			
HARSH SANON COUNCIL OF ARCHITECTURE REGISTRATION NO. CA/90/13356 Signature of Architect:		HARSH SANON COUNCIL OF ARCHITECTURE REGISTRATION NO. CA/90/13356 Signature of Architect:	
PROJECT: PLAN FOR PROPOSED ADDITIONAL 4 FLOORS OVER SANCTIONED 0+07 STORED COMMERCIAL BUILDING AND PARTIAL EXTENSION OF 5TH FLOOR OF 5 STORED MLCBP BLOCK UNDER RULE 26 (2) & (3) READ WITH RULE 69A (1-C) OF KMC BUILDING RULE 2009, PREVIOUSLY BUILDING PLAN WAS SANCTIONED VIDE B.P. NO. 2011/07008, DATED: 13.12.2011, AND SUBSEQUENTLY REVALLDATE FOR FIVE YEARS W.E.F. 13.12.2016 AND REGULARIZED PLAN UNDER RULE 26 (2) & (3) OF KMC BUILDING RULES 2009, VIDE M.B.C. MEETING NO.684, ITEM NO. 12819/20, DATED: 07.11.2016, AT PREMISES NO.10, EAST TOPSIA ROAD, WARD NO-66, BOROUGH NO-VII, KOLKATA-700 046, UNDER KOLKATA MUNICIPAL CORPORATION.			
JOB NO: 670	TITLE: 19TH FLOOR PLAN AND 27TH FLOOR PLAN		
DRG. NO: CA/KMC-04	SCALE: As Mentioned	DEALT BY: Moumita	CHECKED BY: Suvadip
REVISION NO: 0	DATE: 03.09.2020		
S&S SANON SEN & ASSOCIATES (P) LTD. ARCHITECTS, ENGINEERS & INTERIOR DESIGNERS 5, RUSSEL STREET, KOLKATA-700 071 PHONE-91-33-22264579, 22172505, 22294402 FAX-2226 8917 E-MAIL: sanonsen@vsnl.com			